

1 6 02-15



Service Information Bulletin SB-10058867-7972

SUBJECT	DATE
GHG14 DD15 AT Exhaust Gas Recirculation Valve/Hot Pipe	June 2015

Additions, Revisions, or Updates

Publication Number / Title	Platform	Section Title	Change
DDC-SVC-MAN-0083	GHG14 DD15	Removal of the GHG14 DD15 AT Exhaust Gas Recirculation Valve/Hot Pipe	Steps and Notices are added.
		Installation of the GHG14 DD15 AT Exhaust Gas Recirculation Valve/Hot Pipe	



13400 Outer Drive, West, Detroit, Michigan 48239-4001
 Telephone: 313-592-5000
www.demanddetroit.com

2 Removal of the GHG14 DD15 AT Exhaust Gas Recirculation Valve/Hot Pipe

Remove as follows:



WARNING: PERSONAL INJURY

To avoid injury from hot surfaces, wear protective gloves, or allow engine to cool before removing any component.



WARNING: PERSONAL INJURY

To avoid injury, never remove any engine component while the engine is running.

1. Shut off the engine, apply the parking brake, chock the wheels, and perform any other applicable safety steps.
2. Remove the exhaust manifold heat shield covering the Exhaust Gas Recirculation (EGR) hot pipe.
3. Remove the heat shield covering the turbo outlet pipe.

NOTICE: The EGR valve actuator shaft must be held still using a wrench when removing or installing the actuator lever or pull rod clamping nuts to avoid damage to the EGR valve actuator internal end stops.

4. Remove the EGR valve actuator pull rod clamping nut and remove the pull rod from the EGR valve.
5. Remove the exhaust clamps (2) from the EGR valve/hot pipe (1) to the exhaust manifold outlet and EGR cooler inlet (3). Discard exhaust clamps.

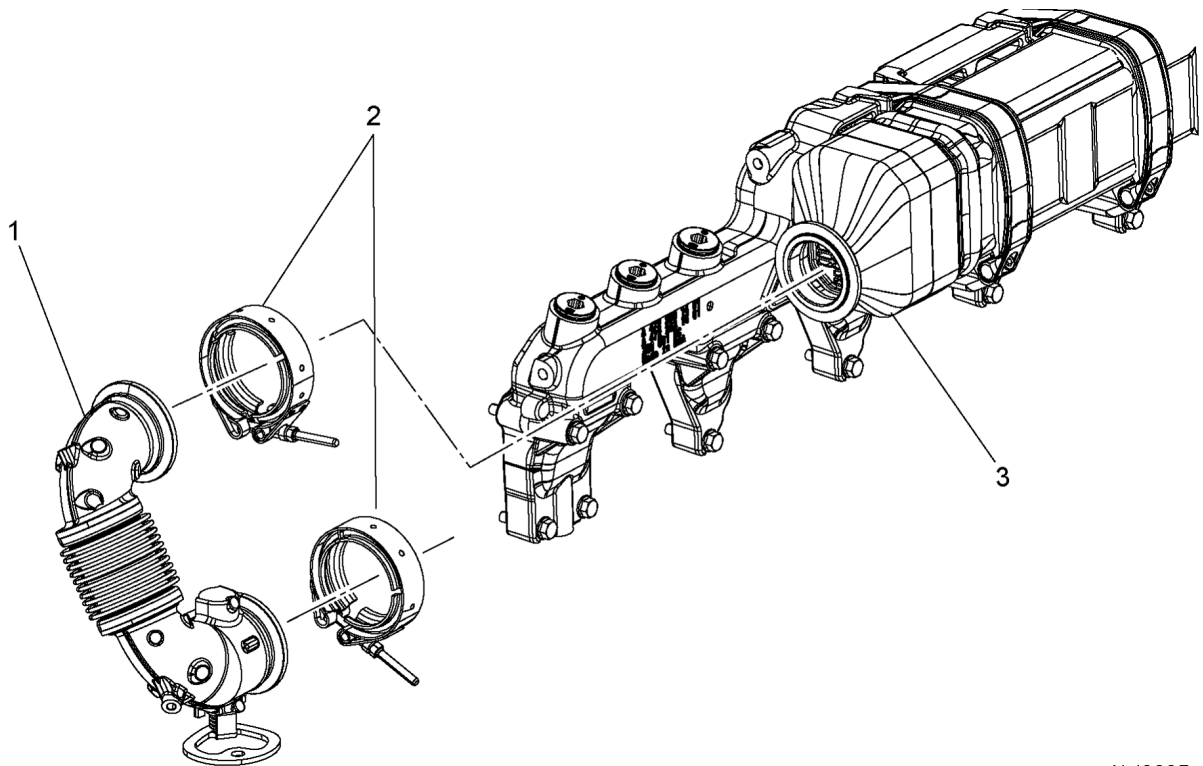

d140385

6. Remove the EGR valve/hot pipe (1) from the engine.

3 Installation of the GHG14 DD15 AT Exhaust Gas Recirculation Valve/Hot Pipe

Install as follows:

NOTICE: Be sure not to bend or damage the Exhaust Gas Recirculation (EGR) valve lever during handling and installation.

1. Install the EGR valve/hot pipe to the EGR cooler inlet and exhaust manifold outlet. Orient the pipe with the lever side attaching to the exhaust manifold outlet.
2. Install new exhaust clamps (2) in the orientation shown below. Torque clamps to 12 N·m (9 lb·ft).

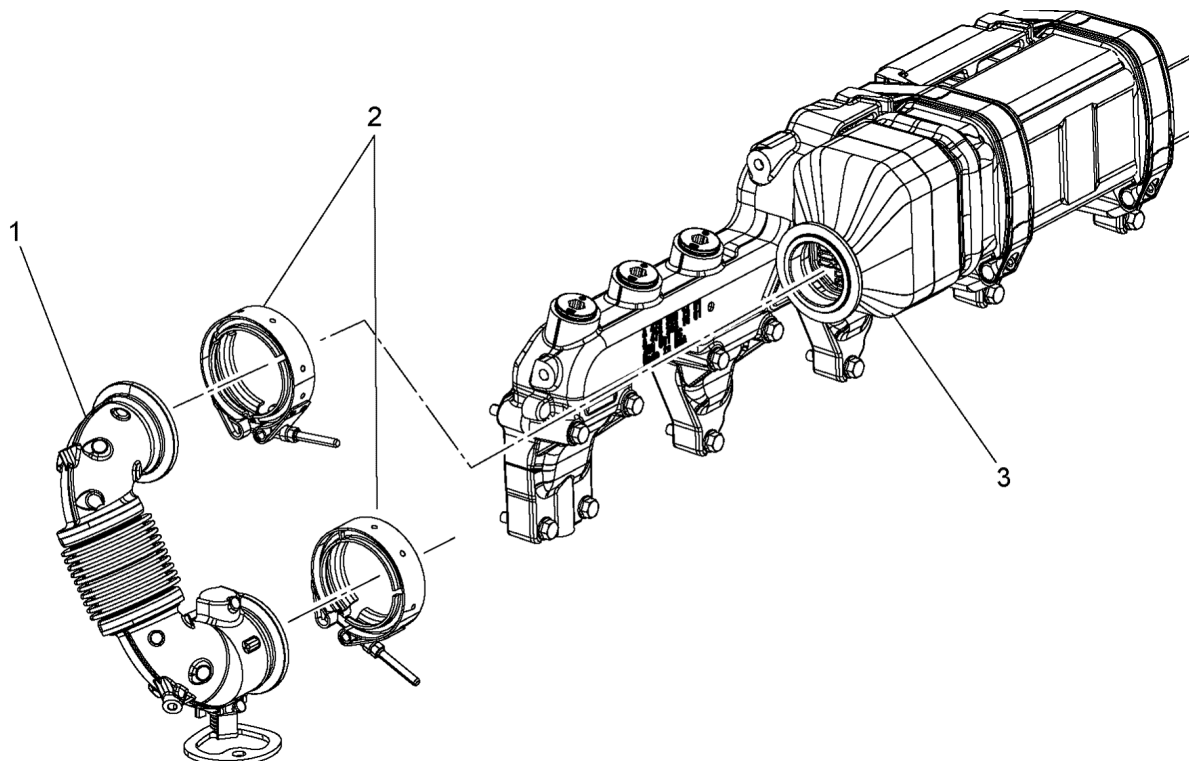

d140385

3. Gently tap each of the clamps to ensure they are properly seated. Re-torque the clamps to 12 N·m (9 lb·ft).
4. After installing the EGR valve/hot pipe (1), sweep the EGR valve lever by hand to verify it does not make contact with the clamps. If contact is made, rotate the clamps as needed to gain clearance.

NOTICE: The EGR valve actuator shaft must be held still using a wrench when removing or installing the actuator lever or pull rod clamping nuts to avoid damage to the EGR valve actuator internal end stops.

5. Install the EGR valve actuator pull rod onto EGR valve lever. Apply a small amount of copper based anti-seize compound to the clamping nut threads and tighten. Make sure that the anti-seize is applied only to the threads and does not get on the pull rod bearings. Torque clamping nut to 20 N·m (15 lb·ft).
6. Run the "EGR Actuator Slow Learn" procedure in DiagnosticLink[®].