

VOLVO CARS
SERVICE AND PARTS BUSINESS

Technical Journal

TITLE:

Front park assist sensor bracket, coming loose

REF NO: TJ 29122	ISSUING DEPARTMENT: Technical Service	CAR MARKET: United States and Canada		
PARTNER: 3 US 7510 Volvo Cars North America		ISSUE DATE:		
FUNC GROUP: 3660	FUNC DESC: Automatic monitoring and control	YEAR 2015	MONTH 09	DAY 16
Page 1 of 6				

"Right first time in Time"**Attachment**

File Name	File Size
TJ 29122.pdf	0.7778 MB

Vehicle Type

Type	Eng	Eng Desc	Sales	Body	Gear	Steer	Model Year	Plant	Chassis range	Struc Week Range
256							2016-9999		0000561-9999999	201505-999952

CSC Customer Symptom Codes

Code	Description
U5	Bumper/Other bumper problems
KS	Front/rear park assist/Does not work

VST Operation Number

VST Operation Number	Description
98610-2	PAS adjust console acc. to TJ29122

DTC Diagnostic Trouble Codes



Text

DESCRIPTION:

The front park assist sensor bracket may come loose from the lower grill. The clamping force on the bracket in the lower grill may be too low.

VEHICLE REPORT:

Yes, please submit a Vehicle Report if the service solution described in this TJ has no effect. Use concern area "Vehicle Report" and sub concern area "Support Not Needed", use function group 3660.

SERVICE:

In case of customer complaints of a loose park assist sensor bracket, follow the attached instruction to assemble a foam block on the bracket to increase the clamping force.

To view TJ attachment continue to next page. This TJ has one attachment.



Volvo Car Customer Service

TJ 29122

Title	Parking assistance, front	Page	1 (4)
Action	Adjustment	Operation number:	98610-2

Issue	Date	Reason
1	2015-09	First issue

Affected vehicles

Model year	Model
2016	XC90 (16-)

Materials

Materials	Qty.	Part No.	Notes
Sealing	0.1	9124372	

Orientation view

Note! Removal steps in this procedure may contain installation details.

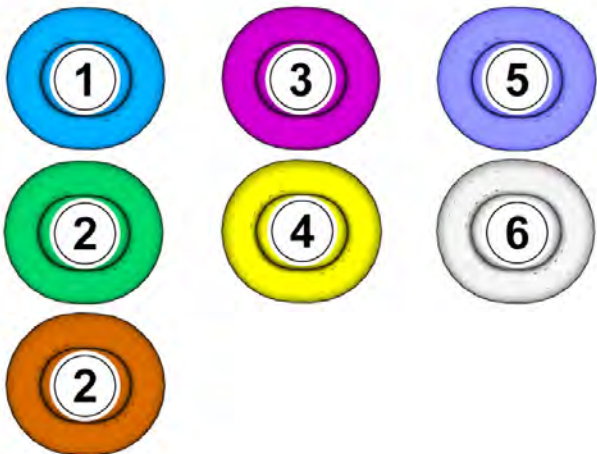
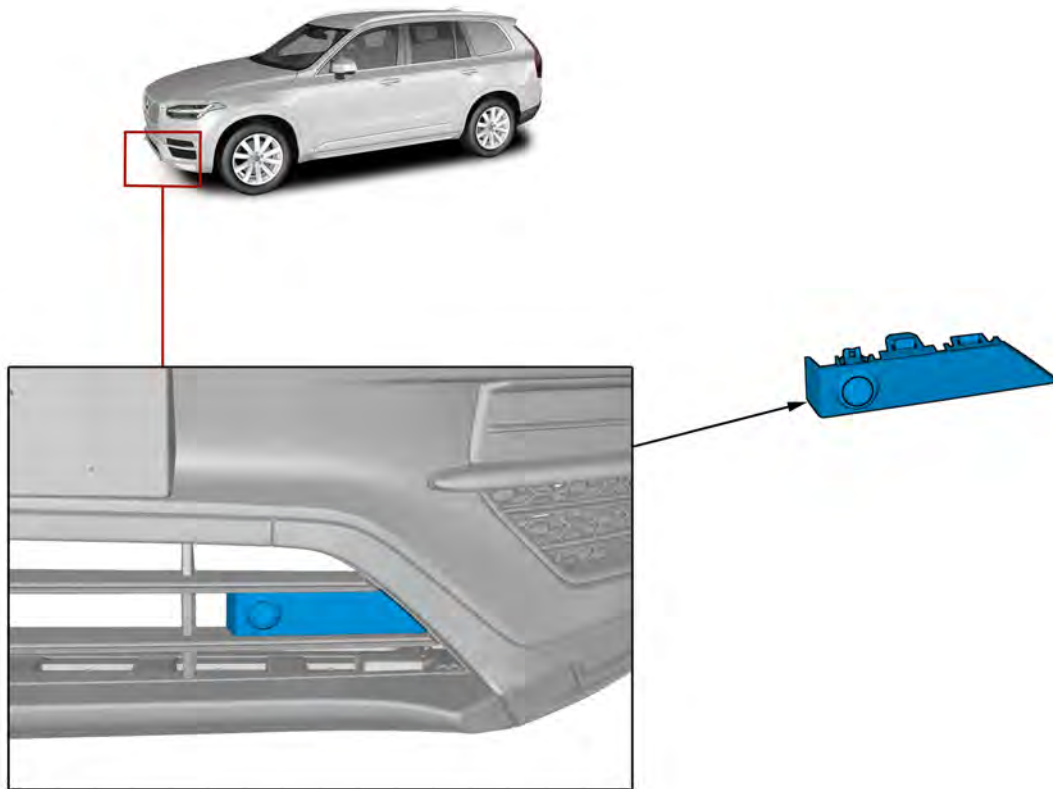

Note! This colour chart displays (in colour print and electronic version) the importance of the different colours used in the images of the method steps.

- 1 . Used for focused component, the component with which you will do something.
- 2 . Used as extra colors when you need to show or differentiate additional parts.
- 3 . Used for attachments that are to be removed/installed. May be screws, clips, connectors, etc.
- 4 . Used when the component is not fully removed from the vehicle but only hung to the side.
- 5 . Used as background color for vehicle components.

Removal

Note! Removal steps in this procedure may contain installation details.

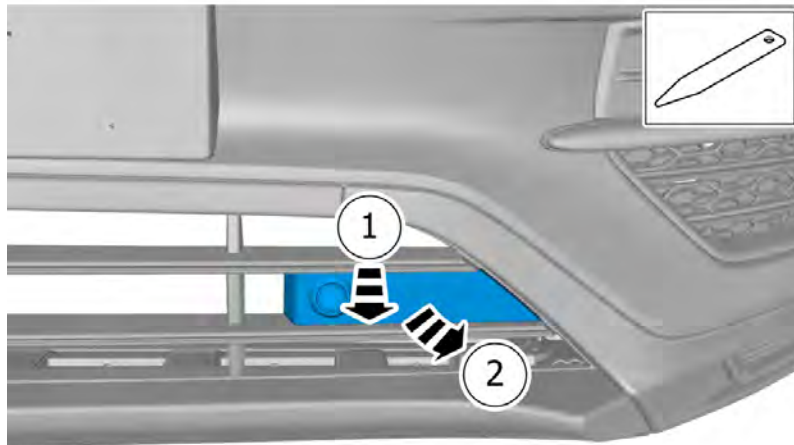

- 1 . **Use:** Interior trim remover
- 2 . Remove the marked part.

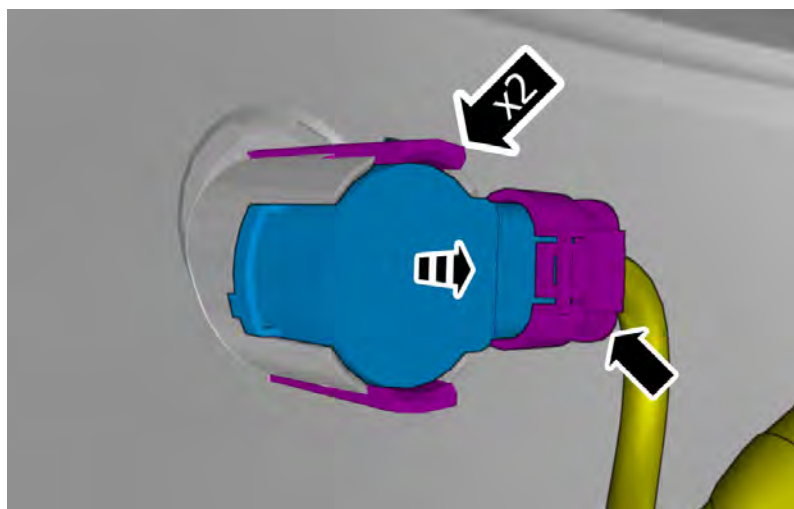

Disconnect the connector.
Release the catches.
Remove the marked part.

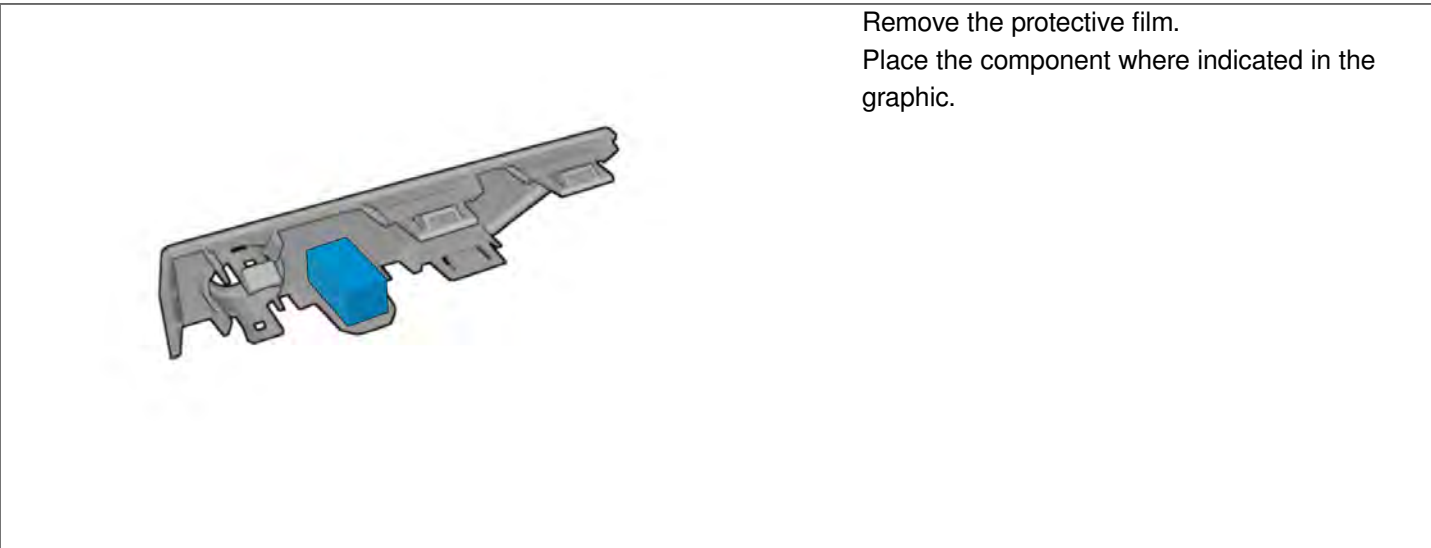
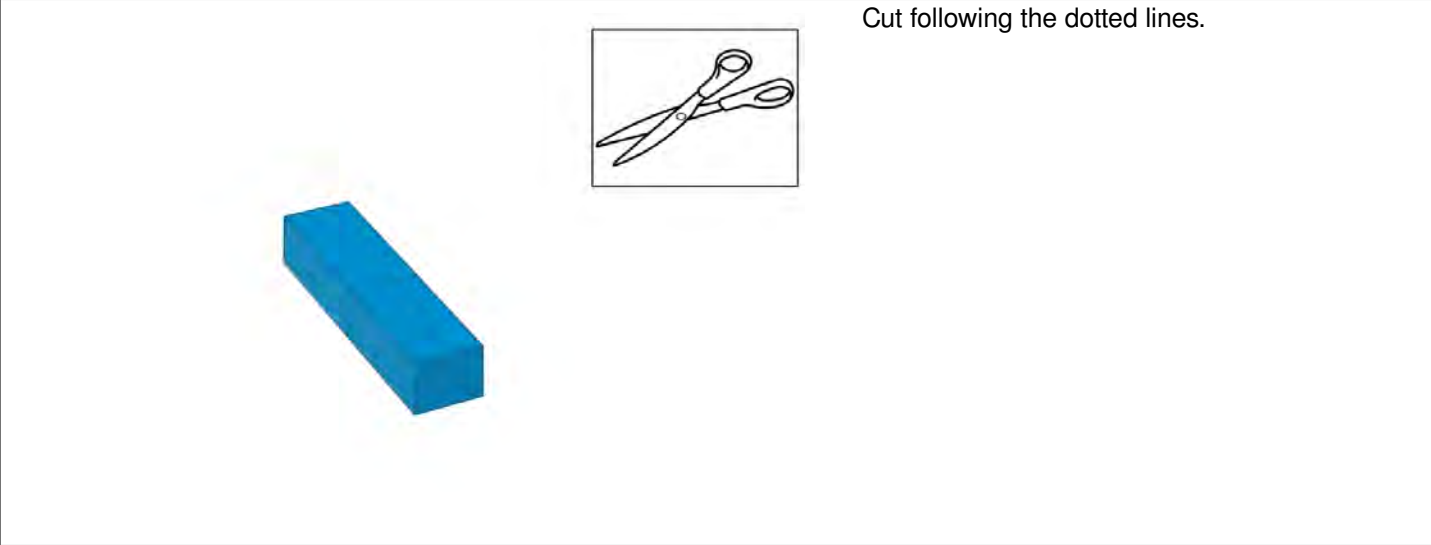

On both sides.

Installation

To install, reverse the removal procedure.

Check for correct operation.