

Cracked Fuses on Powertrain Power Distribution Modules

54-58

Constellation
> Heritage
> 4700 Models

> 4800 Models
> 4900 Models

> 5900 Models
> 6900 Models

**Western Star
Service Bulletin**

General Information

The fuses on horizontally-mounted powertrain power distribution modules (PDM) may crack due to vibration. Use the instructions in this bulletin to reduce the level of vibration on the PDM.

Instructions

1. Park the vehicle, shut down the engine, and apply the brakes. Chock the tires.
2. Open the hood.
3. Remove the split loom from the PDM harness and discard.
4. Wrap a 6-inch (15-cm) length of the harness with electrical tape, starting at the base. See [Fig. 1](#).

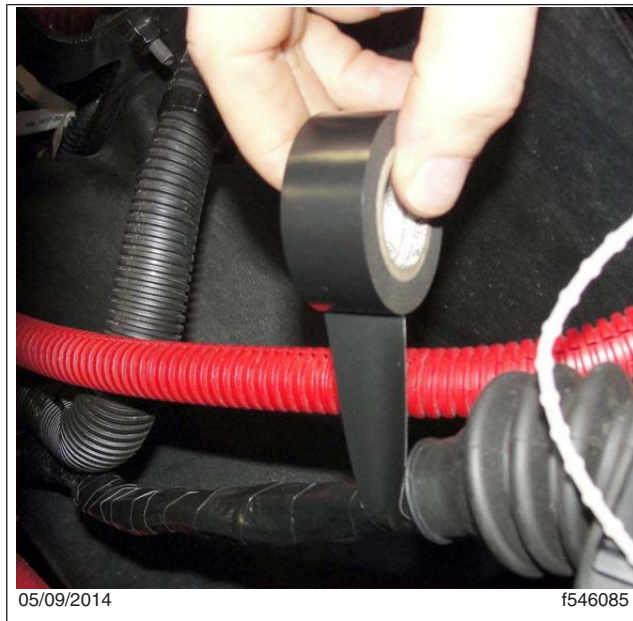

Fig. 1, Wrapping the PDM Harness with Electrical Tape

5. Secure the harness to the PDM using a cable tie.
 - 5.1 Feed the cable tie through the opening at the base of the PDM.
 - 5.2 Wrap the cable tie around the harness and attach the ends, but do not tighten.
 - 5.3 Form a drip loop with the harness so that the PDM boot is not bent or pulled by the harness.
 - 5.4 Tighten the cable tie and secure the harness tightly to the base of the PDM. See [Fig. 2](#).
6. Close the hood.

Warranty

This is an informational bulletin only. Warranty does not apply.

Constellation
> Heritage
> 4700 Models

> 4800 Models
> 4900 Models

> 5900 Models
> 6900 Models

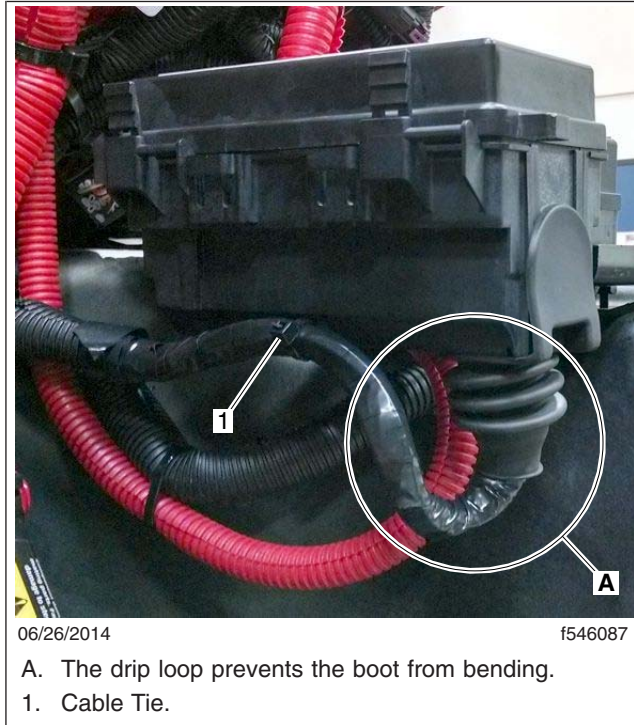

Fig. 2, PDM Harness with a Drip Loop