

Classification:
EM15-002

Reference:
ITB15-015

COPYRIGHT© NISSAN NORTH AMERICA, INC.
Date:
April 8, 2015

2011-2013 M; REMOVING THE ENGINE COVER

APPLIED VEHICLE: 2011-2013 M56 (Y51)

SERVICE INFORMATION

When removing the Engine Cover, special care must be taken to prevent damaging it.

NOTE: If the Engine Cover is not removed in the sequence shown, the Engine Cover could be damaged.

To remove the Engine Cover:

1. First remove the two Engine Cover bolts at the rear of the cover (Figure 1).

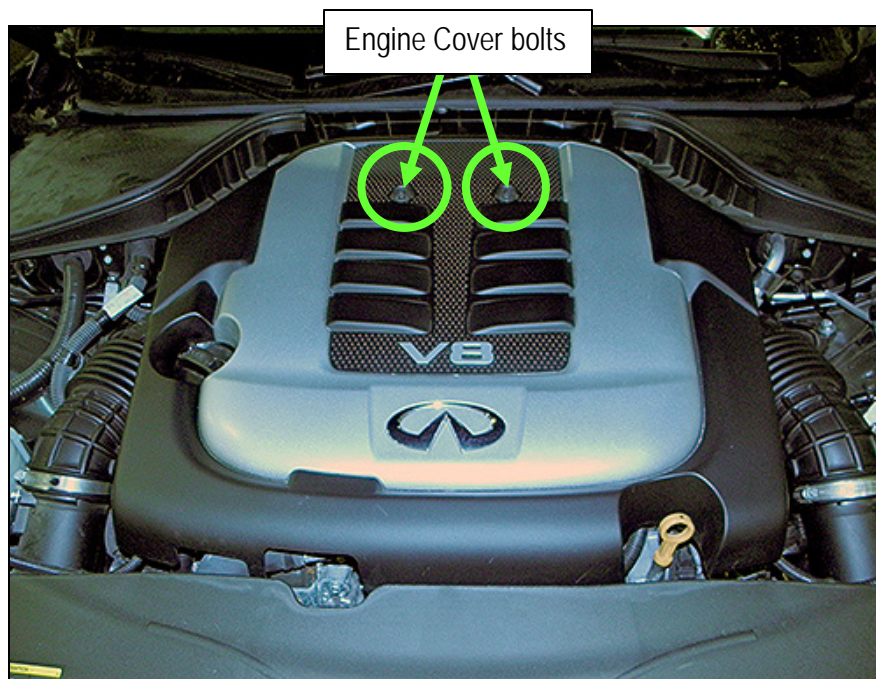

Figure 1

Infiniti Bulletins are intended for use by qualified technicians, not 'do-it-yourselfers'. Qualified technicians are properly trained individuals who have the equipment, tools, safety instruction, and know-how to do a job properly and safely. **NOTE:** If you believe that a described condition may apply to a particular vehicle, **DO NOT** assume that it does. See your Infiniti retailer to determine if this applies to your vehicle.

2. Detach the locator pins, first at the left and then right side, out of their rubber grommets and as close to the locator pins (Figure 3 and Figure 5) as possible.
 - a. Lift the Engine Cover vertically at the left front (driver's side) and detach the left front locator pin from the rubber grommet.

NOTE: Do Not lift the Engine Cover at any other point other than what is shown in Figure 2 or damage may occur.

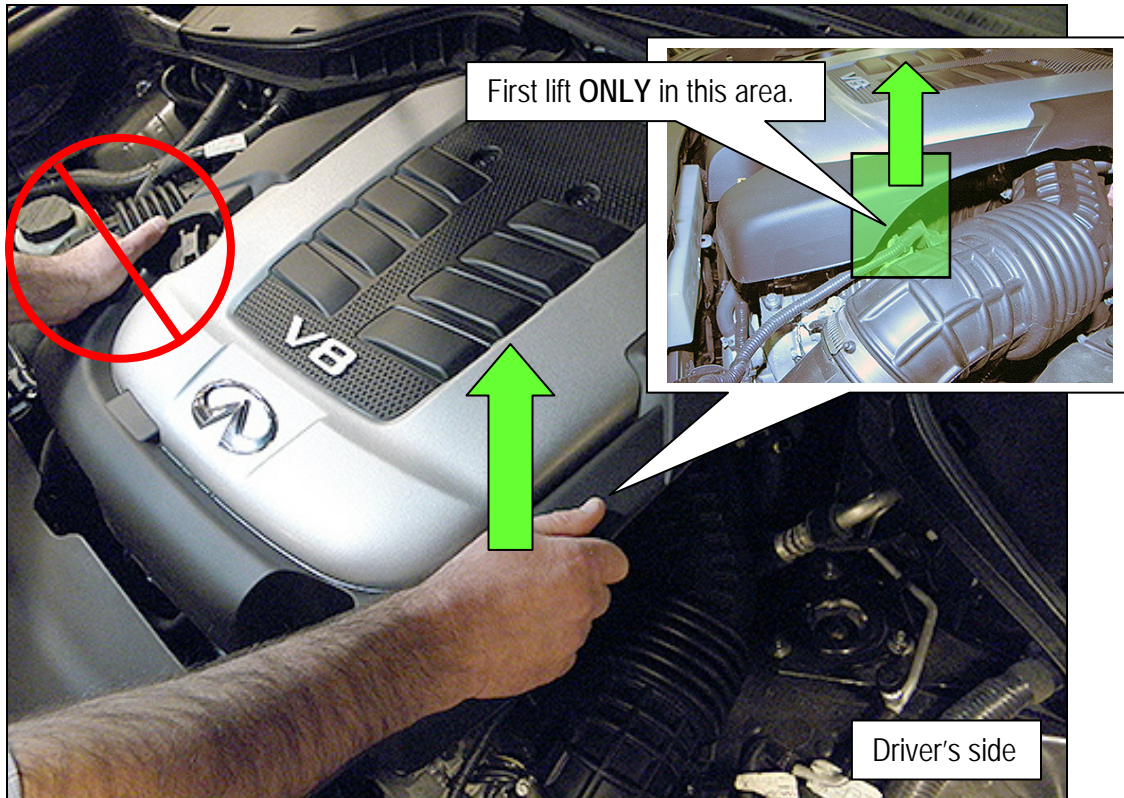

Figure 2

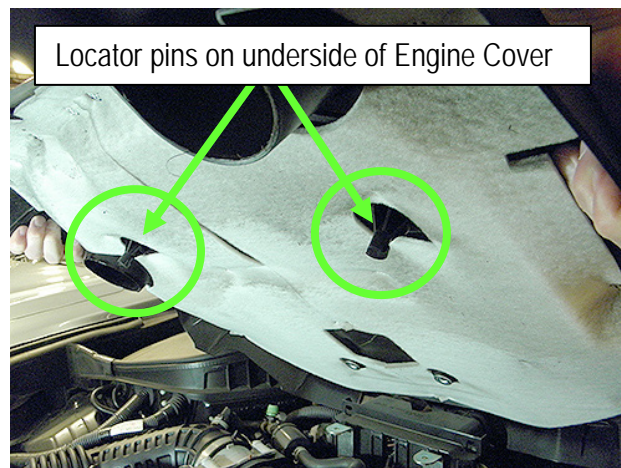

Figure 3

- b. Lift the Engine Cover vertically at the right front (passenger's side) and detach the right front locator pin (Figure 4) from the rubber grommet.

NOTE: Do Not lift the Engine Cover at any other point other than what is shown in Figure 4 or damage may occur.

3. Remove the Engine Cover from the vehicle.

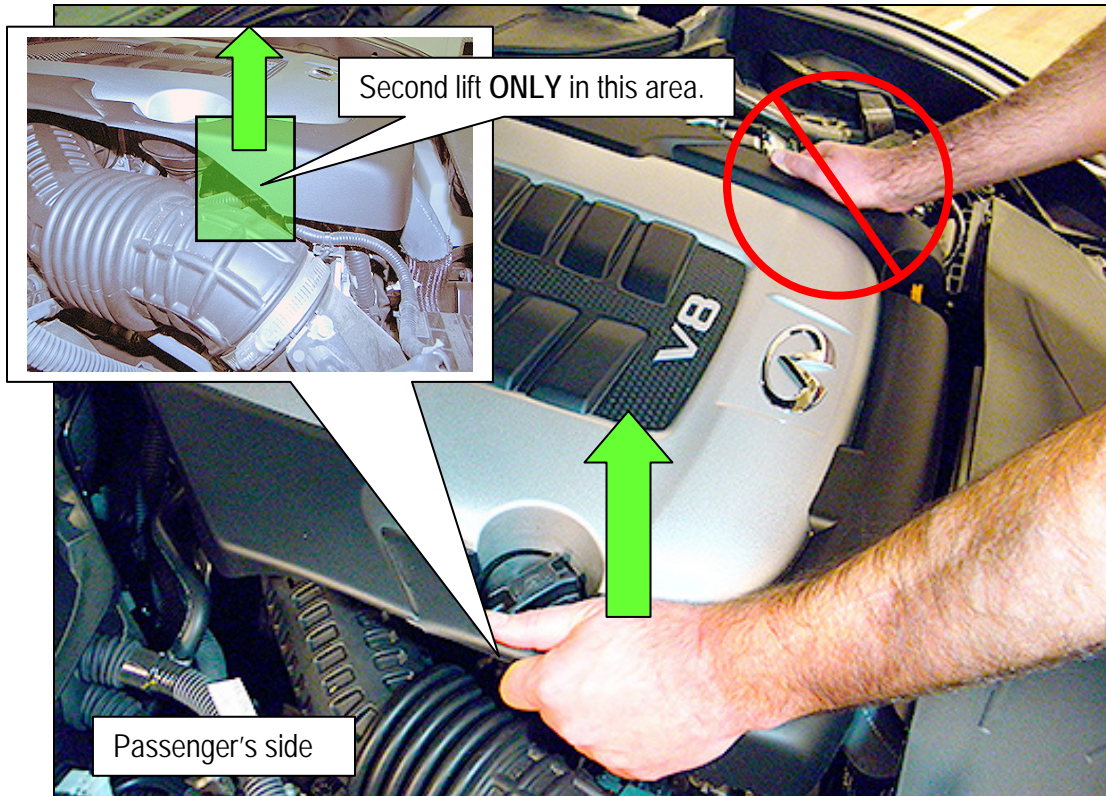

Figure 4

- When reassembling, carefully realign the front locator pins in the reverse order before pushing down to secure.

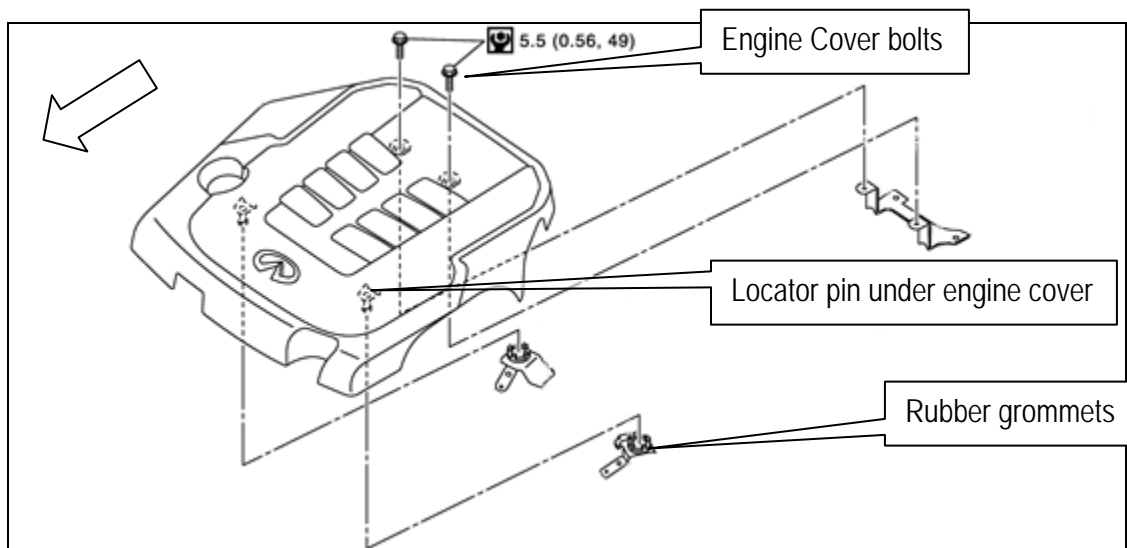

Figure 5