



TECHNICAL SERVICE BULLETIN

Release Date: May 06, 2015
Expiration Date: 05/06/2016

Indian Motorcycle

Bulletin Number: I-15-02AB
Model Year(s): 2015

Safety Bulletin Service Bulletin Service Alert Fax Production Update Kit

Distribution: Owner / Principal Service Manager Sales Manager Parts Manager Technicians

This Service Bulletin is located at www.polarisdealers.com

-Confidential and Proprietary-

SUBJECT: 2015 Indian Chief Classic and Vintage Motorcycles - Fuel Gauge Inoperative

This Service Bulletin must be performed prior to selling an affected unit!

PURPOSE:

Indian Motorcycle has determined that some 2015 motorcycles may have an inoperative fuel level gauge. The affected motorcycles were assembled with a faulty fuel level gauge that continuously displays empty and illuminates the low fuel level lamp regardless of fuel level.

To verify functionality of the fuel level gauge a minimum of 2 gallons (7.57 liters) of gasoline must be added to the fuel tank. If the fuel level gauge reads empty and the low fuel lamp is illuminated after adding fuel the gauge must be replaced. Indian Motorcycle has developed a replacement fuel level gauge to correct this condition.

POTENTIALLY AFFECTED MODELS:

Use 'Unit Inquiry' or the Service Bulletin VIN Lookup tool on the STOP Site to identify affected vehicles.

WHAT YOUR DEALERSHIP SHOULD DO:

1. Review your dealership's inventory to locate potentially affected models.
 - a. Use 'Unit Inquiry'.
 - OR**
 - b. Locate the 'Service and Warranty' dropdown, click on STOP Site.
 - c. On the left hand side of the page, under 'STOP Site Links', click on 'Service Bulletins'.
 - d. Locate the service bulletin number (I-15-02A/B) and click on the 'All VINs' link located on the right.
 - e. The 'All VINs' page will display all affected VINs within your dealership's inventory.
2. Follow the instructions outlined in this Safety Bulletin to inspect, and if necessary, replace the affected fuel gauge assembly using the updated parts detailed in this communication.
3. File a warranty claim using the bulletin number which corresponds to the operation performed (Inspect or Inspect / Replace) immediately after completion of this bulletin.

PARTS INFORMATION:

PART NUMBER / DESCRIPTION	7170107 (QTY.1) – Bulletin Completion Decal
PARTS AVAILABILITY	N/A – Inspection Only
DIRECT-SHIP FROM POLARIS?	No
TO BE ORDERED BY DEALER?	Yes – Order Bulletin Completion decals through normal parts channels

PART NUMBER / DESCRIPTION	3280593 (QTY.1) – Fuel Gauge Assembly
PARTS AVAILABILITY	Available to Order
DIRECT-SHIP FROM POLARIS?	No
TO BE ORDERED BY DEALER?	Yes – Order Bulletin Completion part through normal parts channels

WARRANTY CLAIM INFORMATION:

A single group claim may be submitted listing the complete (17 digit) Vehicle Identification Number for machines with the same model number. File claim type **SB (Service Bulletin)**. DO NOT PUT MORE THAN ONE MODEL NUMBER ON A CLAIM.

SERVICE BULLETIN #	I-15-02A Inspection Only
CLAIM TYPE	SB (Service Bulletin)
LABOR ALLOWANCE	12 Minutes (0.2 Hours)
CLAIM PART NUMBERS	N/A – Auto Process Bulletin
BULLETIN EXPIRATION DATE	Service Bulletin I-15-XX will expire on 05/30/2016.

SERVICE BULLETIN #	I-15-02B Inspection and Gauge Replacement
CLAIM TYPE	SB (Service Bulletin)
LABOR ALLOWANCE	18 Minutes (0.3 Hours)
CLAIM PART NUMBERS	N/A – Auto Process Bulletin
BULLETIN EXPIRATION DATE	Service Bulletin I-15-02A/B will expire on 05/30/2016.

CUSTOMER NOTIFICATION:

Dealers are required to notify owners of motorcycles sold by their dealership, and to make arrangements to perform this bulletin repair immediately.

SERVICE BULLETIN COMPLETION DECAL:

A Service Bulletin Completion Decal must be completed for this bulletin repair. Place the decal on the unit as shown (inside LH upper side cover). If you require more decals, order them through normal parts ordering channels.

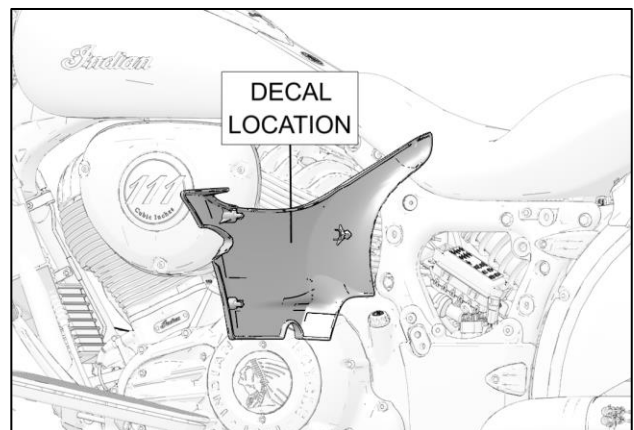

Sincerely,

Doug Koch

Doug Koch,
 Technical Service and Warranty Manager

FUEL GAUGE REPLACEMENT PROCEDURE:

1. Place motorcycle on side stand on a level surface. Working from the right side of the motorcycle, pull side panel corners outward evenly to disengage each tab from the rubber grommet in frame.

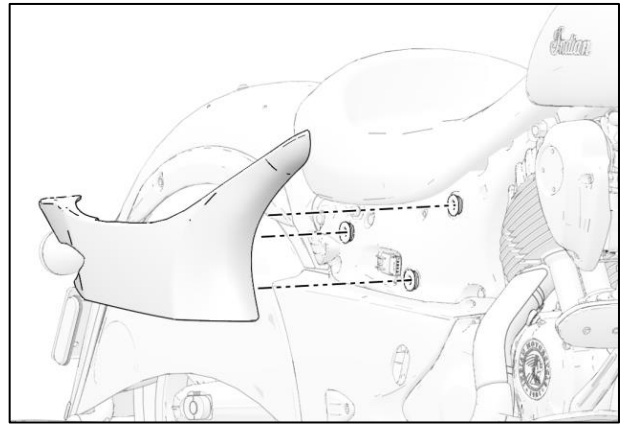

2. Working from the left side of the motorcycle, pull side panel corners outward evenly to disengage each tab from the rubber grommet in frame.

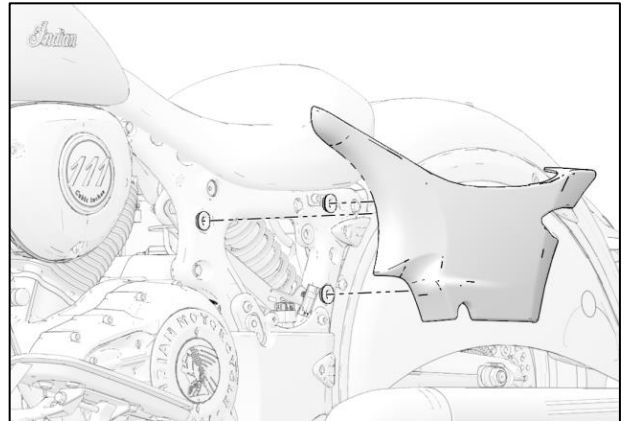

3. Remove the seat fasteners (1) and (2). Lift the rear of the seat and pull rearward to disengage front retainer arms from the bracket behind the fuel tank. Disconnect negative battery cable at battery.

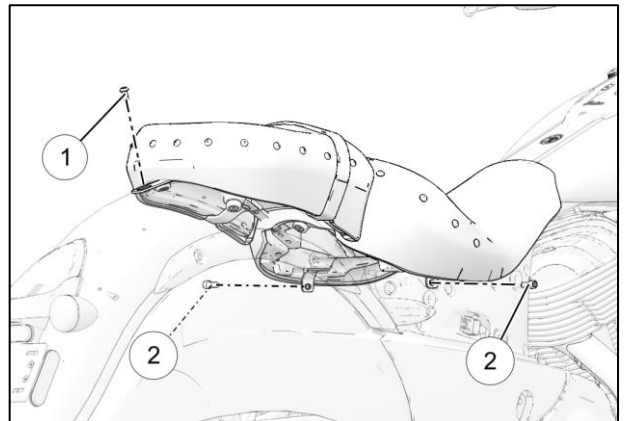

4. Remove the two fasteners (3) securing the console to the fuel tank. Protect cosmetic surfaces and lift the console to disconnect the system power switch, instrument cluster, fuel gauge and accessory switch connectors.

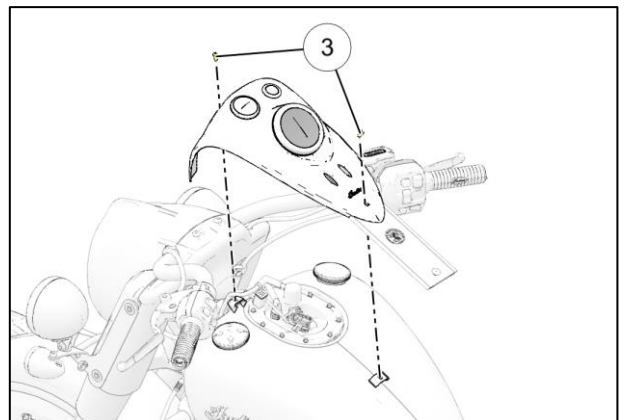

5. Place the console assembly facing down on a protective surface and remove the fuel gauge retainer nuts (4), retainer (5) and fuel gauge (6) from the console.

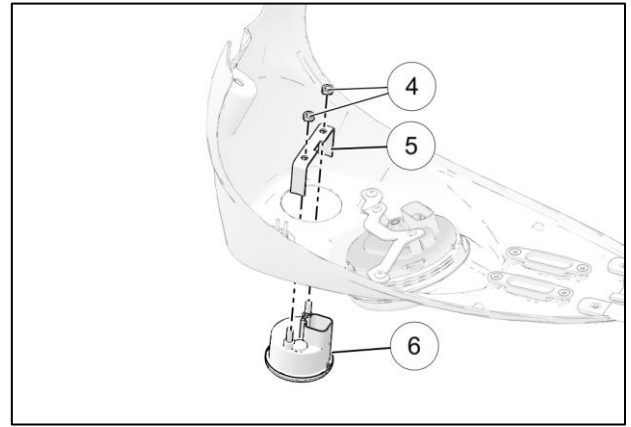

6. Insert the replacement fuel gauge (7) into the console opening. Install the fuel gauge retainer (8) and tighten the retainer nuts (9) to 24 inch lbs. (2.7 Nm)

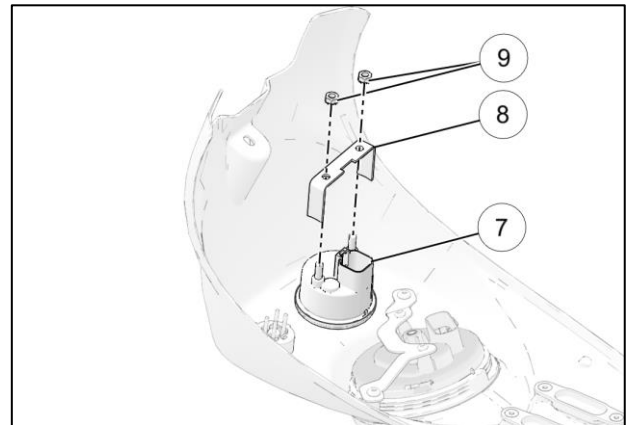

7. Connect the electrical connectors. Install the console assembly and tighten screws (10) to 84 inch lbs. (9.5 Nm).

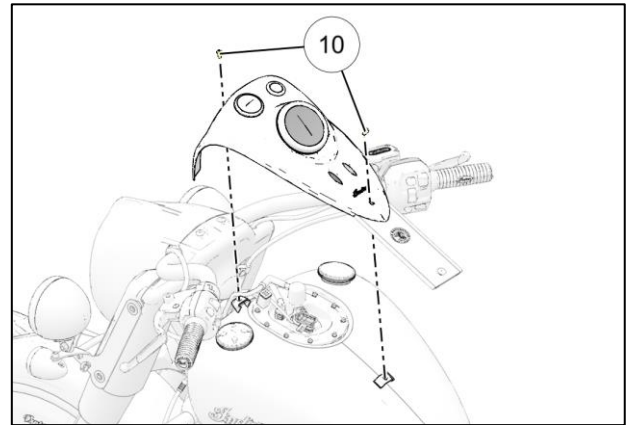

8. Connect the negative battery terminal. Tighten battery terminal fastener to 36 in-lbs (4.1 Nm). Install the seat fasteners (11) and (12). Tighten seat fasteners to 96 inch lbs. (10.8 Nm).

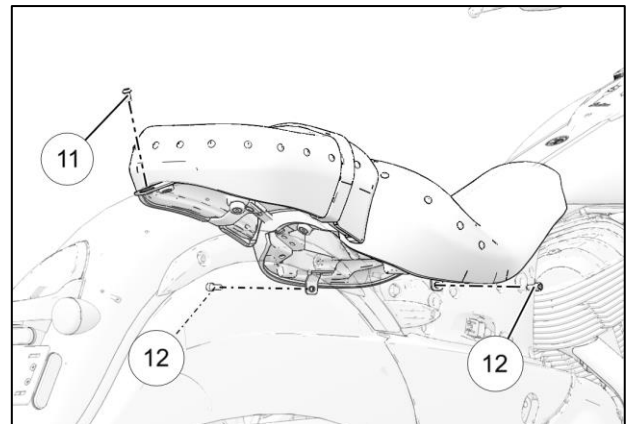

9. Install the right upper side panel by carefully seating the corner tabs into each rubber grommet in the frame.

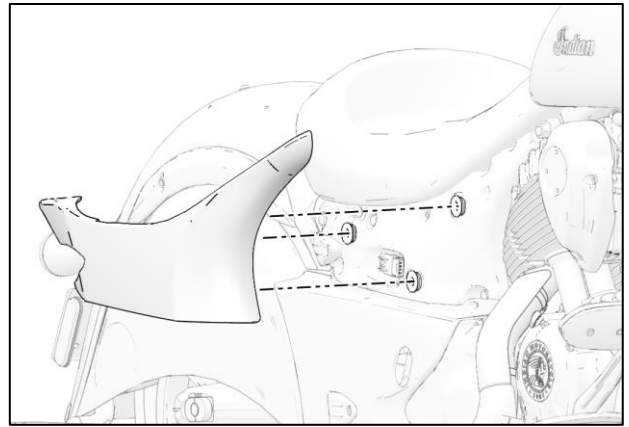

10. Place the bulletin completion sticker inside left upper side panel. Install the left upper side panel by carefully seating the corner tabs into each rubber grommet in the frame.

