



SUBJECT: 2015 Indian Roadmaster – Trunk Does Not Unlock With the Key Fob

PURPOSE:

Indian Motorcycle has determined that some 2015 Roadmaster motorcycles may develop a condition where the trunk cannot be unlocked using the button on the key fob, but can still be unlocked using the key. This may occur if the cable was kinked during installation and has become disengaged from the lock actuator.

This Team Tip will cover the following topics:

- Trunk Lock Overview / Diagnosis
- How to open the trunk if the key is not available
- Parts & Warranty Information

TRUNK LOCK OVERVIEW / DIAGNOSIS

The Roadmaster trunk can be locked and unlocked using two methods; the buttons on the key fob (cable and actuator) and the hard key (tumbler). If you receive a customer complaint regarding trunk operation and confirm the trunk can only be unlocked manually with the key, the following inspections should be performed:

1. Press the LOCK / UNLOCK buttons on the key fob to verify that the actuator cycles.
NOTE: If the actuator does not cycle, make sure the trunk electrical connector is engaged and the key fob battery is good. (see Owner's Manual)
2. Unlock the trunk using the key (if available) and open the trunk lid.
3. Remove the trunk liner ① by lifting it out of the trunk base.

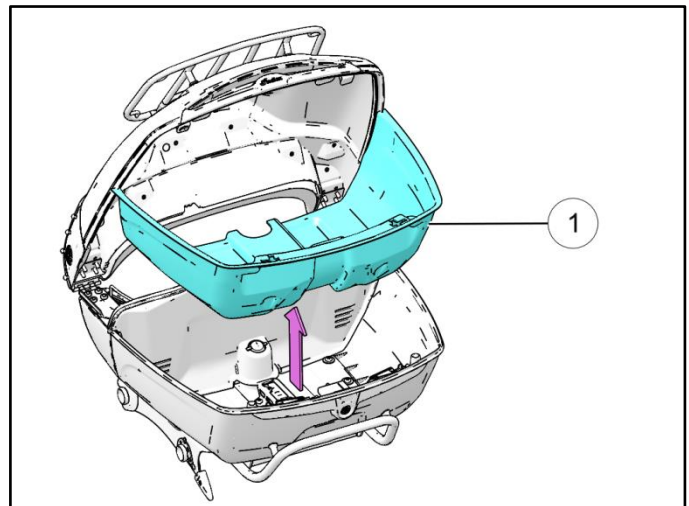

4. Inspect the Lock Actuator (2) and the Actuator Cable (3) to verify they are still connected.
5. If the cable has become disengaged from the actuator, replace the lock / cable assembly using the updated part. (PN: 4015684)

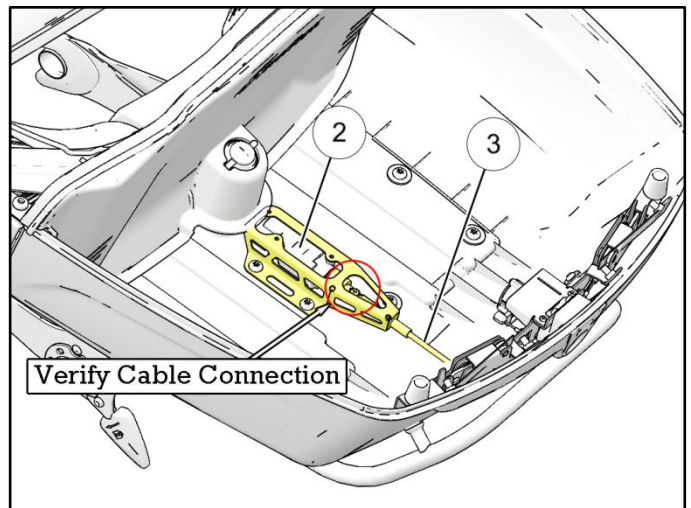

OPENING THE TRUNK IF THE KEY IS NOT AVAILABLE

NOTE: If the key is not available or has been locked inside the trunk, it will be necessary to break the lower chrome bezel off in order to open the trunk lid. Care must be used while prying the bezel off of the trunk base so the paint is not damaged.

1. Insert a flat screwdriver (or similar tool) into the relief slots (4) located on the left and right sides of the lower bezel. Carefully pry bezel outward to release adhesive.

CAUTION: Two screw bosses, located above the lock tumbler must be broken off to fully remove the lower bezel from the trunk.

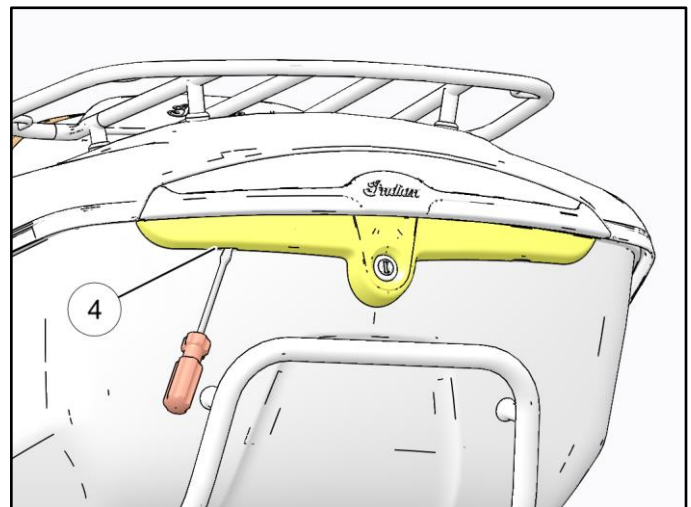

2. With the lower bezel removed from the trunk, remove the four screws (5).

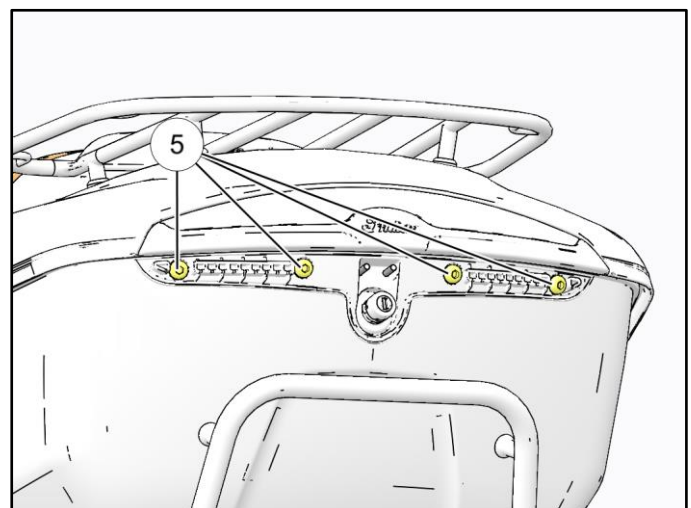

3. Lift the trunk lid enough to depress the latch actuators as shown and fully open the lid.
4. Refer to the 2014-2016 Indian Motorcycle (Full-Size) Service Manual for trunk lock and actuator replacement.

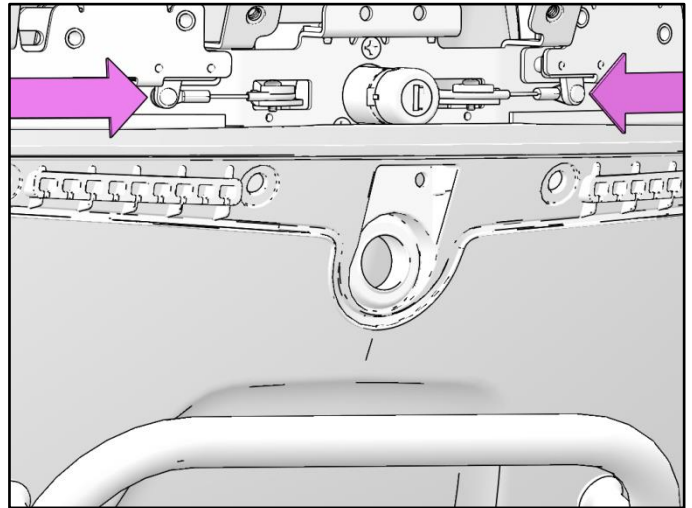

PARTS & WARRANTY INFORMATION

Lock actuator and, if necessary, bezel replacement are covered under the factory 2-year warranty period. Should you encounter this issue, a **Standard Warranty Claim** should be filed.

Use Fail Codes: **140/281/152**

Actuator Replacement Using Key to Unlock Trunk

- 2205864 (QTY.1) Bezel, Adhesive Kit
- 4015684 (QTY.1) Lock Actuator / Cable Assembly

Actuator Replacement without Key

- 5450922-156 (QTY.1) Lock Bezel, Chrome
- 4015684 (QTY.1) Lock Actuator / Cable Assembly
- 7520140 (QTY.2) Screw, Lock Bezel