

Measure no.

US 59759165-04

Subject

Rattle noise from transmission

Status date (mm/dd/yy)

11/24/15

Status

Accepted

Organization

US, MOT

Date created (mm/dd/yy)

11/24/15

Created by

Carsten Gruetzmacher

PQM Problem reference**Release date (mm/dd/yy)****Approved by****Dealer release**

Allow automatic release

Vehicles affected**E series**

K70/11 K71/11 K72/11 K73/02

Engine

K75

Body**Production period (from/to)**

(mm/dd/yy)

/

Comment on production period**Feedback (all cases relating to****measure up to) (mm/dd/yy)****Complaint**

Transmission rattles when the engine is at operating temperature and idling.

The noise disappears when the clutch is operated.

Cause

A gear has an extra margin of radial play on the transmission input shaft.

Measure

IMPORTANT: The gearbox is not faulty and the extra margin of play does not cause additional wear or damage. As such, the vehicle 'operates as designed' and can continue to be used 'as is'. Note; noise, in and of itself, is not a defect. However - if this noise rises to the level of a customer complaint, verified by BMW certified technician and confirmed via puma exchange, the input shaft and 1st gear is to be replaced with "REPAIR KIT GEAR WHEELS 1ST GEAR ", item No.13 in the accompanying picture.

Refer to latest ETK for model specific part number.

This repair is on a case by case basis, applicable within the scope of the original warranty

Complaint

Fault location	Fault type	Fault place	Fault conditions
Idle speed	Rattling noise (disturbing noise)	Bottom	Engine temperature: Hot

Cause

#	Fault location	Fault type	Fault place
1	23/00 Transmission shafts		
	Repair Task	Special Clearance	Area
	Replace	No	Powertrain

Fault code

Progman / DIS / ISTA / ISTA/P

System	State	Version
---------------	--------------	----------------

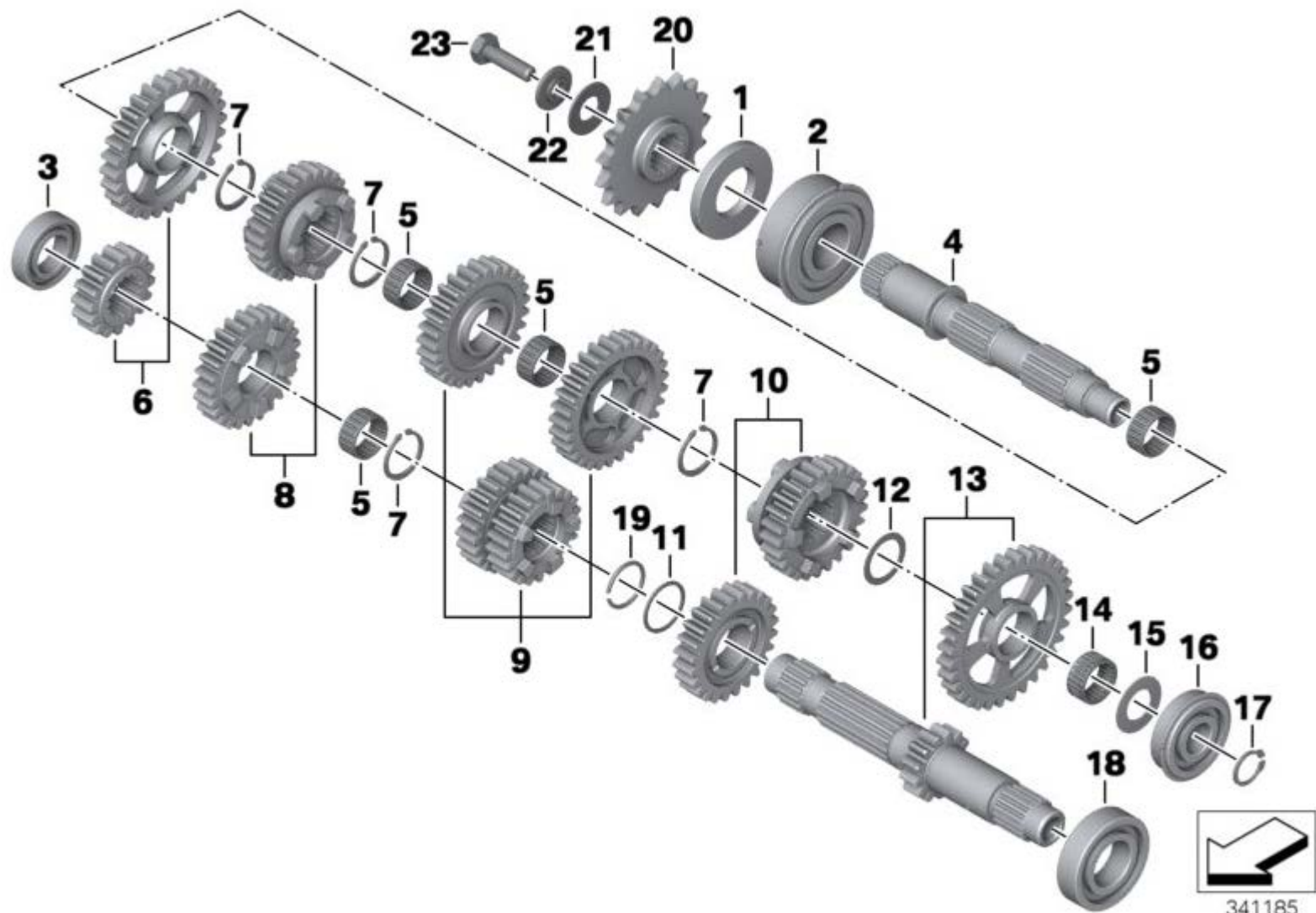

341185