

Date: 13.08.2015 Model: Elise & 4/6 Cylinder Exige with Central Locking from Start of Production to '15MY VIN 11652 Number: 2015/08 Issue 2

Copy files should be maintained by:

Service Manager	Service Reception	Lotus Technicians	Parts Manager
-----------------	-------------------	-------------------	---------------

Amended due to part number correction. Please deleted original bulletin issued 10.08.2015

TITLE:

Retrofitment of the latest level CDL (Central Door Locking) actuator to earlier models if required.

REASON:

Due to parts obsolescence the CDL actuator assembly, part number B116M6039F is no longer available. This actuator was fitted into each door of any Toyota powertrain Elise and 4/6 cylinder Exiges from start of production up to '15MY VIN F__11652 equipped with central locking.

A production running change has been implemented from '15MY VIN F__11653 to fit a new CDL actuator, part number A138M0087F on any Elise/Exige S specified with central locking.

The method of fixing the new actuator to the inner door shell is unchanged, but it has been repositioned to allow for its different dimensions and electrical connections as compared to the original actuator.

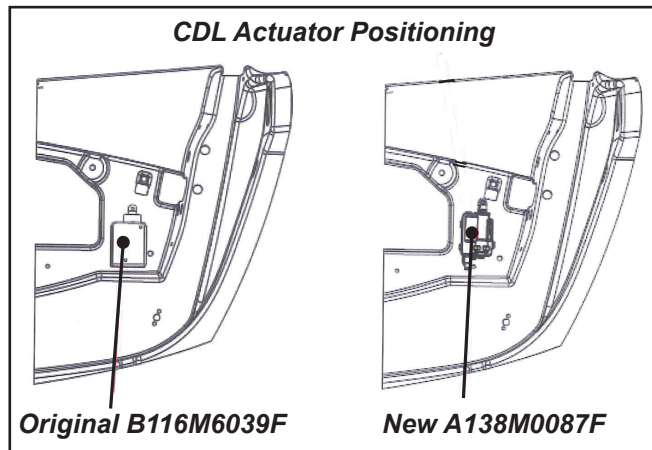

The repositioning of the new actuator also means that the length/profile of the original door sill rod (original part number A117U0329F) linking the actuator to the door latch mechanism has altered requiring a modified link rod to be fitted, part number (A120U0240F).

A fly lead (part number A138M0097F) linking the door harnesses electrical connector to the new actuator is also fitted but will be deleted at a future date with the introduction of a new door harness incorporating the correct connector block which will also fitted as a running change.

ACTION:

In the event that renewal of a CDL actuator is required for a vehicle currently fitted with the obsolete B116M6039F part number actuator, then the new production running change actuator must be fitted in conjunction with the fly lead adaptor, new door sill rod and fixing screws.

Parts Required For Retrofitment

Description	Part Number	Qty/Door
CDL Actuator	A138M0087F	1
Fly lead Adaptor	A138M0097F	1
Rod, CDL actuator to Sill Button	A120U0240F	1
No 8 x 1 Pan Pozi Self Tapping Screws	A075W5039Z	2

Continued.....

LOTUS CARS LIMITED

Retrofitment procedure

1. Remove the CDL actuator, door latch and door sill link rod as necessary; refer to service notes sections BR.15 (Elise/4-cylinder Exige) or BT.12 (Exige S) for further information.
2. Print off a copy of LSL639 - CDL Actuator Location Template. A copy is attached to page 4 of this bulletin but also available to download from the Lotus Dealer Portal in >After sales>Miscellaneous Technical Information >Instructional Guides.

3. Once printed ensure that the template scale of 1:1 is correct by measuring the distance between the alignment holes ensuring that they are exactly the same measurements as the figures printed on the template itself, (if necessary adjust the scale size on your printer/photocopier until the correct scale is achieved).

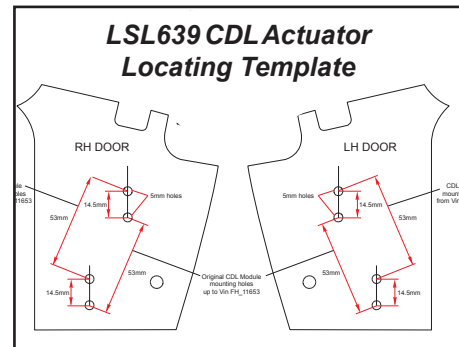

4. Once printed to the correct size pierce 5mm diameter holes in the 'A' datum points of the template (these indicate the fixing point positioning for the screw retaining holes in the door shell which fixed the original B116M0039F CDL actuator to the door shell).

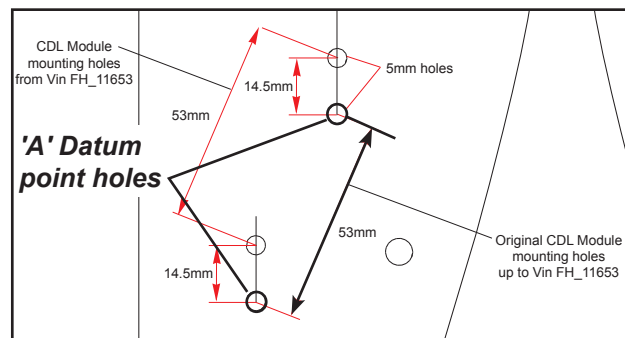

5. Align the templates 'A' datum hole fixing points with the original fixing point holes on the inner door shell panel. Fit the template in the correct position by passing 5mm diameter bolts/screws through the template holes and into the fixing point holes on the door shell and then retain the template to the door with masking tape for additional security.

Note: if both 'A' datum points on the template do not align with the CDL actuator fixing point holes on the door shell then check the template has been printed off to the correct scale.

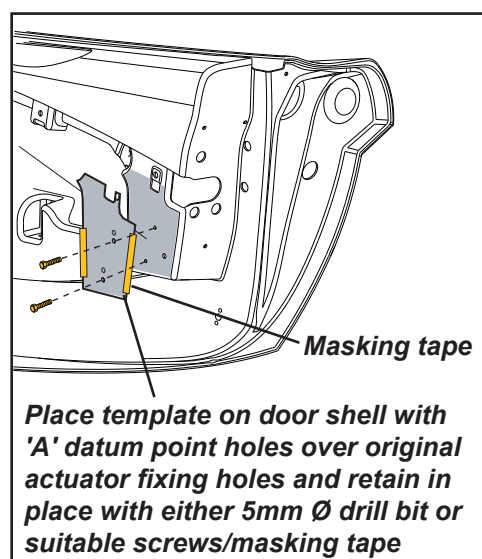

6. With the template in place mark the revised fixing points on the door shell for the new actuator assembly piercing the centre of the 'B' datum points of the template using a suitable scriber/marketing tool, ensuring that the marks made pass through the template and are visible on the door shell.

Continued.....

LOTUS CARS LIMITED

7. Either remove the template or keep it in position and using a 5mm drill bit, drill out 2 new fixing holes in the 'B' datum point template positions.

Carepoint: ensure to only drill through a sufficient distance to pass through the inner panel. Excessive drilling may cause damage to ancillary components within the door shell.

8. Remove the template and clean out any swarf or debris from within the door shell assembly that may have been produced from the drilling action.

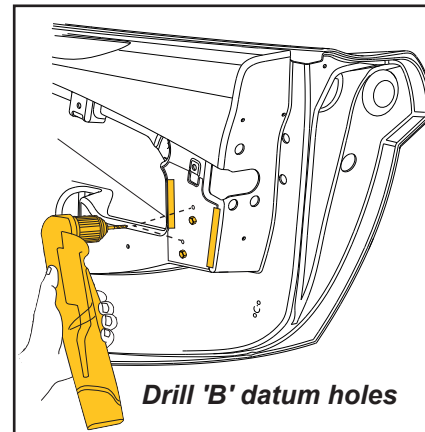

9. Assemble the new door sill link rod, original latch, new CDL actuator and door harness flylead together (ensuring to thread link rod through the inner most hole on the door latch lever).
10. Refit the assembly into the door panel, securing the latch to the door panel using its original fixings.
11. Connect the flylead to the main door harness connector.
12. Using the 2 x No8 x 1 self tapping screws fix the actuator assembly to the inner door panel.
13. Test the operation of the central door locking system before refitting the door trim panel.

CHARGES:

Additional warranty costs apply only for the service replacement parts listed on page 1 of this bulletin (but only if the CDL actuator is being renewed under the terms of the vehicle warranty)

No additional labour costs over and above the current time allowance for operation code 10.17.08-02 or 10.17.09-02 (CDL actuator LH or RH renewal) as shown in the '04 MY onwards Elise/Exige Labour Time Guide are associated with the contents of this bulletin.

Ends.

LOTUS CARS LIMITED

CDL Module Locating Template

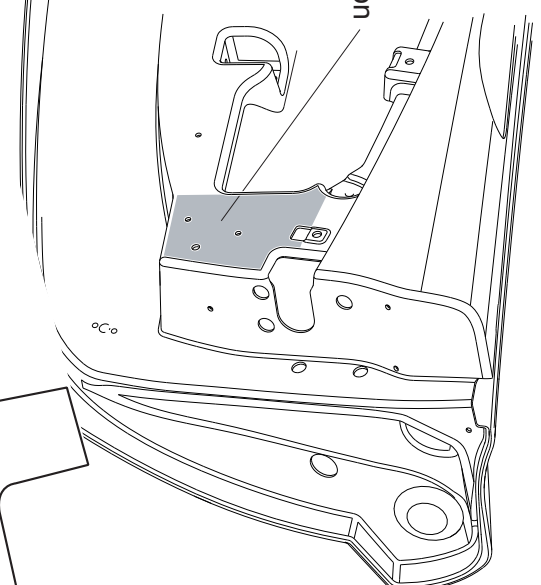

IMPORTANT: To ensure the new fixing holes are drilled in the correct position on the door panel it is critical that this template is printed to 1:1 scale with the distance between the centre of fixing holes matching the measurements displayed on the template.

