



# SCION iM

## 2016 PRE-DELIVERY SERVICE CHECK SHEET

August 2015

BEFORE INSPECTION		OK	Adjust Repair
1 Install D/C Cut Fuse (see page 2).....		<input type="checkbox"/>	
FUNCTIONAL OPERATION			
<i>Apply parking brake and cycle ignition "IG-ON"; place gear selector in reverse; turn on lights and rear defogger. Unlock all doors, release fuel door, release trunk hatch.</i>			
1 Check dome, courtesy, map, and sun visor lights*.....	<input type="checkbox"/>	<input type="checkbox"/>	
2 Check warning/indicator lights, gauges, and horn.....	<input type="checkbox"/>	<input type="checkbox"/>	
3 Check windshield wipers and washers.....	<input type="checkbox"/>	<input type="checkbox"/>	
4 Check headlights, instrument lights, turn signals, emergency flashers, and brake lights .....	<input type="checkbox"/>	<input type="checkbox"/>	
5 Check inside/outside rear view mirror operation/adjustment.....	<input type="checkbox"/>	<input type="checkbox"/>	
6 Check power outlet and cigarette lighter*.....	<input type="checkbox"/>	<input type="checkbox"/>	
7 Check audio/navigation* systems and set vehicle to iM.....	<input type="checkbox"/>	<input type="checkbox"/>	
8 Install shift-lock override button cover.....	<input type="checkbox"/>	<input type="checkbox"/>	
9 Check sliding roof* .....	<input type="checkbox"/>	<input type="checkbox"/>	
10 Set clock to local time .....	<input type="checkbox"/>	<input type="checkbox"/>	
WALKAROUND INSPECTION			
<i>Starting at the left front door, check window and door lock operation. Continue around the vehicle in a counterclockwise direction checking each door and window operation, child door locks, seat belts, interior condition, all lights, and luggage compartment contents. Finish by checking headlight aim and continue into Under Hood checks.</i>			
1 Check door and door lock operation, including each wireless remote control/theft deterrent system*.....	<input type="checkbox"/>	<input type="checkbox"/>	
2 Check power window operation.....	<input type="checkbox"/>	<input type="checkbox"/>	
3 Check that engine starts with all keys .....	<input type="checkbox"/>	<input type="checkbox"/>	
4 Check seats and seat belt operation.....	<input type="checkbox"/>	<input type="checkbox"/>	
5 Check rear defogger.....	<input type="checkbox"/>	<input type="checkbox"/>	
6 Check side marker, tail, backup, and license plate lights .....	<input type="checkbox"/>	<input type="checkbox"/>	
7 Check rear hatch/cargo area trim appearance.....	<input type="checkbox"/>	<input type="checkbox"/>	
8 Adjust spare tire pressure, inspect for damage, and check jack and tool installation.....	<input type="checkbox"/>	<input type="checkbox"/>	
9 Check headlight aim.....	<input type="checkbox"/>	<input type="checkbox"/>	
UNDER HOOD			
1 Check engine oil level.....	<input type="checkbox"/>	<input type="checkbox"/>	
2 Check brake and clutch* fluid levels.....	<input type="checkbox"/>	<input type="checkbox"/>	
3 Check engine coolant level .....	<input type="checkbox"/>	<input type="checkbox"/>	
4 Check windshield washer fluid level.....	<input type="checkbox"/>	<input type="checkbox"/>	
5 Check battery state-of-charge using Digital Battery System Analyzer (SOC Reading: _____%) .....	<input type="checkbox"/>	<input type="checkbox"/>	
6 Inspect for fuel, oil, coolant, and other fluid leaks.....	<input type="checkbox"/>	<input type="checkbox"/>	
* Inspect or install when equipped/required.			

UNDER VEHICLE (ON HOIST)		OK	Adjust Repair
1 Remove disc brake anti-rust covers/anti-corrosion wheel film*.....		<input type="checkbox"/>	
2 Initialize Tire Pressure Warning System (TPWS) (See page 2).....		<input type="checkbox"/>	<input type="checkbox"/>
3 Inspect tires for defects/damage.....		<input type="checkbox"/>	<input type="checkbox"/>
4 Install wheel covers/caps/spare tire wheel covers*.....		<input type="checkbox"/>	<input type="checkbox"/>
5 Install rubber body plugs.....		<input type="checkbox"/>	<input type="checkbox"/>
6 Inspect for fuel, oil, coolant, and other fluid leaks .....		<input type="checkbox"/>	<input type="checkbox"/>
7 Visually check bolts and nuts on chassis and powertrain for looseness.....		<input type="checkbox"/>	<input type="checkbox"/>
8 Inspect under the vehicle for damage, rust, etc.....		<input type="checkbox"/>	<input type="checkbox"/>
ROAD TEST			
<i>A complete road test helps assure customer satisfaction. Drive vehicle over a variety of road surfaces and driving conditions. Check for unusual noise and driving performance.</i>			
Enter Odometer Readings			
Reading Before Test: _____ Reading After Test: _____			
1 Check cold engine operation .....	<input type="checkbox"/>	<input type="checkbox"/>	
2 Check engine operation during warm-up .....	<input type="checkbox"/>	<input type="checkbox"/>	
3 Check engine at normal operating temperature .....	<input type="checkbox"/>	<input type="checkbox"/>	
4 Check transmission operation.....	<input type="checkbox"/>	<input type="checkbox"/>	
5 Check brake and parking brake operation .....	<input type="checkbox"/>	<input type="checkbox"/>	
6 Check steering operation and off-center/vehicle pull/flutter .....	<input type="checkbox"/>	<input type="checkbox"/>	
7 Inspect for abnormal noise and vibration .....	<input type="checkbox"/>	<input type="checkbox"/>	
8 Inspect for squeaks and rattles .....	<input type="checkbox"/>	<input type="checkbox"/>	
9 Check heater and A/C operation.....	<input type="checkbox"/>	<input type="checkbox"/>	
10 Check speedometer operation.....	<input type="checkbox"/>	<input type="checkbox"/>	
11 Check cruise control operation.....	<input type="checkbox"/>	<input type="checkbox"/>	
FINAL INSPECTION AND CLEANING			
1 Remove interior protective covers, unnecessary labels, tags, etc. (Remove just before delivery to customer) .....	<input type="checkbox"/>		
2 Verify floor mat application and install using retaining clips*.....	<input type="checkbox"/>	<input type="checkbox"/>	
3 Visually inspect all interior parts for installation, damage, fit, dirt, etc.....	<input type="checkbox"/>	<input type="checkbox"/>	
4 Remove Rappard™ and clear protective bumper film*.....	<input type="checkbox"/>		
5 Wash and clean vehicle.....	<input type="checkbox"/>		
6 Inspect paint finish for scratches, chips, rust, dents, damage, etc.....	<input type="checkbox"/>	<input type="checkbox"/>	
7 Inspect exterior body parts for proper installation, damage, rust, etc.....	<input type="checkbox"/>	<input type="checkbox"/>	
8 Place Owners Guide and first aid kit portfolio* in glove box .....	<input type="checkbox"/>		
9 Place oil change sticker on inside of windshield, top left corner.....	<input type="checkbox"/>		
10 Perform Techstream Health Check.....	<input type="checkbox"/>		
11 Install front license plate and mounting bracket* (see page 2).....	<input type="checkbox"/>		

Completion and retention of this form is required to comply with Toyota's Warranty Policy.

TECHNICIAN'S SIGNATURE

SERVICE MANAGER'S SIGNATURE

NAME (PLEASE PRINT)

NAME (PLEASE PRINT)

**We hereby certify that all items on this form have been checked and corrected for proper operation as required.**

Date

Dealer Name

Dealer Code

Vehicle Identification Number (Sticker)

## D/C CUT FUSE INSTALLATION

To minimize battery discharge the D/C Cut Fuse has been removed and is stored in the engine compartment Relay Block. Install the D/C Cut Fuse and confirm all related DTCs are cleared.

### DTC Clearing Procedure

1. Connect Techstream.
2. Cycle the ignition switch to the "IG-ON" position.
3. Using Techstream, check any other codes being output.
4. Erase DTCs (B1650 & B1794) and Freeze Frame Data.

#### NOTE

If any DTCs besides B1650 & B1794 appear, repair the applicable system according to the Repair Manual.

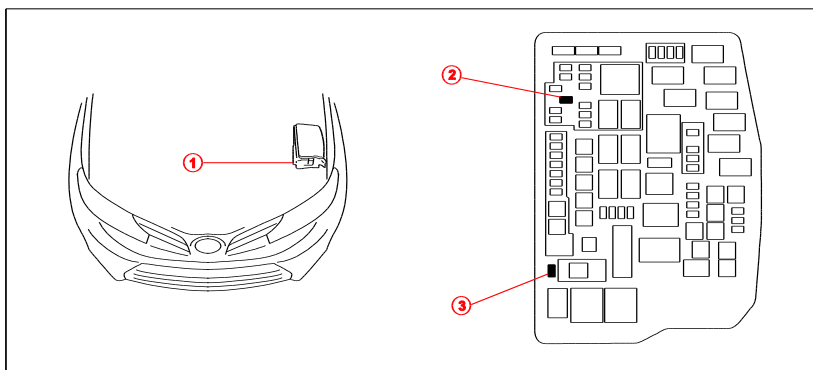

1	Relay Block
2	Install D/C Cut Fuse (30A) here (Original Location)

3	Remove D/C Cut Fuse (30A)
---	---------------------------

## TPWS INITIALIZATION

Refer to the Repair Manual for the [Initialization procedure](#). Please note the spare tire does NOT have a TPWS sensor.

#### NOTE

To adjust the tire pressure correctly when the outside temperature is significantly colder than shop temperature, perform a Health Check using Techstream and select the "Compensation Tire Pressure" checkbox. Compensation pressures will be displayed on the Health Check results screen. Adjust the tire pressure when the tires are cold.

## FRONT LICENSE PLATE & MOUNTING BRACKET INSTALLATION\*

For states that require a front license plate, please install per this procedure. The bracket and self-tapping screws are stored in the luggage compartment.

### Installation Procedure

1. Align holes "A" of the mounting bracket with the dimples on the front bumper cover. Mark the locations of holes "B" on the front bumper cover.

#### NOTE

Holes "A" are used for the installation of the mounting bracket to the front bumper cover.  
Holes "B" are used for the installation of the front license plate to the mounting bracket.

2. Align holes "A" of the mounting bracket with the dimples on the front bumper cover. Mark the locations of holes "B" on the front bumper cover.

#### NOTICE

Do NOT drill into the dimples of the front bumper cover.

3. Drill 2 relief holes with a diameter of 11 mm (0.43 in.) at holes "B" on the front bumper cover. This will prevent the license plate retaining bolt ends from contacting the bumper cover.
4. Install the mounting bracket to the front bumper cover using the 2 self-tapping screws provided.
5. Install the front license plate to the mounting bracket using 2 non-corroding bolts with the following dimensions.

**Nominal Length: 15.0 mm (0.59 in)**

**Diameter: 6.0 mm (0.24 in)**

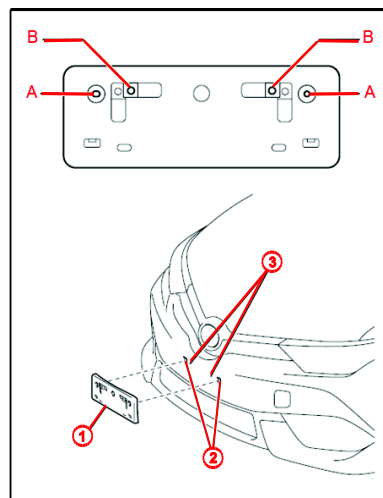

1	Mounting Bracket
2	Dimples
3	Mark and Drill Holes

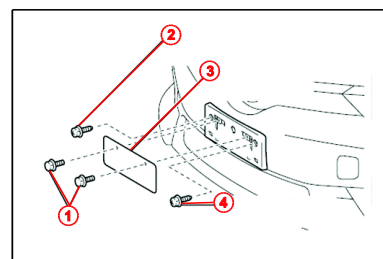

1	Bolts
2	Tapping Screw
3	License Plate
4	Tapping Screw