

Front License Plate & Mounting Bracket Installation

Service Category General

Section Pre-Delivery Service

Market USA

Lexus Supports
ASE Certification 

Applicability

| YEAR(S) | MODEL(S) | ADDITIONAL INFORMATION |
|---------|---------------|------------------------|
| 2016 | ES300H, ES350 | |

Introduction

The front license plate mounting bracket and 2 self-tapping screws for the 2016 model year ES 350 and ES 300h are stored in the luggage compartment of the vehicle. Install the license plate and mounting bracket during Pre-Delivery Service (PDS).

Warranty Information

| OP CODE | DESCRIPTION | TIME | OFP | T1 | T2 |
|---------|----------------------------|------|-----|----|----|
| N/A | Not Applicable to Warranty | – | – | – | – |

Front License Plate & Mounting Bracket Installation

Installation Procedure

1. Align the holes "A" of the front license plate mounting bracket with the dimples on the radiator grill.

HINT

- Holes "A" are used for installation of the front license plate mounting bracket to the radiator grill.
- Holes "B" are used for installation of the front license plate to the mounting bracket.

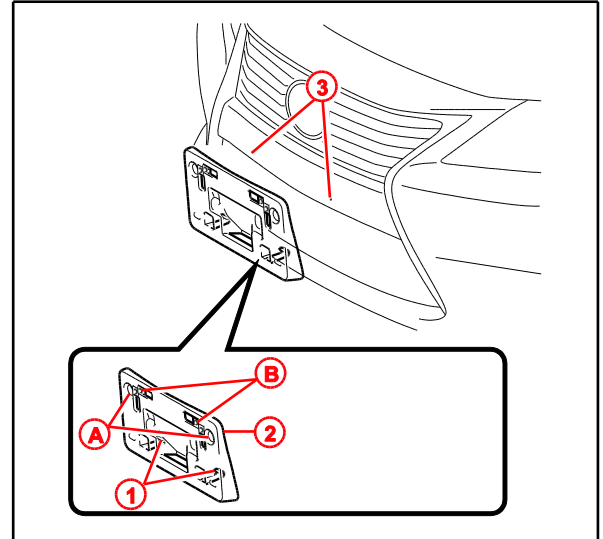

| | |
|---|------------------|
| 1 | Hooks |
| 2 | Mounting Bracket |
| 3 | Dimples |

2. Attach the hooks of the front license plate mounting bracket to the air intake of the radiator grille and hold in place.

Front License Plate & Mounting Bracket Installation

Installation Procedure (Continued)

3. Install the front license plate mounting bracket to the radiator grille using 2 self-tapping screws.

HINT

- Tighten the passenger's side (round hole) self-tapping screw first, and then tighten the driver's side (slotted hole) self-tapping screw.
- Do NOT over-tighten the self-tapping screws.

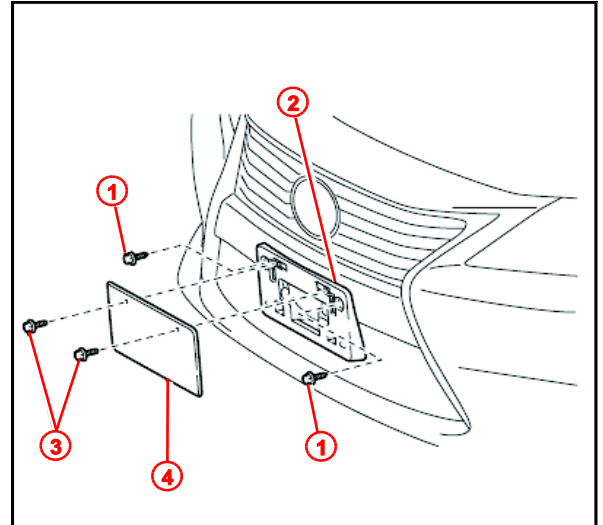

| | |
|---|--------------------|
| 1 | Self-tapping Screw |
| 2 | Mounting Bracket |
| 3 | Bolt |
| 4 | License Plate |

4. Install the front license plate to the mounting bracket using 2 non-corroding bolts.

Nominal Length: 15.0 mm (0.59 in.)
Diameter: 6.0 mm (0.24 in.)

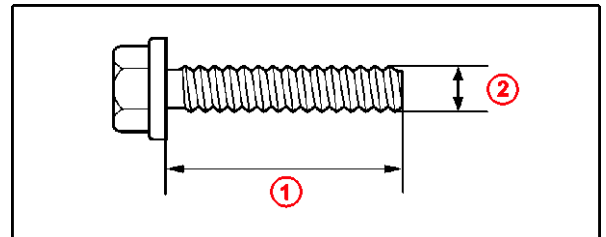

| | |
|---|----------------|
| 1 | Nominal Length |
| 2 | Diameter |