

Initialization of Seat ECUs During PDS

Service Category General

Section Pre-Delivery Service

Market USA

Lexus Supports ASE Certification 

Applicability

YEAR(S)	MODEL(S)	ADDITIONAL INFORMATION
2015	RC F, RC350	

Introduction

As a result of the removal of the D/C Cut fuse, the driving position memory function of the driver and passenger seats will be inoperative due to loss of the seat position memory stored in the seat ECUs. Initialize both front memory seat ECUs after installing the D/C Cut fuse during Pre-Delivery Service (PDS).

Figure 1.

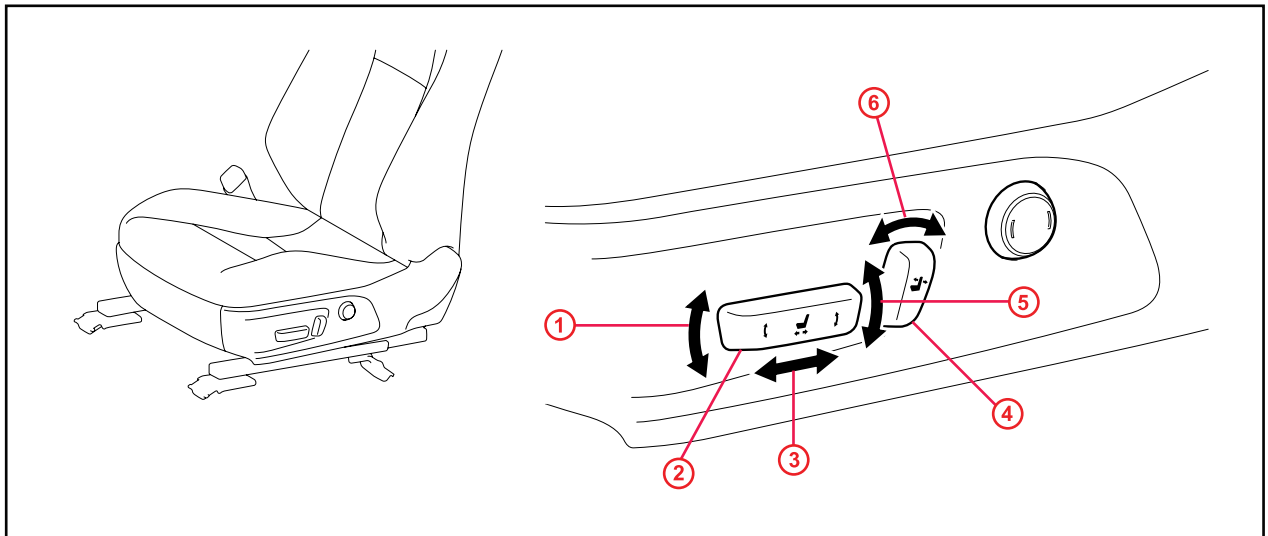

1	Vertical Function
2	Slide and Vertical Power Seat Switch
3	Slide Function

4	Reclining Power Seat Switch
5	Lifter Function
6	Reclining Function

Warranty Information

OP CODE	DESCRIPTION	TIME	OFP	T1	T2
N/A	Not Applicable to Warranty	—	—	—	—

Initialization of Seat ECUs During PDS

Driver Seat Initialization Procedure

1. Turn the engine switch "ON."
2. Operate the Slide and Vertical Power Seat Switch to tilt the power seat downward 3 times. Reference (b) in Figure 2.
3. Within 10 seconds of the previous step, simultaneously operate and hold the Reclining Power Seat Switch to recline the power seat and operate and hold the Slide and Vertical Power Seat Switch to move the power seat upward until the buzzer sounds. Reference (c) in Figure 2.

Figure 2.

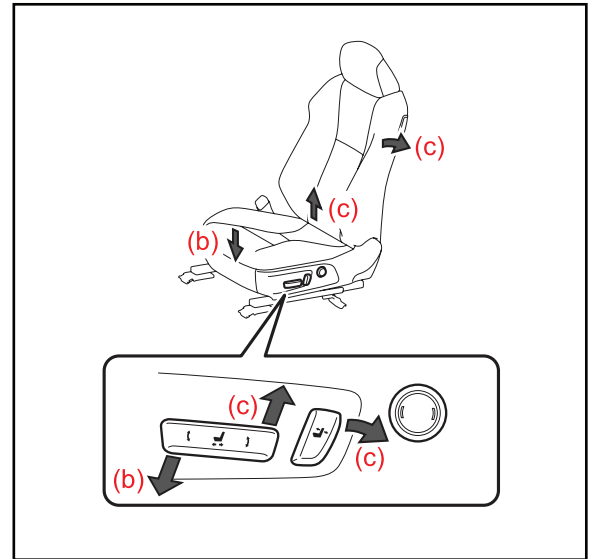

4. Operate and hold the Slide and Vertical Power Seat Switch to move the power seat to the foremost position. Reference (d) in Figure 3.

NOTE

Continue holding the Slide and Vertical Power Seat Switch for 1 second AFTER the power seat has stopped at the foremost position.

5. Operate and hold the Slide and Vertical Power Seat Switch to move the power seat to the rearmost position. Reference (e) in Figure 3.

NOTE

Continue holding the Slide and Vertical Power Seat Switch for 1 second AFTER the power seat has stopped at the rearmost position.

Figure 3.

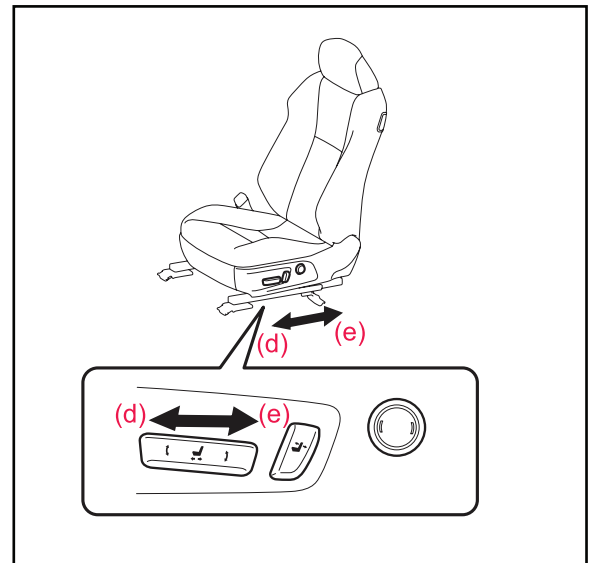

Initialization of Seat ECUs During PDS

Driver Seat Initialization Procedure (Continued)

6. Operate and hold the Slide and Vertical Power Seat Switch to move the power seat to the lowermost position. Reference (f) in Figure 4.

NOTE

Continue holding the Slide and Vertical Power Seat Switch for 1 second AFTER the power seat has stopped at the lowermost position.

Figure 4.

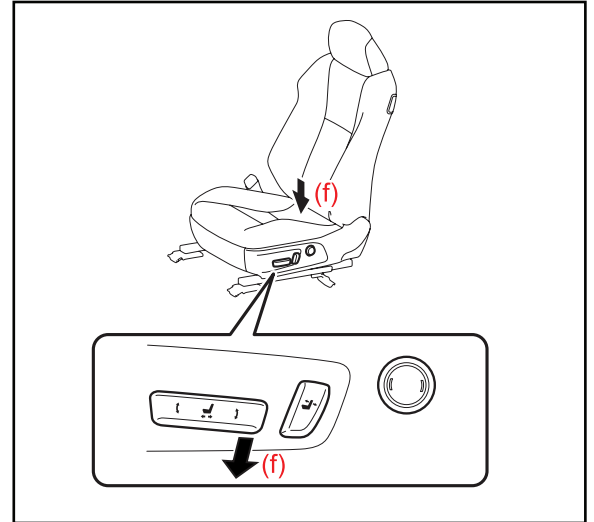

7. Pull the Reclining Remote Control Lever. After the power seat has automatically moved to the lowermost position, fold the seatback forward and check that the one-touch walk-in function operates normally.

Figure 5.

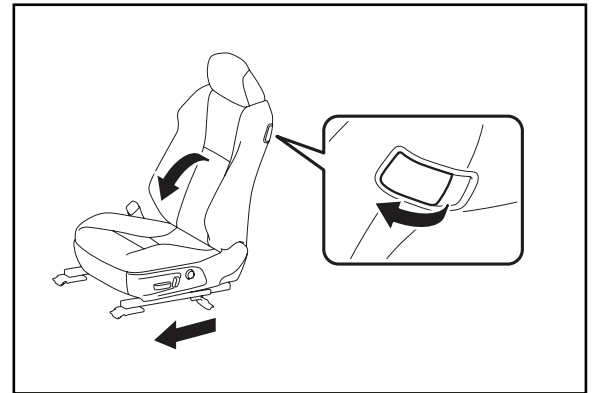

Front Passenger Seat Initialization Procedure

Initialize the front passenger seat in the same manner as the driver seat.