

1 12 05-15



Service Information Bulletin

SUBJECT	DATE
Selective Catalyst Reduction (SCR) Inlet Temperature Sensor	December 2015

Additions, Revisions, or Updates

Publication Number / Title	Platform	Section Title	Change
DDC-SVC-MAN-0083	EPA10 DD Platform	Removal Of The Selective Catalyst Reduction (SCR) Inlet Temperature Sensor	These are new sections.
		Installation Of The Selective Catalyst Reduction (SCR) Inlet Temperature Sensor	



13400 Outer Drive, West, Detroit, Michigan 48239-4001
 Telephone: 313-592-5000
www.demanddetroit.com

2 Removal of the EPA10 Selective Catalyst Reduction Inlet Temperature Sensor

Remove as follows:



WARNING: PERSONAL INJURY

To avoid injury from hot surfaces, wear protective gloves, or allow engine to cool before removing any component.

1. Shut off engine and apply the parking brake, chock the wheels, and perform any other applicable safety steps.



CAUTION: ELECTRICAL SHOCK

To avoid injury from electrical shock, use care when connecting battery cables. The magnetic switch studs are at battery voltage.

2. Disconnect the batteries.
3. If necessary, remove the passenger side fairing. Refer to OEM procedures.
4. Disconnect the Selective Catalyst Reduction (SCR) inlet temperature sensor electrical connector (2).

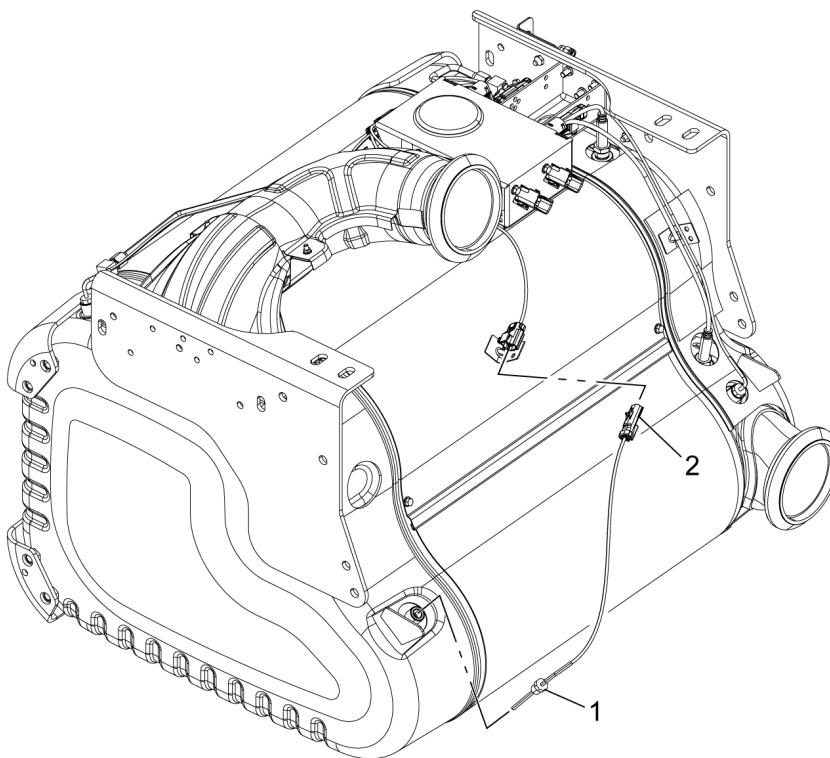

d140591

5. Remove the SCR inlet temperature sensor (1) from the 1-BOX™ configuration.

3 Installation of the EPA10 Selective Catalyst Reduction Inlet Temperature Sensor

Install as follows:

1. Apply high temp anti-seize to the threads of the sensor, but do not allow any to get on the sensor probe.

NOTICE: DO NOT use excessive amounts, anti-seize will squeeze out during installation. DO NOT over tighten sensors; damage to threads may occur.

2. Install the Selective Catalyst Reduction (SCR) inlet temperature sensor (1) to the 1-BOX™ configuration. Torque to 35 to 38 N·m (26 to 28 lb·ft).

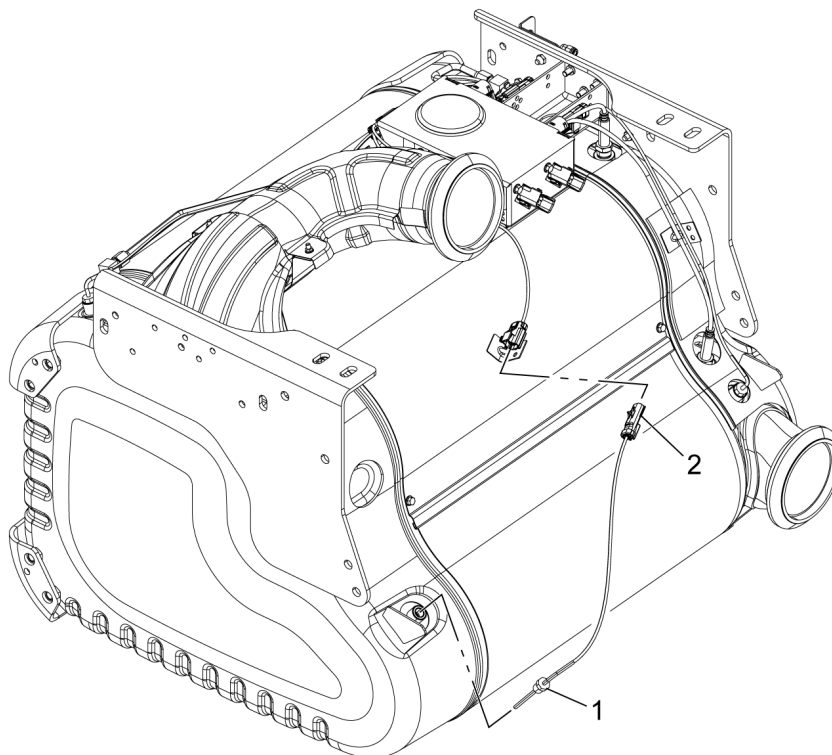

d140591

3. Connect the SCR inlet temperature sensor electrical connector (2).



CAUTION: ELECTRICAL SHOCK

To avoid injury from electrical shock, use care when connecting battery cables. The magnetic switch studs are at battery voltage.

NOTICE: Incorrect routing and attaching of the sensor harness at OEM attachment points may lead to harness damage.

4. Connect the batteries. Refer to OEM procedures.
5. If removed, install the passenger side fairing. Refer to OEM procedures.