

FLA COE
FLB COE
FLD Conventional
Business Class
FLC 112 Conventional

Century Class Conventional
Argosy COE
Cargo
Columbia

> 122SD and Coronado
Business Class M2
Cascadia
108SD/114SD

**Freightliner
Service Bulletin**

General Information

Coronado 122 and 132 vehicles built before July 8, 2013 have hood tilt-assist struts with 8-mm rod ends. Vehicles built after July 8, 2013 have struts with larger 10-mm rod ends. If a strut with an 8-mm rod end fails, replace both struts with the larger 10-mm version. When replacing 8-mm struts with 10-mm struts, new mounting brackets are required. Use the procedure in this bulletin to replace the tilt-assist struts and mounting brackets.

Parts

Parts are available through the PDCs.

Use [Table 1](#) to select the tilt-assist struts needed, based on the vehicle bumper-to-back-of-cab (BBC) measurement and the presence of pre-cleaners in the hood. See [Fig. 1](#).

Use [Table 2](#) to select the lower strut brackets needed, based on the front frame configuration of the vehicle. See [Fig. 2](#).

For parts needed by all configurations, see [Table 3](#).

Parts, Tilt-Assist Strut Selection				
BBC	Pre-Cleaners	Part Number	Description	Qty.
122	Yes	A17-20190-000	STRUT-SPRING, HOOD	2
	No	A17-20190-003	STRUT-SPRING, HOOD	2
132	—	A17-20190-004	STRUT-SPRING, HOOD	2

Table 1, Parts, Tilt-Assist Strut Selection

Parts, Lower Strut Bracket Selection			
Front Frame	Part Number	Description	Qty.
Drop Cast Front Frame	A17-18839-002	BRKT-MTG, STRUT, HOOD, DCAST, LH	1
	A17-18839-003	BRKT-MTG, STRUT, HOOD, DCAST, RH	1
Wide Bolt-On Front Frame	A17-18579-002	BRKT ASSY-SUPT, TLT STRT, LWR, LH	1
	A17-18579-003	BRKT ASSY-SUPT, TLT STRT, LWR, RH	1

Table 2, Parts, Lower Strut Bracket Selection

Parts Needed for All Configurations		
Part Number	Description	Qty.
A17-18695-002	BRKT-SUPT, TILT, STRUT, UPPER, LH	1
A17-18695-003	BRKT-SUPT, TILT, STRUT, UPPER, RH	1
23-13861-106	NUT-HEX, FLNG, LKG, 3/8-16, ZN AL	4
23-09114-002	WASHER-HRDN, 0.41 X 0.81 X .080, ZN	8

Table 3, Parts Needed for All Configurations

Procedure

1. Park the vehicle on a level surface, shut down the engine, and set the parking brake. Chock the tires.

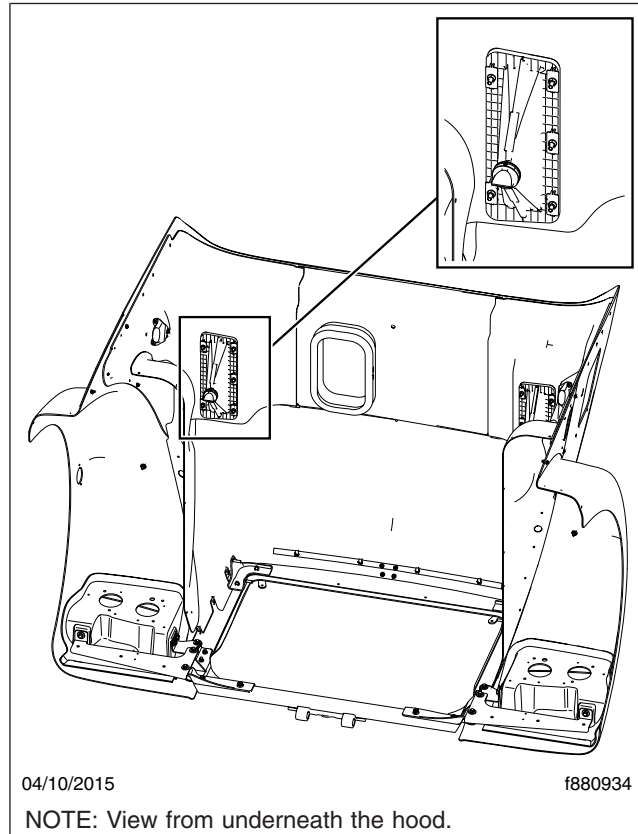

Fig. 1, Hood With Pre-Cleaners

2. Remove the grille as follows:

2.1 Remove the screws that attach the bezel (grille surround) to the hood. Remove the bezel; see [Fig. 3](#).

2.2 Remove the two capscrews and locknuts, and the flatwashers that attach the grille to the hood. There are two locknuts at the top, and two capscrews at the bottom of the grille. Remove the grille and the two lower spacers; see [Fig. 4](#).

3. Open the hood.

NOTE: To prevent the hood from pivoting beyond the normal full-tilt position, complete the strut and bracket replacement on one side of the vehicle before starting on the other side.

4. On one side of the hood, disconnect the hood tilt-assist strut by removing the nuts that attach it to the hood and the chassis. See [Fig. 5](#) and [Fig. 6](#).

5. With an assistant supporting the hood in a less than full-tilt position, disconnect the check strap from the hood-mounted upper bracket. See [Fig. 6](#).

6. Remove the chassis-mounted lower bracket by removing the two bolts and nuts, and the washers that attach it to the chassis. See [Fig. 5](#).

7. Remove the hood-mounted upper bracket by removing the two bolts, nuts, and the washers that attach it to the hood.

FLA COE
FLB COE
FLD Conventional
Business Class
FLC 112 Conventional

Century Class Conventional
Argosy COE
Cargo
Columbia

> 122SD and Coronado
Business Class M2
Cascadia
108SD/114SD

Freightliner
Service Bulletin

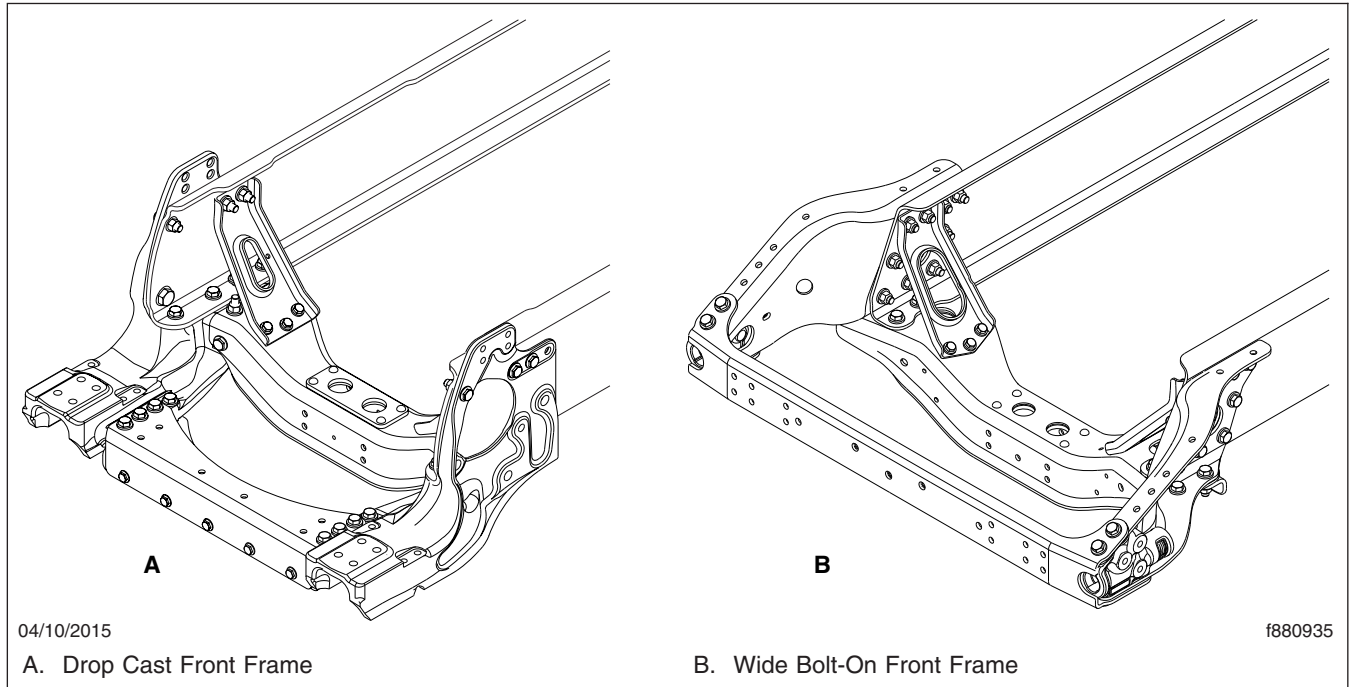

Fig. 2, Front Frame Configuration

8. Install the new hood-mounted upper bracket.
9. Install the new chassis-mounted lower bracket.
10. With an assistant supporting the hood in a less than full-tilt position, connect the check strap to the hood-mounted upper bracket.
11. Using the new fasteners, install the new hood tilt-assist strut to the upper and lower brackets. Tighten the nuts 14 to 19 lbf·ft (19 to 25 N·m).
12. Repeat the strut and bracket replacement on the other side of the vehicle.
13. Close and latch the hood.
14. Install the grille as follows:
 - 14.1 Position the grille on the hood. Install the two locknuts and flatwashers on the isolators at the top of the grille, the capscrews and flatwashers at the bottom, and place the two spacers between the grille and the hood crossbar; see **Fig. 4**.
 - 14.2 Attach the bezel to the grille, using the screws and nylon washers. See **Fig. 3**. Tighten the screws 18 to 22 lbf·in (205 to 250 N·cm).

Warranty

This bulletin is informational only. Warranty does not apply.

Freightliner Service Bulletin

FLA COE
FLB COE
FLD Conventional
Business Class
FLC 112 Conventional

Century Class Conventional
Argosy COE
Cargo
Columbia

> 122SD and Coronado
Business Class M2
Cascadia
108SD/114SD

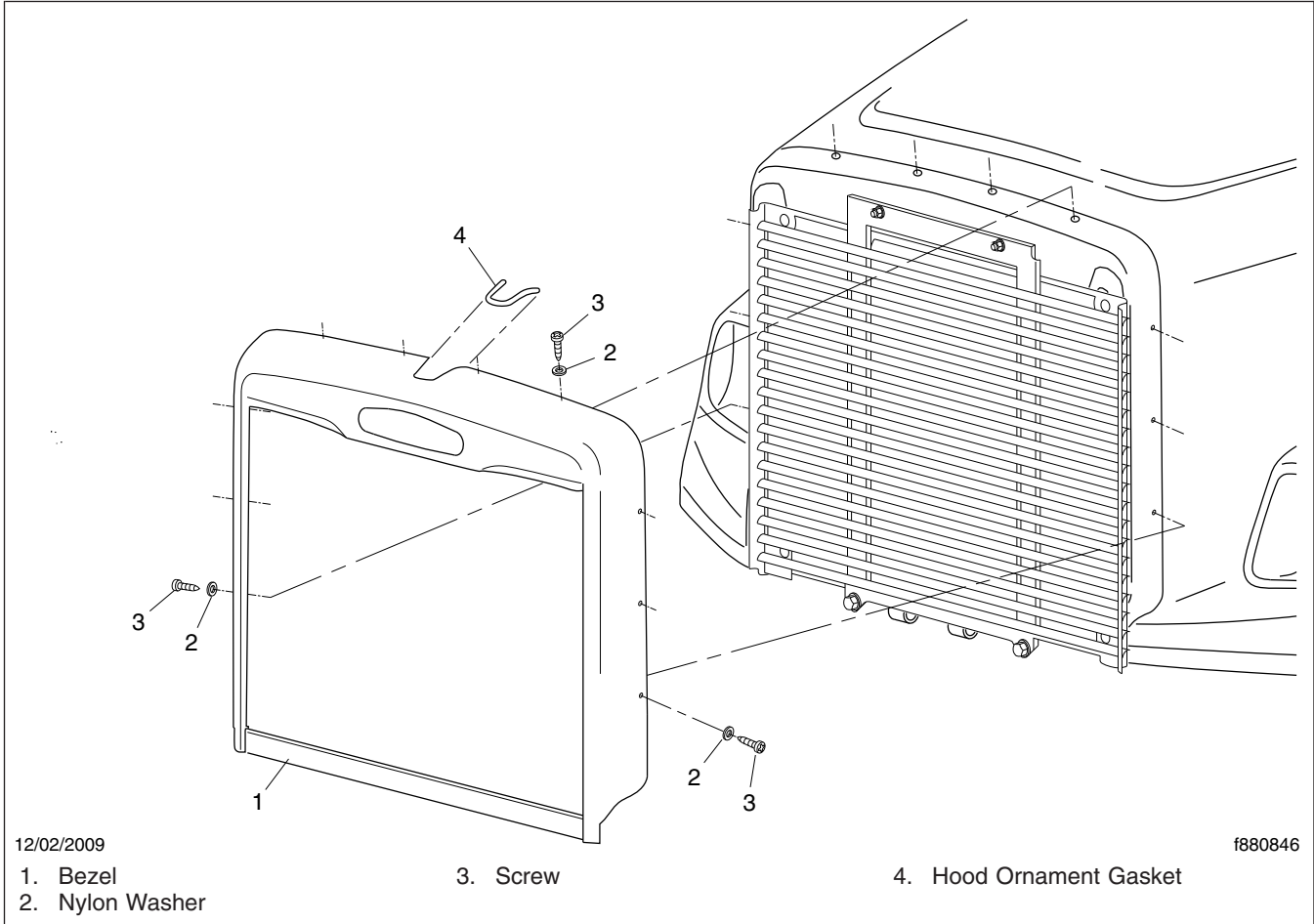

Fig. 3, Bezel Installation

Upgrading to Hood Tilt-Assist Struts With 10-mm Rod Ends, Coronado

88-46

FLA COE
FLB COE
FLD Conventional
Business Class
FLC 112 Conventional

Century Class Conventional
Argosy COE
Cargo
Columbia

> 122SD and Coronado
Business Class M2
Cascadia
108SD/114SD

**Freightliner
Service Bulletin**

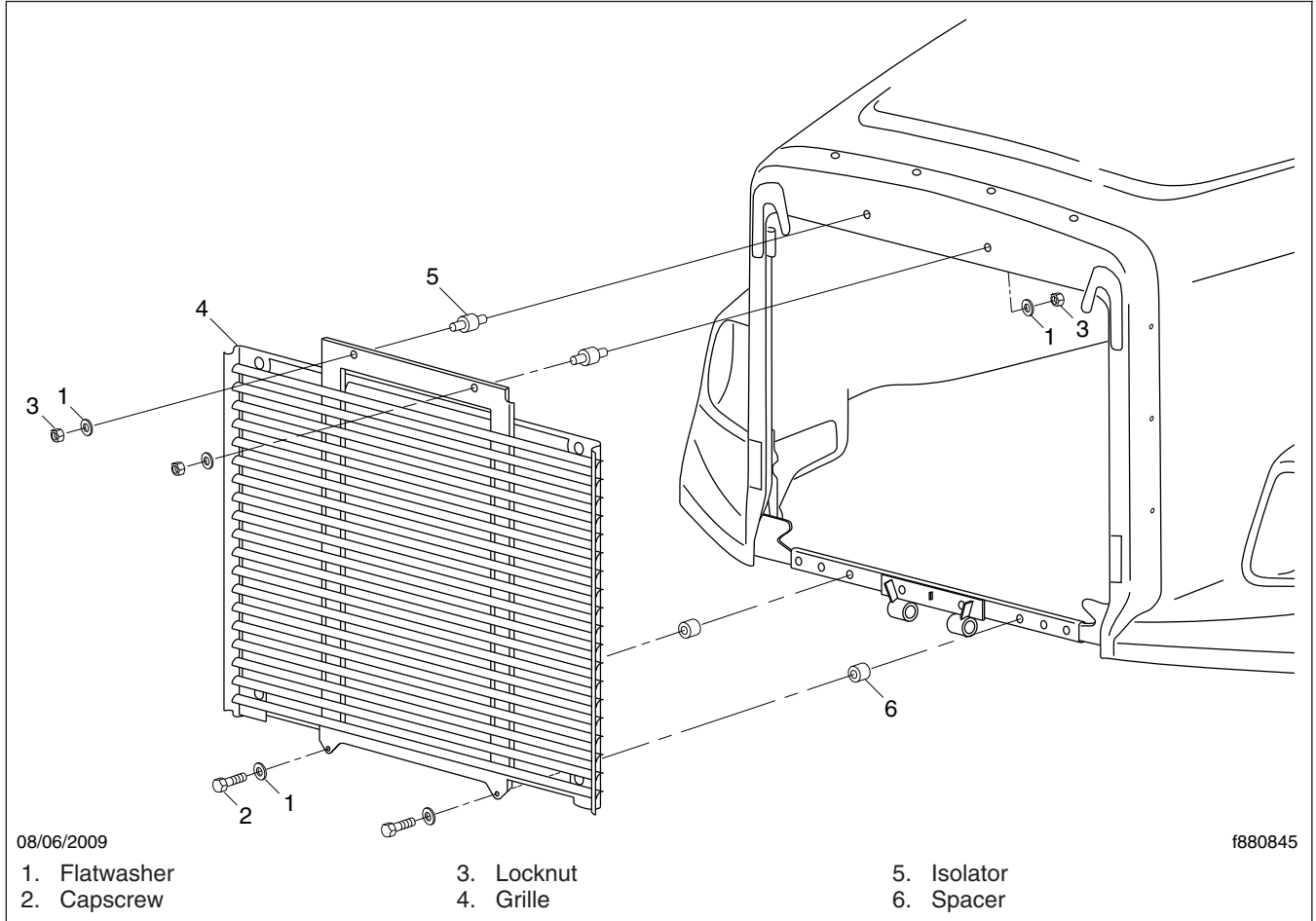

Fig. 4, Grille Installation

Freightliner Service Bulletin

FLA COE
 FLB COE
 FLD Conventional
 Business Class
 FLC 112 Conventional

Century Class Conventional
 Argosy COE
 Cargo
 Columbia

> 122SD and Coronado
 Business Class M2
 Cascadia
 108SD/114SD

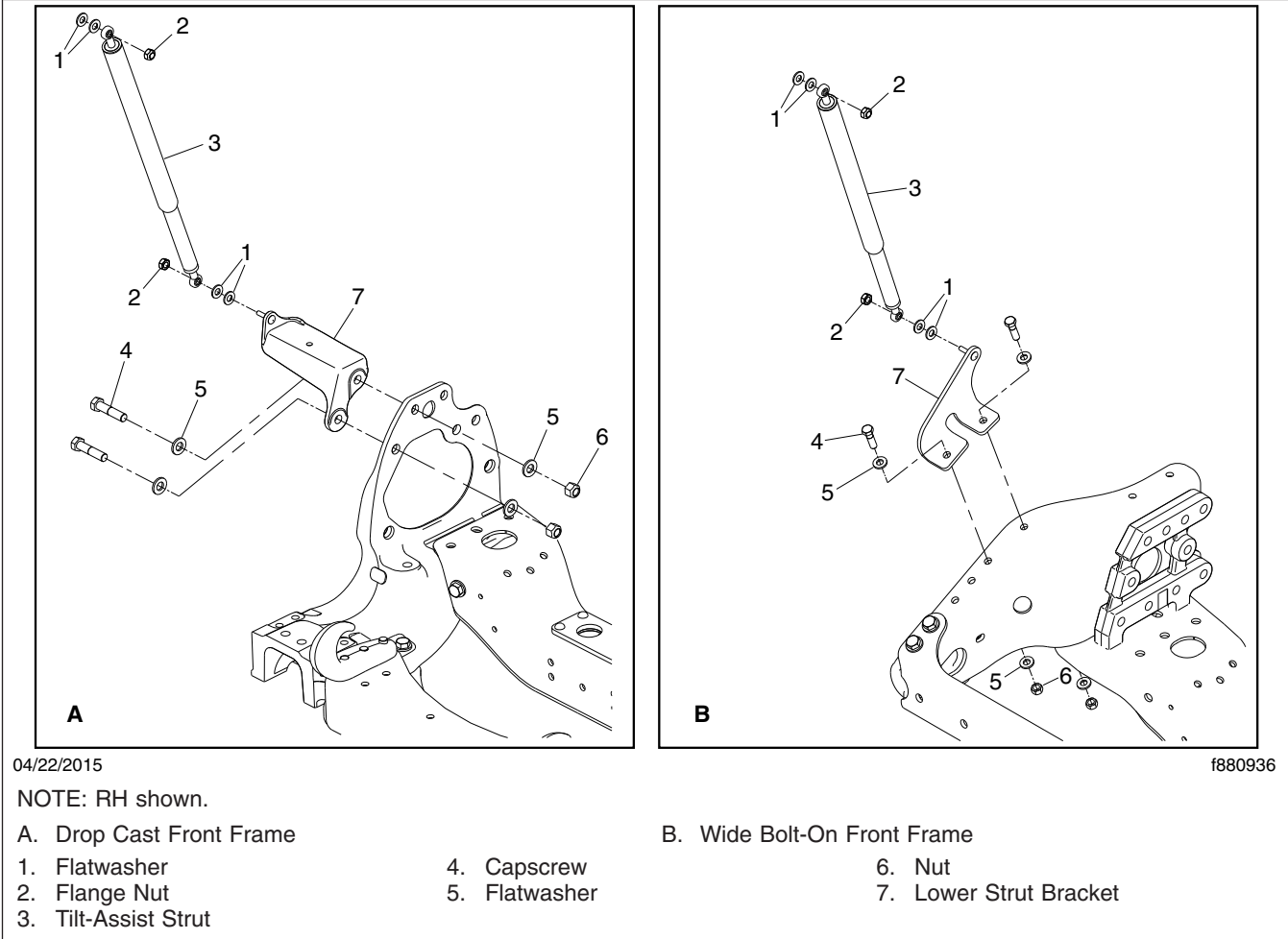

Fig. 5, Tilt-Assist Strut and Mounting Bracket Installation

Upgrading to Hood Tilt-Assist Struts With 10-mm Rod Ends, Coronado

88-46

FLA COE
FLB COE
FLD Conventional
Business Class
FLC 112 Conventional

Century Class Conventional
Argosy COE
Cargo
Columbia

> 122SD and Coronado
Business Class M2
Cascadia
108SD/114SD

Freightliner
Service Bulletin

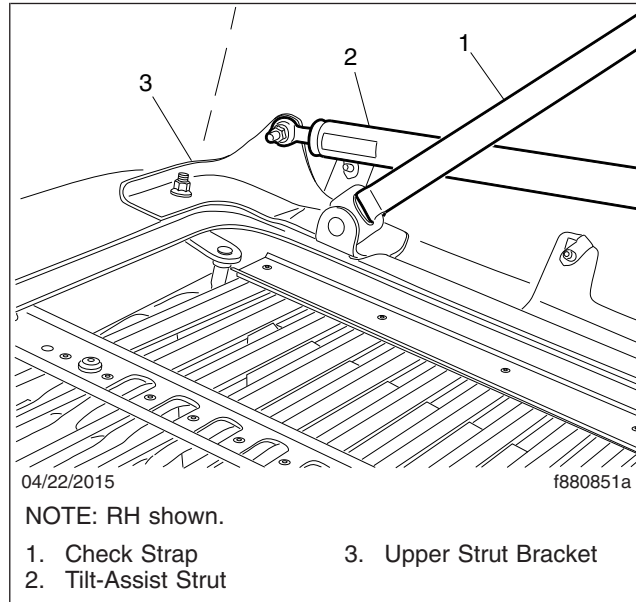

Fig. 6, Hood Tilt-Assist Strut Installation on the Hood