

WE03 - Reworking Rear Lid Release (Workshop Campaign)

Revision: **March 30, 2015**

This revision amends WE03 as follows:

- > Information Note under "Action Required" have been changed, including 3rd bullet point.
- > Attachment "B" — Claim Submission was revised to include Scope 2.

Model Year: **2014**

Model Line: **Panamera**

Concerns: **Rear lid release**

Equipment: Rear wiper (I-no. 425)

Information: This is to inform you of a voluntary Workshop Campaign on the above-mentioned vehicles. **Release switches for opening the rear lid on which electrical malfunctions can occur as a result of water leaking in were installed on the rear wiper.**

Action Required: Replace contact plate for rear lid release.



Information

If you see from the vehicle's workshop history that the **contact plate** with Part No. **298.927.709.A** (i.e. part identifier 000.043.989.07) or a higher index was already installed on the vehicle before carrying out the campaign, this does **not need to be replaced**.

- The campaign must not therefore be carried out on the vehicle.
- This must be documented accordingly in PQIS. The campaign must be marked as "Campaign not feasible" with the reason set as "Scope of campaign already performed before campaign release".
- Once campaign not feasible line is sent to WWS, please submit a PWAR for warranty support to update the recall database accordingly.

Affected Vehicles: The VIN(s) can be checked by using PIWIS Vehicle Information link to verify if the campaign affects the vehicle. This campaign is scope specific to the VIN! Failure to verify in PIWIS may result in an improper repair. This campaign affects 124 vehicles in North America.

Parts Info: **NOTE: PARTS WILL NOT BE AUTOMATICALLY ALLOCATED TO YOUR DEALERSHIP. IF YOU REQUIRE PARTS, PLEASE ORDER THEM VIA A PTEC/PAV."**

Part No.	Designation	Qty.
000.043.989.07	⇒ Contact plate	1 ea.*

* A modified contact plate with release switch will be fitted as part of this campaign. The release switch housing, which is visible from outside, must be re-used following removal.

This means that only one new contact plate is required as a spare part.



Information

- Since the part has been modified, only modified **contact plates** (i.e. Part No. **298.927.709.B**) will be supplied from now on. The new contact plate can only be installed together with a repair connector (Part No. 95B.998.030), which comes with the modified contact plate (Part No. 000.043.989.07) and must also be **fitted (for information on invoicing, see: Scope 2)**.
- Old contact plates with Part No. 298.927.709.A that **were not installed** must be **used up** and invoiced under **Scope 1**.

Overview:

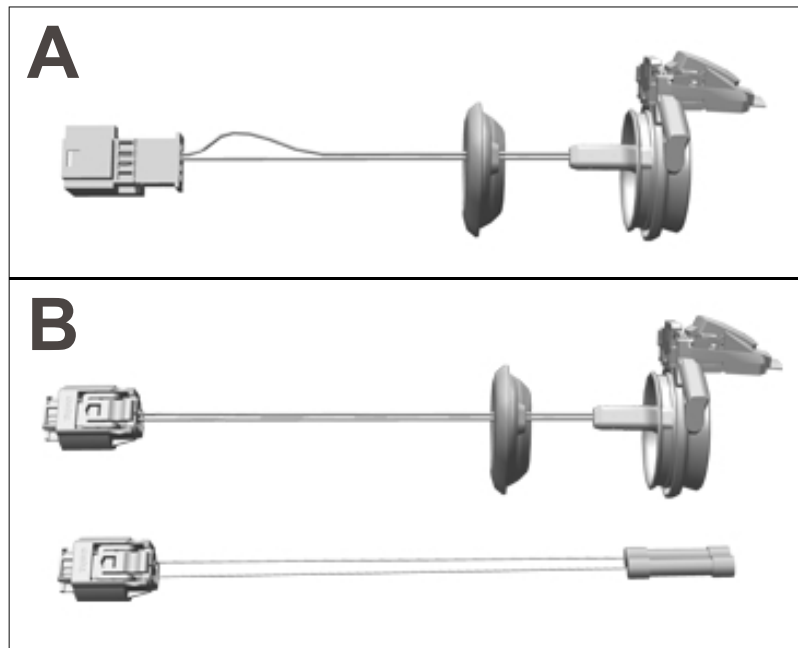

Overview of contact plate

- A** – Contact plate with square connector - old type (use up existing stock)
B – Contact plate with round connector - new type

Materials:

Required for **replacing the repair connector (Scope 2)**:

... ⇒ Fabric tape, approx. 15 mm wide (commercially available) Length: 1,000 mm*

* The WWS Warranty system will automatically add into the "Miscellaneous item" section (sublet) of the claim after the claim has been submitted.

- Tools:
- VAS 1978/14A - Heat gun
 - VAS 1978/1A - Crimping pliers
 - VAS 1978/3 - Stripping pliers

Work Procedure: See Attachment "A".

Claim Submission: See Attachment "B".

Attachment "A": Work Procedure

1 Preliminary work

- 1.1 Switch off ignition and remove driver's key or control panel for Porsche "Entry & Drive" from the ignition lock.
- 1.2 Remove wiper motor for rear wiper ⇒ *Workshop Manual '923419 Removing and installing wiper motor for rear window washer - section on "Removing"*.

2 Remove release switch.

- 2.1 Stick adhesive tape ⇒ *Removing release switch -1-* all around the release switch ⇒ *Removing release switch -2-* and on the rear window trim ⇒ *Removing release switch -3-*.
- 2.2 At the outer edge of the release switch as shown, insert a plastic wedge (**no deeper than 2.5 mm**) between the release switch and cover plate ⇒ *Removing release switch -arrow A-* and then push it straight down until the release switch is pried off the contact plate ⇒ *Removing release switch -arrow B-*. Do not use force on the cover plate.
- 2.3 At the rear window trim ⇒ *Removing release switch -3-*, remove adhesive tape ⇒ *Removing release switch -1-* applied earlier.

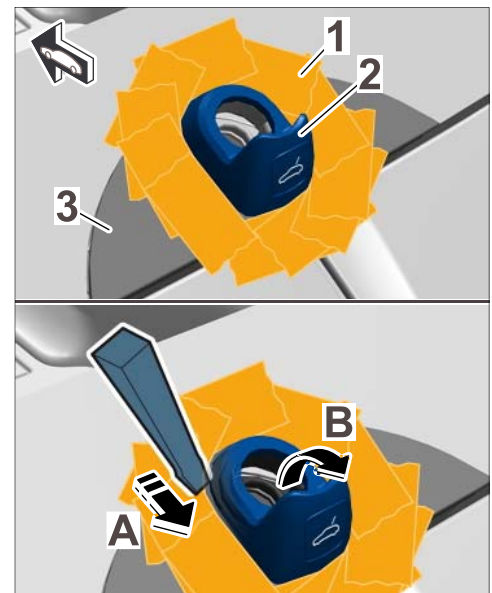

Removing release switch

**Information**

The release switch housing must be re-used as part of this campaign.
Make sure not to damage the housing when removing the electrics.

- 2.4 Use a screwdriver to prise the electrics ⇒ *Reworking release switch -1-* in the release switch ⇒ *Reworking release switch -2-* out of the housing ⇒ *Reworking release switch -arrows A-* and dispose of it ⇒ *Reworking release switch -arrow B-*.

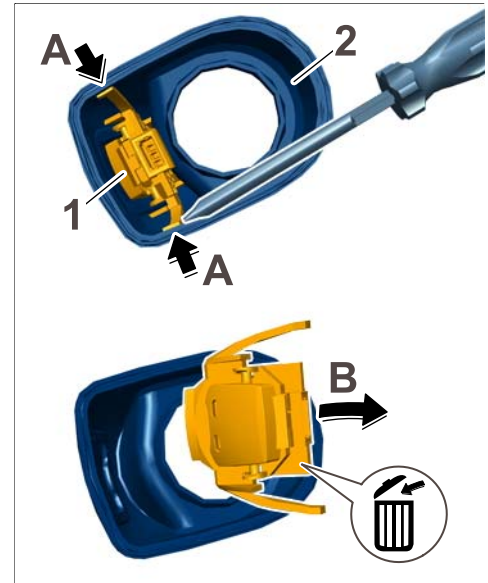

Reworking release switch

3 Remove contact plate.

- 3.1 Release electric plug connection on the inside of the rear lid ⇒ *Disconnecting electric plug connection -a-* and disconnect it ⇒ *Disconnecting electric plug connection -A-*.

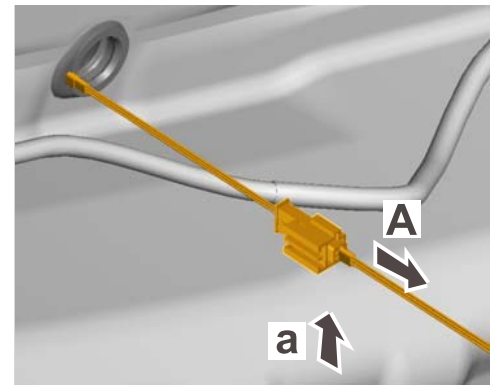

Disconnecting electric plug connection

- 3.2 Carefully press sealing grommet ⇒ *Removing sealing grommet -1-* through by prising it outwards using a screwdriver ⇒ *Removing sealing grommet -arrows-*.
- 3.3 Guide wire harness out of the rear lid and remove contact plate.



Information

Steps **4 to 4.7** described below must only be carried out if a new **contact plate** with **round connector** is installed.

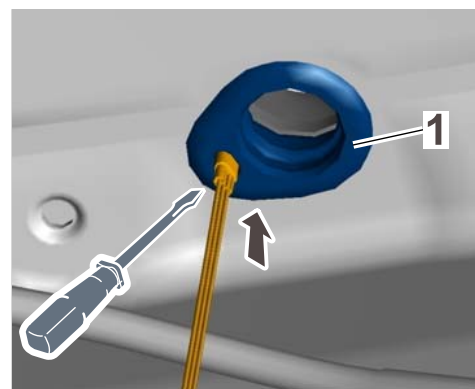

Removing sealing grommet

4 Replace plug connection for rear lid release on the vehicle side.

- 4.1 Remove fabric tape around the main wire harness as shown.

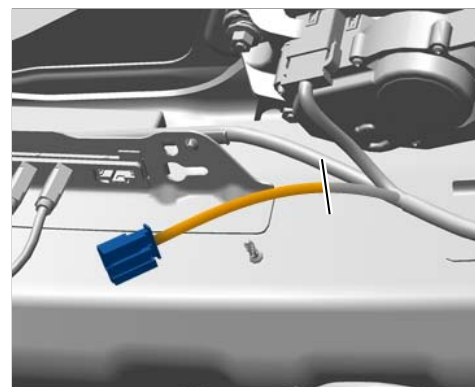

Removing fabric tape



Information

- Select a place for the joint where there is enough space to join the individual wires.
- Mark the electric wires if necessary.

- 4.2 Cut off connector lines ⇒ *Cutting off line -1-* in the marked area **individually** using **stripping pliers VAS 1978/3** ⇒ *Cutting off line -2-*.

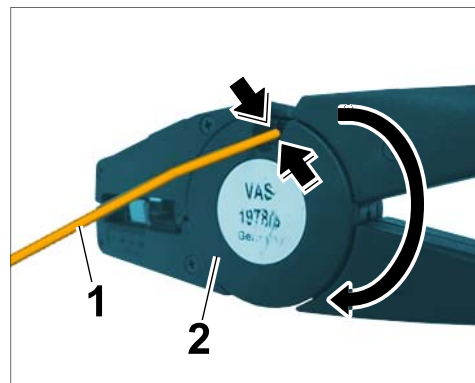

Cutting off line

- 4.3 Strip the lines you have just cut (yellow/blue and brown) ⇒ *Stripping repair line -1-* using the **stripping pliers VAS 1978/3** ⇒ *Stripping repair line -2-*.
The green/white line in the wire harness is not used and must then be insulated using fabric tape.

- 4.4 Insert the stripped lines ⇒ *Inserting lines into crimp connector -1-* into the corresponding crimp connector ⇒ *Inserting lines into crimp connector -2-* on the repair connector, Part No.. **95B.998.030**.

Line assignment:

Brown line of the connector to **brown/white** line of the main wire harness.

Yellow/blue line of the connector to **yellow/blue** line of the main wire harness.

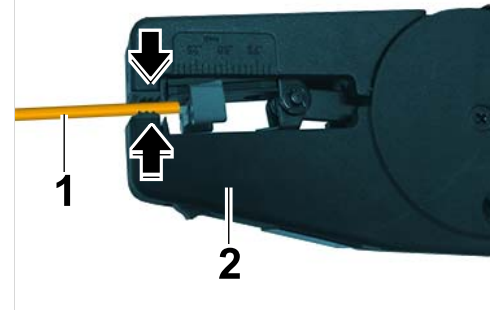

Stripping repair line

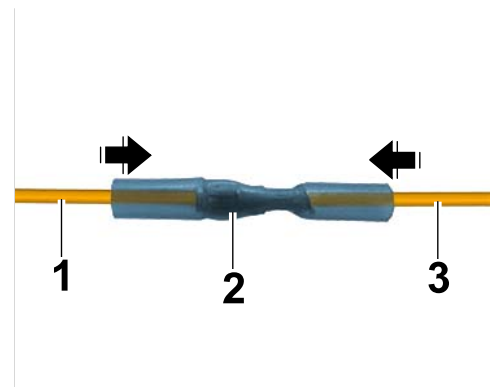

Inserting lines into crimp connector

- 4.5 Crimp on both lines using **crimping pliers VAS 1978/1-1**.

- 4.5.1 Insert crimping pliers insert ⇒ *Crimping on repair line -1-* according to the color marking ⇒ *Crimping on repair line -3-* on the crimp connector ⇒ *Crimping on repair line -2-* into the **crimping pliers VAS 1978/1-1**.

- 4.5.2 Crimp on the crimp connector ⇒ *Crimping on repair line -2-* using **crimping pliers VAS 1978/1-1**.

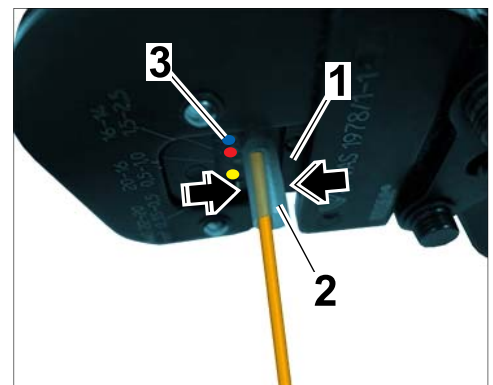

Crimping on repair line

- 4.6 Seal shrink-fit hose on the crimp connection
 ⇒ *Sealing crimp connection -1-* using
hot-air blower VAS 1978/14A ⇒ *Sealing
 crimp connection -2-*.

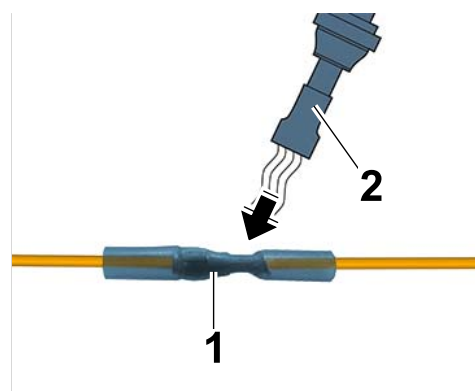

Sealing crimp connection

- 4.7 Wrap fabric tape around the main wire harness and connector lines.

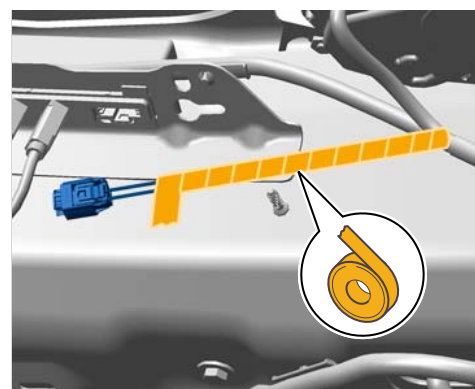

Wrapping tape around wire harness

5 **Install contact plate.**

- 5.1 Position new contact plate ⇒
Installing contact plate -1-, Part No.
000.043.989.07, on the cover plate as
 shown ⇒ *Installing contact plate -2-* and
 check that the seal is fitted correctly all the
 way around.

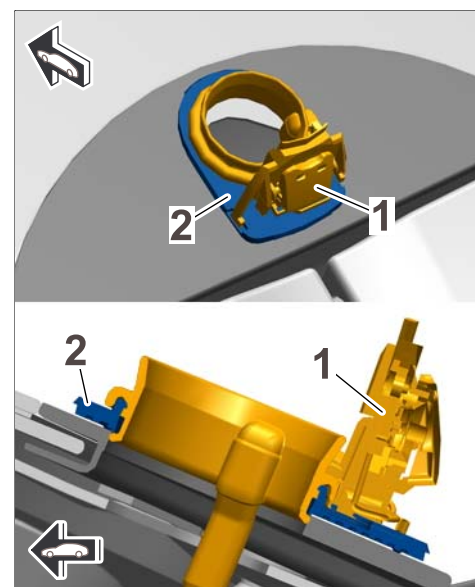

Installing contact plate

- 5.2 Align wire harness ⇒ *Installing contact plate -1- and sealing grommet ⇒ Installing contact plate -2-.*

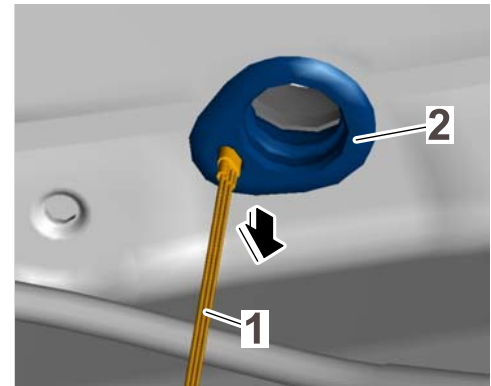

Installing sealing grommet

- 5.3 Connect electric plug connection ⇒ *Connecting electric plug connection -arrows-.*

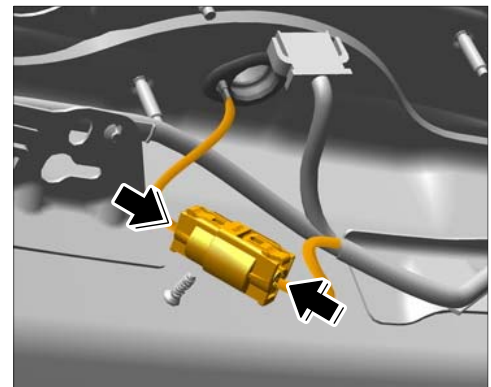

Connecting electric plug connection

NOTICE

Incorrect installation of release switch.

- Damage to rear window trim.
- ⇒ Carefully press in release switch without using excessive force.
- ⇒ Slightly raise or support the rear window trim at the point where it meets the rear spoiler using a plastic wedge or plastic spatula.

- 6 **Install release switch.**
 - 6.1 Coat the inside of the release switch with soapy water before assembly.
 - 6.2 Guide in release switch ⇒ *Installing release switch -1-* at the bottom of the cover ⇒ *Installing release switch -2-* first ⇒ *Installing release switch -arrow A-* and then engage it at the top ⇒ *Installing release switch -arrow B-*.

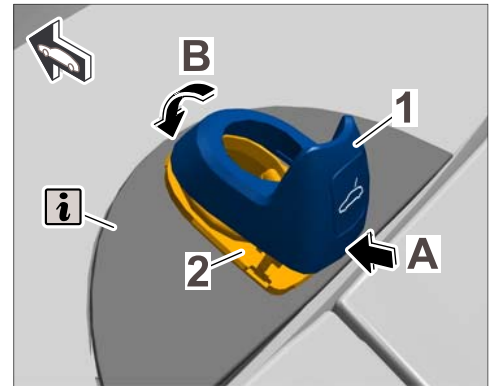

Installing release switch

- 7 **Subsequent work**
 - 7.1 Perform function test on rear lid release.
 - 7.2 Install wiper motor for rear wiper ⇒ *Workshop Manual '923419 Removing and installing wiper motor for rear window washer - section on "Installing"*.
- 8 Enter the workshop campaign in the Warranty and Maintenance booklet.

Attachment "B": **Claim Submission** - Workshop Campaign WE03
 Warranty claims should be submitted via WWS/PQIS.
 Open campaigns may be checked by using either the PIWIS Vehicle Information system or through PQIS Job Creation.
 Labor, parts, and sublet will be automatically inserted when Technician is selected in WWS/PQIS. If necessary, the required part numbers will need to be manually entered into warranty system by the dealer administrator.

Scope 1: **This scope must be invoiced if a contact plate with a square connector is installed (old type).**

Working time:	
Replacing rear lid release	Labor time: 80 TU
Includes:	<ul style="list-style-type: none"> Removing and installing wiper arm for rear wiper Removing and installing wiper motor for rear wiper Removing and installing tailgate trim panel Removing and installing rear lid release
Parts required:	
000.043.989.07 Contact plate	1 ea.
⇒ Damage code WE03 066 000 2	

Scope 2: **This scope must be invoiced if a contact plate with a round connector is installed (new type).**

Working time:

Replacing rear lid release

Labor time: **96 TU**

Includes: Removing and installing wiper arm for rear wiper
 Removing and installing wiper motor for rear wiper
 Removing and installing tailgate trim panel
 Removing and installing rear lid release
 Reworking electric plug connections

Parts required:

298.927.709.B	Contact plate	1 ea.
95B.998.030	Adapter	1 ea.
WE030000001	Expendable items	1 ea. * (for warranty invoicing only)

* The WWS Warranty system will automatically add into the "Miscellaneous item" section (sublet) of the claim after the claim has been submitted.

⇒ **Damage code WE03 066 000 2**

References: ⇒ *Workshop Manual '923419 Removing and installing wiper motor for rear window washer'*

Important Notice: Technical Bulletins issued by Porsche Cars North America, Inc. are intended only for use by professional automotive technicians who have attended Porsche service training courses. They are written to inform those technicians of conditions that may occur on some Porsche vehicles, or to provide information that could assist in the proper servicing of a vehicle. Porsche special tools may be necessary in order to perform certain operations identified in these bulletins. Use of tools and procedures other than those Porsche recommends in these bulletins may be detrimental to the safe operation of your vehicle, and may endanger the people working on it. Properly trained Porsche technicians have the equipment, tools, safety instructions, and know-how to do the job properly and safely. If a particular condition is described, do not assume that the bulletin applies to your vehicle, or that your vehicle will have that condition. See your authorized Porsche Dealer for the latest information about whether a particular technical bulletin applies to your vehicle. Part numbers listed in these bulletins are for reference only. Always check with your authorized Porsche dealer to verify the current and correct part numbers. The work procedures updated electronically in the Porsche PIWIS diagnostic and testing device take precedence and, in the event of a discrepancy, the work procedures in the PIWIS Tester are the ones that must be followed.

© Porsche Cars North America, Inc.

Dealership	Service Manager	Shop Foreman	Service Technician
Distribution	Asst. Manager	Warranty Admin.	Service Technician
Routing			

Dr. Ing. h.c. F. Porsche AG is the owner of numerous trademarks, both registered and unregistered, including without limitation the Porsche Crest®, Porsche®, Boxster®, Carrera®, Cayenne®, Cayman®, Macan®, Panamera®, Speedster®, Spyder®, 918 Spyder®, Tiptronic®, VarioCam®, PCM®, PDK®, 911®, RS®, 4S®, FOUR, UNCOMPROMISED®, and the model numbers and the distinctive shapes of the Porsche automobiles such as, the federally registered 911 and Boxster automobiles. The third party trademarks contained herein are the properties of their respective owners. Porsche Cars North America, Inc. believes the specifications to be correct at the time of printing. Specifications, performance standards, standard equipment, options, and other elements shown are subject to change without notice. Some options may be unavailable when a car is built. Some vehicles may be shown with non-U.S. equipment. The information contained herein is for internal authorized Porsche dealer use only and cannot be copied or distributed. Porsche recommends seat belt usage and observance of traffic laws at all times.

Printed in the USA