

WE81 - Replacing Switching Element for Charge Port Door (Workshop Campaign)

Vehicle Type: **918 Spyder**

Model Year: **2015**

Concerns: **Switching element for charge port door**

Information: This is to inform you of a voluntary Workshop Campaign on the above-mentioned vehicles. **Defective switching elements for the charge port door may have been installed on the affected vehicles due to a supplier error. We have discovered that there is a greater likelihood that the switching elements used here will fail.**

If this is the case, the switching element can become mechanically blocked. It will then no longer be possible to open the charge port door.

Action Required: Replace switching element for charge port door.

Affected Vehicles: The VIN(s) can be checked by using PIWIS Vehicle Information link to verify if the campaign affects the vehicle. This campaign is scope specific to the VIN! Failure to verify in PIWIS may result in an improper repair. This campaign affects 61 vehicles in North America.

Tools:

- **9002 - Lifting platform holders**
- **9453 - Access ramps**
- **9003 - Socket wrench** for central wheel lock
- **9004 - Socket wrench** for central wheel lock cover
- **VAS 6928 - Socket wrench set, 39-piece**
- Torque wrench, 150 – 800 Nm (111 – 592 ftlb.), e.g. **V.A.G. 1601 - Torque wrench 150-800 Nm (111-592 ftlb.)**
- Torque wrench, 2 – 10 Nm (1.5 – 7.5 ftlb.), e.g. **V.A.G 1783 - Torque wrench, 2-10 Nm (1.5-7.5 ftlb.)**

Parts Info: **NOTE: PARTS WILL NOT BE AUTOMATICALLY ALLOCATED TO YOUR DEALERSHIP. ALL PARTS MUST BE ORDERED VIA A PTEC/PAV.**

Part No.	Designation	Qty.
9P1.962.625	⇒ Switching element for charge port door	1 ea.

Work Procedure: See Attachment "A".

Claim
Submission: See Attachment "B".

Installation
Position:

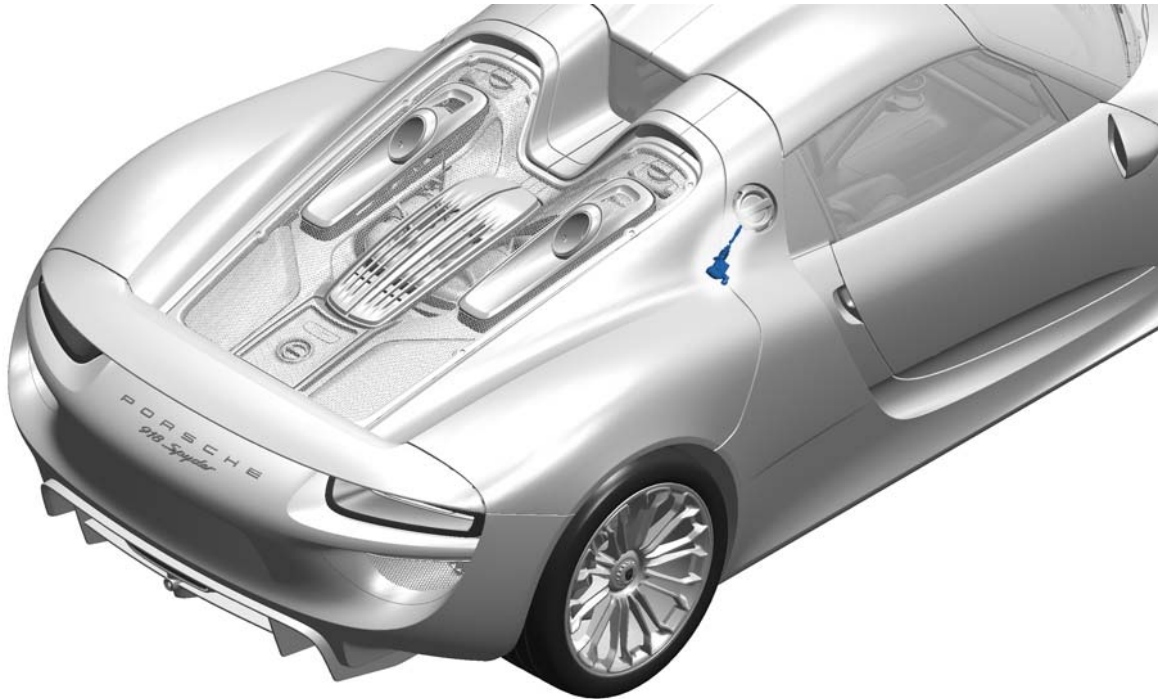

Installation position of switching element for charge port door

Attachment "A": **Work Procedure**

1 Preliminary work

- 1.1 Raise the vehicle on a lifting platform ⇒ *Workshop Manual '4X00IN Lifting the vehicle'.*
 - 1.1.1 Position the vehicle between the arms of the lifting platform and push it onto the **9453 - access ramps**.
 - 1.1.2 Remove underbody covers and fit mounting plates **9002 - Lifting platform holders**, ⇒ *Workshop Manual '518119 Removing and installing jacking points'.*
 - 1.1.3 Jack and raise the vehicle at the mounting plates.
- 1.2 Remove rear right wheel ⇒ *Workshop Manual '440519 Removing and installing wheel - section on "Removing".*
- 1.3 Remove front part of rear wheel housing liner at the right ⇒ *Workshop Manual '53691901 Removing and installing rear wheel housing liner (front part) - section on "Removing".*

1.4 Remove air guide.

- 1.4.1 Open clamping jaws ⇒ *Removing air cleaner guide -2-* and remove air guide ⇒ *Removing air cleaner guide -1-*.

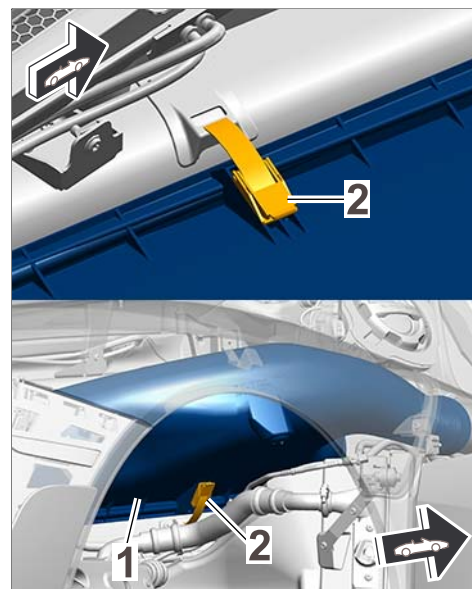

Removing air cleaner guide

2 Remove switching element for charge port door.

- 2.1 Release electric plug connection ⇒ *Disconnecting connector -1-* on switching element for charge port door ⇒ *Disconnecting connector -2-* and disconnect it ⇒ *Disconnecting connector -arrow-*.

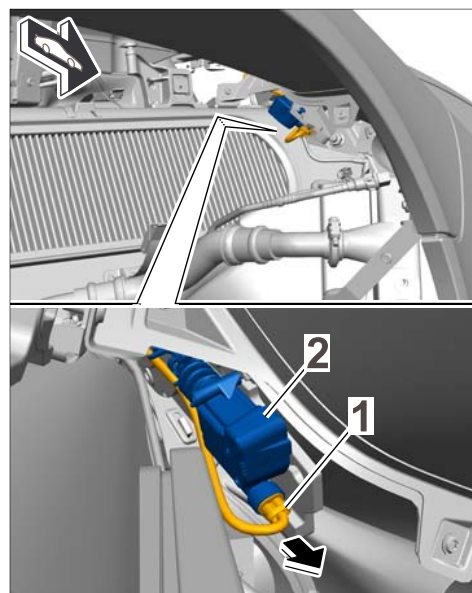

Disconnecting connector

- 2.2 Loosen fastening screws ⇒ *Removing switching element -1-* on switching element for charge port door ⇒ *Removing switching element -2-* by approx. 3 turns.
- 2.3 Disengage switching element for charge port door ⇒ *Removing switching element -2-* from the charging socket tray ⇒ *Removing switching element -arrow-*.

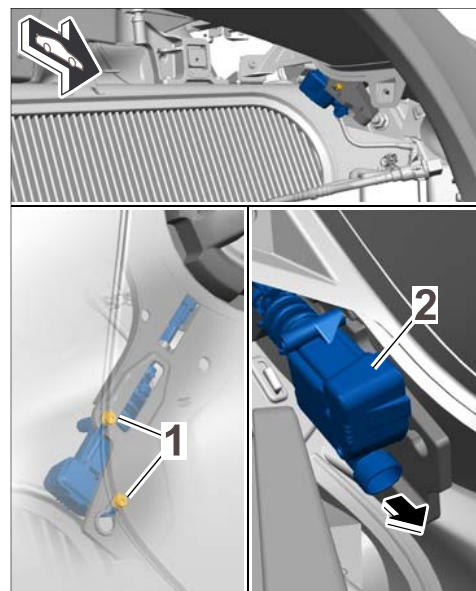

Removing switching element



Information

The locking bar and fastening screws on the switching element for the charge port door must be re-used during this campaign.

- 2.4 Unclip locking bar ⇒ *Removing locking bar -1-* from the servo motor axle ⇒ *Removing locking bar -2-* (⇒ *Removing locking bar -arrow A-*).
- 2.5 Unscrew and remove fastening screws ⇒ *Removing locking bar -3-* from switching element for charge port door ⇒ *Removing locking bar -2-* (⇒ *Removing locking bar -arrows B-*).
- 3 Install new switching element for charge port door, Part No. 9P1.962.625.

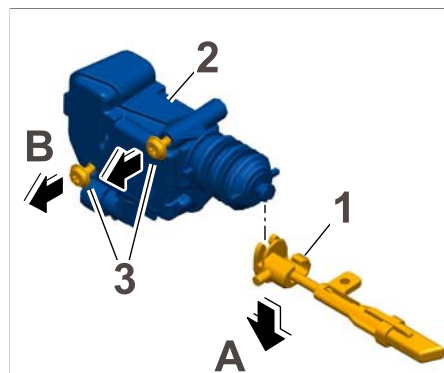

Removing locking bar

- 3.1 Screw in fastening screws \Rightarrow *Installing locking bar -3-* on switching element for charge port door \Rightarrow *Installing locking bar -2-* by approx. 3 turns initially \Rightarrow *Installing locking bar -arrows A-*.
- 3.2 Hold axle for switching element for charge port door securely with your hand and clip in the locking bar you removed earlier \Rightarrow *Installing locking bar -1-* (\Rightarrow *Installing locking bar -arrow B-*).

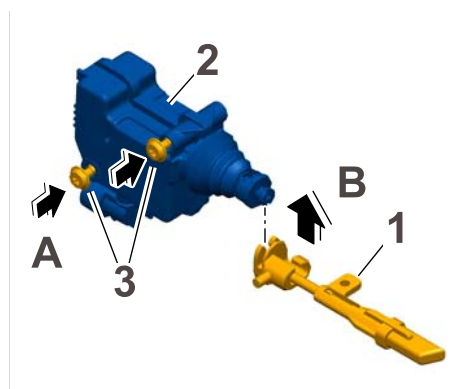

Installing locking bar

- 3.3 Engage switching element for charge port door \Rightarrow *Inserting switching element -2-* at the charging socket tray \Rightarrow *Inserting switching element -arrow-* and secure with the fastening screws \Rightarrow *Inserting switching element -1-*.

Tightening torque 2.5 Nm (2 ftlb.)

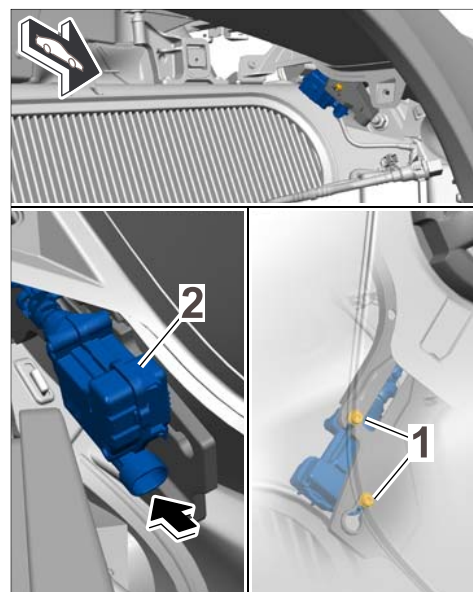

Inserting switching element

- 3.4 Connect electric plug connection ⇒ *Locking connector -1-* on switching element for charge port door ⇒ *Locking connector -2-* (⇒ *Locking connector -arrow-*) until the plug connection engages securely.

- 3.5 Carry out a function test.

- 3.5.1 Lock the vehicle.

- 3.5.2 Check that the switching element locks the charge port door when the vehicle is locked.

- 3.5.3 Unlock the vehicle.

- 3.5.4 Check that the charge port door can be opened when the vehicle is unlocked.

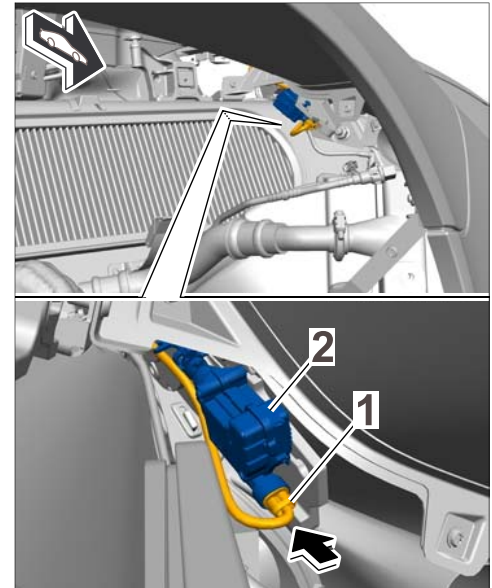

Locking connector

4 Subsequent work

- 4.1 Install air guide.

- 4.1.1 Insert air guide ⇒ *Installing air guide -1-* into the air duct and press it onto the air-cleaner element until it is flush.

- 4.1.2 Close the clamping jaws ⇒ *Installing air guide -2-*.

- 4.2 Install front part of rear wheel housing liner at the right ⇒ *Workshop Manual '53691901 Removing and installing rear wheel housing liner (front part) - section on "Installing"*.

- 4.3 Fit rear right wheel ⇒ *Workshop Manual '440519 Removing and installing wheel - section on "Installing"*.

- 4.4 Lower the vehicle and remove it from the lifting platform ⇒ *Workshop Manual '4X00IN Lifting the vehicle'*.

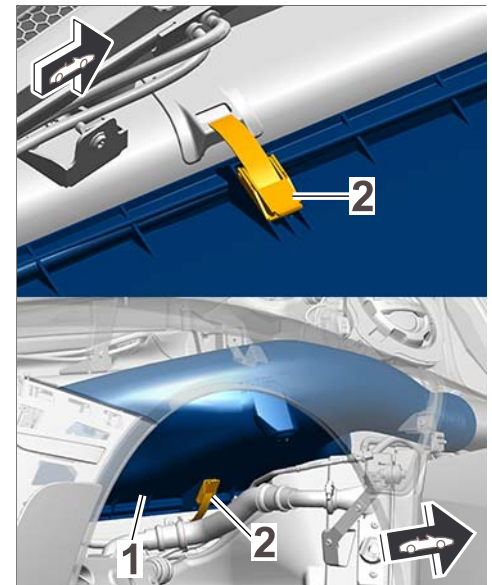

Installing air guide

- 4.4.1 Lower the vehicle onto the **9453 - access ramps** with the lifting platform.

- 4.4.2 Remove mounting plates **9002 - Lifting platform holders** and install the covers on the underbody ⇒ *Workshop Manual '518119 Removing and installing jacking points'*.

- 5 Enter the workshop campaign in the Warranty and Maintenance booklet.

Attachment "B": **Claim Submission** - Workshop Campaign WE81

Warranty claims should be submitted via WWS/PQIS.

Open campaigns may be checked by using either the PIWIS Vehicle Information system or through PQIS Job Creation.

Labor, parts, and sublet will be automatically inserted when Technician is selected in WWS/PQIS. If necessary, the required part numbers will need to be manually entered into warranty system by the dealer administrator.



Information

The specified working time was determined specifically for carrying out this campaign and may differ from the working time published in the Labor Operation List in PIWIS.

Working time:

Replacing switching element for charge port door

Labor time: **124 TU**

Includes: Removing and installing rear right wheel
Removing and installing front part of rear wheel housing liner at the right

Parts required:

9P1.962.625 Switching element for charge port door 1 ea.

⇒ **Damage code WE81 066 000 2**

- References:
- ⇒ *Workshop Manual '4X00IN Lifting the vehicle'*
 - ⇒ *Workshop Manual '440519 Removing and installing wheel'*
 - ⇒ *Workshop Manual '518119 Removing and installing jacking points'*
 - ⇒ *Workshop Manual '53691901 Removing and installing rear wheel housing liner (front part)'*

Important Notice: Technical Bulletins issued by Porsche Cars North America, Inc. are intended only for use by professional automotive technicians who have attended Porsche service training courses. They are written to inform those technicians of conditions that may occur on some Porsche vehicles, or to provide information that could assist in the proper servicing of a vehicle. Porsche special tools may be necessary in order to perform certain operations identified in these bulletins. Use of tools and procedures other than those Porsche recommends in these bulletins may be detrimental to the safe operation of your vehicle, and may endanger the people working on it. Properly trained Porsche technicians have the equipment, tools, safety instructions, and know-how to do the job properly and safely. If a particular condition is described, do not assume that the bulletin applies to your vehicle, or that your vehicle will have that condition. See your authorized Porsche Dealer for the latest information about whether a particular technical bulletin applies to your vehicle. Part numbers listed in these bulletins are for reference only. Always check with your authorized Porsche dealer to verify the current and correct part numbers. The work procedures updated electronically in the Porsche PIWIS diagnostic and testing device take precedence and, in the event of a discrepancy, the work procedures in the PIWIS Tester are the ones that must be followed.

© Porsche Cars North America, Inc.

Dealership	Service Manager	Shop Foreman	Service Technician
Distribution			
Routing	Asst. Manager	Warranty Admin.	Service Technician

Dr. Ing. h.c. F. Porsche AG is the owner of numerous trademarks, both registered and unregistered, including without limitation the Porsche Crest®, Porsche®, Boxster®, Carrera®, Cayenne®, Cayman®, Macan®, Panamera®, Speedster®, Spyder®, 918 Spyder®, Tiptronic®, VarioCam®, PCM®, PDK®, 911®, RS®, 4S®, FOUR, UNCOMPROMISED®, and the model numbers and the distinctive shapes of the Porsche automobiles such as, the federally registered 911 and Boxster automobiles. The third party trademarks contained herein are the properties of their respective owners. Porsche Cars North America, Inc. believes the specifications to be correct at the time of printing. Specifications, performance standards, standard equipment, options, and other elements shown are subject to change without notice. Some options may be unavailable when a car is built. Some vehicles may be shown with non-U.S. equipment. The information contained herein is for internal authorized Porsche dealer use only and cannot be copied or distributed. Porsche recommends seat belt usage and observance of traffic laws at all times.

Printed in the USA