

# NEWMAR CORPORATION WARRANTY DEPARTMENT

## TECHNICAL SERVICE BULLETIN

DATE ISSUED	MODEL YEAR(S) AFFECTED	TSB #
11/30/2015	2012-2013	438
<b>BRAND</b>		
Bay Star Sport <input type="checkbox"/>	Ventana <input type="checkbox"/>	Essex <input checked="" type="checkbox"/>
Bay Star <input type="checkbox"/>	Dutch Star <input type="checkbox"/>	King Aire <input checked="" type="checkbox"/>
Canyon Star <input type="checkbox"/>	Mountain Aire <input type="checkbox"/>	Other <input type="checkbox"/>
Ventana LE <input type="checkbox"/>	London Aire <input type="checkbox"/>	
<b>DESCRIPTION</b>		
<p>Newmar Corporation has decided that a defect relating to motor vehicle safety exists in specific 2012 and 2013 Essex and 2012 King Aire motorhomes. This is in response to notification from Spartan Motors, Inc. Attached is a list of specific unit numbers affected.</p> <p><b>Issue:</b> A defect relating to the modulator valves making contact with the IFS relay rod may exist in certain vehicles equipped with an IFS2000 model front suspension. When the steering wheel is turned, the relay rod may interfere with the ABS modulator valve if the valve is in an incorrect orientation and the steering relay rod is in the full forward position during full right or left turns.</p> <p><b>Condition:</b> If enough contact is made with the ABS modulator valve, the valve may fracture. This may result in air not being applied to the affected side during a braking event. This may reduce stopping distance of the vehicle or cause the vehicle to pull to one side, which could result in a vehicle crash.</p>		
<b>RECOMMENDED ACTION</b>		
<p><b>Correction:</b> An Authorized Service facility will inspect the modulator valve and, if needed, add a spacer behind the ABS modulator valve. Spartan Motors, Inc. has provided the attached work instructions.</p> <p>If you are contacted by the current owner who has not received a recall letter, you should verify that they have an affected chassis by calling Spartan 1-800-543-4277 (opt. 0) for verification.</p> <p>If you have technical questions, please call Spartan Customer Product Support Department at 1-800-543-4277 (opt. 1).</p> <p>NHTSA# 15V 727            TC# 2015-363</p> <p style="background-color: yellow;"><b><i>Please read this bulletin in its entirety prior to beginning any diagnosis or repairs.</i></b>  <b><i>If further assistance is needed, Contact Newmar Service Department @ 1 866-290-5371.</i></b></p>		



WHEN YOU KNOW THE DIFFERENCE

# NEWMAR CORPORATION

NEWMARCORP.COM

Date: November 30, 2015  
Re: Newmar Corporation – Motor Vehicle Recall Notification

---

Subject: Recall Campaign No.: 15V 727

This notice is sent to you as a Newmar Dealer in accordance with the requirements of the National Traffic and Motor Vehicle Safety Act. Newmar Corporation has decided that a defect which relates to motor vehicle safety exists in specific Newmar recreational vehicles.

The National Traffic and Motor Vehicle Safety Act requires that each vehicle which is subject to a recall campaign of this type must be satisfactorily repaired within a reasonable time after the owner has tendered it for repair. A failure to adequately repair within 60 days after tender of a vehicle is prima facie evidence of failure to repair within a reasonable time. If the condition is not properly repaired within a reasonable time, the owners may be entitled to an identical or reasonably equivalent vehicle at no charge or to a refund of the purchase price less a reasonable allowance for depreciation.

To avoid providing these problematic solutions, every effort must be made to promptly schedule an appointment with each owner and to repair their vehicle as soon as possible. Vehicle owners are being notified of this recall. If the condition is not remedied within a reasonable time, they are instructed on how to contact the National Highway Traffic Safety Administration.

## **REASON FOR THIS RECALL**

*Newmar Corporation has decided that a defect which relates to motor vehicle safety exists in specific motor homes. This is in response to notification from Spartan Motors, Inc.*

On certain motorhomes, equipped with IFS2000 model front suspension, the shaft of the ball joint on the steering relay rod may contact the ABS valve, if the valve is an incorrect orientation and the steering relay rod is in the full forward position during full right or left turns. If enough contact with the ABS modulator valve is made, the valve may fracture which could result in air not being applied to the affected wheel. This could occur without warning. A fractured ABS modulator valve could allow air to not be applied to the affected side during a braking event. This may reduce stopping distance of the vehicle or cause the vehicle to pull to one side which could result in a vehicle crash. Correction: An Authorized Service facility will inspect the modulator valve and if needed add a spacer behind the ABS modulator valve.

Motorhomes included in this recall include:

2012-2013 model year Essex Class A motorhomes.

2012 model year King Aire Class A motorhomes.

These motorhomes were built between 3/22/2011 and 1/08/2013.

**These motor homes require immediate service. Continued use poses a potential safety hazard.**

**DEALER CAMPAIGN RESPONSIBILITY**

*Dealers are to provide to all customers/owner vehicles the service of completing this campaign at no charge to the customer/owner regardless of vehicle age, vehicle mileage, or ownership at the time of repair.*

**REPAIR PROCEDURE**

Spartan Motors, Inc. will provide the work instructions. The Authorized Service facility will inspect the modulator valve and if needed add a spacer behind the ABS modulator valve.

**If you should have any questions please contact the Newmar service department at: 1-866-290-5371.**

Thank you for your cooperation.

Sincerely,

Newmar Corporation



WHEN YOU KNOW THE DIFFERENCE

# NEWMAR CORPORATION

NEWMARCORP.COM

Date: November 24, 2015

Re: Newmar Corporation – Motor Vehicle Recall Notification

---

Subject: Recall Campaign No.: # 2015-563

This notice is sent to you as a Newmar Dealer in accordance with the requirements of the Canada Motor Vehicle Safety Act. Newmar Corporation has decided that a defect which relates to motor vehicle safety exists in specific Newmar recreational vehicles.

Each vehicle which is subject to a recall campaign of this type must be satisfactorily repaired within a reasonable time after the owner has tendered it for repair. A failure to adequately repair within 60 days after tender of a vehicle is prima facie evidence of failure to repair within a reasonable time. If the condition is not properly repaired within a reasonable time, the owners may be entitled to an identical or reasonably equivalent vehicle at no charge or to a refund of the purchase price less a reasonable allowance for depreciation.

To avoid providing these problematic solutions, every effort must be made to promptly schedule an appointment with each owner and to repair their vehicle as soon as possible. Vehicle owners are being notified of this recall. If the condition is not remedied within a reasonable time, they are instructed to contact Transport Canada.

## **REASON FOR THIS RECALL**

*In response to notification from Spartan Motors, Newmar Corporation has determined that a defect which relates to motor vehicle safety exists in specific motor homes built on Spartan chassis.*

On certain motorhomes equipped with IFS2000 model front suspensions, the ABS valve may have been incorrectly oriented at time of installation. As a result, the shaft of the ball joint on the steering relay rod may contact the valve during full right or left turns. If enough contact is made, the valve may fracture without warning, which could result in service brake air pressure not being applied to the affected wheel. This may increase stopping distances or cause the vehicle to pull to one side which could result in a vehicle crash. Correction: An Authorized Service facility will inspect the modulator valve and if needed add a spacer behind the ABS modulator valve.

**These motor homes require immediate service. Continued use poses a potential safety hazard.**

This recall applies to certain Newmar motorhomes built between 4/15/2011 and 10/22/2012.

## **DEALER CAMPAIGN RESPONSIBILITY**

***Dealers are to provide to all customers/owner vehicles the service of completing this campaign at no charge to the customer/owner regardless of vehicle age, vehicle mileage, or ownership at the time of repair.***

**REPAIR PROCEDURE**

Please reference Spartan Motors, Inc. work instructions enclosed.

**If you should have any questions please contact the Newmar service department at: 1-866-290-5371.**

Thank you for your cooperation.

Sincerely,

Newmar Corporation



# Spartan Motors Chassis, Inc.

SERVICE BULLETIN

RSB12-250-005

NHTSA Id: 13V-392

9/17/2013

**SUBJECT:** Spartan Motors Chassis, Inc. has determined a defect relating to the modulator valves making contact with the IFS relay rod may exist in certain vehicles equipped with IFS2000 model front suspension.

*Bulletin # CSB12-250-005 is superseded by bulletin RSB12-250-005. Any vehicle repaired under bulletin CSB12-250-005 will not require any additional work.*

**CONDITION:** When the steering wheel is turned, the relay rod on the IFS may interfere with the ABS modulator valve.

**APPLIES TO:** This bulletin applies to vehicles assembled by Spartan Motors Chassis, Inc. as motorhome chassis between vehicle dates of manufacturing of 2/26/2009 and 1/16/2013.

**CORRECTION:** Add spacer behind ABS modulator valve.

**LABOR ALLOCATION:** 1.0 hrs.

**PARTS NEEDED:**

<u>QTY</u>	<u>Part Number</u>	<u>Description</u>
1	S-2387-001	Kit – ABS spacer

**Kit # S-2387-001 Contains:**

<u>QTY</u>	<u>Part Number</u>	<u>Description</u>
4	05180350H8Y	BOLT 5/16-18X3.50LG HEX GR8 YEL
4	0946-LL2-002	Spacer
1	CSB12-250-005	Document instructions

**GENERAL INSTRUCTIONS:**

Review entire work procedure before starting work. If there are questions and/or concerns with steps defined in this procedure, contact Spartan Motors Chassis, Inc. Customer & Product Support.

All applicable industry safety standards must be followed when performing work identified in this procedure.

Technical Service Bulletins are intended for use by Professional Technicians only. They are written to guide Professional Technicians in performing service to vehicles of product specific nature in conjunction with industry standards. Professional Technicians are appropriately trained on industry standards and have the tools and equipment to perform procedures safely and properly.



**STEP-BY-STEP INSTRUCTIONS:**

1. Locate left and right ABS modulator valves on front IFS suspension. Refer to FIG. 2-1.



**FIG. 2-1**

2. Remove (2) 5/16 in. bolts, (4) washers, and (2) nuts that mount ABS modulator valve to suspension. Retain washers and nuts for reuse. Refer to FIG. 3-1.

**NOTE: Do not remove airline or brake drop hose from valve.**

3. Install spacers between ABS modulator valve & mounting plate. Refer to FIG. 3-1.
4. Install new bolts, retained washers, and retained nuts. Torque nut side to 15 lbs. ft.
5. Repeat steps 2 through 4 for opposite side.

Technical Service Bulletins are intended for use by Professional Technicians only. They are written to guide Professional Technicians in performing service to vehicles of product specific nature in conjunction with industry standards. Professional Technicians are appropriately trained on industry standards and have the tools and equipment to perform procedures safely and properly.



# Spartan Motors Chassis, Inc.

SERVICE BULLETIN

RSB12-250-005

NHTSA Id: 13V-392

9/17/2013

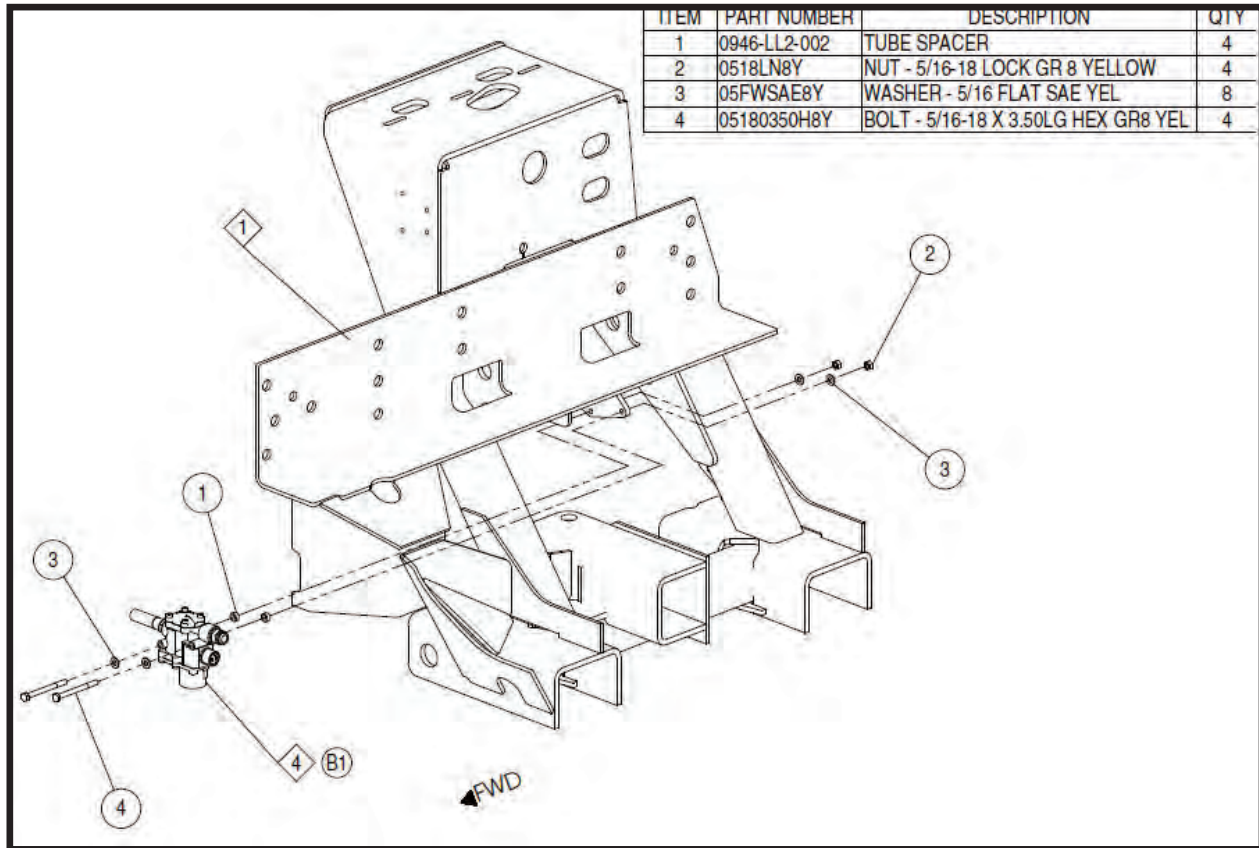

**FIG. 3-1**

Technical Service Bulletins are intended for use by Professional Technicians only. They are written to guide Professional Technicians in performing service to vehicles of product specific nature in conjunction with industry standards. Professional Technicians are appropriately trained on industry standards and have the tools and equipment to perform procedures safely and properly.

VIN Number	Production Number	Model Year	Brand	Type	Floor Plan	Chassis Brand	Date In Production	Date Off Production
4VZAU1E9XCC075585	800995	2012	EX	DP	4544	S	2/17/2012	2/29/2012
4VZAU1E9XDC075491	800991	2013	EX	DP	4544	S	1/16/2012	1/25/2012
4VZAU1E9XDC076253	801006	2013	EX	DP	4544	S	8/7/2012	8/16/2012
4VZAU1E91DC076254	801012	2013	EX	DP	4544	S	8/13/2012	8/21/2012
4VZAU1E91DC076559	801023	2013	EX	DP	4547	S	12/14/2012	1/8/2013
4VZAU1E92DC076005	801004	2013	EX	DP	4544	S	5/23/2012	6/4/2012
4VZAU1E93CC074813	800968	2012	EX	DP	4544	S	8/9/2011	8/19/2011
4VZAU1E94CC075548	800993	2012	EX	DP	4544	S	2/2/2012	2/13/2012
4VZAU1E95CC075252	800979	2012	EX	DP	4544	S	11/4/2011	11/15/2011
4VZAU1E95CC075316	800980	2012	EX	DP	4544	S	11/28/2011	12/6/2011
4VZAU1E95DC076144	801011	2013	EX	DP	4547	S	7/27/2012	8/7/2012
4VZAU1E97DC076386	801019	2013	EX	DP	4547	S	9/21/2012	10/4/2012
4VZAU1E98DC076588	801022	2013	EX	DP	4544	S	12/10/2012	12/18/2012
4VZAU1E99DC075613	800999	2013	EX	DP	4544	S	4/24/2012	5/3/2012
4VZVU1E90CC073992	530097	2012	KG	DB	4584	S	3/22/2011	3/31/2011

### Canadian Units

VIN Number	Production Number	Model Year	Brand	Type	Floor Plan	Chassis Brand	Date In Production	Date Off Production
4VZAU1E90CC074624	800956	2012	EX	DP	4544	S	4/15/2011	4/27/2011
4VZAU1E92CC075385	800987	2012	EX	DP	4540	S	12/9/2011	1/18/2012
4VZAU1E92CC075547	800990	2012	EX	DP	4544	S	2/8/2012	2/17/2012
4VZAU1E93CC074570	800955	2012	EX	DP	4542	S	4/18/2011	4/29/2011
4VZAU1E97DC076520	801005	2013	EX	DP	4544	S	10/11/2012	10/22/2012