



Service Bulletin

TECHNICAL

Subject: Driver Outside Wide Load Mirror Turn Signal Too Bright

Models: 2015 Chevrolet Silverado 1500
2015 Chevrolet Silverado 2500/3500 with RPO AVF
2015 GMC Sierra 1500
2015 GMC Sierra 2500/3500 with RPO AVF
With Mirror RPO DPN or DQS

Attention: This Bulletin also applies to any of the above models that may be Export vehicles.

Condition

Some customers may comment that the driver's outside wide load mirror turn signal is too bright. This concern is more noticeable when driving at night.

Cause

The cause of this condition may be the brightness of LED's in the turn signal on the mirror.

Correction

Replace the original upper left hand outside rearview mirror glass only with a new part designed to reduce the intensity of the LED indicator.

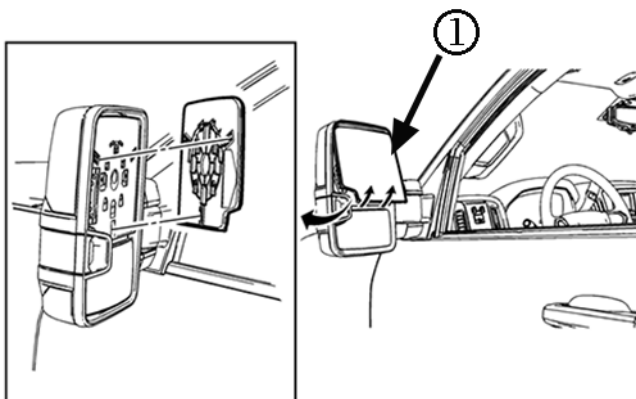

1. Remove the upper outside rearview mirror glass (1). Refer to the appropriate Outside Rearview Mirror Glass Replacement - Upper procedure in SI.
2. Install the new upper outside rearview mirror glass. Refer to the appropriate Outside Rearview Mirror Glass Replacement- Upper procedure in SI.

Parts Information

Part Number	Description	Qty
-------------	-------------	-----

23444110	MIRROR KIT-O/S RR VIEW	1
----------	------------------------	---

Warranty Information

For vehicles repaired under warranty, use:

Labor Operation	Description	Labor Time
2050110	Outside Rearview Mirror Glass Replacement	Use Published Labor Operation Time

GM bulletins are intended for use by professional technicians, NOT a "do-it-yourselfer". They are written to inform these technicians of conditions that may occur on some vehicles, or to provide information that could assist in the proper service of a vehicle. Properly trained technicians have the equipment, tools, safety instructions, and know-how to do a job properly and safely. If a condition is described, DO NOT assume that the bulletin applies to your vehicle, or that your vehicle will have that condition. See your GM dealer for information on whether your vehicle may benefit from the information.



WE SUPPORT VOLUNTARY TECHNICIAN CERTIFICATION