

# Front License Plate and Mounting Bracket Installation

**Service Category** General

**Section** Pre-Delivery Service

**Market** USA

Lexus Supports ASE Certification

## Applicability

YEAR(S)	MODEL(S)	ADDITIONAL INFORMATION
2016	LX570	

## Introduction

The 2016 model year LX 570 front license plate bracket and 2 self-tapping screws are stored in the luggage compartment of the vehicle at the assembly plant. For states that require a front license plate, install the bracket and bolts on the bumper cover during Pre-Delivery Service (PDS) according to the following procedures.

## Warranty Information

OP CODE	DESCRIPTION	TIME	OFF	T1	T2
N/A	Not Applicable to Warranty	-	-	-	-

## Installation Procedure

1. Disengage the 3 claws and remove the 2 radiator grille moldings.

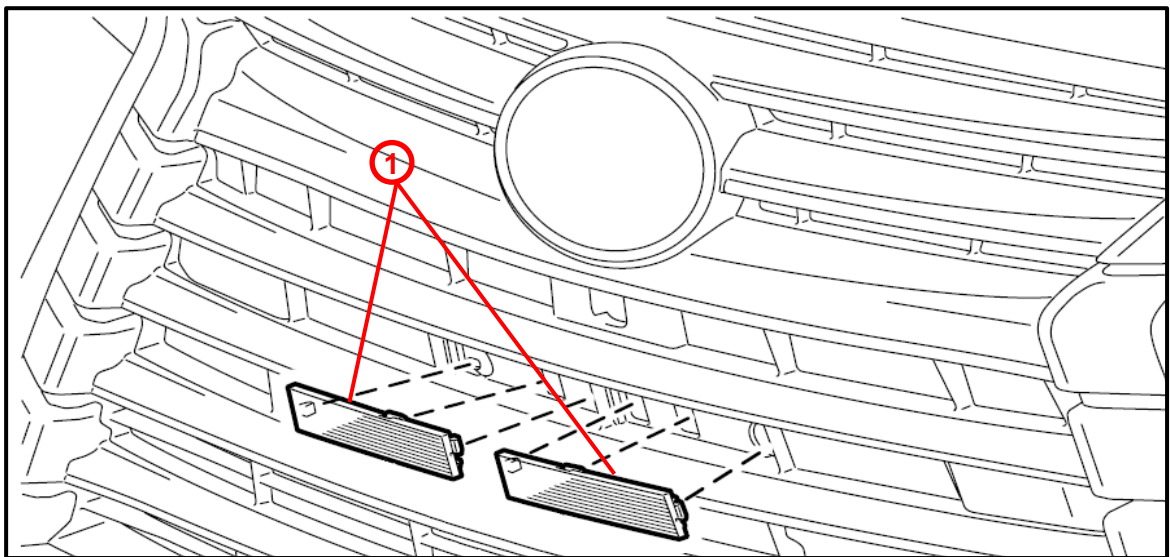

<b>1</b>	<b>Radiator Grille Moldings</b>
----------	---------------------------------

## Front License Plate and Mounting Bracket Installation

### Installation Procedure (Continued)

2. Attach the hooks of the front license plate mounting bracket to the air intake of the radiator grille and hold in place.
3. Align holes "A" of the mounting bracket with the installation holes on the radiator grille.

**NOTE**

- Holes "A" are used for installation of the mounting bracket to the bumper cover.
- Holes "B" are used for installation of the front license plate to the mounting bracket.

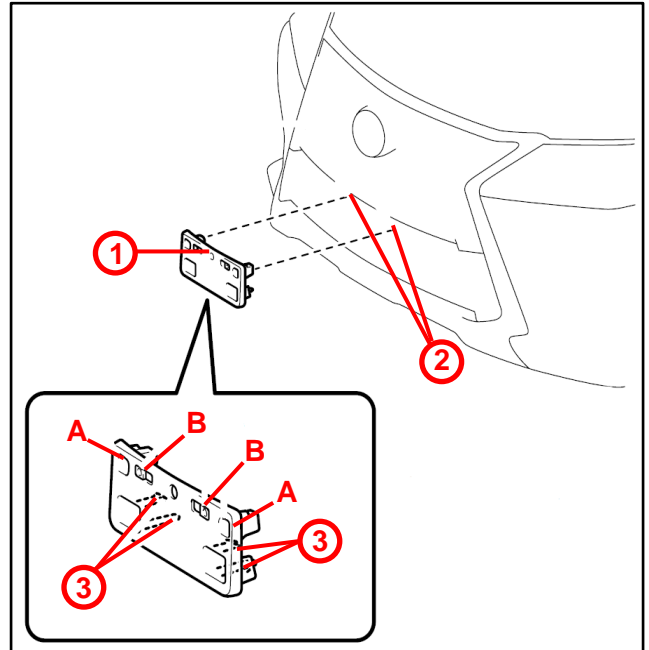

1	Mounting Bracket
2	Installation Holes
3	Hooks

## Front License Plate and Mounting Bracket Installation

### Installation Procedure (Continued)

4. Install the mounting bracket to the radiator grille using 2 self-tapping screws provided.

**NOTE**

**Do NOT over-tighten the self-tapping screws.**

5. Install the front license plate using 2 non-corroding bolts with the following dimensions:

**Nominal Length: 15.0 mm (0.59 in.)**  
**Diameter: 6.0 mm (0.24 in.)**

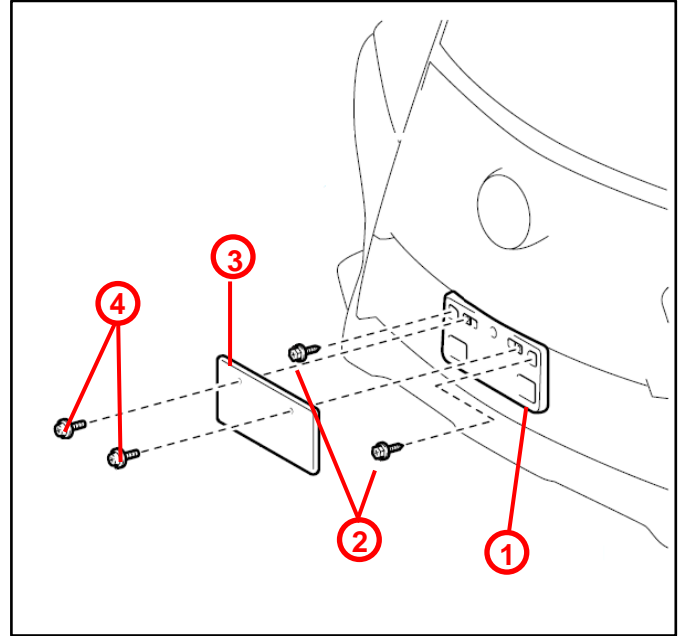

1	Mounting Bracket
2	Self-Tapping Screws
3	License Plate
4	Bolts

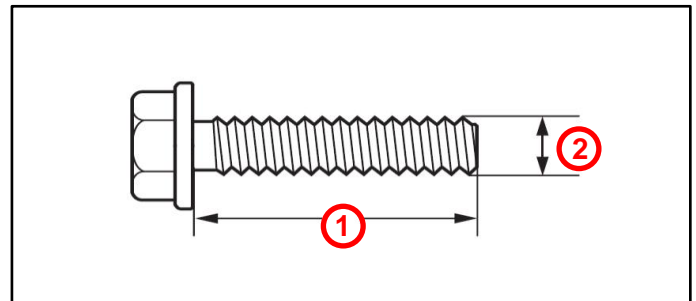

1	Nominal Length
2	Diameter