



INSTRUCTION TO SERVICE

ITS: 5944	
SECTION:	Body
WRITTEN BY:	Kevin Robinson
SUBJECT:	Inspect mirror spacer and replace as required.

ITS5944

THIS DOCUMENT AND THE CONTENTS DISCUSSED HEREIN ARE THE CONFIDENTIAL AND PROPRIETARY INFORMATION OF NEW FLYER INDUSTRIES CANADA ULC AND NEW FLYER OF AMERICA INC. AND ARE DISCLOSED BY NEW FLYER IN CONFIDENCE. THIS DOCUMENT AND THE CONTENTS HEREIN ARE NOT TO BE DISCLOSED BY THE INTENDED RECIPIENT WITHOUT THE PRIOR WRITTEN AUTHORIZATION OF NEW FLYER. ANY UNAUTHOIZED DISCLOSURE, REPRODUCTION OR OTHER DISTRIBUTION OF THIS DOCUMENT OR INFORMATION IS STRICTLY PROHIBITED AND MAY RESULT IN ACTION BEING TAKEN AGAINST THE PARTY MAKING THE UNAUTHORIZED DISCLOSURE. THIS DOCUMENT AND ALL COPIES HEREOF MUST BE RETURNED TO NEW FLYER UPON REQUEST.

PROCEDURE:

Inspection

1. Turn the main battery disconnect switch to the “OFF” position.
2. Review the curbside mirror arm spacer to determine whether it is powder coated black.
 - a. If powder coated black, place the bus back in service.

Remove and Replace

3. If the spacer is not found to be powder coated black, order a new spacer (NF PN A-34202533)
4. Inside the bus, disconnect the mirror harness and de-populate the wires on the mirror side from the connector.
5. Disassemble the mirror and remove it from the bus. Discard the existing spacer. Retain hardware for re-use.
6. Clean the sealant off of the mounting plate, left on the bus and the mirror base.
7. Replace the existing spacer with the new one, re-routing the harness into the coach.
8. Apply a thin layer of clear sealant between the mounting plate and the spacer and also between the spacer and the mirror base. Refer to Figure 1 for exploded view of CS mirror install.

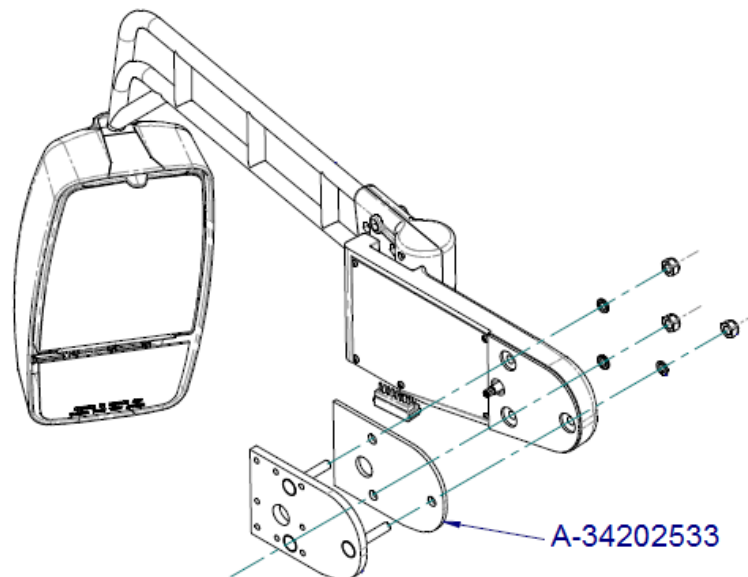

Figure 1: Enter Description of Figure Here

9. Secure the mirror base to the bus with three new nylon lock nuts (NF PN A-87280306).
10. Remove all tools and debris and return the bus to service.

LABOUR ESTIMATE

	Operation	Men	Hours	Labour Time M X HR
1	Inspect mirror spacer	1	0.13	0.13
2	Remove and replace as required	1	0.5	0.5

PARTS REQUIRED

Item	Part Number	Description	Qty. per Coach	Units	Notes
1	A-34202533	Enter part description from Oracle	1	EA	
2	A-87280306	NUT NYLON INSERT PDIN982 M10-M10	3	EA	
3	NPN	Clear sealant	A/R		Source Locally