

© 2014 Mazda Motor of America, Inc.

Subject: VARIOUS AUDIO SYSTEM CONCERNS WITH TUNER AND AMP UNIT (TAU)	Bulletin No: 09-021/14
	Last Issued: 04/29/2014

BULLETIN NOTE

- This bulletin supersedes the previous bulletin 09-038/13, issued on 12/19/13 and 12/23/13. The APPLICABLE MODEL(S)/VINS and WARRANTY INFORMATION have been revised.
- Changes are noted below in Red beside the change bar.

APPLICABLE MODEL(S)/VINS

2014 Mazda3 vehicles (with MAZDA CONNECT) with VINs lower than JM1BM*****194012 (produced before March 17, 2014)

DESCRIPTION

Some vehicle may experience any one of the symptoms below that can be resolved with a modified TAU.

- AM/FM/XM cannot be selected as they are grayed out
- Radio station returns to 87.9MHz on its own
- Audio sound setting resets on its own
- TAU version is displayed as "not available"

Customers having any of these concerns should have their vehicle repaired using the following repair procedure.

REPAIR PROCEDURE

1. Verify customer concern.
2. On vehicle with a touchscreen (A), remove the TAU (B) and replace with a modified one. Refer to MS3 online instructions or Workshop manual (section 09-20 TUNER AND AMP UNIT (TAU) REMOVAL/INSTALLATION).

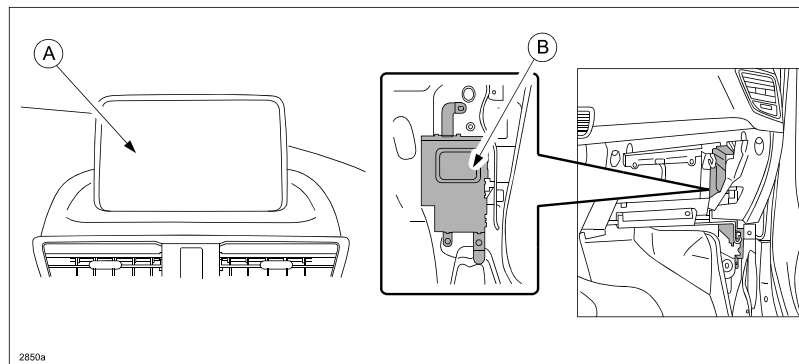

NOTE: When replacing the tuner and amp unit (TAU) with a new one for any reason, refer to TSB 09-030/13 SIRIUSXM REGISTRATION AFTER TUNER AND AMP UNIT (TAU) REPLACEMENT.

3. Verify repair.

PART(S) INFORMATION

Use exchange unit only from United Radio. DO NOT automatically order a new part for warranty replacement.

Part Number	Description	Qty.	Notes
BHP1-66-DRX*	TAU	1	Confirm the part number in the EPC for the subject VIN.
BHP5-66-DRX*	TAU	1	
BJD5-66-DRX*	TAU (w/ XM Radio)	1	
BJD6-66-DRX*	TAU (w/ XM Radio)	1	

* Any suffix

WARRANTY INFORMATION

NOTE:

- This warranty information applies only to verified customer complaints on vehicles eligible for warranty repair.
- This repair will be covered under Mazda's New Vehicle Limited Warranty term.
- Additional diagnostic time cannot be claimed for this repair.

Warranty Type	A
Symptom Code	61
Damage Code	9H
Part Number Main Cause	Select the correct part number from the Parts Information listed above.
Quantity	0
Operation Number / Labor Hours:	XXK2CXRX / 0.3 Hrs.