



# Recall Bulletin



## PRODUCT SAFETY RECALL

**SUBJECT:** Ignition Switch Replacement

**MODELS:** 2005-2007 Chevrolet Cobalt  
2005-2006 Pontiac Pursuit (Canada Only)  
2007 Pontiac G5

Vehicles involved in this safety recall are also involved in safety recall 14113 or 14133. Check the Investigate Vehicle History (IVH) screen in the GM Global Warranty Management (GWM) system to determine which additional field action is applicable. Perform the service procedure provided in that bulletin in conjunction with the repair described in this bulletin.

In the interest of customer satisfaction and to assist with dealer throughput, recall repairs for 13454 and 14113 or 14133 should be performed in a single visit. Customers will receive a notification letter in the near future advising them that parts are becoming available for recalls 13454 and 14113 or 14133, and they should contact their dealer to arrange a service appointment for the recall repairs. When contacted for a service appointment, schedule their appointment as soon as possible based on parts availability. Please place orders only for the ignition switch part number 23215459 and include the VIN. Orders will be fulfilled with parts needed for both recalls based on this.

### CONDITION

General Motors has decided that a defect which relates to motor vehicle safety exists in 2005-2007 model year (MY) Chevrolet Cobalt, 2005-2006 MY Pontiac Pursuit, and 2007 MY Pontiac G5 vehicles. There is a risk, under certain conditions, that the ignition switch may move out of the "run" position, resulting in a partial loss of electrical power and turning off the engine. This risk increases if the key ring is carrying added weight (such as more keys or the key fob) or the vehicle experiences rough road conditions or other jarring or impact related events. If the ignition switch is not in the run position, the air bags may not deploy if the vehicle is involved in a crash, increasing the risk of injury or fatality.

**Whenever a customer contacts you about the recalls it is imperative that you remind them of the following:**

**Until the recall repairs have been performed, it is very important before exiting the vehicle to make sure the vehicle is in "Park," or in the case of a manual transmission, to put the transmission into reverse gear and set the parking brake. Also, customers**

**should remove all items from their key ring, leaving only the vehicle key. The key fob (if applicable), should also be removed from the key ring.**

### CORRECTION

Dealers are to replace the ignition switch.

### VEHICLES INVOLVED

All involved vehicles are identified by Vehicle Identification Number on the Investigate Vehicle History screen in GM Global Warranty Management system. Dealership service personnel should always check this site to confirm vehicle involvement prior to beginning any required inspections and/or repairs. It is important to routinely use this tool to verify eligibility because not all similar vehicles may be involved regardless of description or option content.

For dealers with involved vehicles, a listing with involved vehicles containing the complete vehicle identification number, customer name, and address information has been prepared and will be provided to US and Canadian dealers through the GM GlobalConnect Recall Reports. Dealers will not have a report available if they have no involved vehicles currently assigned.

The listing may contain customer names and addresses obtained from Motor Vehicle Registration Records. The use of such motor vehicle registration data for any purpose other than follow-up necessary to complete this recall is a violation of law in several states/provinces/countries. Accordingly, you are urged to limit the use of this report to the follow-up necessary to complete this recall.

### PART INFORMATION

The parts required to complete this recall are to be obtained from General Motors Customer Care and Aftersales (GMCCA). Please refer to your "involved vehicles listing" before ordering.

<b>Part Number</b>	<b>Description</b>	<b>Quantity/Vehicle</b>
23215459	Ignition and Start Switch	1

**Note:** GMCCA will utilize the VIN number provided on the ignition switch SPAC order to place an order on your behalf for the parts required for this recall as well as to complete safety recall 14113 or 14133, whichever is applicable. This will ensure alignment of the ignition switch shipment with the parts needed to complete all required recalls. You may receive the parts required for the repair as kit number 23232575 (Chevrolet branded keys) or kit number 23232576 (unbranded keys for Saturn or Pontiac vehicles). Each kit will contain an ignition switch, an ignition lock cylinder, two keys and two key rings.

**Until further instructions are received, dealers should order parts as a CSO and then immediately upgrade the order to a SPAC case. Note that normal DRO and CSO orders will not be accepted at this time.**

## SERVICE PROCEDURE

**Note:** Vehicles involved in this safety recall are also involved in safety recall 14113 or 14133. Check the Investigate Vehicle History (IVH) screen in the GM Global Warranty Management (GWM) system to determine which additional field action is applicable. Perform the service procedure provided in that bulletin in conjunction with the repair described in this bulletin.

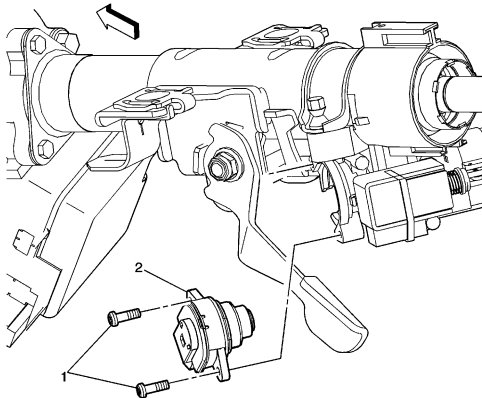

2085987

1. Remove the ignition switch from the vehicle. Refer to *Ignition and Start Switch Replacement* in SI.
2. Install a new ignition switch. Refer to *Ignition and Start Switch Replacement* in SI.

## CUSTOMER REIMBURSEMENT – U.S.

Customer requests for reimbursement of previously paid repairs for the recall condition are to be submitted to the dealer by May 31, 2015, unless otherwise specified by state law. If this is not convenient for the customer, they may mail the completed Customer Reimbursement Request Form and all required documents to the GM Customer Assistance Center.

**All reasonable and customary costs to correct the condition described in this bulletin should be considered for reimbursement. Any questions or concerns should be reviewed with your GM representative prior to processing the request.**

When a customer requests reimbursement, they must provide the following:

- A completed Customer Reimbursement Request Form. This form is mailed to the customer or can be obtained through GM GlobalConnect.
- The name and address of the person who paid for the repair.
- Paid receipt confirming the amount of the repair expense, a description of the repair, and the person or entity performing the repair.

**IMPORTANT:** GM requires dealers to approve or deny a reimbursement request within 30 days of receipt. If a reimbursement request is approved, the dealer should immediately issue a check to the customer and submit an appropriate warranty transaction for the incurred expense. If a reimbursement request is denied, the dealer MUST provide the customer with a clear and concise explanation, in writing, as to why the request was denied. The bottom portion of the Customer Reimbursement Request Form may be used for this purpose. If the denial was due to missing documents, the customer can resubmit the request when the missing documents are obtained, as long as it is still within the allowed reimbursement period.

Warranty transactions for customer reimbursement of previously paid repairs are to be submitted as required by GM Global Warranty Management. Additional information can also be found in Warranty Administration Bulletin 11-00-89-004.

#### CUSTOMER REIMBURSEMENT - For Canada and Export

Customer requests for reimbursement of previously paid repairs to correct the condition described in this bulletin are to be submitted to the dealer prior to or by May 31, 2015.

When a customer requests reimbursement, they must provide the following:

- Proof of ownership at time of repair.
- Original paid receipt confirming the amount of unreimbursed repair expense(s) (including Service Contract deductibles), a description of the repair, and the person or entity performing the repair.

All reasonable and customary costs to correct the condition described in this bulletin should be considered for reimbursement. Any questions or concerns should be reviewed with your GM representative prior to processing the request.

#### COURTESY TRANSPORTATION AND VEHICLE TOWING – For U.S. and Canada

For purposes of this recall, it is permissible to offer courtesy transportation to those customers who express concern about the continued use of their vehicle or who require alternate transportation while the vehicle is in for the recall repairs. The availability of courtesy transportation to such customers is very important in maintaining customer satisfaction. Dealers are to ensure that these customers understand that shuttle service or some other form of courtesy transportation is available and will be provided at no charge. Dealers should refer to the General Motors Service Policies and Procedures Manual for Courtesy Transportation guidelines. In addition, for purposes of this recall, it is permissible to provide free towing to a customer who may be concerned about operating their vehicle.

WARRANTY TRANSACTION INFORMATION

Submit a transaction using the table below. All transactions should be submitted as a ZFAT transaction type, unless noted otherwise.

<b>Labor Code</b>	<b>Description</b>	<b>Labor Time</b>	<b>Net Item</b>
9100356	Replace Ignition & Start Switch	0.4	N/A
9100402*	Courtesy Transportation	N/A	***
9100403**	Customer Reimbursement Approved	0.2	****
9100404**	Customer Reimbursement Denied - For US Dealers Only	0.1	N/A

\* To avoid having to “H” route this transaction for approval, it must be submitted prior to the repair transaction (U.S. only).

\*\* To avoid having to “H” route this transaction for approval, it must be submitted prior to the repair transaction (U.S. and Canada). Note that customer reimbursement will not close this recall.

\*\*\* The amount identified in “Net Item” should represent the actual dollar amount for courtesy transportation.

\*\*\*\* The amount identified in “Net Item” should represent the actual dollar amount reimbursed to the customer.

CUSTOMER NOTIFICATION – For US and Canada

General Motors will notify customers of this recall on their vehicle.

CUSTOMER NOTIFICATION – For Export

Letters will be sent to known owners of record located within areas covered by the US National Traffic and Motor Vehicle Safety Act. For owners outside these areas, dealers should notify customers using the attached sample letter.

DEALER RECALL RESPONSIBILITY – For US and Export (US States, Territories, and Possessions)

It is a violation of Federal law for a dealer to deliver a new motor vehicle or any new or used item of motor vehicle equipment (including a tire) covered by this notification under a sale or lease until the defect or noncompliance is remedied.

The U.S. National Traffic and Motor Vehicle Safety Act provides that each vehicle that is subject to a recall of this type must be adequately repaired within a reasonable time after the customer has tendered it for repair. A failure to repair within sixty days after tender of a vehicle is prima facie evidence of failure to repair within a reasonable time. If the condition is not adequately repaired within a reasonable time, the customer may be entitled to an identical or reasonably equivalent vehicle at no charge or to a refund of the purchase price less a reasonable allowance for depreciation. To avoid having to provide these burdensome remedies, every effort must be made to promptly schedule an appointment with each customer and to repair their vehicle as soon as possible. In the recall notification letters, customers are told how to contact the US National Highway Traffic Safety Administration if the recall is not completed within a reasonable time.

## DEALER RECALL RESPONSIBILITY – All

All unsold new vehicles in dealers' possession and subject to this recall must be held and inspected/repaired per the service procedure of this recall bulletin before customers take possession of these vehicles.

Dealers are to service all vehicles subject to this recall at no charge to customers, regardless of mileage, age of vehicle, or ownership, from this time forward.

Customers who have recently purchased vehicles sold from your vehicle inventory, and for which there is no customer information indicated on the dealer listing, are to be contacted by the dealer. Arrangements are to be made to make the required correction according to the instructions contained in this bulletin. A copy of the customer letter is provided in this bulletin for your use in contacting customers. Recall follow-up cards should not be used for this purpose, since the customer may not as yet have received the notification letter.

In summary, whenever a vehicle subject to this recall enters your vehicle inventory, or is in your dealership for service in the future, you must take the steps necessary to be sure the recall correction has been made before selling or releasing the vehicle.



## Question & Answer Document for Upcoming Safety Recall 13454

**Q1. What models are involved?**

A1. Certain 2005-2007 model year Chevrolet Cobalt, 2005-2006 model year Pontiac Pursuit (Canada only) and 2007 model year Pontiac G5 vehicles.

**Q2. Why are they being recalled?**

A2. The ignition switch torque performance may not meet General Motors' specification. If the torque performance is not to specification, and the key ring is carrying added weight or the vehicle goes off road or experiences some other jarring event, the ignition switch may inadvertently be moved out of the "run" position. The timing of the key movement out of the "run" position, relative to the activation of the sensing algorithm of the crash event, may result in the airbags not deploying, increasing the potential for occupant injury in certain kinds of crashes.

**Q3. How was this condition discovered?**

A3. GM initially learned of field incidents involving moderately severe to severe crashes in which the cars' frontal airbags did not deploy.

**Q4. Why was no recall ordered earlier?**

A4. The incident rate was very low with no growing trend.

**Q5. Why did GM not make this public sooner?**

A5. The incident rate was very low with no growing trend.

**Q6. What has changed? Why are you recalling the cars now?**

A6. We have now completed our internal analysis and concluded that a recall of the ignition switch for certain model years is the appropriate action to bring closure to this issue.

**Q7. Did the NHTSA order you to do a recall?**

A7. No. GM independently made this decision. There was no government involvement. We took our findings to the agency and told NHTSA we would voluntarily recall these cars.

**Q8. What about the Chevrolet HHR and Saturn ION? They are similar vehicles. Why are they not being recalled?**

A8. Those vehicles have different physical layouts or electrical architecture and we have no confirmed reports of incidents involving non-deployment of frontal air bags occurring on these other vehicles under the conditions described above.

**Q9. Didn't GM issue a Preliminary Information Bulletin in 2005 warning dealers to be on the lookout for this condition?**

A9. At that time, we were investigating field incidents that involved inadvertent turning of the key cylinder and loss of electrical power, and the bulletin addressed those issues.

**Q10. What is the country breakdown of the recalled vehicles?**

A10.	US	619,122
	Canada	153,310
	Mexico	6,130
	Total	778,562

**Q11. The Cobalt has had a lot of recalls and problems in recent years. How many times have you recalled these cars?**

A11. There have been seven safety or non-compliance recalls of Cobalt models since production began in 2004. In most cases, the completion rate for repairs exceeds 80 percent.

**Q12. How dangerous is this condition? Is my car safe to drive?**

A12. Even with the reduced torque condition, these vehicles can be safely driven. Customers should remove non-essential items from their key ring until the corrective action is completed.

**Q13. When can I get my car fixed?**

A13. We are working with our suppliers to expedite the availability of parts. We expect to have parts available beginning in April. Customers will receive a letter in early April.

**Q14. How do I know if my vehicle is involved?**

A14. All 2005 through 2007 models are included.