

Technical Service Bulletin



94 Xenon headlight flickers or is inoperative on one side (DTC 00978 or 00979)

94 14 31 2021751/4 January 16, 2014. Supersedes Technical Service Bulletin Group 94 number 10-19 dated June 7, 2010 for reasons listed below.

Model(s)	Year	VIN Range	Vehicle-Specific Equipment
A4	2009	N000001 - N050000 A000001 - A179000	Xenon headlights
A5	2008	All	
A5	2009	000001 - 034000	
Q5	2009	000001 - 003400	

Condition

REVISION HISTORY		
Revision	Date	Purpose
4	-	Revised header data (Added DTCs) Revised <i>Service</i> (Clarified instructions) Revised <i>Warranty</i> (Corrected labor operations)
3	6/7/2010	Revised <i>Warranty</i>
2	4/29/2010	Revised <i>Service</i> (Clarification of procedure and bulb date code decoder) Revised <i>Warranty</i>
1	10/6/2009	Original publication

- The xenon headlight on one side of the vehicle flickers or is inoperative. The condition may be intermittent or permanent.
- One of the following DTCs is stored in the electronic central electronics control module, J519, (address word 09) for the affected headlight:
 - **DTC 00978** (Left Low Beam Headlight -M29- Electrical fault in circuit).
 - **DTC 00979** (Right Low Beam Headlight -M31- Electrical fault in circuit).
- Only xenon bulbs manufactured by Philips are affected.

Technical Background

The xenon bulb may have an internal leak at the crimp of the electrodes, and xenon gas can be released (Figure 1).

Without an adequate amount of xenon gas, the bulb cannot establish a stable light arc. The xenon igniter control unit (ballast) repeatedly tries to establish an arc, which may cause a flickering of the headlight.

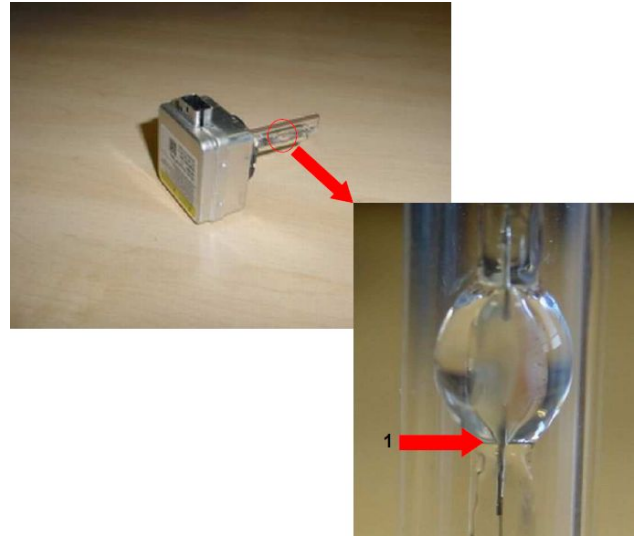

Figure 1. The location of the xenon bulb leak.

Production Solution

Improved xenon bulbs in production.

Service

If the condition occurs permanently:

1. Swap the bulbs between the left and right headlights.
 - If the condition *does not* follow the bulb:
Check the power supply and control unit of the headlight assembly according to Guided Fault Finding.
 - If the condition *does* follow the bulb:
Proceed to step 1 under *If the condition occurs intermittently*, below.

If the condition occurs intermittently:

1. Locate the 4-digit alphanumeric production date code on the label of each of the xenon bulbs (Figure 1)



Figure 1. Location of the 4-digit alphanumeric production date code.

2. Determine the production of the xenon bulbs by using the *Production Date Decoder* table below.
 - If the bulbs were produced *before* June 1, 2008:
Replace both bulbs, even without a customer complaint. The bulbs will be covered under the New Vehicle Limited Warranty (NVLW) extension.
 - If the bulbs were produced *on or after* June 1, 2008:
Replace only the failing bulb. The bulb will be covered under the New Vehicle Limited Warranty (NVLW) extension.

Technical Service Bulletin



Production Date Decoder (read code from left to right)

If the first character is a letter:		If the first character is a number:		
First character: (Indicates month)	A = January B = February C = March D = April E = May F = June	G = July H = August J = September K = October L = November M = December	First character: (Indicates year)	0 = 2010 1 = 2011 2 = 2012 3 = 2013
Second character: (Indicates year)	6 = 2006 7 = 2007 8 = 2008 9 = 2009	Second character: (Indicates month)	A = January B = February C = March D = April E = May F = June	G = July H = August J = September K = October L = November M = December
Third and fourth characters: (Indicate day)	01 = 1st 02 = 2nd 03 = 3rd 04 = 4th 05 = 5th 06 = 6th 07 = 7th 08 = 8th 09 = 9th 10 = 10th 11 = 11th 12 = 12th 13 = 13th 14 = 14th 15 = 15th 16 = 16th	17 = 17th 18 = 18th 19 = 19th 20 = 20th 21 = 21st 22 = 22nd 23 = 23rd 24 = 24th 25 = 25th 26 = 26th 27 = 27th 28 = 28th 29 = 29th 30 = 30th 31 = 31st	Third and fourth characters: (Indicate day)	01 = 1st 02 = 2nd 03 = 3rd 04 = 4th 05 = 5th 06 = 6th 07 = 7th 08 = 8th 09 = 9th 10 = 10th 11 = 11th 12 = 12th 13 = 13th 14 = 14th 15 = 15th 16 = 16th

Technical Service Bulletin



Warranty

Claim Type:	Use applicable claim type. If vehicle is outside any warranty, this Technical Service Bulletin is informational only.		
Service Number:	9459		
Damage Code:	0040		
Labor Operations:	For A4 and A5 - If one bulb was replaced:		
	1 Headlight assembly remove+reinstall	9415 1901	50 TU
	1 Gas discharge bulb remove+reinstall	9459 1950	10 TU
	2 Headlight assembly adjust	9415 1600	20 TU
	For A4 and A5 - If both bulbs were replaced:		
	2 Headlight assembly remove+reinstall	9415 2001	70 TU
	2 Gas discharge bulb remove+reinstall	9459 2050	20 TU
	2 Headlight assembly adjust	9415 1600	20 TU
	For A4 and A5 - If bulbs were tested due to permanent failure:		
	2 Gas discharge bulb remove+reinstall	9459 2050	20 TU
	Test/swap 2 gas discharge bulbs	9459 3299	20 TU
	2 Headlight assembly adjust	9415 1600	20 TU
	For Q5 - If one bulb was replaced (left side):		
	1 Gas discharge bulb remove+reinstall	9459 1900	50 TU
	2 Headlight assembly adjust	9415 1600	20 TU
	For Q5 - If one bulb was replaced (right side):		
1 Gas discharge bulb remove+reinstall	9459 1901	90 TU	
2 Headlight assembly adjust	9415 1600	20 TU	

Technical Service Bulletin



	For Q5 - If both bulbs were replaced:		
	2 Gas discharge bulb remove+reinstall	9459 2000	110 TU
	2 Headlight assembly adjust	9415 1600	20 TU
	For Q5 - If bulbs were tested due to permanent failure:		
	2 Gas discharge bulb remove+reinstall	9459 2000	110 TU
	Test/swap 2 gas discharge bulbs	9459 3299	20 TU
	2 Headlight assembly adjust	9415 1600	20 TU
Diagnostic Time: (All vehicles)	GFF – Checking and clearing fault codes and basic settings	0150 0000	Time stated on diagnostic protocol (Max 40 TU)
	Road test prior to service procedure	No allowance	0 TU
	Road test after service procedure	No allowance	0 TU
	Technical diagnosis at dealer' s discretion (Refer to Section 2.2.1.2 and Audi Warranty Online for DADP allowance details)		
Claim Comment:	As per TSB #2021751/4		

All warranty claims submitted for payment must be in accordance with the *Audi Warranty Policies and Procedures Manual*. Claims are subject to review or audit by Audi Warranty.

Additional Information

All parts and service references provided in this TSB (2021751) are subject to change and/or removal. Always check with your Parts Department and service manuals for the latest information.