



HYUNDAI | NEW THINKING.
NEW POSSIBILITIES.

TECHNICAL SERVICE BULLETIN

GROUP
BODY ELECTRICAL

NUMBER
14-BE-010

DATE
JUNE, 2014

MODEL(S)
GENESIS SEDAN (DH)

SUBJECT: BLUE LINK: TELEMATICS UNIT LOCATION

DESCRIPTION: This bulletin provides information to assist in locating the Telematic Unit for the 15 MY Genesis (DH). Please refer to the shop manual for more information on unit replacement procedures and connector pin out information.

Applicable Vehicles: 2015 Genesis Sedan (DH)

TOUCH SCREEN ONLY NAVIGATION SYSTEM (NON-PREMIUM): TELEMATIC UNIT LOCATION



The TMU (Telematics Unit) is integrated inside the head unit. If TMU replacement is necessary, the entire head unit will need to be replaced.

CAUTION

- Never replace with a used head unit.
- Never swap the head units between vehicles. NOT even for testing purposes only.

Circulate To: General Manager, Service Manager, Parts Manager, Warranty Manager, Service Advisors, Technicians, Body Shop Manager, Fleet Repair

PREMIUM 2.0 NAVIGATION SYSTEM: TELEMATIC UNIT LOCATION (JOG DIAL SYSTEM)

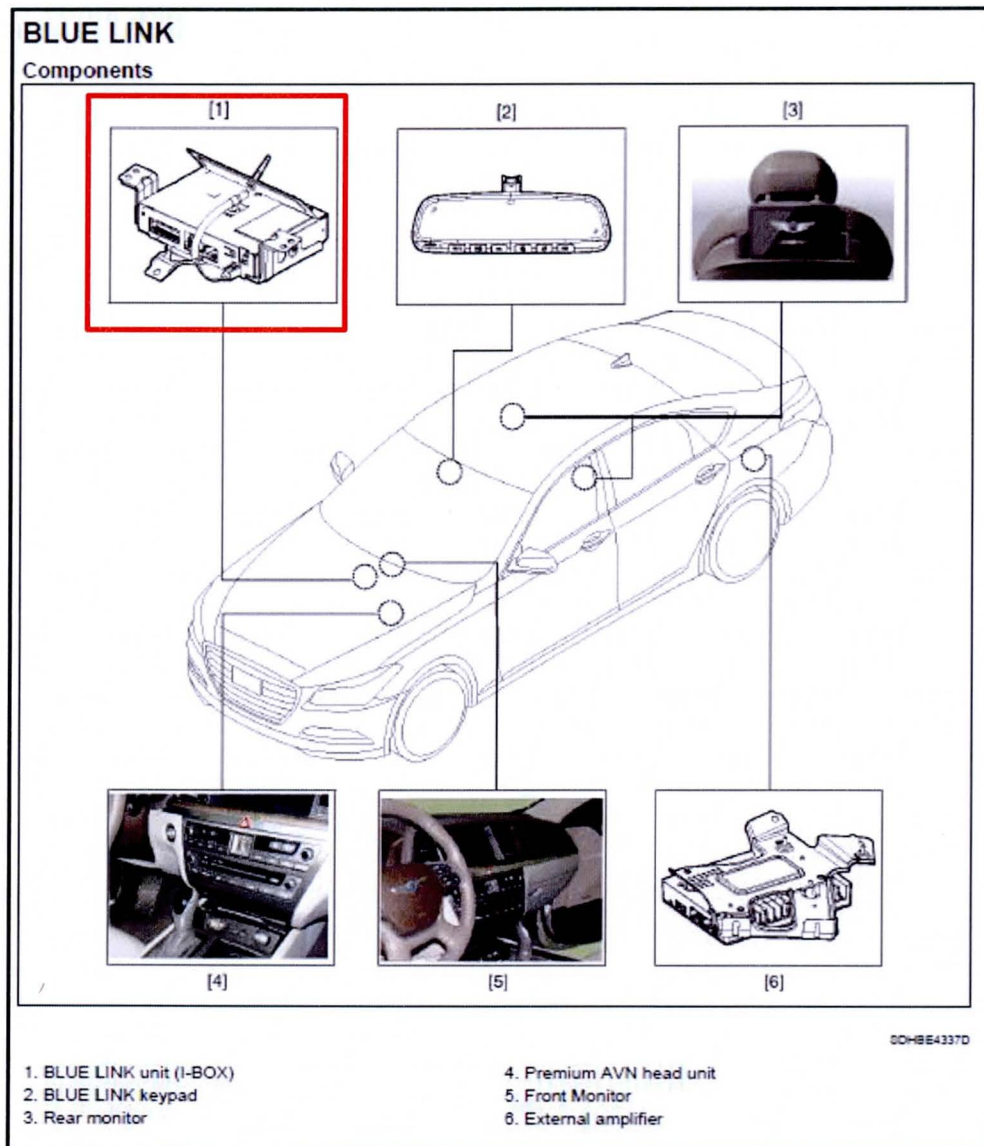

The TMU/I-Box (Telematics Unit) is external. Replacement of the TMU will require replacement of the Blue Link Unit (Item #1).

PROCEDURE: TELEMATIC UNIT REPLACEMENT

Jog Dial System, the TMU should be removed by the below procedure. Please refer to the shop manual for details.

Removal

1. Remove the battery (-) terminals.
2. Remove the AVN monitor (Body – "Premium AVN system")
3. Disconnect the cables and connectors (A) from the TMU unit.

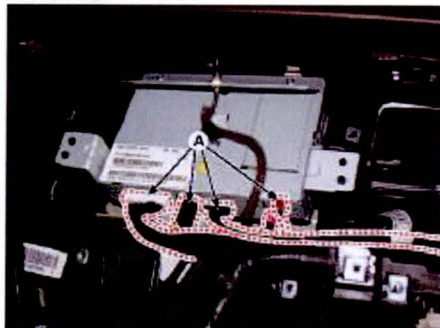

4. Remove the TMU unit after loosening the screws and nuts.

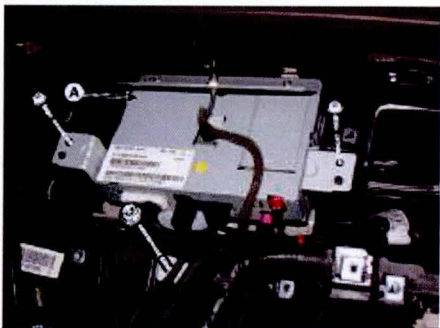

Components

[Premium AVN]

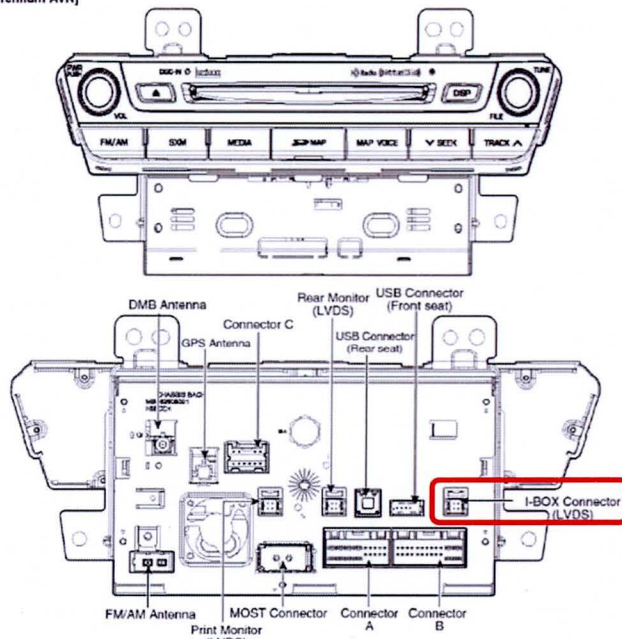

CAUTION

- Never replace with a used Blue Link TMU.
- Never swap the Blue Link TMU between vehicles. NOT even for testing purposes only.