

14U-644

3 1-14-15

Technical BULLETIN

©2014 YAMAHA MOTOR CORPORATION, U.S.A.



SAFETY RECALL This modification has top priority. This bulletin must be performed immediately to ensure customer safety.

NOTE: Bulletins that announce a recall will have an "R" at the end of the bulletin number.

CERTAIN 2014 YZF-R6 MODELS FACTORY MODIFICATION CAMPAIGN – Aluminum Wheel Hardness

i INTRODUCTION

Yamaha Motor Corporation, U.S.A. has decided that a defect which relates to motor vehicle safety exists in certain 2014 YZFR6E and YZFR6EC ("YZF-R6") model motorcycles. In affected motorcycles, the metal in the front and rear wheels does not meet required hardness specifications due to a manufacturing error. Therefore, the wheel bearing could move from its original position, allowing the wheel to loosen, and also wheel deformation could allow air to leak past the tire. These conditions could result in the possibility of a crash with injury or death.



To correct this problem, Yamaha is initiating a Factory Modification Campaign. Affected units must have both front and rear wheels replaced.

Yamaha is notifying all registered owners of affected motorcycles by mail. A copy of this letter is included in this bulletin. The customer should take this letter along with the affected motorcycle to an authorized Yamaha dealer for modification.

A computer report listing all affected motorcycles invoiced to your dealership is included with this bulletin. Use the list to help ensure all motorcycles are modified. All sold motorcycles that have been registered with Yamaha will show the customer's name and address. Your dealership must notify the owner of any affected motorcycle that was actually sold but listed as "unsold" in the report.

You must modify all affected motorcycles in your inventory as well as all customer-owned motorcycles brought to you for this service. Any affected motorcycle that you purchase from Yamaha in the future may also require modification. If you purchase a motorcycle from another dealer or Yamaha, check to see if the procedures in this bulletin have already been performed before you sell the motorcycle.

Motorcycles that are affected should not be operated until they are modified. It is a violation of Yamaha policy for your dealership to deliver any affected motorcycle to customers until the procedures in this bulletin are performed.

When the modification on each motorcycle is performed, follow the Warranty information section of this bulletin to receive reimbursement. Be sure to use the Factory Modification Campaign procedures in Chapter 7 of the **Warranty and Y.E.S. Handbook** (LIT-11760-00-08).



DEALER ACTION SUMMARY

Unsold

Units: Replace the front and rear wheel assemblies on all units within the affected range, matching the wheel color and tire brand to the original.

Sold

Units: Check first to be sure the modification has not already been performed (see Identification Procedure in this bulletin for more information). If not, replace the front and rear wheel assemblies on all units within the affected range, matching the wheel/pinstripe color to the original.

Parts:

Yes, order a YZFR6 wheel assy kit for each affected unit. There is a kit available to match each original wheel/pinstripe color combination used on affected units. Refer to the Parts Information section.

Warranty:

Factory Modification Campaign. See the Warranty Information section of this bulletin. This modification applies to all affected units regardless of ownership or warranty status.

Notify

Customers: Yes, you must immediately contact any customer whose motorcycle shows as unregistered on the enclosed report. Yamaha has sent letters to customers whose motorcycles were registered with Yamaha as of 10/29/2014



AFFECTED RANGE

2014 YZFR6E

RJ16E-0032446, 0032448, 0032453, 0032458, 0032461, 0032465 ~ 0032471

2014 YZFR6EC

RJ16Y- 0008763 ~ 0008777



SERVICE PROCEDURES

The YZFR6 wheel kit includes both, the front and rear wheel assemblies. These assemblies include the bearings, seals, brake discs, and tires. Refer to the YZF-R6 Service Manual (LIT-11616-22-51) for procedures to remove and install the front and rear wheels. Tag and hold the original wheel/tire assemblies. Yamaha will be recalling the parts.



IDENTIFICATION PROCEDURE

Perform a unit status inquiry in YDS to check if the unit is in the affected range or if the unit has been modified.

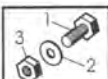

PARTS INFORMATION

Order the correct part number kit for the unit. Use the chart below to determine the correct kit to order based on the original wheel and pin stripe colors.

Part Number	Part Name	Wheel Color	Pin Stripe Color	Dealer Cost
90891-20226-00	YZFR6 Wheel Assy. DL BPR (Front and Rear Wheel Assemblies)	Black	Red	\$812.19
90891-20230-00	YZFR6 Wheel Assy. DL Y (Front and Rear Wheel Assemblies)	Yellow	None	\$812.19
90891-20231-00	YZFR6 Wheel Assy. BPW (Front and Rear Wheel Assemblies)	Matte Black	White	\$812.19



WARRANTY INFORMATION

The owner of each registered unit will receive a letter announcing this campaign. The customer's letter includes the Primary ID and Recall Number.

The modification is authorized for all affected motorcycles, both sold and unsold, regardless of ownership or warranty status. You do not need the customer's letter to perform the modification or to file for reimbursement.

Submit a Recall Request for the parts* and labor as described below using Recall Number **990088**. The labor allowance is **0.6** hour.

YDS:

When signed on to YDS, click on the Service Tab, and then "Recall Request-Add." This function will allow you to enter multiple Primary IDs for the same recall. Remember, YDS requires a 7-digit serial number, so use a "0" as the first digit. The system will check your submission instantly to make sure the Primary ID numbers you've entered are valid for the recall. You can check back the next day for your claim numbers to track your credit.

MAIL:

Complete a Recall Reimbursement Request (LIT-11790-00-03) as shown below:

Dealer Number		Dealer Name							
<input type="text"/>		<input type="text"/>							
Recal Number		Primary I.D.		Date Completed		Status			
9	9	R	J	1	1	1	1	M	I
0	0	1	6	0	0	0	3		
8	8	E	-	0	0	3	-		
				2	X	X	X		

If you have any questions about proper procedures for Factory Modification Campaigns, see Chapter 7 in your **Warranty and Y.E.S. Handbook** (LIT-11760-00-08).

* **NOTE:** You will receive a Parts Recall form for part number 90891-20230-00. Return the original wheel/tire assemblies you replaced even if this part number does not correspond.



YAMAHA MOTOR CORPORATION, U.S.A. 6555 Katella Avenue, Cypress, CA 90630-5101 (714) 761-7300

IMPORTANT SAFETY RECALL NOTICE

October 30, 2014

This notice applies to your vehicle, (VIN XXXXXXXXXXXXXXXXX)

Dear Yamaha Owner:

This notice is sent to you in accordance with the requirements of the National Traffic and Motor Vehicle Safety Act. Yamaha Motor Corporation, U.S.A. has decided that a defect which relates to motor vehicle safety exists in certain 2014 YZFR6E and YZFR6EC ("YZF-R6") model motorcycles. Our records show that you own one of the affected motorcycle shown above.

The reason for this recall:

In affected motorcycles, the metal in the front and rear wheels does not meet required hardness specifications due to a manufacturing error. Therefore, the wheel bearing could move from its original position, allowing the wheel to loosen, and also wheel deformation could allow air to leak past the tire. These conditions could result in the possibility of a crash with injury or death.

What Yamaha and your dealer will do:

To correct this defect, your authorized Yamaha dealer will install new front and rear wheel and tire assemblies. The procedure takes a little over 30 minutes to perform, but your dealer may need to keep your motorcycle longer depending upon their schedule. There will be no charge to you for this procedure.

What you should do now:

Please call your Yamaha dealer to make a service appointment to have this procedure performed. At that same time, you can find out how long they expect to keep your motorcycle for this service. Remember to take this letter with you when you take in your motorcycle.

You should not ride your motorcycle until this modification is performed.

If you are unable to return to the Yamaha dealer who sold you the motorcycle, this service will be performed by any authorized Yamaha Motorcycle dealer. For the name of a dealer near you, call 1-800-88-YAMAHA or visit the Yamaha web site at: www.yamaha-motor.com.

If you have had this repair performed before you received this letter, you may be entitled to receive reimbursement for the cost of obtaining a pre-notification remedy of the problem associated with this repair. For more information, contact Yamaha Customer Relations at 1-800-962-7926.

Federal regulations require that any vehicle lessor receiving this recall notice must forward a copy of this notice to the lessee within 10 days.

If you need help:

If, after contacting your dealership, you have questions or concerns which the dealership is unable to answer, please write to:

Yamaha Motor Corporation, U.S.A.
Customer Relations Department
P.O. Box 6555
Cypress CA 90630
or call 1-800-962-7926.

If, after contacting Yamaha Customer Relations, you are still not satisfied that we have done our best to remedy the situation without charge and within a reasonable time, you may submit a written complaint to the Administrator, National Highway Traffic Safety Administration, 1200 New Jersey Avenue, SE., Washington, DC 20590; or call the Auto Safety Hotline at 1-888-327-4236 (TTY: 1-800-424-9153); or go to <http://www.safercar.gov>. Refer to campaign 14V-644.

If you no longer own this Yamaha:

If you have sold your motorcycle to another party, please call us toll-free at 1-800-962-7926 with the name and address of the new owner, along with the serial number shown to the right of your name and address above.

We're sorry to cause you any inconvenience, but we are sincerely concerned about your safety and continued satisfaction with our products. Thank you for giving your attention to this important matter.

Sincerely,
Customer Support Group
Yamaha Motor Corporation, U.S.A.