



Technical Bulletin

SB-10055859-8342

Model(s)	Year	Eng. Code	Trans. Code	VIN Range From	VIN Range To
Routan	2011-2012	All	All	All	All

Condition

46 14 07 August 14, 2014 **2033247** Supersedes Technical Bulletin V461404 dated April 15, 2014 to update the text in the "YES" answer of step 1 of Lower Control Arm Inspection.

Front Brake Judder And / Or Vibration

This bulletin involves installing new right and left front lower control arms, brake linings and resurfacing or replacing both front brake rotors.

Technical Background

Vehicle owners may feel brake pedal pulsation, steering wheel shake and/or floor pan vibration.

Note:

This bulletin applies to vehicles built before March 30th 2012 with PR codes 1LA – 1LB for 16 inch brake systems. Vehicles with PR 1LC have 17 inch brakes and are not applicable to this technical bulletin.

Production Solution

New improved brake pads and lower control arms introduced March 30th 2012.

Technical Bulletin

Service

REPAIR PROCEDURE:

Brake Pads and Rotors

1. Raise and support the vehicle.
2. Remove and replace front brake pads with kit Part No. 7B0698151D, see Repair Manual Group 46, Chassis, Brake System, Mechanical Components, Removal and Installation, Front Brake Pads in Elsa.
3. Do you have an on-car brake lathe?
 - a. YES - Proceed to [Step #6](#).
 - b. NO - Proceed to [Step #4](#) and [Step #5](#), disregard [Step #6](#).
4. Remove both front brake rotors, see Repair Manual Group 46, Chassis, Brake System, Mechanical Components, Removal and Installation, Front Brake Rotor in Elsa.
5. Install new front brake rotors Part No. 7B0615301C, see Repair Manual Group 46, Chassis, Brake System, Mechanical Components, Removal and Installation, Front Brake Rotor in Elsa.
6. Using an on-vehicle brake lathe, lightly resurface both front brake discs.

Note:

Follow all resurfacing directions and procedures associated with the equipment used.

Lower Control Arm Inspection

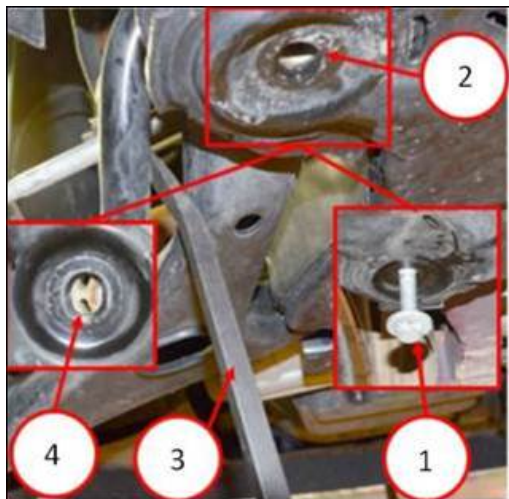

Call out 1. Remove the mounting bolt in Fig 1 to access the cross member hole (Callout 2)

Call out 3. Using a pry bar move the lower control arm so bushing slots are visible through the cross member hole.

Call out 4. Determine the slot type (long or short) shown in callout 4.

(Fig. 1) Front Lower Control Arm

Technical Bulletin

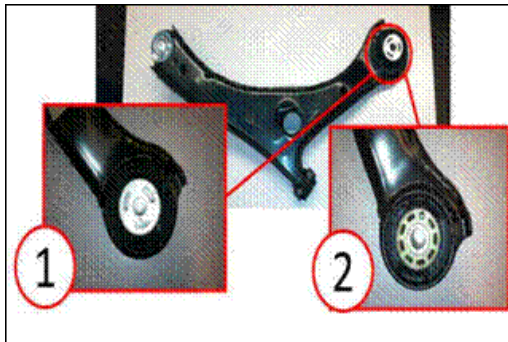

1 - Replace Previous Control Arm Bushing (Metal Substrate Inner)

2 - Retain Current Control Arm Bushing (Plastic Substrate Inner)

(Fig. 2) Front Lower Control Arm

Step 1. Inspect the bushing on the right and left lower control arm as show in (Fig. 2).

Did the bushing have eight slots as shown in call out 2 as compared to three slots in call out 1?

a. Yes >>> **Proceed to step 3.**

b. No >>> Proceed to Step 2.

Step 2. Remove and replace the right and left lower control arm. Refer to Repair Manual/Suspension Wheels Steering / Front Suspension Removal and installation/Lower Control Arm.

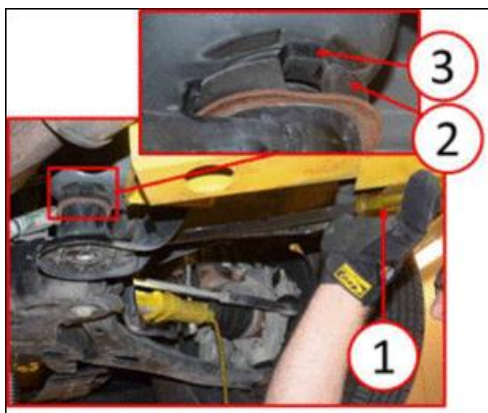

Fig. 3 Snubber Installation

Step 3. With the rear mounting bolt for the lower control arm still removed, position a pry bar between the crossmember and the body to lower the upper crossmember mount for snubber installation (Fig. 3).

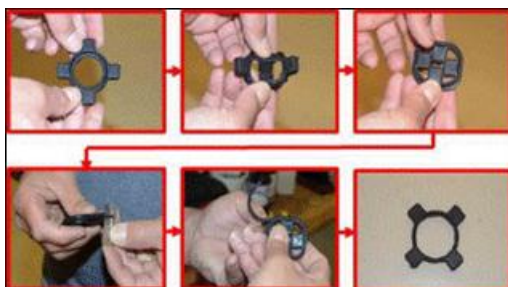

Fig. 4 Trim Snubber

Step 4. Prior to installing the snubbers, fold them inside out and trim the excess inner rib with a razor blade as shown in (Fig. 4). Return the snubbers to their original state and insert between the vehicle body and the left and right upper crossmember mount.

With the pry bar removed, install the right and left lower control arm rear mounting bolts and torque to 115Nm (114 ft. lbs.).



Technical Bulletin

Road test the vehicle for 5 miles.

Did any brake pedal pulsation, steering wheel shake and/or floor pan vibration exhibit.

- a. Yes >>> Continue further diagnosis.
- b. No >>> Return the vehicle to the customer.



Technical Bulletin

Warranty

Note:

All Routan pre and post road test time units are included in the labor operation. Therefore, no road test time units will appear in the designated area within the warranty table.

To determine if this procedure is covered under Warranty, always refer to the Warranty Policies and Procedures Manual ¹⁾					
Model(s)	Year(s)	Eng. Code(s)	Trans. Code(s)	VIN Range From	VIN Range To
Routan	2011-2012	All	All	All	All
SAGA Coding					
Claim Type:			Use applicable Claim Type ¹⁾		
Service Number:	Damage Code	HST		Damage Location (Depends on Service No.)	
4636	0010	CWM2033247		Use applicable when indicated in Elsa Web (L/R)	
Parts Manufacturer		Routan		USM ²⁾	
Labor Operation ³⁾ : Replace front brake pads and brake rotors, and replace Lower control arms, Install Snubbers			40175699 = 310 TU		
Labor Operation ³⁾ : Replace front brake pads and Resurface brake rotors, and replace Lower control arms, Install Snubbers			40174699 = 380 TU		
Labor Operation ³⁾ : Replace front brake pads and brake rotors, Install Snubbers			46365699 = 60 TU		
Labor Operation ³⁾ : Replace front brake pads and Resurface brake rotors - On vehicle, Install Snubbers			46504699 = 130 TU		
Causal Part:			7B0698151F		



Technical Bulletin

Diagnostic Time ⁴⁾		
GFF Time expenditure	01500000 = 00 TU max.	NO
Road Test	01210002 = 00 TU 01210004 = 00 TU	NO
Technical Diagnosis	01320000 = 00 TU max.	NO
Claim Comment: Input "As per Technical Bulletin 2033247" in comment section of Warranty Claim.		
<p>¹⁾ Vehicle may be outside any Warranty in which case this Technical Bulletin is informational only</p> <p>²⁾ Code per warranty vendor code policy.</p> <p>³⁾ Labor Time Units (TUs) are subject to change with ELSA updates.</p> <p>⁴⁾ Documentation required per Warranty Policy Procedures Manual.</p>		



Technical Bulletin

Required Parts and Tools

Part Description	Part No:	Quantity
Front Brake Pad Kit	7B0698151F	1
Front Wheel Brake Disc	7B0615301C	2
Front lower Control Arm (Right)	7B0407152F	1
Front lower Control Arm (Left)	7B0407151F	1
Snubber (Jounce Bumper)	7B0407303A	2

Tool Description	Tool No:
PRO-CUT International TM PFM 9.0	PCIPFM90VW
Hunter Engineering Company Model OCL 400	HUNOCL400VW

Additional Information

All part and service references provided in this Technical Bulletin are subject to change and/or removal. Always check with your Parts Dept. and Repair Manuals for the latest information.