



Mack Trucks, Inc.
Greensboro, NC USA

Field Service Bulletin Trucks

Date 2.2014 Group 313 No. 005 Release 01 Page 1(12)

SB-10055175-6332

Stackable Battery Box, Premature Battery
Corrosion
GU

FSB 313-005, Stackable Battery Box, Premature Battery Corrosion

(February 2014)

Changes have been made to the stackable 3 battery box used on certain MACK GU model chassis' from 2010–2013. This will improve the protection of the batteries from the environment therefore improving the condition of the battery terminals, cables, connections within the box in regards to corrosion.

Required Parts

Part #	Qty	Description	Application
22248322	1	Battery Shelf	Standard and Tandem Steer Mounting Location
* 22248326	1	Lower Hold Down	Standard only
* 22248327	1	Lower Hold Down	Tandem Steer Only
22248330	1	Lower Cover	Standard and Tandem Steer Mounting Location
21324949	1	Hold Down Bolt	Standard and Tandem Steer Mounting Location
22262398	1	Positive Jump Stud	Standard and Tandem Steer Mounting Location
21416154	1	Warning Label	Standard and Tandem Steer Mounting Location
25157779	1	Warning Label	Standard and Tandem Steer Mounting Location
25167207	1	Warning Label	Standard and Tandem Steer Mounting Location

Note: * Indicates parts are specific to mounting location.

Repair Procedure

Note: Information is subject to change without notice. Illustrations are used for reference only, and may differ slightly from the actual engine version. However, key components addressed in this information are represented as accurately as possible.

You must read and understand the precautions and guidelines in Service Information, Function Group 30, "General Safety Practices, Electrical and Electronics" before performing this procedure. If you are not properly trained and certified in this procedure, ask your supervisor for training before you perform it.

- 1 Secure the vehicle for service by parking it on a flat level surface, applying the parking brake, chocking the rear wheels, and placing the transmission in neutral.
- 2 Turn the battery disconnect switch off (If applicable).
- 3 Remove the driver side top step (If applicable).
- 4 Remove the upper and lower battery box covers.
- 5 Steam clean and blow dry (using an air nozzle) the cables, batteries and battery box assembly.
- 6 Remove the driver side fender extension attached to the battery box.
- 7 Cut and remove battery cable ties anchoring leads to upper battery hold down.

- 8 Disconnect the upper battery cables in order. Tape or cover each battery cable terminal as it is disconnected.

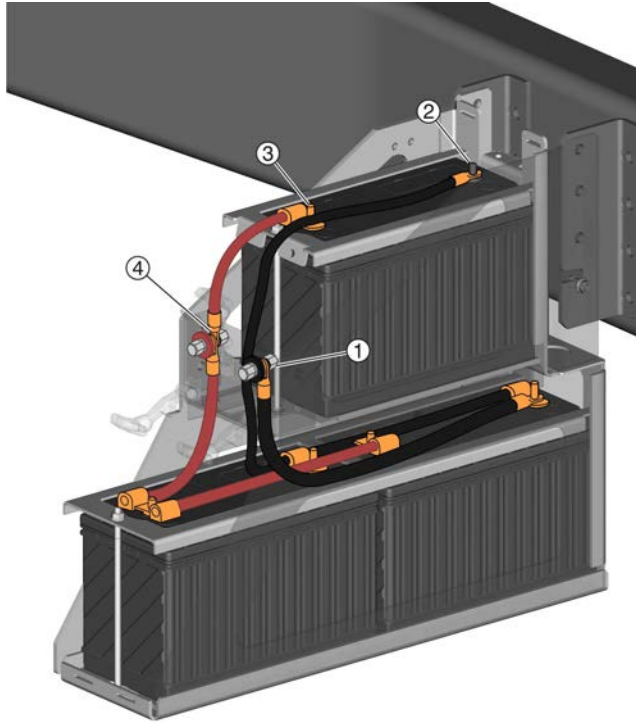

W3057042

- 9 Remove upper battery hold down and fastener.
10 Remove upper battery from tray. Ensure cab air bags are aired up to allow sufficient clearance to work.

11 Disconnect the lower battery cables in order. Tape or cover each battery terminal as it is disconnected.

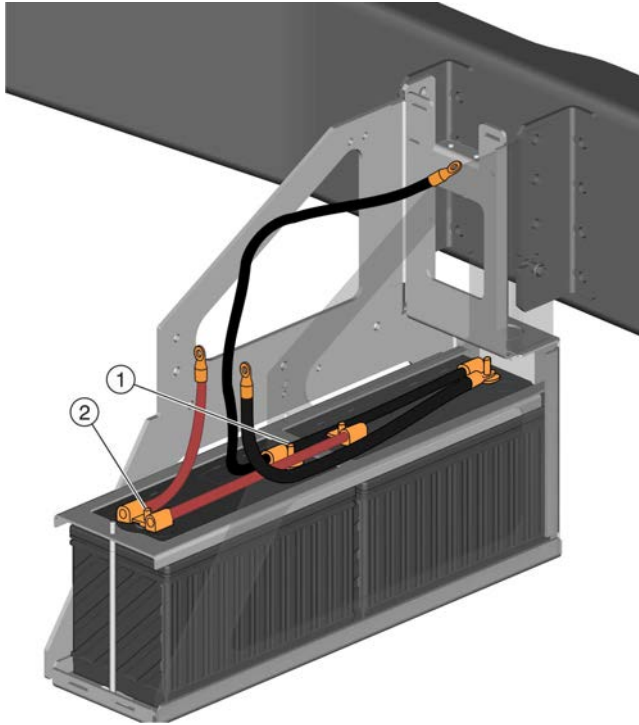

W3057043

12 Remove lower battery hold down and fasteners. Remove both batteries.

13 Remove upper battery support shelf.

- a. Remove the mat (1).
- b. Remove both jump studs.
- c. Remove the shelf and discard (2).

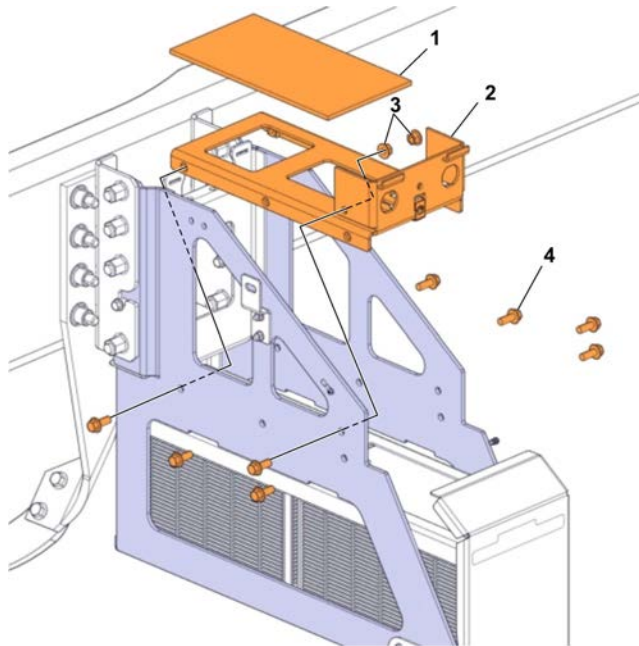

W3084489

14 Install the new upper battery support shelf (part # 22248322).

- a. Install both jump studs (Original Negative(-) and New Positive(+)) (part # 22262398)).

Note: Do not over tighten plastic nut. Hand tighten only.

- b. Install replacement upper battery shelf (2).
- c. Install original mat(1).

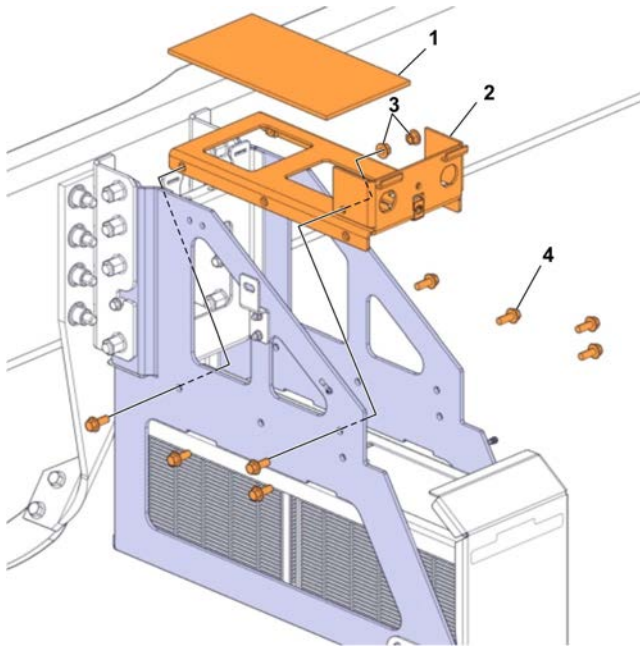

W3084489

15 Recheck the cleanliness of the battery box and make certain it is clean and dry.

16 Install tubing on hold down bolt (part # 21324949)(Outside lower).

- a. Obtain a length of 3/8" air tubing.
- b. Cut to an approximate length of 216 mm (8.5 inches).
- c. Slide the tubing over the new longer hold down bolt.

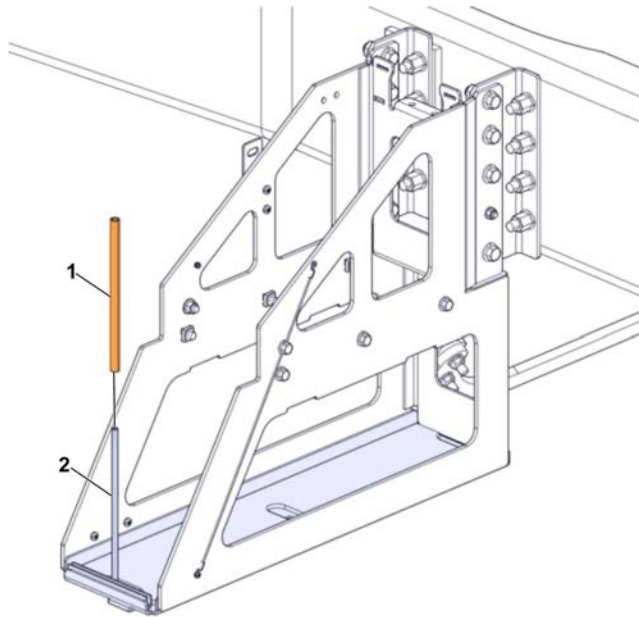

W3084490

1. Tube
2. Battery Hold Bolt

17 Install the lower mat, both lower batteries and the replacement battery hold down (part # 22248236 Standard Box Location) (part # 22248327 Tandem Steer Location). Torque the hold down fastener to 9.5 Nm (7 ft/lb).

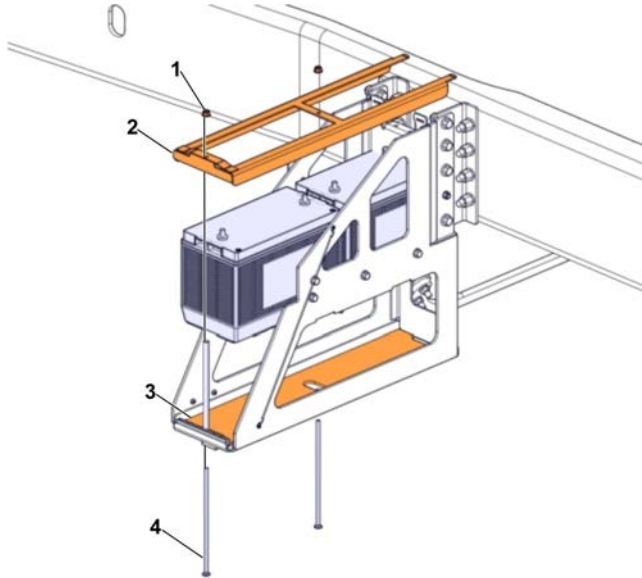

W3084491

1. Nut
2. Battery Hold Down
3. Mat
4. Stud

18 Remove the tape or covers from the lower battery cable terminals. Connect the cables in reverse order.

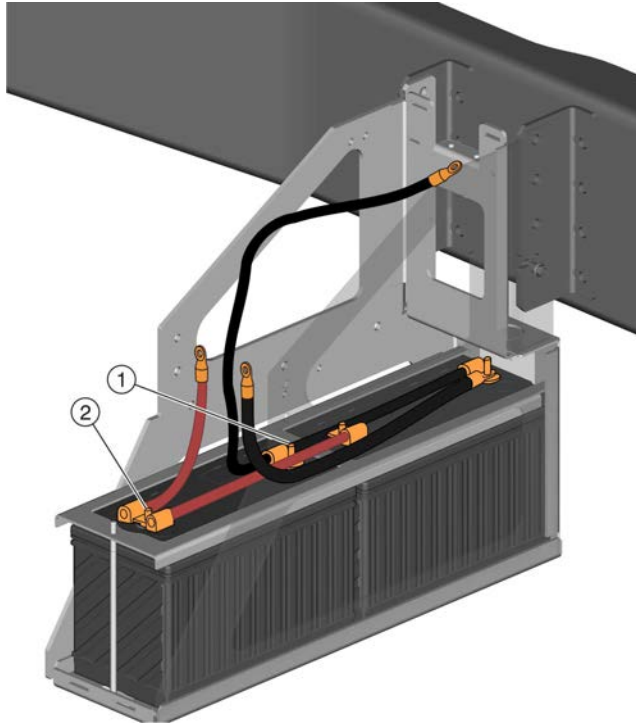

W3057043

19 Coat the lower battery connections with corrosion inhibitor or similar product.
20 Install the upper battery and hold down. Torque the hold down fastener to 9.5 Nm (7 lb/ft).

21 Remove the tape or covers from the upper battery cable terminals. Connect the cables in reverse order.

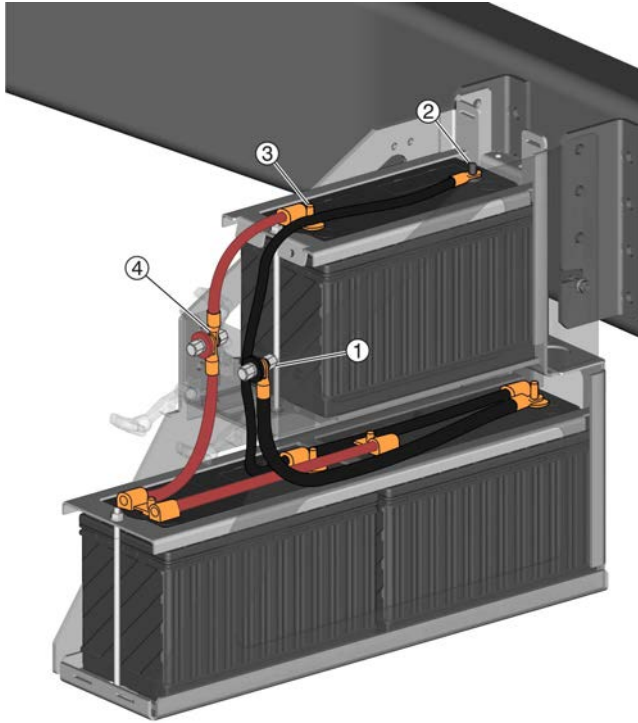

W3057042

22 Coat the upper battery cable connections with corrosion inhibitor or similar product.

23 Install cable ties as needed to secure the battery cables.

24 Modify the upper battery box cover as follows:

- a. Place the new lower cover (part # 22248330) over the upper cover, as if positioned on the box.
- b. Place the lower cover (oblong hole) over top of the (hole) in the upper cover so that the oblong is mostly located above the hole.
- c. Scribe the inside oblong shape onto the upper cover.
- d. File the cover to same shape hole as lower cover.

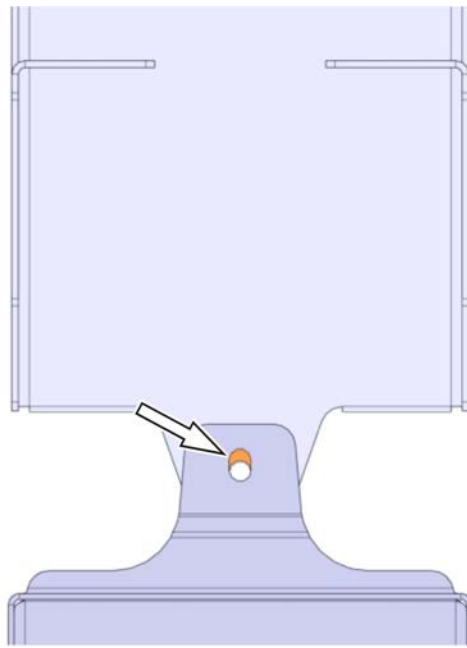

W3084492

25 Install the upper and lower battery box covers. (Attach tethers, if applicable).

26 Install warning Labels (part # 21416154, 25157779, and 25167207).

27 Install driver side top step. (If applicable)

28 Turn the battery disconnect switch on. (If applicable)

29 Check for proper operation of the electrical system.

30 Remove the wheel chocks.

Reimbursement

This repair may be eligible for reimbursement if a product failure was experienced within time and mileage limits of the applicable Warranty coverage. Reimbursement is obtained via the normal claim handling process.	
Claim Type (used only when uploading from the Dealer Bus. Sys.)	01
Labor Code	
Primary Labor Code	1412A-ZZ-80 1.4 hrs.
Causal Part	21689508

Mack Trucks, Inc. engages in a comprehensive program of testing and evaluating to provide the best possible product. Mack Trucks, Inc. however, is not committed to, or liable for updating existing vehicles.