

WD67 - Replacing E-box for the High-voltage System (Stop Sale Campaign/Workshop campaign)

Vehicle Type: **Panamera S E-Hybrid**

Model Year: **2014**

Concerns: **E-box for the high-voltage system**

Information: This is to inform you of a voluntary Workshop Campaign on the above-mentioned vehicles. **An E-box for the high-voltage system that does not meet the required specifications was installed in the affected vehicles.**

As a result, there is a possibility that the E-box for the high-voltage system may fail after the vehicle has been driven for just a short time. If this happens, the message "Hybrid system failure - Park vehicle safely" will appear in the instrument cluster.

Action Required: Replace E-box for the high-voltage system.

Affected Vehicles: The VIN(s) can be checked by using PIWIS Vehicle Information link to verify if the campaign affects the vehicle. This campaign is scope specific to the VIN! Failure to verify in PIWIS may result in an improper repair. This campaign affects 5 VINs in the United States.

Parts Info: **NOTE: Parts will not be automatically shipped to your dealership. Please submit a PTEC/PAV for parts.**

7PP.915.251.A	⇒ Battery relay carrier (BDU)	1 ea.
970.611.901.07	⇒ Set of screws for control unit	1 ea.
7PP.915.465.A	⇒ Battery cover plate, top	1 ea.
7PP.915.151	⇒ Battery cover plate, side	1 ea.
970.611.901.02	⇒ Set of screws for cover plate	1 ea.
970.611.901.03	⇒ Battery fuse box cover	1 ea.
970.611.901.04	⇒ Set of screws for fuse	1 ea.
7PP.915.463	⇒ Fuse	1 ea.
N .906.661.01	⇒ Tie-wrap clip	5 ea.
970.555.643.01	⇒ Screw bolt for locking mechanism	2 ea.
999.507.584.02	⇒ Clamp	10 ea.
999.507.839.01	⇒ Clip	10 ea.
7PP.010.849.L	⇒ Indication sticker LI.ION HV-BATTERY	1 ea.
958.701.739.00	⇒ Warning sign for cover	2 ea.

8R0.010.539	⇒ Warning sign, English	1 ea.
000.043.301.47	⇒ Antifreeze, 1-litre container	approx. 1 liter per vehicle (as much as required)

Materials:	...	Tie-wrap, approx. 3.0 x 200 mm e.g. 999.513.075.40	5 ea.**
------------	-----	---	---------

** WD67000001 should be entered manually as a sublet part.

Special Tools:	<ul style="list-style-type: none"> • VAS 6558/9-6 - High-voltage test adapter HVA 280 • VAS 6558/9-7 - High-voltage test adapter HVR 40 • VAS 6884 - High-voltage cordon • VAS 6883 - Insulated tool set • 9860 - Adapter plate • 3033 - Lifting tackle • VAS 6100 - Workshop crane • T40262 - Locking cap • 9818 - PIWIS Tester II • 9696 - Filling device • Nr.192 - Hose clamping pliers • Nr.90 Pos.2 - Torque wrench • Nr.90 Pos.6 - Torque wrench
----------------	---

Work Procedure:	See Attachment "A".
-----------------	---------------------

Claim Submission:	See Attachment "B".
-------------------	---------------------

Installation
Position:

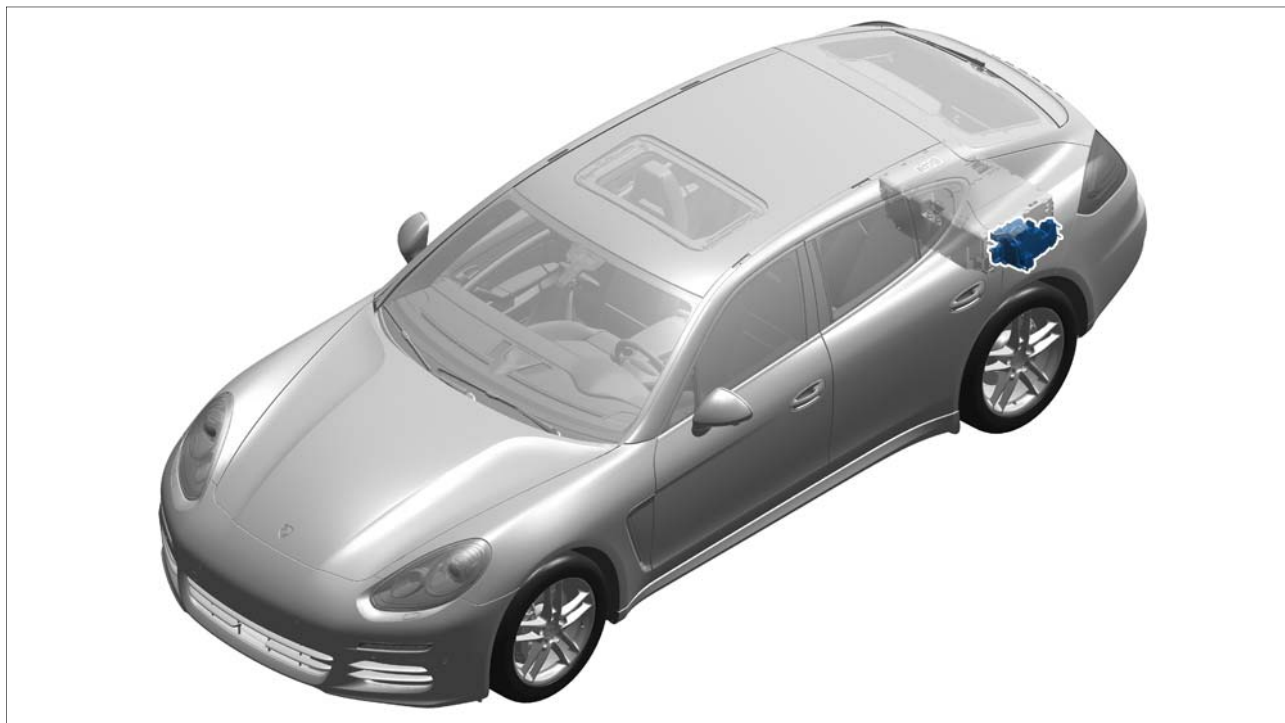

Installation position of E-box

Attachment "A": **Work Procedure**

⚠ WARNING

High voltage

- **Danger of electric shock from live parts**
 - **Risk of serious burns or death**
- ⇒ **Work on the HV battery may only be carried out by a high-voltage technician.**
- ⇒ **Always use insulated tools VAS 6883 - Insulated tool set when working on the HV battery.**
- ⇒ **Observe general warning notes for working on the high-voltage vehicle electrical system. ⇒ *Workshop Manual '2X00IN General warning notes for working on the high-voltage electrical system'***

**Information**

Before starting to work on the high-voltage system, a high-voltage technician must isolate the high-voltage system from the power supply.

The document ⇒ *Workshop Manual '2X00IN Isolation from supply prior to performing maintenance tasks on hybrid vehicles'* describes the various types of work for which the high-voltage system must be isolated from the power supply.

The test log **Verifying absence of electric charge** and **Restarting high-voltage system** can be found under Standard forms in PIWIS.

**Information**

Always use insulated tools **VAS 6883 - Insulated tool set** when working on the high-voltage battery and a high-voltage cordon **VAS 6884 - High-voltage cordon** when working on a HV work bay.

- 1 Observe warning notes ⇒ *Workshop Manual '2X00IN General warning notes for working on the high-voltage vehicle electrical system'*.
- 2 The high-voltage system must be **isolated from the power supply** and the related documentation for isolating the high-voltage system and classification of the high-voltage battery must be completed.
⇒ *Workshop Manual '2X00IN Isolating high-voltage electrical system from power supply/Starting high-voltage electrical system'*
⇒ *Workshop Manual '2X00IN Classification of high-voltage battery'*
- 3 The E-box (high-voltage battery) must now be **replaced** ⇒ *Workshop Manual '270819 Removing and installing E-box'*.

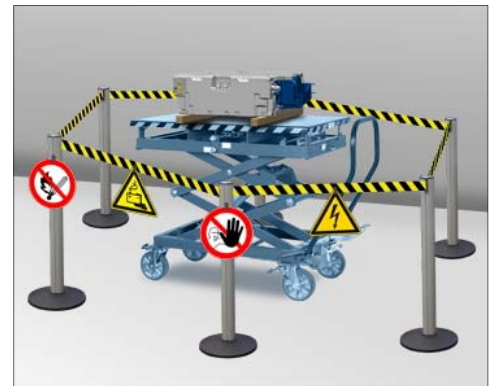

Restricted area for HV battery

**Information****Stickers (warning of dangerous electrical voltage)**

The cover plates for the high-voltage battery must be replaced while carrying out the work required for replacing the E-box.

The identification and warning stickers affixed to the cover plates cannot be re-used.

Before re-installing the high-voltage battery, new stickers must therefore be affixed to the new cover plates at the same position and with the same text alignment as on the removed cover plates.

- 1 Warning sign pictograms
- 2 Indication sticker for Li-Ion HV battery
- 3 Safety marking warning sign

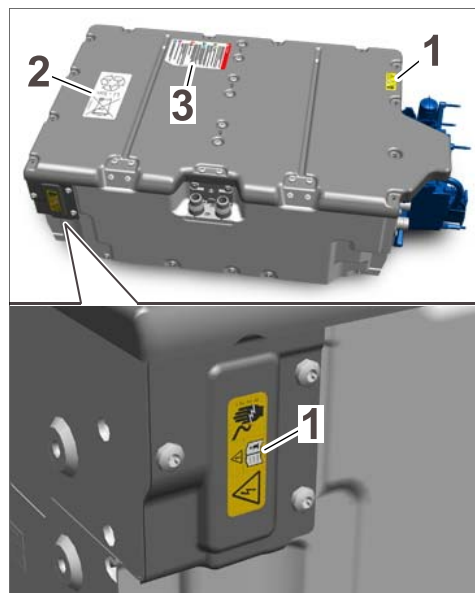

Arrangement of stickers

- 4 Restart the high-voltage system and complete the relevant documentation ⇒ *Workshop Manual '2X00IN Isolating high-voltage electrical system from power supply/Starting high-voltage electrical system'*.
- 5 Enter the campaign in the Warranty and Maintenance booklet.

Attachment "B": **Claim Submission** - Stop Sale/Workshop Campaign WD67

Warranty claims should be submitted via WWS/PQIS.

Open campaigns may be checked by using either the PIWIS Vehicle Information system or through PQIS Job Creation.

Labor, parts, and sublet will be automatically inserted when Technician is selected in WWS/PQIS. If necessary, the required part numbers will need to be manually entered into warranty system by the dealer administrator.

Replacing E-box for the high-voltage system

Labor time: **502 TU**

- Includes:
- Isolating high-voltage system from power supply and starting high-voltage system
 - Classification of high-voltage battery
 - Removing and installing subwoofer
 - Removing and installing luggage compartment cover
 - Removing and installing C-pillar trim panel
 - Removing and installing side trim panel
 - Removing and installing cover for lock support
 - Removing and installing battery

Removing and installing KESSY antenna
 Removing and installing high-voltage charger
 Removing and installing high-voltage battery
 Removing and installing battery cross member
 Removing and installing high-voltage battery control unit
 Removing and installing high-voltage battery fuse
 Filling coolant
 Bleeding low-temperature cooling system
 Connecting and disconnecting battery charger
 Connecting and disconnecting PIWIS Tester

Parts required:

7PP.915.251.A	Battery relay carrier (BDU)	1 ea.
970.611.901.07	Set of screws for control unit	1 ea.
7PP.915.465.A	Battery cover plate, top	1 ea.
7PP.915.151	Battery cover plate, side	1 ea.
970.611.901.02	Set of screws for cover plate	1 ea.
970.611.901.03	Battery fuse box cover	1 ea.
970.611.901.04	Set of screws for fuse	1 ea.
7PP.915.463	Fuse	1 ea.
N.906.661.01	Tie-wrap clip	5 ea.
970.555.643.01	Screw bolt for locking mechanism	2 ea.
999.507.584.02	Clamp	10 ea.
999.507.839.01	Clip	10 ea.
7PP.010.849.L	Indication sticker LI.ION HV-BATTERY	1 ea.
958.701.739.00	Warning sign for cover	2 ea.
8R0.010.539	Warning sign, English	1 ea.
000.043.301.47	Antifreeze, 1-liter container	1 ea.
WD670000001	Tie-wrap	1 ea. (i.e. 5 tie-wraps, approx. 3.0 x 200 mm e.g. 999.513.075.40; for warranty invoicing only)*

* WD670000001 should be entered manually as a sublet part..

⇒ Damage code WD67 066 000 2

- References:
- ⇒ *Workshop Manual '2X00IN General warning notes for working on the high-voltage vehicle electrical system'*
 - ⇒ *Workshop Manual '2X00IN Isolating high-voltage electrical system from power supply/Starting high-voltage electrical system'*
 - ⇒ *Workshop Manual '2X00IN Classification of high-voltage battery'*
 - ⇒ *Workshop Manual '270819 Removing and installing E-box'*

Important Notice: Technical Bulletins issued by Porsche Cars North America, Inc. are intended only for use by professional automotive technicians who have attended Porsche service training courses. They are written to inform those technicians of conditions that may occur on some Porsche vehicles, or to provide information that could assist in the proper servicing of a vehicle. Porsche special tools may be necessary in order to perform certain operations identified in these bulletins. Use of tools and procedures other than those Porsche recommends in these bulletins may be detrimental to the safe operation of your vehicle, and may endanger the people working on it. Properly trained Porsche technicians have the equipment, tools, safety instructions, and know-how to do the job properly and safely. If a particular condition is described, do not assume that the bulletin applies to your vehicle, or that your vehicle will have that condition. See your authorized Porsche Dealer for the latest information about whether a particular technical bulletin applies to your vehicle. Part numbers listed in these bulletins are for reference only. Always check with your authorized Porsche dealer to verify the current and correct part numbers. The work procedures updated electronically in the Porsche PIWIS diagnostic and testing device take precedence and, in the event of a discrepancy, the work procedures in the PIWIS Tester are the ones that must be followed.

© Porsche Cars North America, Inc.

Dealership	Service Manager	Shop Foreman	Service Technician				
Distribution							
Routing	Asst. Manager	Warranty Admin.	Service Technician				

Dr. Ing. h.c. F. Porsche AG is the owner of numerous trademarks, both registered and unregistered, including without limitation the Porsche Crest®, Porsche®, Boxster®, Carrera®, Cayenne®, Cayman®, Panamera®, Speedster®, Spyder®, 918 Spyder®, Tiptronic®, VarioCam®, PCM®, PDK®, 911®, 4S®, FOUR, UNCOMPROMISED.® and the model numbers and the distinctive shapes of the Porsche automobiles such as, the federally registered 911 and Boxster automobiles. The third party trademarks contained herein are the properties of their respective owners. Porsche Cars North America, Inc. believes the specifications to be correct at the time of printing. Specifications, performance standards, standard equipment, options, and other elements shown are subject to change without notice. Some options may be unavailable when a car is built. Some vehicles may be shown with non-U.S. equipment. The information contained herein is for internal use only by authorized Porsche dealers and authorized users and cannot be copied or distributed. Porsche recommends seat belt usage and observance of traffic laws at all times.

Printed in the USA