

# Technical Bulletin

| Model(s)    | Year        | Eng. Code | Trans. Code | VIN Range From | VIN Range To |
|-------------|-------------|-----------|-------------|----------------|--------------|
| Jetta Wagon | 2001 – 2006 | All       | All         | All            | All          |

## Condition

55 14 05 December 5, 2014 2038994

### Corrosion in Corner Area of Rear Lid towards Rear Lights

Corrosion in the corner area of the rear lid towards the rear lights (Figure 1).

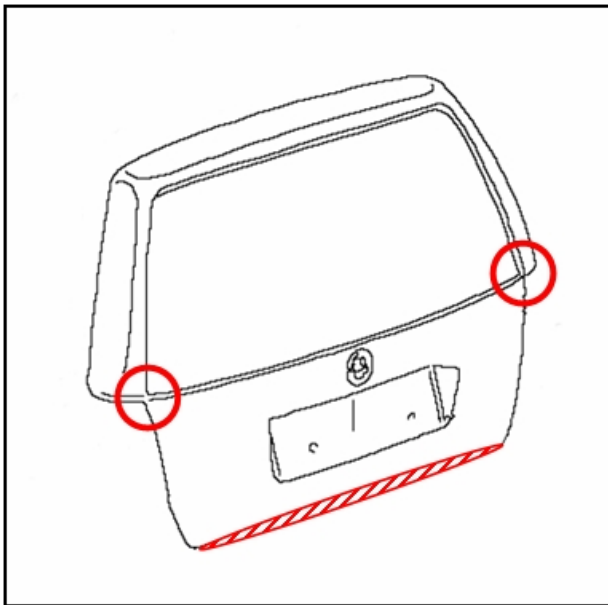

**Figure 1 - Red circles - corrosion on the rear lid**

Hatch area - possible fold corrosion on the rear lid

**! Note:**

To determine if this procedure is covered under Warranty, always refer to the *Warranty Policies and Procedures Manual*.

Documentation required per *Warranty Policies and Procedures Manual*.

For vehicles outside of the *Limited Warranty Against Corrosion Perforation* this Technical Bulletin is for information only.

# Technical Bulletin

---

## Technical Background

- Insufficient fine seam sealing.
- Edges on the inner panel too sharp.
- Heavy load on corners by relative movement.

## Production Solution

Corrections in the production process after discovering deviations.

## Service

1. Replace the rear lid.

Or

2. Repair the rear lid. Only perform this operation if the total repair cost is 80% or less of the total replacement cost.

1. Replace the rear lid:

If the lower fold area of the inner rear lid exhibits through-corrosion (perforation) (see Figure 2), DO NOT repair, Install a new rear lid.



Figure 2

# Technical Bulletin

---

- Remove all necessary parts/trim pieces of the original rear lid. See Repair Group 70 and Repair Group 55 in Elsa.
- Remove the rear window from the original rear lid. See Repair Group 64 in Elsa.

## **PERFORM THE WELDING STEP DESCRIBED BELOW AT THIS POINT**

- Apply a VOC compliant epoxy primer as an anti-corrosion treatment and primer (locally sourced).
- Paint the rear lid according to Volkswagen guidelines.
- Remove the original rear lid. See Repair Group 55 in Elsa.
- Install the new rear lid. See Repair Group 55 in Elsa.
- Install the window in the new rear lid. See Repair Group 64 in Elsa.
- Install all parts/ trim pieces previously removed. See Repair Group 70 and Repair Group 55 in Elsa.
- Adjust the rear lid fit according to the repair manual. See Repair Group 55 in Elsa.

## **2. Repair the rear lid:**

**Before the repair, check the fold area of the inner rear lid. If the lower fold area of the inner rear lid exhibits through-corrosion (perforation) (see Figure 2), DO NOT repair and install a new rear lid.**

- Remove all necessary parts/trim parts from the rear lid. See Repair Group 70 and Repair Group 55 in Elsa.
- Remove the rear window from the rear lid. See Repair Group 64 in Elsa.
- Remove the rear lid. See Repair Group 55 in Elsa.
- Remove the corrosion with a pneumatic brush grinder. Make sure that the folds of the rear lid do not get damaged.



### **Note:**

If through-corrosion (perforation) is not present, rear lid replacement will only be accepted if it qualifies per the Reimbursement Policy section of the *Warranty Policies and Procedure Manual*. This section provides important guidelines when considering component repair vs. replacement options (the “80% rule”).

## **PERFORM THE WELDING STEP DESCRIBED BELOW AT THIS POINT**

- If necessary, modify the welding seam without damaging the folds. Thoroughly clean the area.
- Apply a VOC compliant epoxy primer as an anti-corrosion treatment and primer (locally sourced).
- Re-paint the rear lid according to Volkswagen guidelines.
- Install the rear lid. See Repair Group 55 in Elsa.
- Install the window in the rear lid. See Repair Group 64 in Elsa.
- Install all parts/ trim pieces previously removed. See Repair Group 70 and Repair Group 55 in Elsa.
- Adjust the rear lid according to the repair manual. See Repair Group 55 in Elsa.

# Technical Bulletin

---

## Welding

- MIG weld the corners of the rear lid (see Figure 3, red outline). Make sure that all three panels are connected with each other in the contact area of the rear lid (Figure 4, arrows).



Figure 3



Figure 4



# Technical Bulletin

## Warranty

**Note:**

- Dealers may complete the repair as described without prior authorization (through a WISE Warranty Repair Acceptance request).
- Documentation required: Clear pictures, completed estimate and body shop invoice must be saved and kept on file at the Dealership for audit purposes.
- Labor time units (TU), Material units (MU), and Material unit rate are correct at the time of publication. The time units and/or material units may differ if the repair catalogue is updated. The information in the repair catalogue applies, except for the open time items (labor operations ending in 99) which are calculated at actual time multiplied by the body shop labor rate. The material allowance (Paint material price per unit) is subject to change. Refer to **WISE > Resource Center > Forms > Paint/Corrosion for the most current forms.**
- This section is applicable for vehicles within the terms of Volkswagen's Limited Warranty Against Corrosion Perforation. For vehicles outside the terms of the Limited Warranty Against Corrosion Perforation this section is for information only.
- This bulletin may be provided to outside shops to ensure the proper repair is completed.

**Note:**

### Claim Processing Options

**Option 1:** Utilize the attached form examples and interactive forms on WISE to assist with calculating the reimbursement amounts. **This will expedite the claim review process and reduce the time to pay the claim.**

Note that miscalculations are subject to claim adjustment.

For the complete set of pre-populated Paint/Corrosion Claim Form templates associated with this Technical Bulletin, refer to WISE > Resource Center > Forms > Paint/Corrosion.

**Option 2:** Email repair estimates to [paintcamp@vw.com](mailto:paintcamp@vw.com). The Paint and Corrosion Team will calculate the warranty allowance and complete the required form(s) on behalf of the dealer.

| <b>To determine if this procedure is covered under Warranty, always refer to the <i>Warranty Policies and Procedures Manual</i> <sup>1)</sup></b> |                   |              |                |                |              |
|---|-------------------|--------------|----------------|----------------|--------------|
| Model(s)  | Year(s)           | Eng. Code(s) | Trans. Code(s) | VIN Range From | VIN Range To |
| Jetta Wagon   | 2001-2006         | All          | All            | All            | All          |
| <b>SAGA Coding</b>  |                   |              |                |                |              |
| <b>Claim Type:</b>  | 160 <sup>1)</sup> |              |                |                |              |



# Technical Bulletin

|   |                          |  |   |
|---|--------------------------|--|---|
| <b>Service Number:</b>  | <b>Damage Code</b>       | <b>HST</b>                             | <b>Damage Location<br/>(Depends on Service No.)</b> |
| 5559  | 0003                     | --                                     | 030   |
| <b>Parts Manufacturer</b>   | <b>Jetta Wagon (1J6)</b> | <b>030<sup>2)</sup></b>                |   |
| <b>Repair</b>   |                          |  |   |
| Please use the following part number in "Outside Materials" <sup>4)</sup>   |                          |  |   |
| <b>LACKMATF: Paint and Materials</b>  |                          | <b>MU @ \$12 per unit</b>              |   |
| <b>Epoxy Primer (Locally Sourced)</b>   |                          | <b>Claim Dollar Amount (MAX: \$40)</b> |   |
| Please use the following Labor Operation in "Outside Labor" <sup>4)</sup>   |                          |  |   |
| <b>Select the appropriate Labor Operation below:</b><br>- L0010000: External Painting-straight color<br>- L0020000: External Painting-metallic/2-layer<br>- L0030000: External Painting-pearl color |                          | <b>Claim Dollar Amount</b>             |   |
| <b>Use this for all body repair in this bulletin:</b><br>- A0041000: Body Shop repair no paint  |                          | <b>Claim Dollar Amount</b>             |   |
| <b>Replace</b>  |                          |  |   |
| Please use the following part number in "Outside Materials" <sup>4)</sup>   |                          |  |   |
| <b>LACKMATF: Paint and Materials</b>  |                          | <b>MU @ \$12 per unit</b>              |   |
| <b>Epoxy Primer (Locally Sourced)</b>   |                          | <b>Claim Dollar Amount (MAX: \$40)</b> |   |
| Please use the following Labor Operation in "Outside Labor" <sup>4)</sup>   |                          |  |   |
| <b>Select the appropriate Labor Operation below:</b><br>- L0010000: External Painting-straight color<br>- L0020000: External Painting-metallic/2-layer<br>- L0030000: External Painting-pearl color |                          | <b>Claim Dollar Amount</b>             |   |
| <b>Use this for all body repair in this bulletin:</b><br>- A0041000: Body Shop repair no paint  |                          | <b>Claim Dollar Amount</b>             |   |



# Technical Bulletin

|   |                                      |          |
|---|--------------------------------------|----------|
| Causal Part:  |                                      | L00#0000 |
| Diagnostic Time <sup>4)</sup>   |                                      |          |
| GFF Time expenditure  | 01500000 = 00 TU max.                | NO       |
| Road Test   | 01210002 = 00 TU<br>01210004 = 00 TU | NO       |
| Technical Diagnosis   | 01320000 = 00 TU                     | NO       |
| Claim Comment: Input "As per Technical Bulletin 2038994" in comment section of Warranty Claim.  |                                      |          |
| <p><sup>1)</sup> For Vehicles outside the Limited Warranty Against Corrosion Perforation this bulletin is information only</p> <p><sup>2)</sup> Corrosion claim vendor code will be the damage location.</p> <p><sup>3)</sup> Labor Time Units (TUs) are subject to change with ELSA updates.</p> <p><sup>4)</sup> Documentation required per <i>Warranty Policies and Procedures Manual</i>.</p> <p><sup>5)</sup> See attachment "srt_reference_table.pdf" for labor time reference.</p> |                                      |          |

## Required Parts and Tools

| Replacement            |                    |
|------------------------|--------------------|
| Part number            | Description        |
| 1J9 827 025 AD         | Rear Lid           |
| Repair and Replacement |                    |
| Part number            | Description        |
| DH 009 100             | 1K Window Adhesive |

For Special Tools see repair Manual.

## Additional Information

All part and service references provided in this Technical Bulletin are subject to change and/or removal. Always check with your Parts Dept. and Repair Manuals for the latest information.

Paint/Corrosion Claim Form



Dealer No.  
Repair Order No.

400000  
910000

**Example - Repair**  
If repeat repair, provide explanation in box below:  
**A4 Jetta Wagon**

|                                       |                                  |     |                                     |
|---------------------------------------|----------------------------------|-----|-------------------------------------|
| VIN (17-Digits)                       | WVWSK61J83W000000                |     |                                     |
| Color No. (4-digit ElsaPro Paint No.) | LA7W                             |     |                                     |
| Dealer Labor Rate                     | 100.00                           |     |                                     |
| Paint material price per unit         | 12.00                            |     |                                     |
| Dealer-owned paint shop?              | <input checked="" type="radio"/> | Yes | <input checked="" type="radio"/> No |
| Original paint material?              | <input checked="" type="radio"/> | Yes | <input checked="" type="radio"/> No |

| Service No. | Damage Code | Dmg Loc | Part manufacturer (Vendor Code) | Description of Repair   | Paint Labor Operation(s) | Time Units | Mat'l Units |
|-------------|-------------|---------|---------------------------------|---|--------------------------|------------|-------------|
| 5559        | 0003        | 030     | 030                             | Paint liftgate  | 55597973                 | 160        | 8           |
|             |             |         |                                 | Verify <b>ALL</b> Labor Operation Time Units and Material Units |                          |            |             |

Note: Authorization and claim reimbursement are contingent on the usage of original parts for the repair

|                         |          |     |
|-------------------------|----------|-----|
| Body Painting Prep Time | 51017173 | 160 |
|-------------------------|----------|-----|

The vehicle history must be checked for any previous damage. Digital photographs must be included with the repair order per VWoA instructions. If there is a sublet invoice for painting, the invoice amount must be split between outside (sublet) labor and outside (sublet) material.

|                |     |   |
|----------------|-----|---|
| Paint Subtotal | 320 | 8 |
|----------------|-----|---|

| Part Number | Part Description | Part Qty | Part Price per Unit | Total Part Price | Description of Repair              | Repair/Replace Labor Operation(s) | Time Units |
|-------------|------------------|----------|---------------------|------------------|------------------------------------|-----------------------------------|------------|
| EPOXY       | Epoxy Primer     | 1        | \$ 40.00            |                  | Remove and install Liftgate        | 55591920                          | 110        |
|             |                  |          |                     |                  | Remove and install rear upper lock | 55561970                          | 10         |
|             |                  |          |                     |                  | Remove and install lock mechanism  | 55571970                          | 10         |
|             |                  |          |                     |                  | Remove and install rear emblem     | 66511999                          | 20         |
|             |                  |          |                     |                  | Remove and install rear letterings | 66502000                          | 20         |
|             |                  |          |                     |                  | Remove and install rear screen     | 64861920                          | 190        |
|             |                  |          |                     |                  | Remove corrosion on rear lid       | 55596300                          | 60         |
|             |                  |          |                     |                  | MIG weld right and left corners    | 55594199                          | 100        |
|             |                  |          |                     |                  | Wax body                           | 51017500                          | 30         |

Example Part Qty and Part Price per Unit only  
All other parts should be claimed separately in the SAGA claim

Full pre-populated forms can be found in the following location:  
WISE > Resource Center > Forms > Paint/Corrosion > TB# Form specific to the vehicle and the repair.

Example Time Units

|                  |                             |    |        |                     |     |
|------------------|-----------------------------|----|--------|---------------------|-----|
| Outside Material | Part Amount Subtotal        | \$ | 40.00  | Body Labor Subtotal | 550 |
| LACKMATF         | Total Paint Material Amount | \$ | 96.00  | Total TU/MU         | 870 |
|                  | Total Parts Amount          | \$ | 136.00 |                     | 8   |

VW Representative  
Authorization No.

TB 2038994

Authorization Date \_\_\_\_\_

Authorization valid until: \_\_\_\_\_

|                      |           |                 |
|----------------------|-----------|-----------------|
| L00#0000             | \$        | 320.00          |
| A0041000             | \$        | 550.00          |
| Parts and Materials: | \$        | 136.00          |
| <b>Total:</b>        | <b>\$</b> | <b>1,006.00</b> |

Warranty

VW Representative Name (printed)

VW Representative Signature



Paint/Corrosion Claim Form



Das Auto.

Dealer No. **400000**  
 Repair Order No. **910000**

**Example - Replace**

If repeat repair, provide explanation in box below:

**A4 Jetta Wagon**

|                                       |                                  |     |                                     |
|---------------------------------------|----------------------------------|-----|-------------------------------------|
| VIN (17-Digits)                       | WVWSK61J83W000000                |     |                                     |
| Color No. (4-digit ElsaPro Paint No.) | LA7W                             |     |                                     |
| Dealer Labor Rate                     | 100.00                           |     |                                     |
| Paint material price per unit         | 12.00                            |     |                                     |
| Dealer-owned paint shop?              | <input checked="" type="radio"/> | Yes | <input checked="" type="radio"/> No |
| Original paint material?              | <input checked="" type="radio"/> | Yes | <input checked="" type="radio"/> No |

| Service No. | Damage Code | Dmg Loc | Part manufacturer (Vendor Code) | Description of Repair   | Paint Labor Operation(s) | Time Units | Mat'l Units |
|-------------|-------------|---------|---------------------------------|---|--------------------------|------------|-------------|
| 5559        | 0003        | 030     | 030                             | Paint new liftgate  | 55596170                 | 130        | 10          |
|             |             |         |                                 | Verify <b>ALL</b> Labor Operation Time Units and Material Units |                          |            |             |

|  |                         |                |     |
|--|-------------------------|----------------|-----|
| Note: Authorization and claim reimbursement are contingent on the usage of original parts for the repair   | Body Painting Prep Time | 51017173       | 160 |
| The vehicle history must be checked for any previous damage. Digital photographs must be included with the repair order per VWoA instructions. If there is a sublet invoice for painting, the invoice amount must be split between outside (sublet) labor and outside (sublet) material. |                         | Paint Subtotal | 290 |
|  |                         |                | 10  |

| Part Number | Part Description | Part Qty         | Part Price per Unit         | Total Part Price | Description of Repair           | Repair/Replace Labor Operation(s) | Time Units |
|-------------|------------------|------------------|-----------------------------|------------------|---------------------------------|-----------------------------------|------------|
| EPOXY       | Epoxy Primer     | 1                | \$ 40.00                    |                  | Remove and install Liftgate     | 55591920                          | 110        |
|             |                  |                  |                             |                  | Replace Liftgate                | 55595570                          | 250        |
|             |                  |                  |                             |                  | MIG weld right and left corners | 55594199                          | 100        |
|             |                  |                  |                             |                  | Wax body                        | 51017500                          | 30         |
|             |                  | Outside Material | Part Amount Subtotal        | \$ 40.00         |                                 | Body Labor Subtotal               | 490        |
|             |                  | LACKMATF         | Total Paint Material Amount | \$ 120.00        |                                 | Total TU/MU                       | 780        |
|             |                  |                  | Total Parts Amount          | \$ 160.00        |                                 |                                   | 10         |

Example Part Qty and Part Price per Unit only  
 All other parts should be claimed separately in the SAGA claim

Full pre-populated forms can be found in the following location:  
 WISE > Resource Center > Forms > Paint/Corrosion > TB# Form specific to the vehicle and the repair.

VW Representative Authorization No. **TB 2038994**

Authorization Date \_\_\_\_\_  
 Authorization valid until: \_\_\_\_\_

|                      |                  |
|----------------------|------------------|
| L00#0000             | \$ 290.00        |
| A0041000             | \$ 490.00        |
| Parts and Materials: | \$ 160.00        |
| <b>Total:</b>        | <b>\$ 940.00</b> |

Warranty  
 VW Representative Name (printed) \_\_\_\_\_

VW Representative Signature \_\_\_\_\_

## SRT Reference Table for TPI# 2038994

| Repair (A4 Jetta) – Models(1J6)                      |                      |   |
|--|----------------------|---|
| <u>Body Labor</u>                                    |                      |   |
| Labor Operation : Remove and install rear lid        | 55 59 19 20 = 110 TU | Multiply claim time units x warranty labor rate. Enter in SAGA under Outside Labor Operation:<br>A0041000   |
| Labor Operation : Remove and install rear upper lock | 55 56 19 70 = 10 TU  |   |
| Labor Operation : Remove and install lock mechanism  | 55 57 19 70 = 10 TU  |   |
| Labor Operation : Remove and install rear logo       | 66 51 19 99 = 20 TU  |   |
| Labor Operation : Remove and install rear letterings | 66 50 20 00 = 20 TU  |   |
| Labor Operation : Remove and install rear window     | 64 86 19 20 = 190 TU |   |
| Labor Operation : Remove corrosion on rear lid       | 55 59 63 00 = * TU   |   |
| Labor Operation : MIG weld right and left corners    | 55 59 41 99 = 100 TU |   |
| Labor Operation : Wax body                           | 51 01 75 00 = 30 TU  |   |
| <u>Refinish Labor</u>                                |                      |   |
| Labor Operation: Prepare painting                    | 51 01 71 73 = 160 TU | Multiply claim time units x warranty labor rate. Enter in SAGA under Outside Labor Operation:<br><br>L00#0000*<br>*Please see warranty table for proper labor operation |
| Labor Operation: Paint rear lid (Removed)            | 55 59 79 73 = 160 TU |   |
| <u>Outside Materials</u>                             |                      |   |
| Labor Operation: Paint rear lid                      | 8 MU                 | Multiply claim material units x \$12.00. Enter in SAGA under Outside Materials:<br><br>LACKMATF   |

\* Liftgate replacement should be considered if the total repair cost will exceed 80% of the total replacement cost. Refer to the Reimbursement Policy section of the *Warranty Policies and Procedure Manual*. This section provides important guidelines when considering component repair vs. replacement options (the “ 80% rule” ).

## Replace (A4 Jetta) – Models(1J6)

### Body Labor

|   |                      |   |
|---|----------------------|---|
| Labor Operation : Remove and install rear lid                     | 55 59 19 20 = 110 TU | Multiply claim time units x warranty labor rate. Enter in SAGA under Outside Labor Operation:<br>A0041000 |
| Labor Operation : Replace rear lid                                | 55 59 55 70 = 250 TU |   |
| Labor Operation : MIG weld right and left corners of the rear lid | 55 59 41 99 = 100 TU |   |
| Labor Operation : Wax body  | 51 01 75 00 = 30 TU  |   |

### Refinish Labor

|   |                      |   |
|---|----------------------|---|
| Labor Operation: Prepare painting             | 51 01 71 53 = 160 TU | Multiply claim time units x warranty labor rate. Enter in SAGA under Outside Labor Operation:<br><br>L00#0000*<br>*Please see warranty table for proper labor operation |
| Labor Operation: Paint new rear lid (Removed) | 55 59 61 70 = 130 TU |   |

### Outside Materials

|                                 |       |   |
|---------------------------------|-------|---|
| Labor Operation: Paint rear lid | 10 MU | Multiply claim material units x \$12.00. Enter in SAGA under Outside Materials:<br><br>LACKMATF |
|---------------------------------|-------|---|