



NUMBER: 23-028-14

GROUP: Body

DATE: October 11, 2014

This bulletin is supplied as technical information only and is not an authorization for repair. No part of this publication may be reproduced, stored in a retrieval system, or transmitted, in any form or by any means, electronic, mechanical, photocopying, or otherwise, without written permission of Chrysler Group LLC.

THIS SERVICE BULLETIN IS ALSO BEING RELEASED AS RAPID RESPONSE TRANSMITTAL (RRT) 14-082. ALL APPLICABLE SOLD AND UN-SOLD RRT VIN'S HAVE BEEN LOADED. TO VERIFY THAT THIS RRT SERVICE ACTION IS APPLICABLE TO THE VEHICLE, USE VIP OR PERFORM A VIN SEARCH IN TECHCONNECT. ALL REPAIRS ARE REIMBURSABLE WITHIN THE PROVISIONS OF WARRANTY.

SUBJECT:

Hood Latch Release Cable Hangs Down Too Low Under Instrument Panel

OVERVIEW:

This bulletin involves routing and securing the hood latch release cable.

MODELS:

2015 (UF) 200

NOTE: This bulletin applies to vehicles built on or after March 09, 2014 (MDH 0309XX) and on or before July 12, 2014 (MDH 0712XX).

SYMPTOM/CONDITION:

The customer may describe the hood latch release cable hanging down too low under the instrument panel.

DIAGNOSIS:

If a customer's VIN is listed in VIP or your RRT VIN list, perform the repair. For all other customers that describe the symptom/condition, perform the Repair Procedure.

PARTS REQUIRED:

Qty.	Part No.	Description
1	04641780	Tie Strap

REPAIR PROCEDURE:

1. Is the hood latch release cable (1) hanging down too low under the instrument panel as shown in (Fig. 1)?
 - a. YES>>> Continue with the Repair Procedure [Step #2](#).
 - b. NO>>> This Bulletin does not apply. Further diagnosis is required.



Fig. 1 Hood Release Cable Hanging Down

1 - Hood Latch Release Cable

2. Is the hood latch release cable (1) routed in front of the wire harness (2) as shown in (Fig. 2)?
- Yes>>> Continue with [Step #3](#).
 - No>>> Proceed to [Step #6](#)

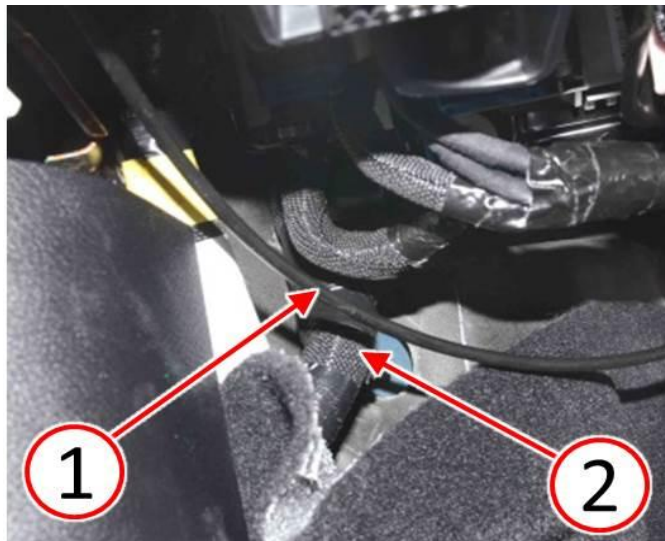

Fig. 2 Hood Release Cable In Front Of Harness

1 - Hood Latch Release Cable

2 - Wire Harness

3. Disconnect the hood latch release cable by pressing the tabs and release the cable (3) from the hood release handle (4) then remove the cable end (1) (Fig. 3).



Fig. 3 Disconnect Hood Release Cable

- 1 - Cable End
 - 2 - Retaining Tab
 - 3 - Cable Retainer
 - 4 - Hood Release Handle
-

4. Route the hood latch release cable (1) behind the wire harness (2) as shown in (Fig. 4).

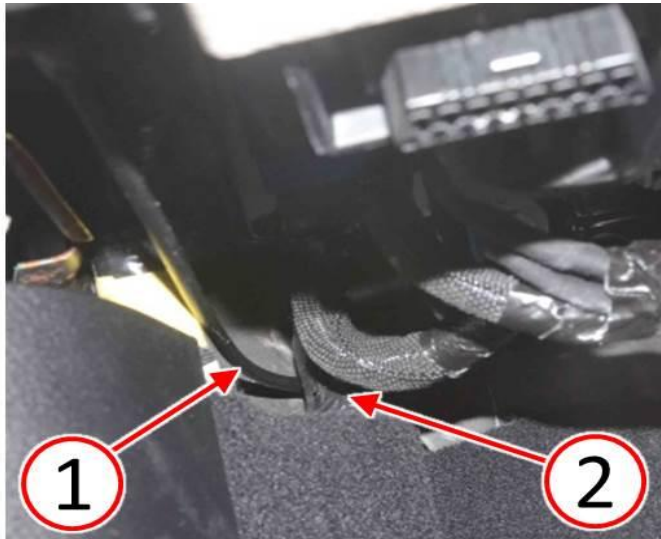

Fig. 4 Route Hood Release Cable Behind Harness

- 1 - Hood Latch Release Cable
 - 2 - Wire Harness
-

5. Install the cable end (1) then engage the cable (3) into the hood release handle (4) (Fig. 5).

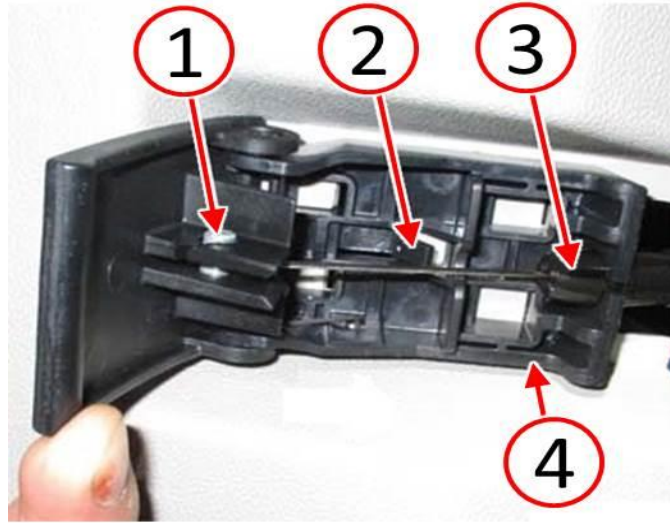

Fig. 5 Connect Hood Release Cable

- 1 - Cable End
- 2 - Retaining Tab
- 3 - Cable Retainer
- 4 - Hood Release Handle

-
6. Near to where the hood latch release cable passes through the front cowl, secure the hood latch release cable (1) to the wire harness (2) with a tie strap (3) and remove any excess tie strap material (Fig. 6).

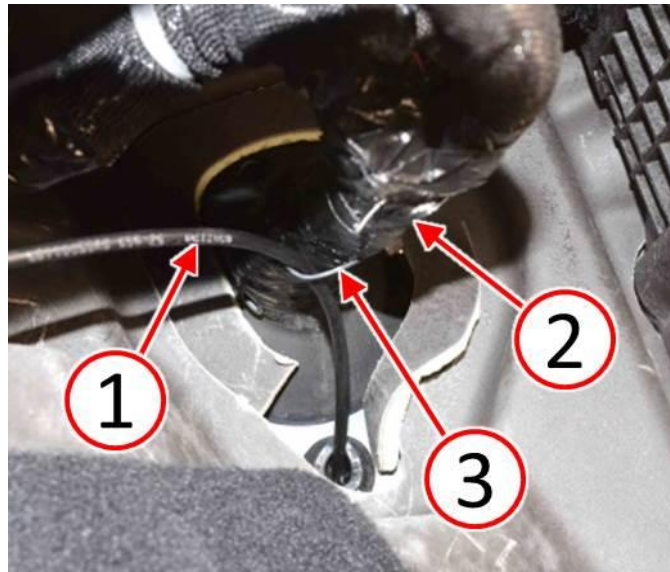

Fig. 6 Secure Hood Release Cable To Harness

- 1 - Hood Latch Release Cable
- 2 - Wire Harness
- 3 - Tie Strap

-
7. Ensure that the hood release cable is now secured and not hanging down too low under the instrument panel ([Fig. 7](#)).

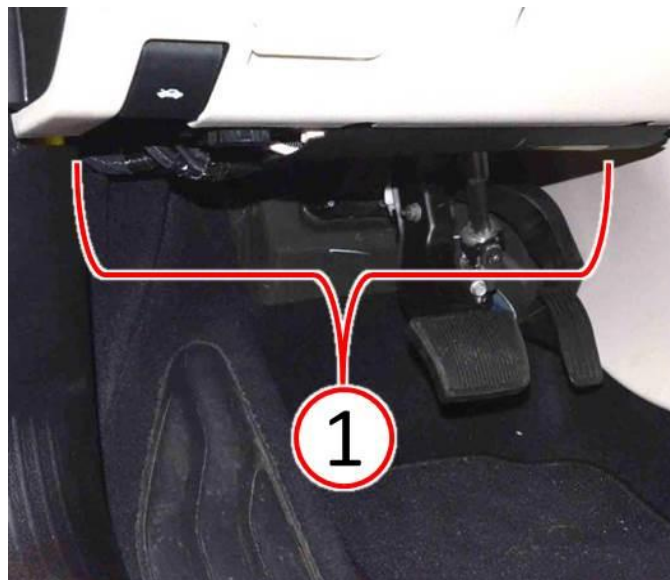

Fig. 7 Hood Release Cable Not Hanging Down

- 1 - Under Instrument Panel
-

POLICY:

Reimbursable within the provisions of the warranty.

TIME ALLOWANCE:

Labor Operation No:	Description	Skill Category	Amount
23-41-49-93	Inspect Hood Latch Release Cable Routing (1 - Semi-Skilled)	6 - Electrical and Body Systems	0.2 Hrs.
23-41-49-94	Inspect Route And Secure Hood Latch Release Cable (1 - Semi-Skilled)	6 - Electrical and Body Systems	0.2 Hrs.

FAILURE CODE:

ZZ	Service Action
----	----------------