



# SERVICE BULLETIN

|                             |                         |                            |
|-----------------------------|-------------------------|----------------------------|
| Classification:<br>BT14-026 | Reference:<br>NTB14-108 | Date:<br>November 21, 2014 |
|-----------------------------|-------------------------|----------------------------|

## 2011-2012 MURANO CROSSCABRIOLET; EDGE OF SOFT TOP FRAYING

**APPLIED VEHICLE:** 2011 - 2012 Murano CrossCabriolet (Z51)

### IF YOU CONFIRM:

The edge on the right side of the soft top is fraying.

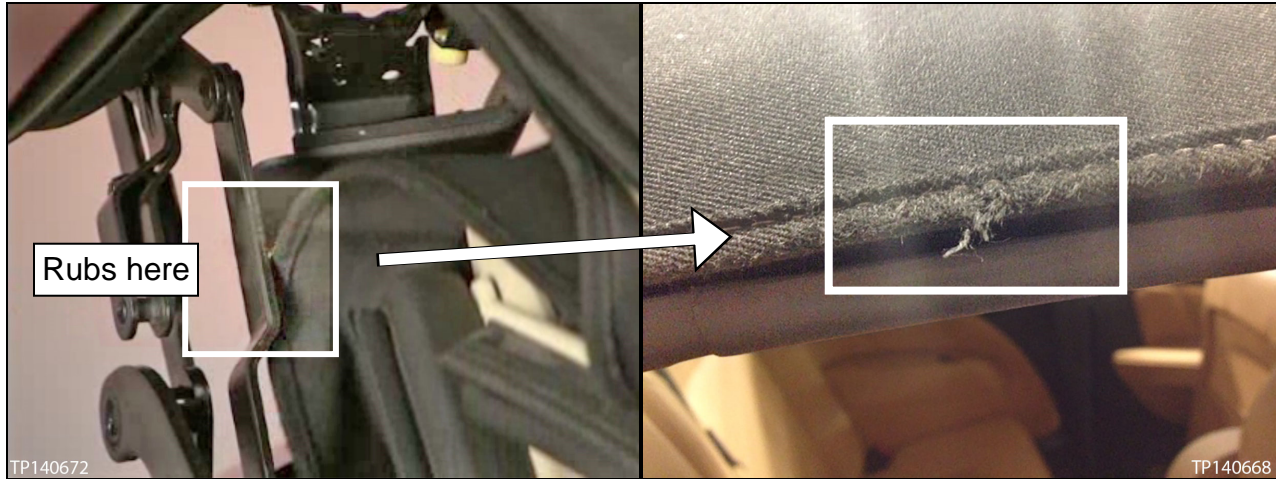

Figure 1

Figure 2

### ACTION:

1. Inspect the link of the right side storage lid hinge for a sharp edge.
2. Use emery cloth to smooth off the edge.
  - Use touch-up paint to cover up any bare metal.
3. Using a suitable tool, trim off the frayed material.
  - If the edge is worn too much, replace the soft top cover outer (soft top cover).
    - If the soft top cover needs to be replaced, refer to the Electronic Service Manual (ESM), section **RF-Roof**, for removal and installation.

**IMPORTANT:** The purpose of **ACTION** (above) is to give you a quick idea of the work you will be performing. You **MUST** closely follow the entire **SERVICE PROCEDURE** as it contains information that is essential to successfully completing the repair.

Nissan Bulletins are intended for use by qualified technicians, not 'do-it-yourselfers'. Qualified technicians are properly trained individuals who have the equipment, tools, safety instruction, and know-how to do a job properly and safely. **NOTE:** If you believe that a described condition may apply to a particular vehicle, **DO NOT** assume that it does. See your Nissan dealer to determine if this applies to your vehicle.

## SERVICE PROCEDURE:

1. Open the convertible top in the position shown in Figure 3.
2. Access the front link of the right side storage lid hinge.



Figure 3

3. Smooth off the inside edges with emery cloth (see Figure 4).

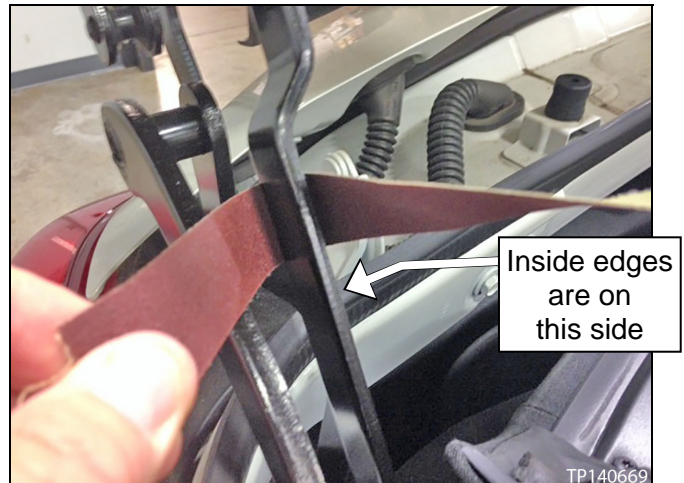

Figure 4

4. Use a suitable touch-up paint where bare metal is seen (see Figure 5).



Figure 5

5. Once the touch-up paint dries, trim off the frayed material with a fabric lint trimming tool or other suitable tool (see Figure 6).
6. If the result of trimming is not acceptable (the soft top cover's edge is worn too much), replace the soft top cover.
  - If the soft top cover needs to be replaced, refer to the ESM, section **RF-Roof**, for removal and installation.

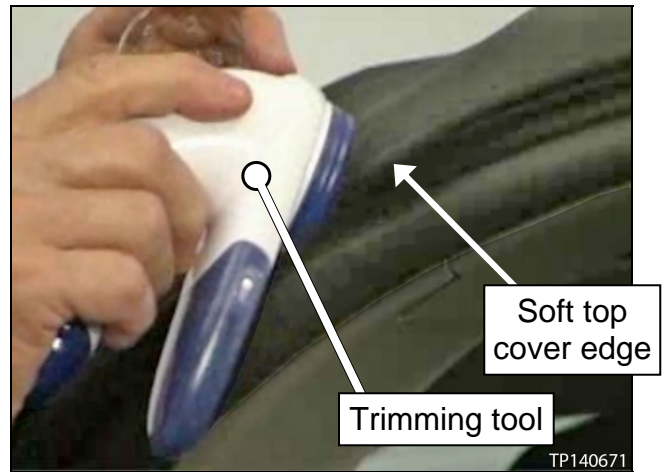

Figure 6

## PARTS INFORMATION

| DESCRIPTION                      | PART #      | QUANTITY |
|----------------------------------|-------------|----------|
| Cover Kit – Folding Roof (Black) | 97152-1GR1A | 1 *      |
| Cover Kit – Folding Roof (Beige) | 97152-1GR1C | 1 *      |

\* Replace only if the result of trimming is unacceptable and the soft top cover's edge is too worn.

## CLAIMS INFORMATION

Submit a Primary Part (PP) type line claim using the following claims coding:

| DESCRIPTION        | PFP | OP CODE | SYM | DIA | FRT |
|--------------------|-----|---------|-----|-----|-----|
| RPR TOP COVER EDGE | (1) | BX4MAA  | ZE  | 32  | 0.7 |

(1) Refer to the electronic parts catalog (FAST) and use the Folding Roof assembly part number (97003-\*\*\*\*\*) as the Primary Failed Part (PFP).

**And only if needed on same repair line**

**If the Cover Kit Needs Replacing:**

| DESCRIPTION         | PFP | OP CODE | SYM | DIA | FRT |
|---------------------|-----|---------|-----|-----|-----|
| RPL TOP COVER ASS'Y | (1) | UV10AA  | ZE  | 32  | (2) |

(1) Refer to the electronic parts catalog (FAST) and use the Folding Roof assembly part number (97003-\*\*\*\*\*) as the Primary Failed Part (PFP).

(2) Reference the current Nissan Warranty Flat Rate Manual and use the indicated flat rate time.