



# SERVICE BULLETIN

Classification: BT14-007	Reference: NTB14-021	Date: April 4, 2014
-----------------------------	-------------------------	------------------------

## 2014 ROGUE; LOWER INSTRUMENT PANEL DOES NOT STAY IN PLACE

**APPLIED VEHICLE** 2014 Rogue (T32)  
**APPLIED VIN AND DATE** Built before 5N1AT2MV(\*)EC 777569 / Jan 15, 2014

### IF YOU CONFIRM

The Instrument Lower Panel LH (as shown in Figure 1) molded plastic clip will not stay secured.

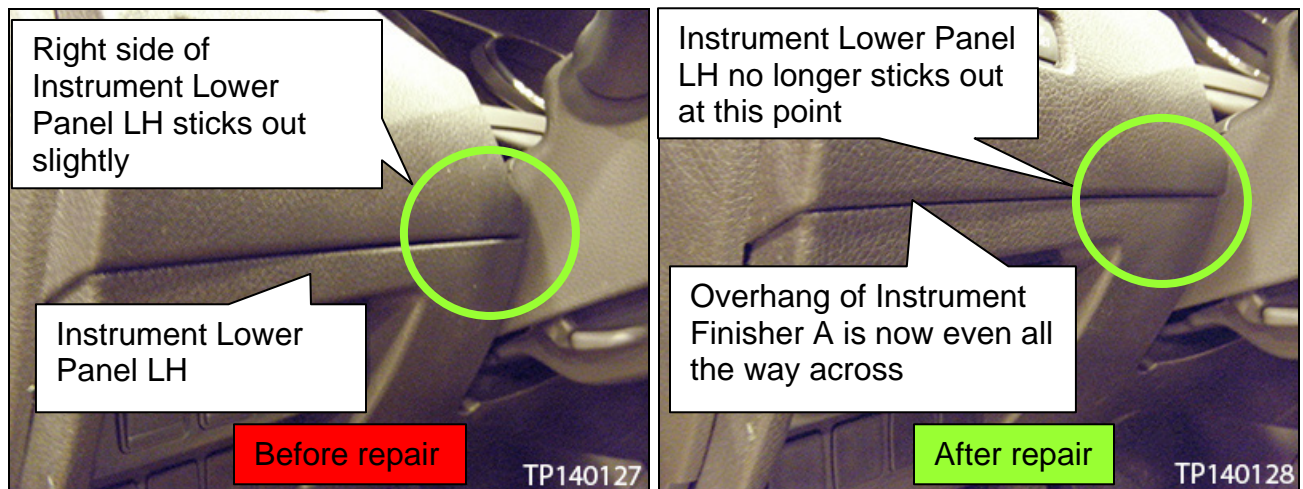

Figure 1

Figure 2

### ACTION

Install a shim between the Steering Member and the Instrument Panel and apply felt tape to the Instrument Lower Panel LH with the **SERVICE PROCEDURE** starting on page 2.

**IMPORTANT:** The purpose of **ACTION** (above) is to give you a quick idea of the work you will be performing. You **MUST** closely follow the entire **SERVICE PROCEDURE** as it contains information that is essential to successfully completing this repair.

Nissan Bulletins are intended for use by qualified technicians, not 'do-it-yourselfers'. Qualified technicians are properly trained individuals who have the equipment, tools, safety instruction, and know-how to do a job properly and safely. NOTE: If you believe that a described condition may apply to a particular vehicle, DO NOT assume that it does. See your Nissan dealer to determine if this applies to your vehicle.

## SERVICE PROCEDURE

1. Remove the Instrument Side Finisher (LH) with a finesse tool as shown in Figure 3.



Figure 3

2. Remove the two bolts holding the Fuel Filler Lid/Hood Lock Release Handle.
3. Slide the release handle assembly rearward to remove from the Instrument Lower Panel LH.

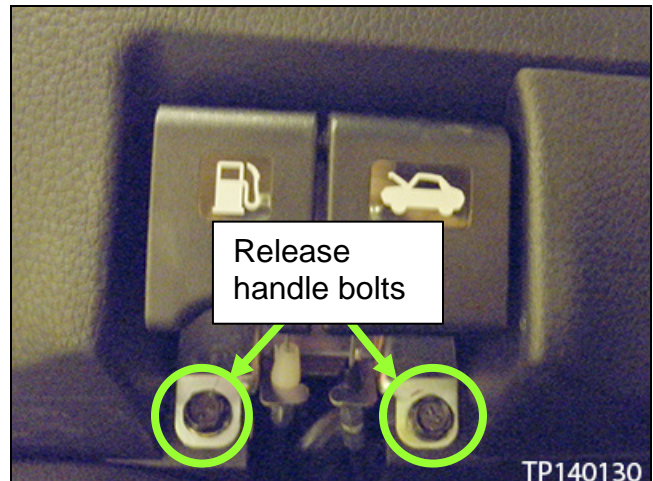

Figure 4

4. Unclip the Instrument Lower Panel LH from Instrument Finisher A and Instrument Finisher B by pulling rearward.
  - This panel can be allowed to hang by the harness, once unclipped, and does not need to be completely removed.

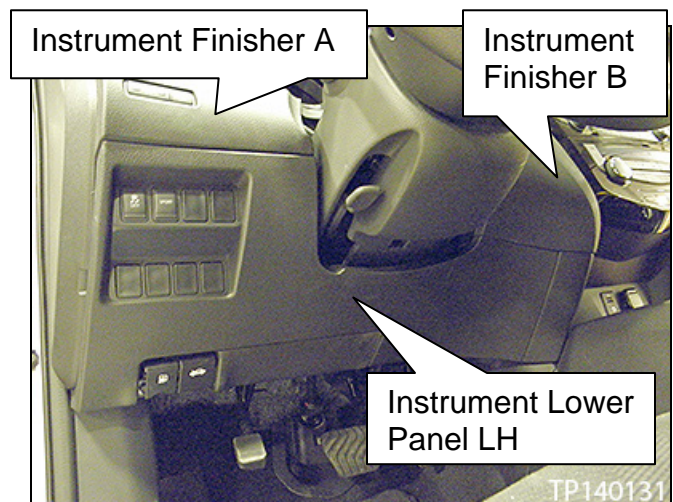

Figure 5

5. Remove the A/C Switch Assembly from Cluster Lid C by lifting up and pulling rearward at the bottom edge.

**NOTE:**

- It is held by four (4) metal clips.
- It is not necessary to disconnect the electrical connections but care should be taken not to scratch or damage any surrounding surfaces.

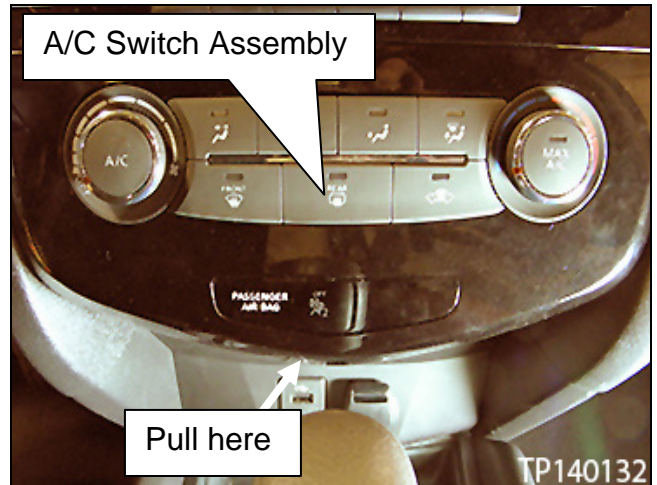

Figure 6

6. Remove Instrument Finisher B by pulling rearward.

**NOTE:** It is not necessary to completely remove Instrument Finisher B or to disconnect the electrical connections on "Push to Start" vehicles, but care should be taken so it does not scratch any of the surrounding surfaces.

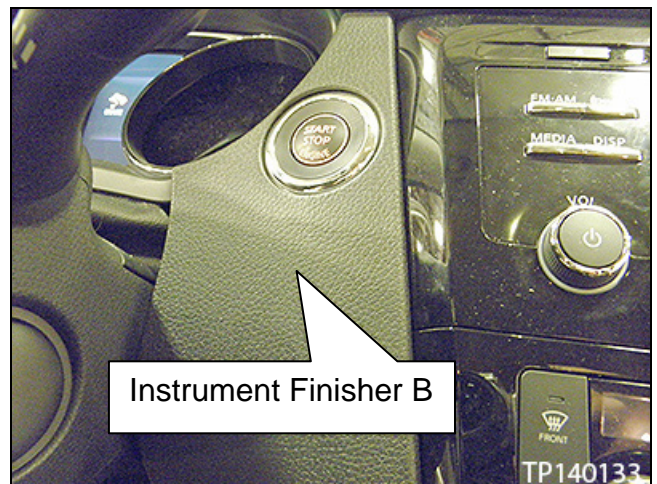

Figure 7

7. Remove the Side Ventilator Grill LH from the Instrument Finisher A and Instrument Panel as show in Figure 8:

- a. Hold the molded plastic clip in the released position.
- b. Insert a finesse tool between the Side Ventilator Grill LH and Instrument panel.
- c. Apply a slight downward force with the finesse tool to the top of the Side Ventilator Grill LH while gently pulling rearward to pry it free from the Instrument Panel.

**NOTE:**

- There is one (1) molded plastic clip on the left side, two (2) felt covered metal clips above and two (2) felt covered metal clips below the vent (Figure 9).
- Take care not to pull the vent face off of the Side Ventilator Grill LH when disassembling.

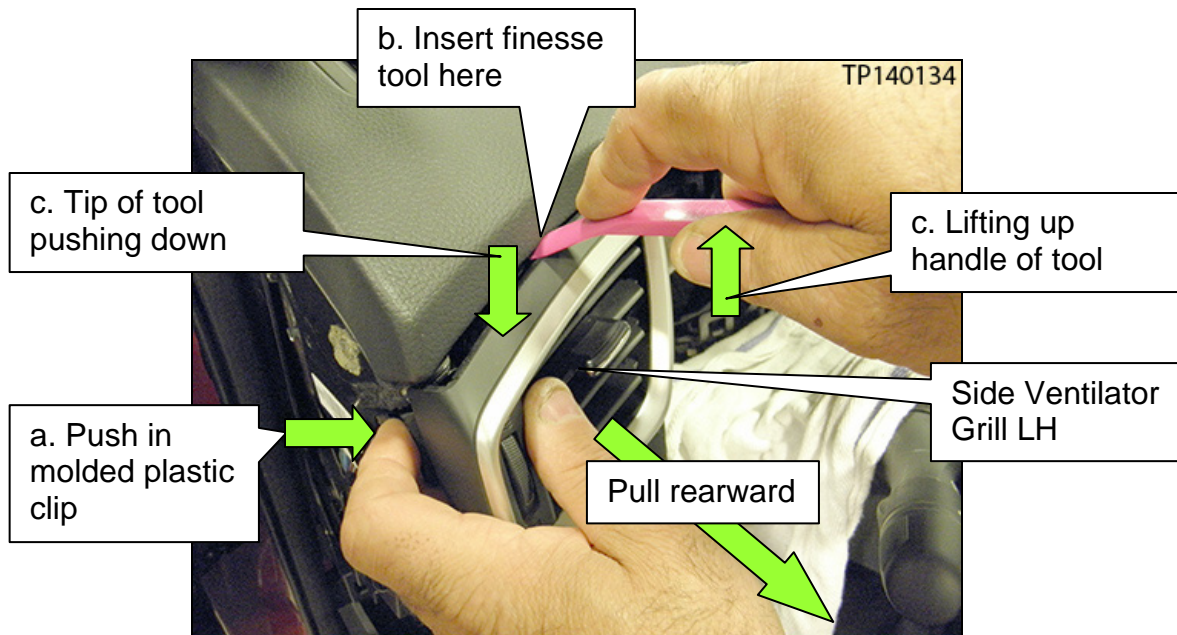

Figure 8

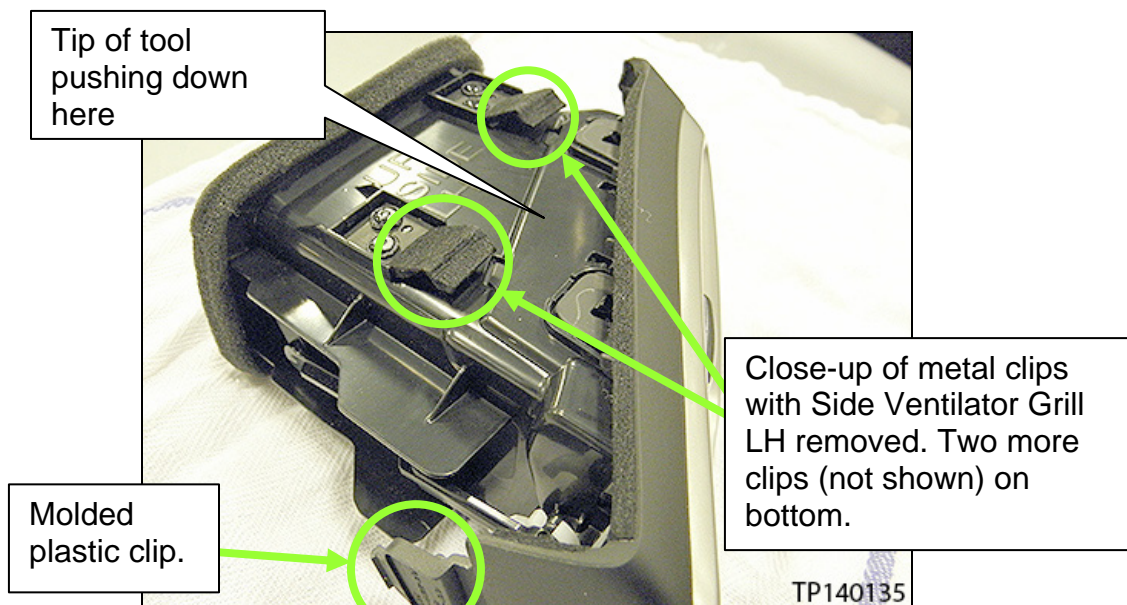

Figure 9

8. Remove the Instrument Finisher A (Figure 10), from the Instrument Panel by pulling rearward and then disconnect the wire harness connector (Figure 11) from the illumination control.

**NOTE:** There are three (3) metal clips and two (2) molded plastic clips that hold it to the Instrument Panel.

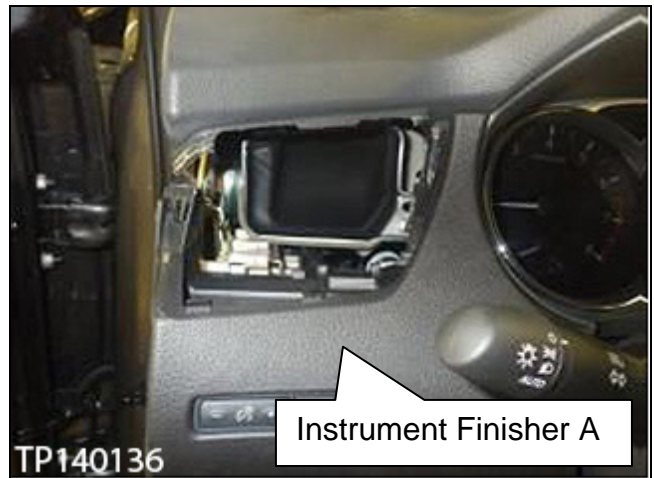

Figure 10

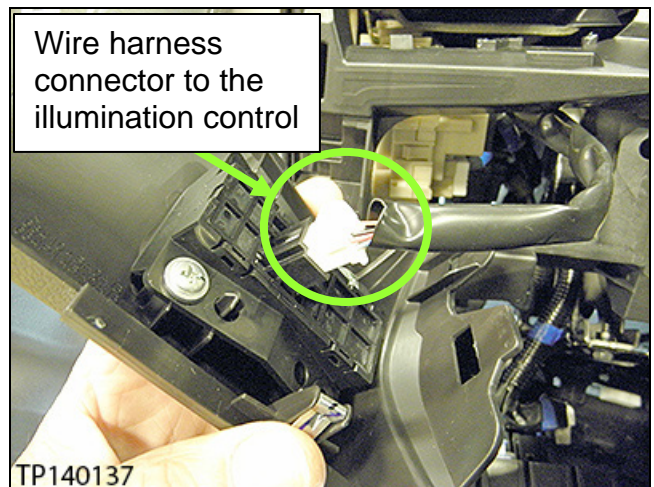

Figure 11

9. Lower the steering column to the lowest possible position and then extend the steering wheel to the farthest possible position from Combination Meter.



Figure 12

10. Remove the Gap Hider by lifting it up and away from the Steering Column Upper Cover.
- Four (4) metal clips.



Figure 13

11. Remove the Cluster Lid A from the Instrument Panel by pulling it rearward.
- Carefully lift out the Cluster Lid A taking care not to scratch or scuff the adjacent parts.
- NOTE:** The Cluster Lid A has seven (7) molded plastic clips and one (1) metal clip.

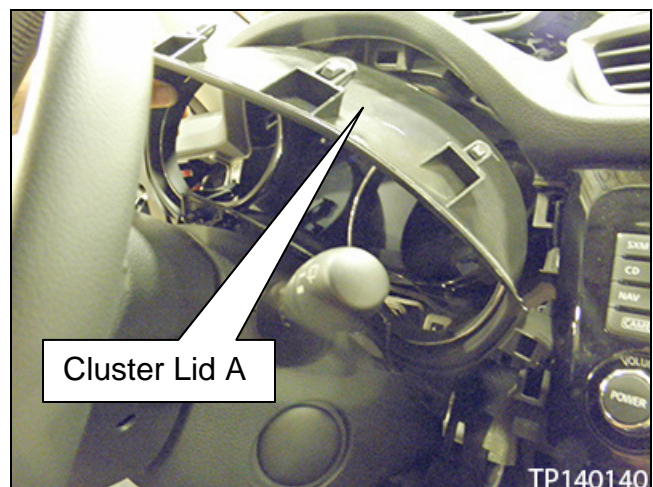

Figure 14

12. Remove the two (2) screws holding the Combination Meter shown in Figure 15.

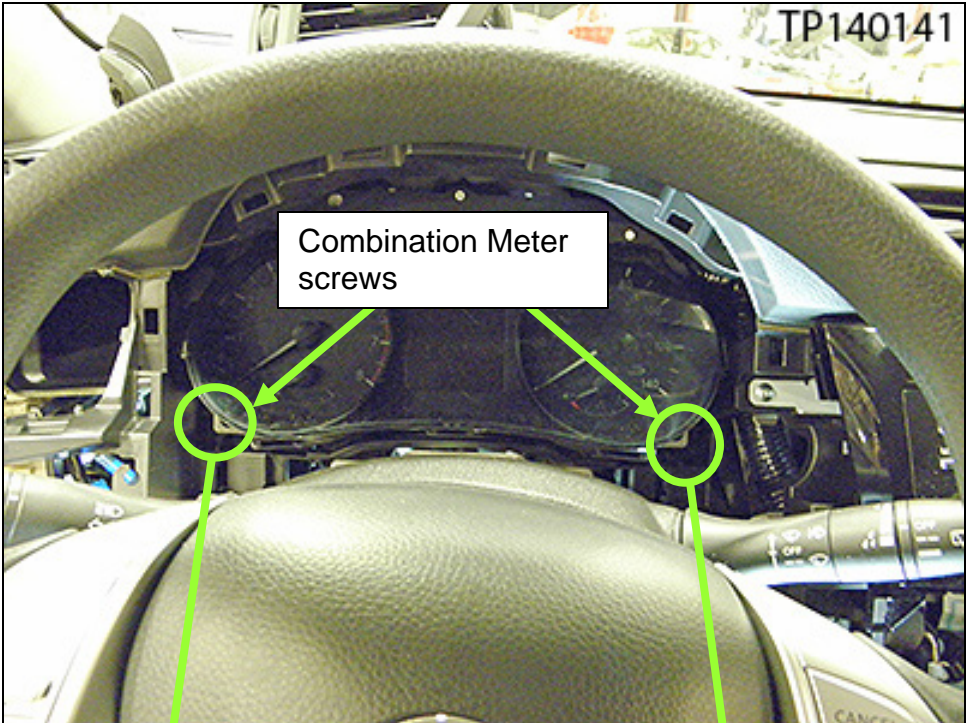

Figure 15

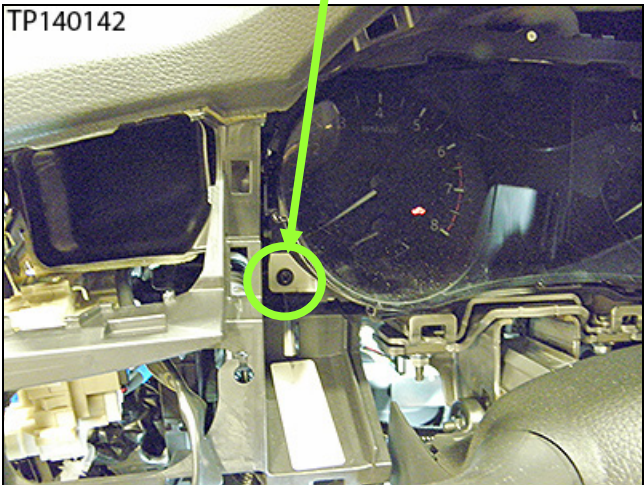

Figure 16

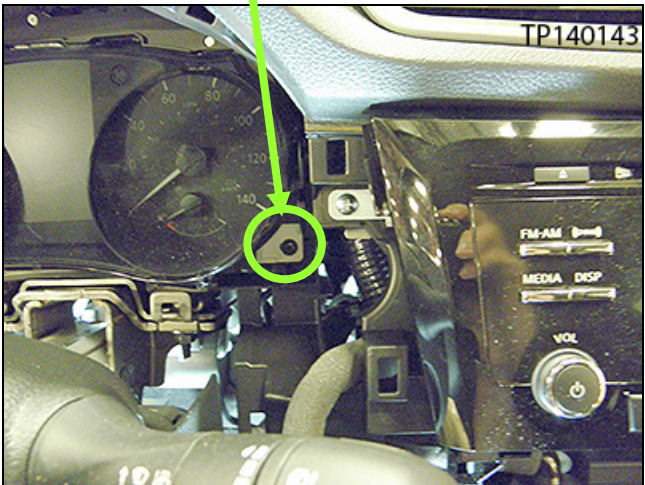

Figure 17

13. Cover the Steering Column Upper Cover with a clean shop towel.



Figure 18

14. Pull the Combination Meter rearward to unseat two (2) molded plastic clips attaching it to the Instrument Panel.

15. Unplug the Combination meter and place it out of the way.

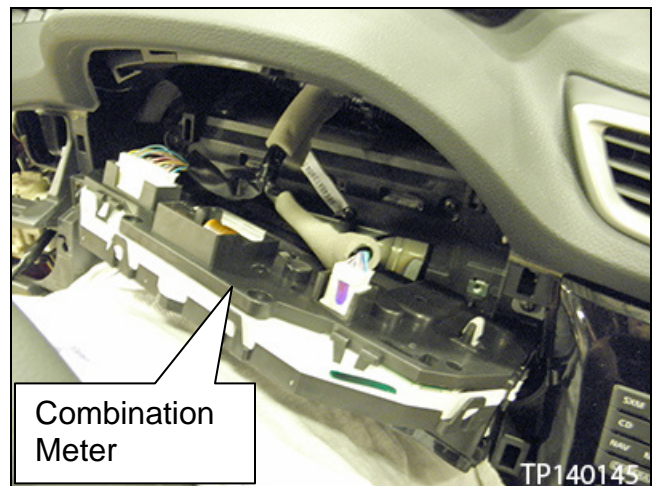

Figure 19



16. Remove one (1) screw that attaches the Instrument Panel to the Steering Member shown in Figure 21.

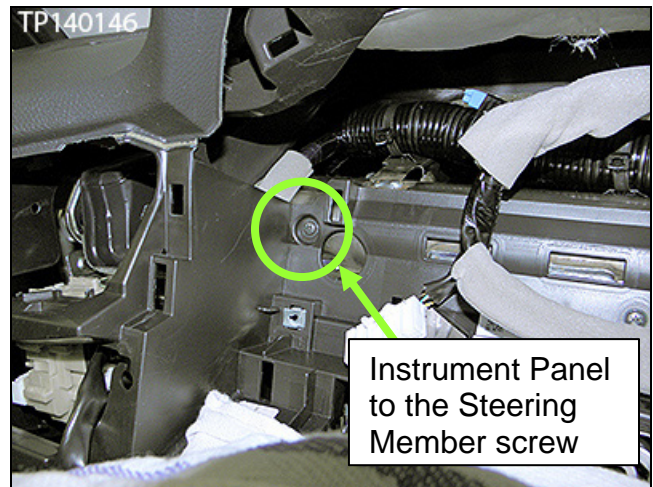

Figure 21

17. Insert one (1) shim (steel washer) between the Instrument Panel and Steering Member (Figure 22).

- The washer should have a 6 mm inside diameter and be approximately 2.5 mm - 3.0 mm thick.

**NOTE:**

- If a single washer cannot be found that is 2.5 mm – 3.0 mm, two washers that when combined are equal to the above thickness, can be substituted.
- It may be necessary to pull the Instrument Panel rearward to allow the washer to slide into place.

Insert washer here. Gap between the Instrument Panel and Steering Member

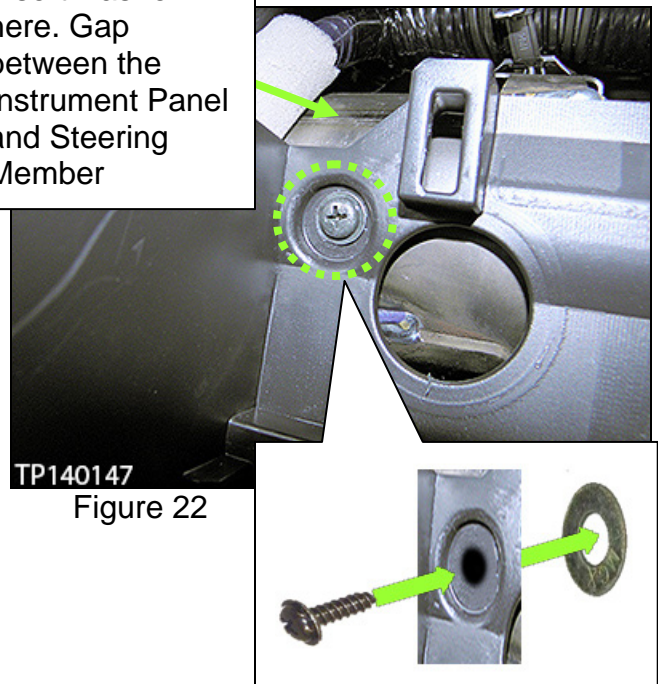

Figure 22

18. Reinstall the Instrument Panel screw removed in step 16 so that the screw passes through the center of the newly installed shim(s).

**NOTE:** in the following steps, use the disassembly Figures on the preceding pages for reference.

19. Install the Combination Meter by snapping the two (2) molded plastic clips to the Instrument Panel and then securing with two (2) screws.

20. Install the Cluster Lid A to Instrument Panel.

- Align and clip seven (7) molded plastic clips and one (1) metal clip to the Instrument Panel.

21. Install the Gap Hider to the Steering Column Upper Cover.

22. Install Instrument Finisher B.

23. Connect the illumination control wire harness connector and then install Instrument Finisher A to the Instrument Panel.

24. Install the Side Ventilator Grill LH into the Instrument Finisher A and Instrument Panel.

25. Apply felt tape (Part number J-50397-5 from Squeak and Rattle kit) to Instrument Lower Panel LH molded plastic clip as shown in Figure 23 and Figure 24.

- a. Remove any pre-existing felt tape.
- b. Cut the felt tape to approximately 8mm x 30mm.

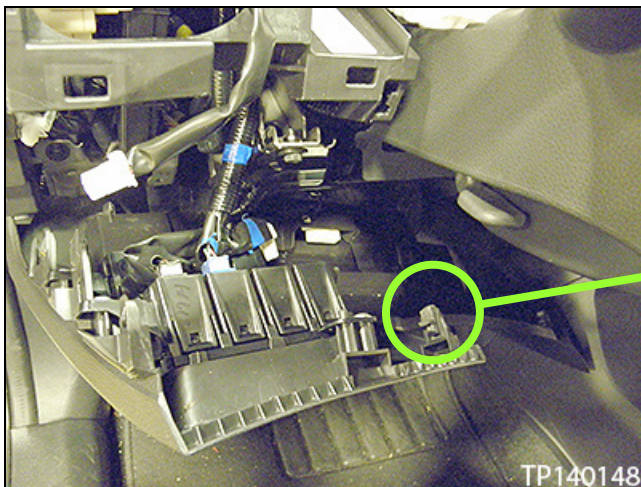

Figure 23

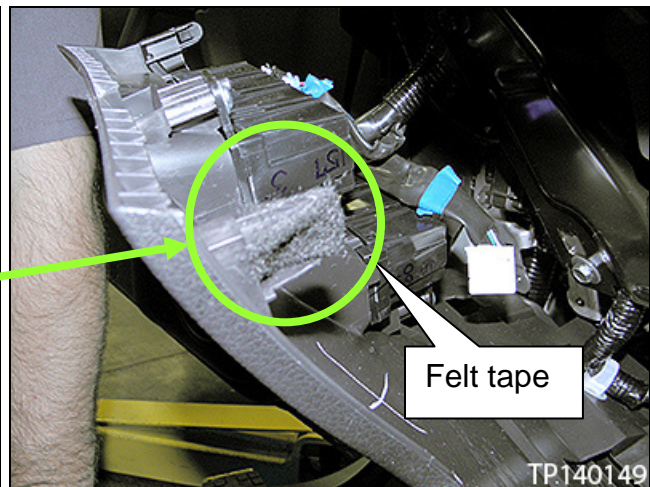

Figure 24

26. Install Instrument Lower Panel LH to Instrument Panel.

**NOTE:** With the added felt tape the clip will not respond with a snap when secured so after clipping "pull" to confirm that it locked to the Instrument Panel.

27. Install Fuel Filler Lid/Hood Lock Release Handle to the Instrument Lower Panel LH and secure with two (2) bolts.

28. Install the A/C Switch Assembly to the Instrument Panel.

29. Install the Instrument Side Finisher (LH).

## PARTS INFORMATION

DESCRIPTION	PART #	QUANTITY
Washer	(1)	1
Felt tape	J-50397-5 (2)	as needed

(1) Shop supplies

(2) From Squeak and Rattle Kit J-50397

## CLAIMS INFORMATION

OPERATION	OP CODE	PFP	SYM	DIAG	FRT
REPAIR - LOWER INSTRUMENT PANEL	VX4NAA	(1)	ZA	41	0.4

(1) Refer to the electronic parts catalog (FAST or equivalent) and use the appropriate Lower Instrument Panel part number (68106-\*\*\*\*\*) as the primary failed part.

