

**SUBJECT****Traffic Information Is Inoperative****MODEL**

E60 (5 Series Sedan) from 09/08

E61 (5 Series Sports Wagon) from 09/08

E63 (6 Series Coupe) from 09/08

E64 (6 Series Convertible) from 09/08

E70 (X5) from 10/08

E71 (X6) from 04/08

E72 (X6 ActiveHybrid)

E82 (1 Series Coupe) from 09/08

E84 (X1)

E88 (1 Series Convertible) from 09/08

E89 (Z4)

E90 (3 Series Sedan) from 09/08

E91 (3 Series Sports Wagon) from 09/08

E92 (3 Series Coupe) from 09/08

E93 (3 Series Convertible) from 09/08

F01 (7 Series Sedan)

F02 (7 Series Sedan)

F02H (7 Series Sedan ActiveHybrid)

F04H (7 Series Sedan ActiveHybrid)

F06 (6 Series Gran Coupe)

F07 (5 Series Gran Turismo)

F10 (5 Series Sedan)

F10H (5 Series Sedan ActiveHybrid)

F12 (6 Series Convertible)

F13 (6 Series Coupe)

F15 (X5)

F22 (2 Series Coupe)

F25 (X3)

F30 (3 Series Sedan)

F30H (3 Series Sedan ActiveHybrid)

F31 (3 Series Sports Wagon)

F32 (4 Series Coupe)

F33 (4 Series Convertible)

F34 (3 Series Gran Turismo)

With option 609 (Navigation System Professional)

and

With option 6AM (Real-Time Traffic Information)

or

With option 6UH (Real-Time Traffic Information)

SITUATION

The traffic information is intermittently or permanently inoperative.

- Traffic flow is not displayed on the navigation map.
- The traffic list is empty.

CAUSE

1. The Offboard Availability (backend) system is unavailable and is not sending traffic information.
2. The traffic information feature is not activated correctly.

CORRECTION

Do not replace parts, and do not program or code the vehicle.

Cause 1:

Refer to Service Information [B65 25 13](#) (ConnectedDrive/BMW ASSIST Features Are Inoperative) to check if the cause is related to an Offboard Availability (backend) system issue.

Cause 2:

Activate the traffic information feature by performing a BMW ASSIST Update in the vehicle, using the iDrive

controller.

PROCEDURE

1. Select the “Connected Drive” menu from the main menu.
2. When the “Connected Drive” menu is active on the CID (Central Information Display) screen, push the “Option” button next to the iDrive controller.

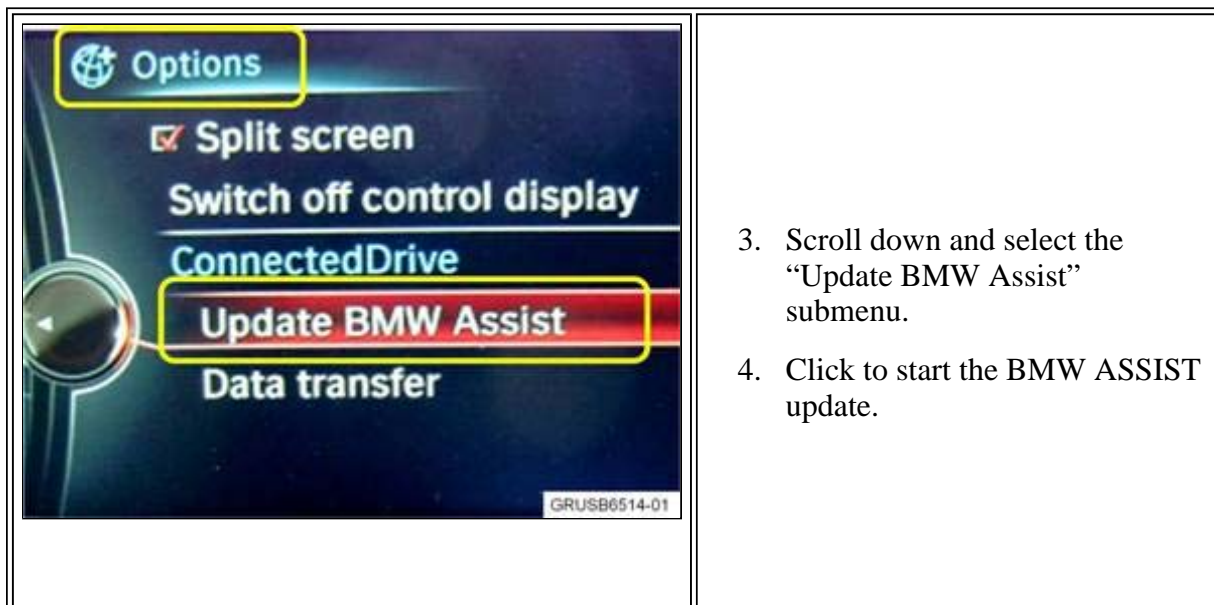

Additional information on the traffic information feature can be found in Service Information B65 77 06 (Real Time Traffic Information).

WARRANTY INFORMATION

Not applicable, since the first-time traffic information activation is part of the QC1 process and cannot be claimed separately.

[Copyright ©2014 BMW of North America, Inc.]