



Date: 21.02.2014 Model: All Toyota Powertrain Elise/4-Cylinder Exige Number: 2014/02 Models From Start of Production - '14MY VIN EHC10747

Copy files should be maintained by:

Table with 5 columns: Service Manager, Service Reception, Lotus Technicians, Parts Manager, and an empty column.

TITLE:

Retrofitment of the latest level windscreen washer bottle/pump assembly to earlier models if required.

REASON:

Due to parts obsolescence the windscreen washer bottle/pump assembly fitted to all Toyota power train Elise and 4-cylinder Exige from start of production (part number A116M0039F) is no longer available.

A production running change has been implemented from '14MY VIN EHC10747 with the fitment of a new windscreen washer bottle/pump assembly (part number A120M6058F). At the same time the 1ZR/2ZR main vehicle harness (F121M0064F) has also been updated to 'G' level to accommodate some minor revisions which includes a revised washer pump terminal block required to fit the electrical connections of the new washer pump.

ACTION:

To provide a suitable alternative to the obsolete A116M0039F washer bottle/pump assembly, a fly lead adaptor is now available so that the latest level production assembly can be retrofitted onto earlier models if required as shown in the table below:

Table with 2 columns: Engine Power Train and VINS Affected. Rows include 1ZZ - 2ZZ, 1ZR - 2ZR and their corresponding VINS affected.

* Except for '14MY VIN EHH10741 which is fitted with the latest level washer bottle/pump and main vehicle harness.

Parts Required For Retrofitment

Table with 3 columns: Description, Part Number, Qty/Vehicle. Lists various parts like Washer bottle/pump Assembly, Fly lead Adaptor, etc.

Retrofitment procedure

- 1. Washer bottle/pump assembly and mounting bracket removal:
A. Remove the vehicle battery; refer to service notes section MP.7 for further information.
B. Slide the washer bottle/pump assembly upwards and withdraw from its mounting bracket.

Continued.....

LOTUS CARS LIMITED

- C. Disconnect the main vehicle harness plug from the washer motor terminal connection.
- D. Disconnect the screen washer tube from the pump.
- E. The assembly can now be removed from the vehicle and discarded.
- F. Pull the carpet trim away from the luggage compartment/engine bay panel to access the 3 rivets securing the washer bottle mounting bracket to the engine bay panel.
- G. Using a suitable drill and bit, drill out the rivets, remove the old bracket and discard.

Note: take care to remove any swarf that may have accumulated during the drilling procedure.

2. Mounting bracket fitment:

- A. Place the new mounting bracket (Part number A120P0197F) into position. From within the luggage bay area fit the 2 longer rivets (part number A111W6614F) through the panel and into the two outer bracket mounting holes and the 1 shorter rivet (part number A111W6613F) to the brackets central mounting hole.

- B. From within the engine bay, place a washer (B075W4009Z) on the body of each rivet, confirm the bracket, rivets and washers are firmly in position then, using a suitable pop rivet gun, clamp the bracket into position.

- C. Refit the luggage compartment carpet.

3. Fly lead adaptor fitment:

- A. Cut the washer pump feed + (Green) and earth - (Black) wires at close proximity to the main vehicle harness connector; the connector can now be discarded.

- B. Using suitable wire strippers remove approximately 1cm of insulation of off the vehicle harness feed and earth wires.

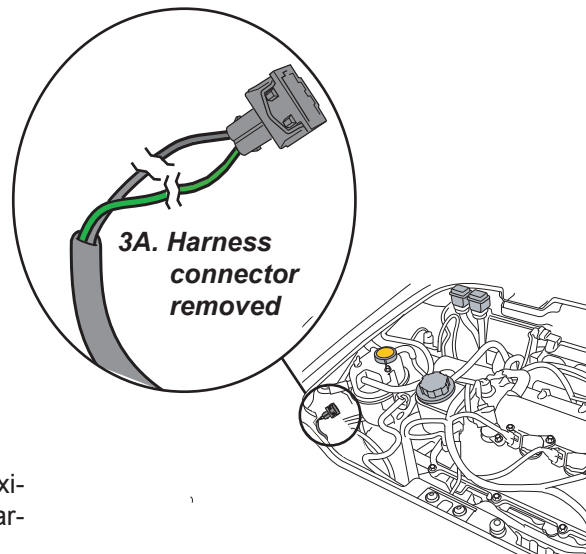
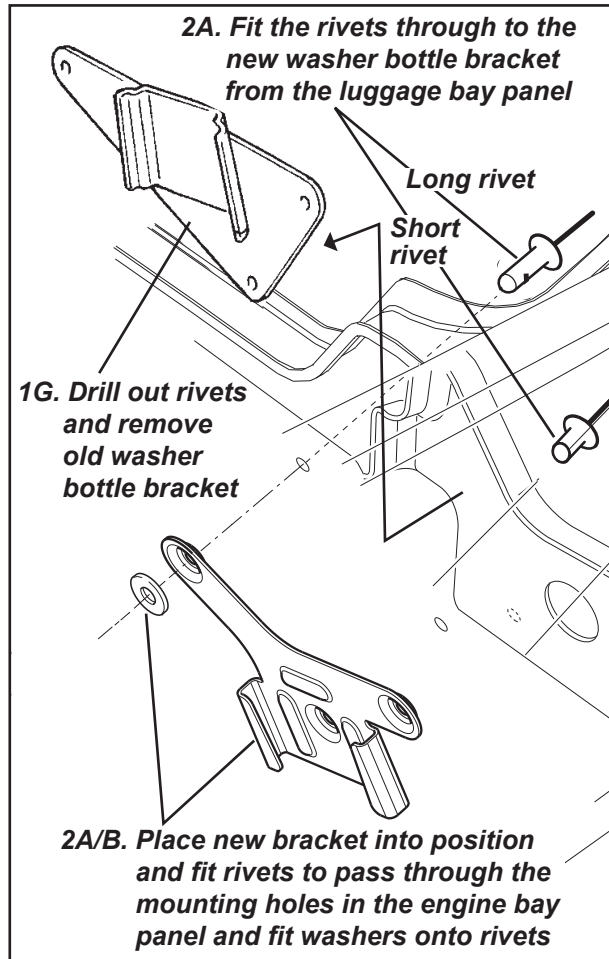

Continued.....

C. Repeat step B on the fly lead adaptor (A120M0090S).

D. Fit a butt connector (part number A120M6036S) over the ends of the vehicle harness feed and earth wires.

E. Fit the corresponding fly lead adaptors feed + (Green) and earth - (Black) wires to the main vehicle harness wire/butt connectors.

Ensure that the exposed conductor cores of the fly leads and harness wires are now adjacent to each other and positioned centrally within the connector so that pass through the solder ring of the connector.

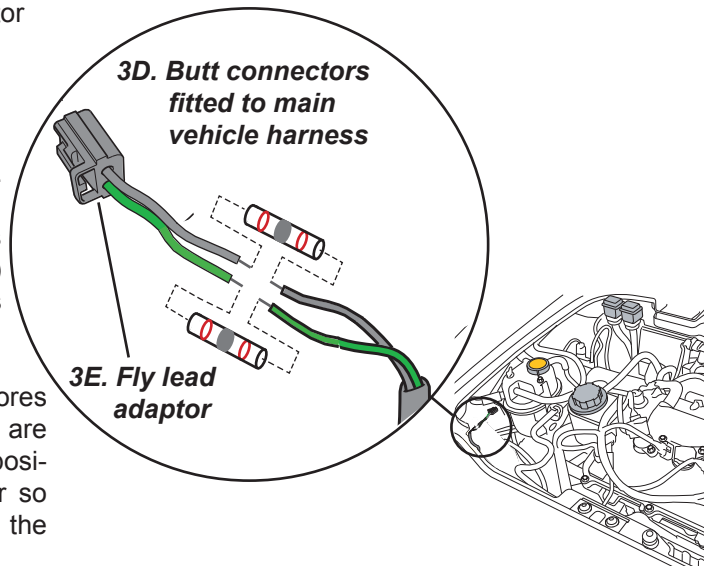

F. Using a suitable hot air gun, apply heat over the entire length of each butt connector ensuring the central soldered ring has melted and flowed over the wire cores and the outer casing has shrunk creating a tight seal over harness/fly lead insulation.

4. Washer bottle/pump assembly refitment:

A. Fit the screen washer tube to the new washer bottle/pump assembly.

B. Connect the modified harness connector to the washer pumps electrical terminals.

C. Slide the washer bottle/pump assembly onto the mounting bracket, and ensure washer tube and main vehicle harness routings are not kinked or fouling any other ancillary components.

E. Fill the washer bottle with the recommended screen wash/water solution, check for fluid leaks and correct pump operation.

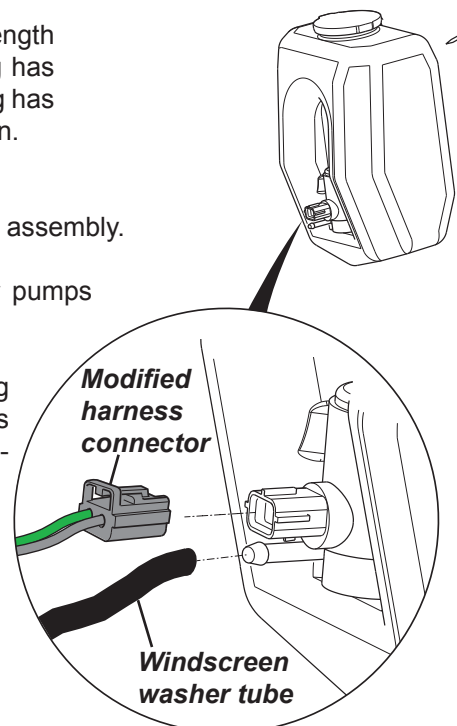

CHARGES:

Additional warranty costs apply only for the service replacement parts listed on page 1 of this bulletin (but only if the washer bottle/pump assembly is being renewed under the terms of the vehicle warranty)

No additional labour costs over and above the current time allowance for operation code 17.21.06-02 (Washer bottle and pump assembly renew) as shown in the '04 MY onwards Elise/Exige Labour Time Guide are associated with the contents of this bulletin.

Ends.

LOTUS CARS LIMITED