



Applies To: **See VEHICLES AFFECTED**

January 18, 2014

## MIL is on with P0420 or P0430

### SYMPTOM

MIL is on with DTC P0420 and/or DTC P0430 (catalyst system efficiency below threshold) with a possible DTC P2243 and/or DTC P2247 (A/F sensor 1 circuit high voltage).

### POSSIBLE CAUSE

One or both A/F Sensor 1 (Air Fuel Ratio) caps may have fallen off and bored a hole through the affected WU-TWC (Warm Up Three Way Catalyst).

### VEHICLES AFFECTED

#### 2010 Accord 2-door A/T:

From VIN 1HGCS2B..AA008601 thru  
1HGCS2B..AA009464

#### 2010 Accord 2-door M/T:

From VIN 1HGCS2A..AA008781 thru  
1HGCS2A..AA008840

#### 2010 Accord 4-door A/T:

From VIN 1HGCP3...AA023009 thru  
1HGCP3...AA025113

From VIN 5KBCP3...AB016172 thru  
5KBCP3...AB016473

#### 2010 Crosstour 2WD:

From VIN 5J6TF1...AL011378 thru  
5J6TF1...AL012391

#### 2010 Crosstour 4WD:

From VIN 5J6TF2...AL009991 thru  
5J6TF2...AL011551

#### 2010 Odyssey EX, EX-L, EX RES:

From VIN 5FNRL3...AB069816 thru  
5FNRL3...AB086414

#### 2010 Pilot 2WD:

From VIN 5FNYP3...BB006605 thru  
5FNYP3...BB007888

#### 2010 Pilot 4WD:

From VIN 5FNYP4...BB00001 thru  
5FNYP4...BB017640

#### 2010 Ridgeline:

From VIN 5FPYK1...AB012510 thru  
5FPYK1...AB013080

### CORRECTIVE ACTION

Replace the affected A/F sensor and WU-TWC, then locate and retrieve the A/F sensor cap.

### PARTS INFORMATION

#### Common Parts

EGR Pipe Lower Gasket (front WU-TWC replacement):  
P/N 18719-R70-A01

EGR Pipe Upper Gasket (front WU-TWC replacement):  
P/N 18716-R70-A01

Lower WU-TWC Gasket:  
P/N 18212-SA7-003

Self-Locking Nut (8 mm) (four required):  
P/N 90212-RCA-A01

Self-Locking Nut (10 mm)(12 required):  
P/N 90212-SA5-003

Upper WU-TWC Gasket:  
P/N 18115-R70-A01

Under Floor TWC Gasket (Fr):  
P/N 18393-SDB-A00

#### Accord Parts

Front A/F Sensor:  
P/N 36531-R70-A02

Front WU-TWC:  
P/N 18190-R70-A10

Rear A/F Sensor:  
P/N 36541-R70-A01

Rear WU-TWC:  
P/N 18290-R70-A00

Under Floor TWC Gasket:  
P/N 18393-SDB-A00

**Crosstour Parts**

Front A/F Sensor:  
P/N 36531-R70-A02

Front WU-TWC:  
P/N 18190-RBR-A00

Rear A/F Sensor:  
P/N 36541-R70-A01

Rear WU-TWC:  
P/N 18290-RBR-A00

Under Floor TWC Gasket:  
P/N 18393-SDB-A00

**Odyssey Parts**

Cotter Pin (rear WU-TWC replacement):  
P/N 90701-S3V-A01

Front A/F Sensor:  
P/N 36531-RGW-A01

Front WU-TWC:  
P/N 18190-RN0-A01

Intermediate Shaft Snap-Ring  
(rear WU-TWC replacement):  
P/N 44319-SD4-010

Lower Ball Joint Castle Nut  
(rear WU-TWC replacement):  
P/N 90363-S3V-A01

Rear A/F Sensor:  
P/N 36541-RGW-A01

Rear WU-TWC:  
P/N 18290-RGW-A01

Spindle Nut:  
P/N 90305-S3V-A11

Under Floor TWC Gasket:  
P/N 18302-SP0-003

**Pilot Parts**

Cotter Pin (rear WU-TWC replacement):  
P/N 90701-S3V-A01

Front A/F Sensor:  
P/N 36531-R70-A02

Front WU-TWC:  
P/N 18190-RN0-A01

Intermediate Shaft Snap-Ring  
(rear WU-TWC replacement):  
P/N 44319-SD4-010

Lower Ball Joint Castle Nut  
(rear WU-TWC replacement):  
P/N 90363-S3V-A01

Rear A/F Sensor:  
P/N 36541-R70-A01

Rear WU-TWC:  
P/N 18290-RGW-A01

Spindle Nut:  
P/N 90305-SD4-003

Under Floor TWC Gasket:  
P/N 18393-SDB-A00

**Ridgeline Parts**

Cotter Pin (rear WU-TWC replacement):  
P/N 90701-S3V-A01

Front A/F Sensor:  
P/N 36531-R70-A02

Front WU-TWC:  
P/N 18190-RN0-A01

Intermediate Shaft Snap-Ring  
(rear WU-TWC replacement):  
P/N 44319-SD4-010

Lower Ball Joint Castle Nut  
(rear WU-TWC replacement):  
P/N 90363-S3V-A01

Rear A/F Sensor:  
P/N 36541-R70-A01

Rear WU-TWC:  
P/N 18290-RGW-A01

Spindle Nut:  
P/N 90305-S3V-A11

Under Floor TWC Gasket:  
P/N 18393-SDB-A00

## REQUIRED MATERIALS

Moly 60 Paste: (Odyssey, Pilot, Ridgeline)  
P/N 08734-0001

High Temp Urea Grease: (Odyssey, Pilot, Ridgeline)  
P/N 08798-9002

## TOOL INFORMATION

Ball Joint Remover:  
T/N 07MAC-SL0A102

Ball Joint Thread Protector:  
T/N 071AF-SZVA000

O2 Sensor Socket Wrench (commercially available):

## WARRANTY CLAIM INFORMATION

The normal warranty applies.

### Accord

OP#	Description	FRT
1201K5	<b>Procedure A</b> -Replace the front WU-TWC, primary A/F sensor, and check the TWC for cap (includes diagnosis).	1.6 hr
1201K6	<b>Procedure B</b> -Replace the rear WU-TWC, primary A/F sensor, and check the TWC for cap (includes diagnosis, no alignment needed).	1.6 hr

### Crosstour

OP#	Description	FRT
1201K5	<b>Procedure A</b> -Replace the front WU-TWC, primary A/F sensor, and check the TWC for cap (includes diagnosis).	1.6 hr
1201K6	<b>Procedure B</b> -Replace the rear WU-TWC, primary A/F sensor, and check the TWC for cap (includes diagnosis, no alignment needed).	1.6 hr

### Odyssey

OP#	Description	FRT
1201K5	<b>Procedure A</b> -Replace the front WU-TWC, primary A/F sensor, and check the TWC for cap (includes diagnosis).	1.7 hr
1201K6	<b>Procedure B</b> -Replace the rear WU-TWC, primary A/F sensor, and check the TWC for cap (includes diagnosis and alignment).	1.6 hr

## Pilot

OP#	Description	FRT
1201K5	<b>Procedure A</b> -Replace the front WU-TWC, primary A/F sensor, and check the TWC for cap (includes diagnosis).	1.6 hr
1201K6	<b>Procedure B</b> -Replace the rear WU-TWC, primary A/F sensor, and check the TWC for cap (includes diagnosis and alignment).	2.1 hr

## Ridgeline

OP#	Description	FRT
1201K5	<b>Procedure A</b> -Replace the front WU-TWC, primary A/F sensor, and check the TWC for cap (includes diagnosis).	1.4 hr
1201K6	<b>Procedure B</b> -Replace the rear WU-TWC, primary A/F sensor, and check the TWC for cap (includes diagnosis and alignment).	1.5 hr

Failed Part: 36541-R70-A01

Defect Code: 07801

Symptom Code: 03203

Skill Level: Repair Technician

## DIAGNOSIS

1. Connect the HDS to the vehicle and check for DTCs: P0420 or P0430.  
**NOTE: In addition** to DTCs P0420 and P0430, you may also see DTCs P2243 or 2247 stored; the A/F sensor tip may have broken off the A/F sensor.

2. Remove the primary A/F sensor located on top of the affected catalytic converter.

**NOTE:** For example: If DTC P0420 is stored remove the rear (bank one) primary A/F sensor.

3. Check for a missing cap from the primary A/F sensor.

**GOOD**

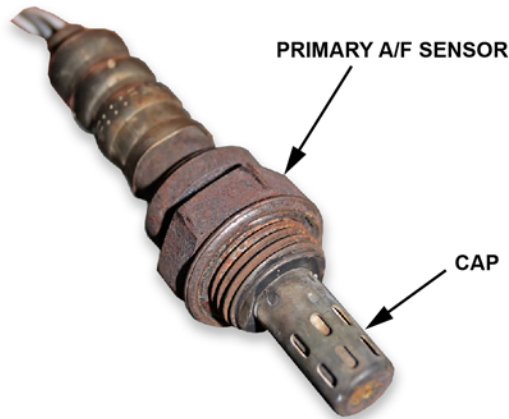

**NO GOOD**



- If DTC P0430 is stored and the cap is missing from the front (bank two) primary A/F sensor go to REPAIR PROCEDURE A.
- If DTC P0420 is stored and the cap is missing from the rear (bank one) primary A/F sensor go to REPAIR PROCEDURE B.
- If the cap is not missing, this bulletin does not apply, continue with normal troubleshooting.

## SERVICE MANUAL PROCEDURES

The following service manual procedures have been used in full or in part within this service bulletin. For more detail on these procedures, and torque specifications for some components, refer to the appropriate electronic service manual.

- Condenser Fan Removal/Installation
- Driveshaft Removal/Installation
- A Pipe Removal/Installation
- Warm Up TWC Removal/Installation
- Under Floor TWC Removal/Installation

## REPAIR PROCEDURE A

1. Remove the engine cover.

*Pilot shown:*

**ENGINE COVER**

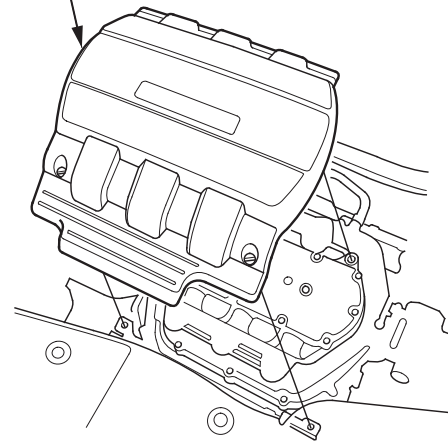

- If not disconnected already, disconnect the 4P connector and remove the front primary WU-TWC A/F sensor.

**Pilot shown:**

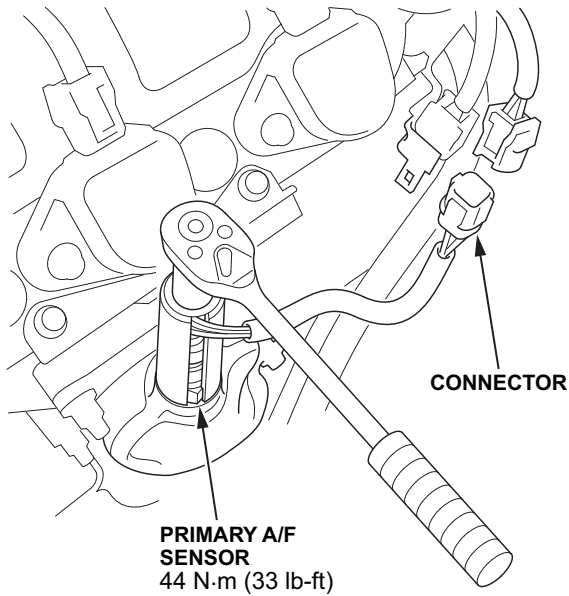

- Disconnect the 4P connector and remove the harness clamps securing the front WU-TWC secondary A/F sensor harness.

**Pilot shown:**

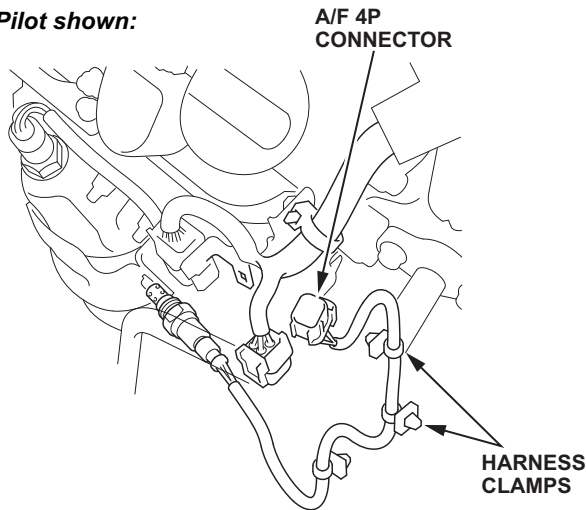

- Remove the front secondary A/F sensor.

**Pilot shown:**

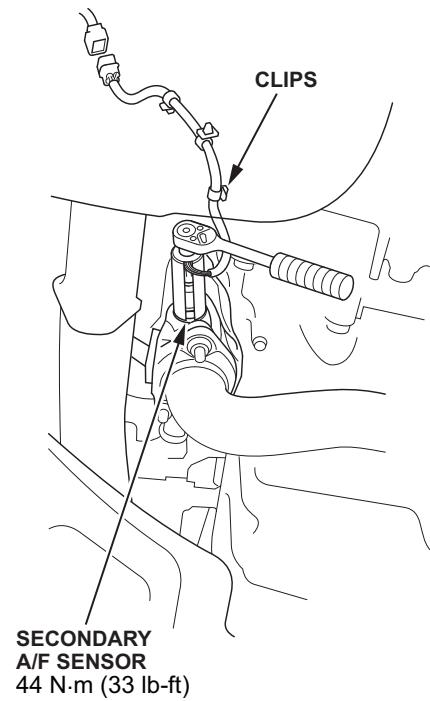

- Remove the EGR pipe.

**Pilot shown:**

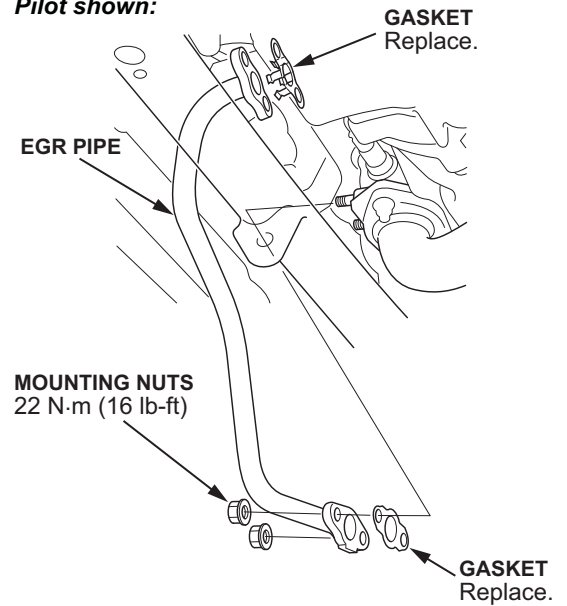

6. If necessary, remove the A/C condenser fan assembly.

**NOTE:** Place an appropriate size piece of cardboard in front of the radiator. This protects the radiator from damage when removing the front catalytic converter.

**Pilot shown:**

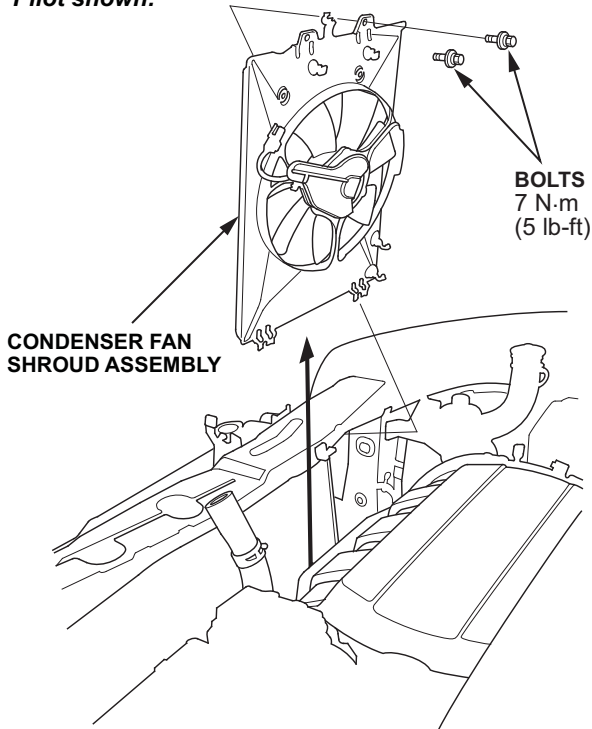

7. Remove the No. 5 ignition coil and the ignition coil heat insulator.

**Pilot shown:**

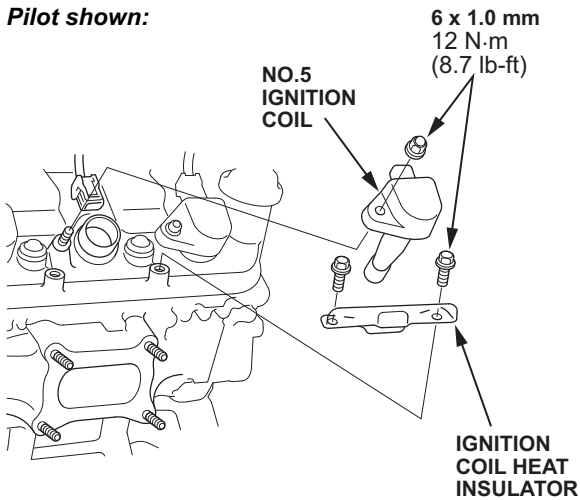

8. Raise the vehicle.

9. Remove the exhaust pipe hangers then remove the A pipe.

**Pilot shown:**

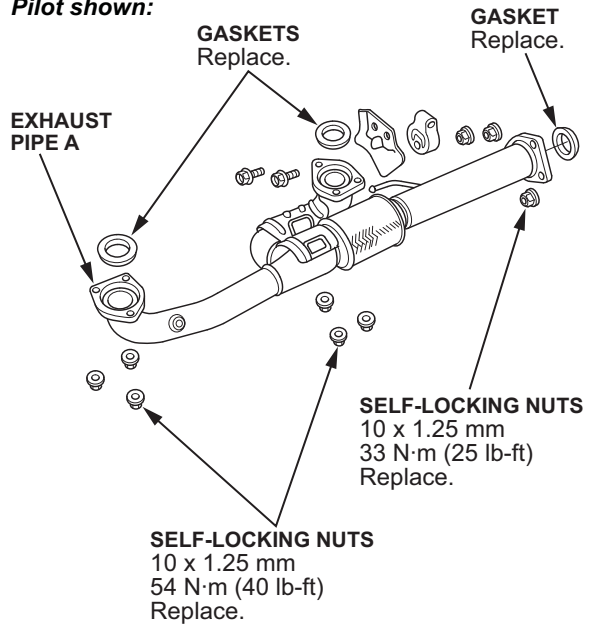

10. Remove the front catalytic converter.

**Pilot shown:**

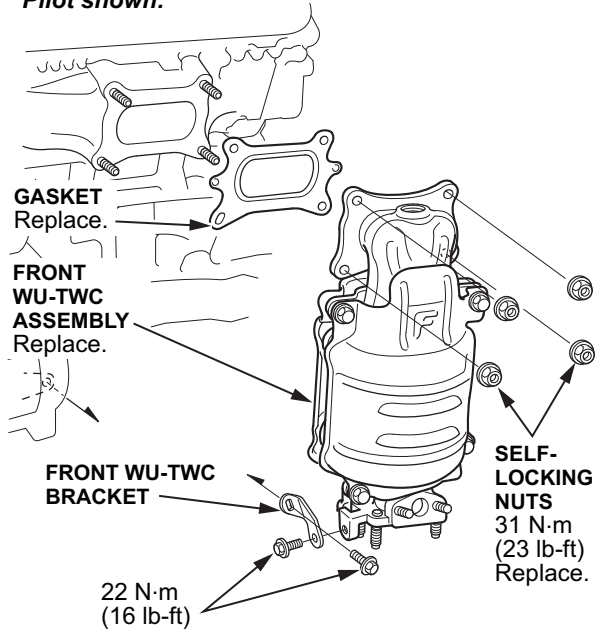

11. Go to UNDER FLOOR TWC and check for the missing A/F sensor cap.

## REPAIR PROCEDURE B

1. Remove the engine cover.

*Pilot shown:*

ENGINE COVER

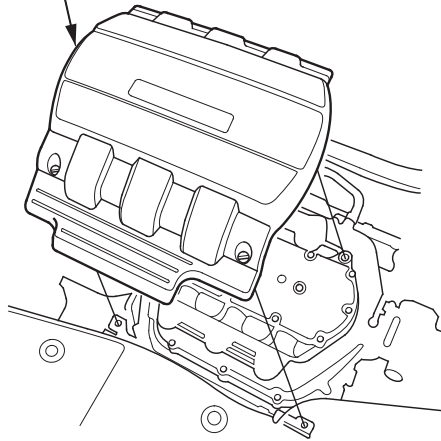

2. Disconnect the connector and remove the rear primary WU-TWC A/F sensor.

*Pilot shown:*

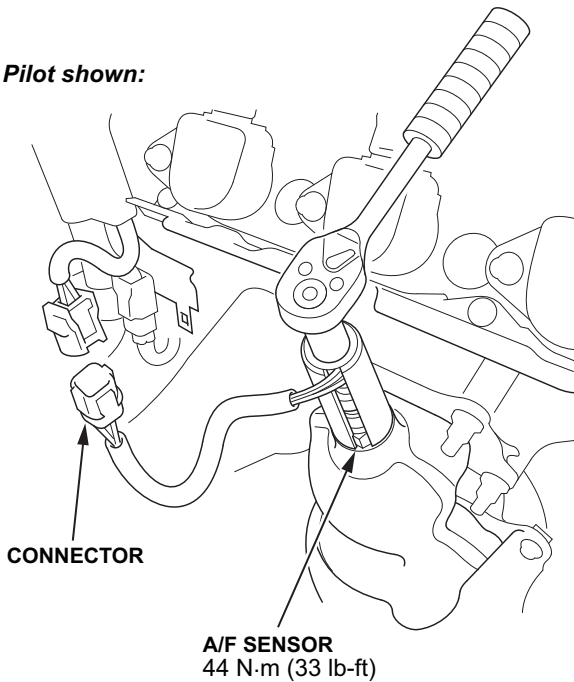

3. Raise the vehicle.

4. Remove the rear secondary A/F sensor.

*Pilot shown:*

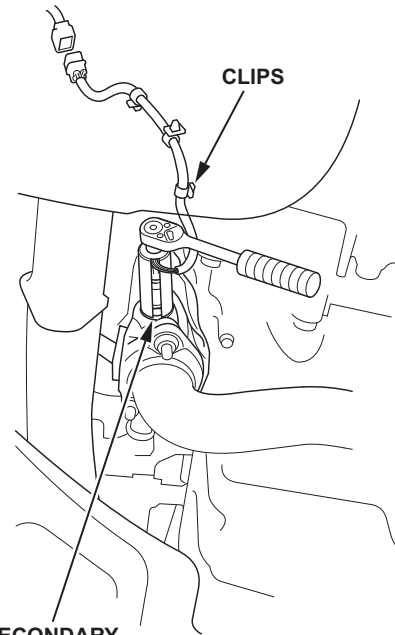

SECONDARY  
A/F SENSOR  
44 N·m (33 lb-ft)

5. Remove the right front wheel.
6. *Odyssey, Pilot, and Ridgeline only:* Remove the brake hose mounting bolt from the right damper.

*Pilot shown:*

BRAKE HOSE  
MOUNTING BOLT  
22N·m (16 lb-ft)

BRAKE HOSE

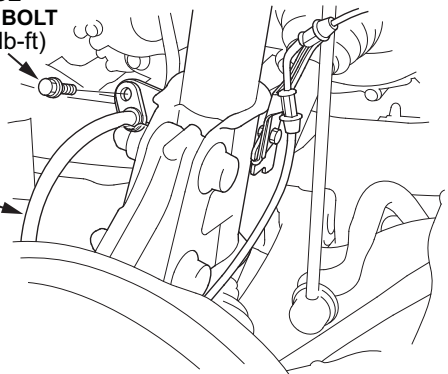



7. *Odyssey, Pilot and Ridgeline only:* Separate the right lower ball joint.

*Pilot shown:*

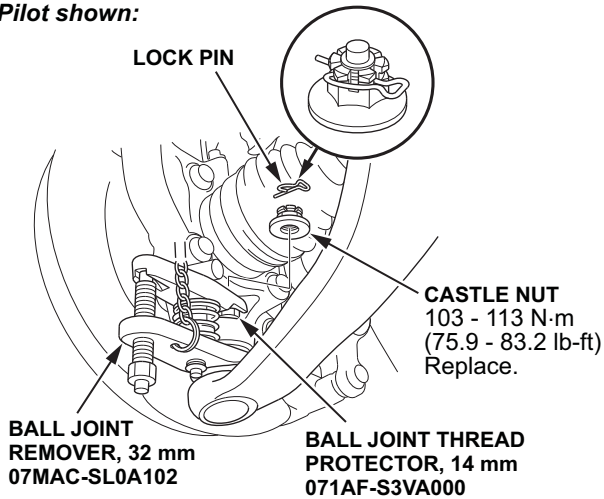

8. *Odyssey, Pilot and Ridgeline only:* Remove the spindle nut.
9. *Odyssey, Pilot and Ridgeline only:* Remove the right driveshaft.

NOTE: Drive the inboard joint off the intermediate shaft using a drift and hammer. **Do not** pull on the driveshaft or the inboard joint may come out.

*Pilot shown:*

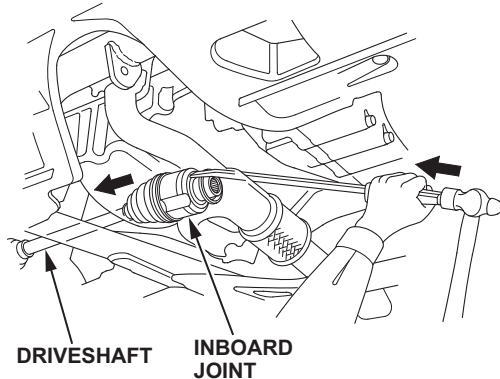

10. Remove the rear WU-TWC exhaust pipe bracket.

*Pilot shown:*

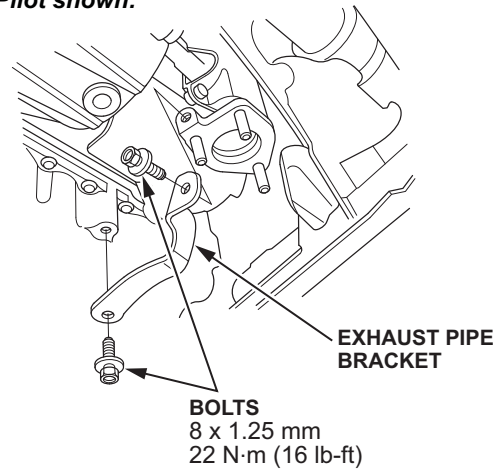

11. Remove the rear WU-TWC.

*Pilot shown:*

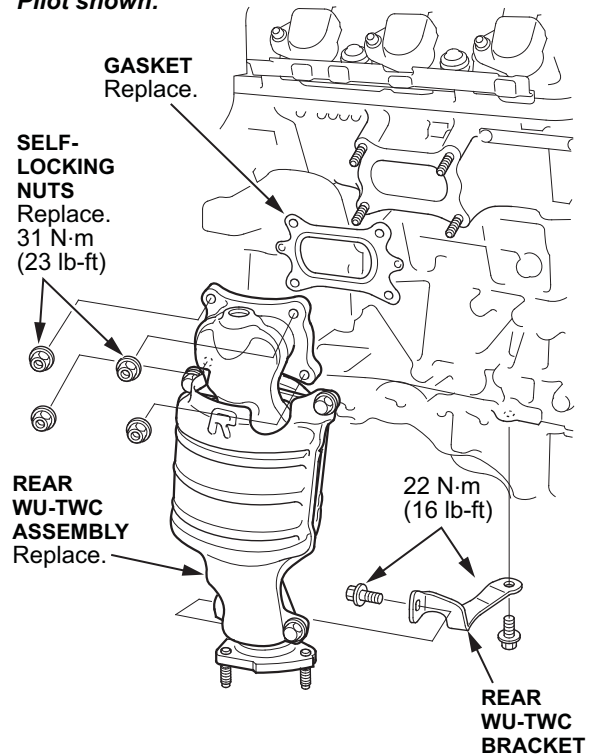

12. Go to UNDER FLOOR TWC and check for the missing A/F sensor cap.



## Under Floor TWC

1. Remove the under floor TWC.

*Pilot shown:*

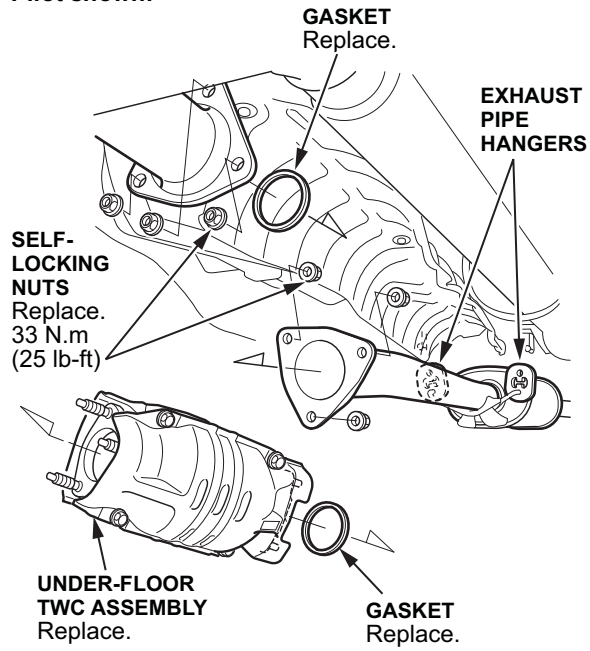

2. Search the under floor TWC for the missing A/F sensor cap and remove it.
3. Install all components in reverse order of removal.
4. Check wheel alignment and adjust if necessary.