



Service Bulletin

File in Section: -

Bulletin No.: PI1293

Date: August, 2014

PRELIMINARY INFORMATION

Subject: A/C Compressor Clutch Inoperative

Models: 2012-2013 Caprice PPV
Vehicles Equipped with Police Option Package (RPOs 9C1, 9C3)

Condition/Concern

Some customers may comment on the A/C being inoperative.

This may be caused by the clutch coil thermal fuse failing.

This may be due to the thermal fuse in the A/C compressor clutch is an open circuit.

Recommendation/Instructions

Technicians are asked to perform standard diagnostics in SI. If no underlying cause can be found, replace the A/C compressor clutch with one of the following part numbers listed below.

1. Remove the radiator air deflector. Refer to Cooling Fan and Shroud Replacement.
2. Remove the air filter assembly. Refer to Air Cleaner Assembly Replacement.
3. Remove the A/C drive belt. Refer to Air Conditioning Compressor Belt Replacement.

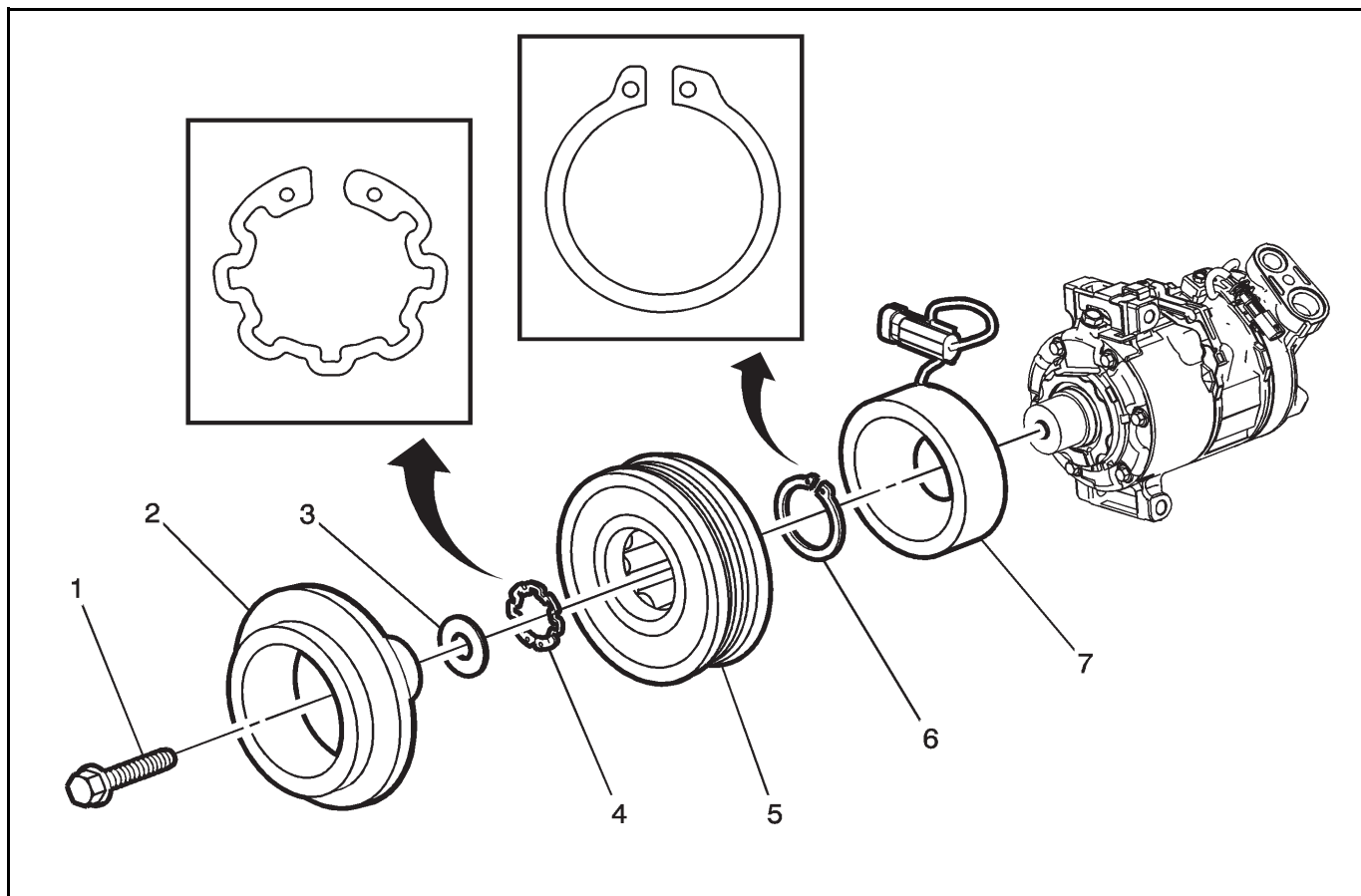

3270240

4. Use the J-37872 Universal Spanner Wrench to hold the compressor clutch drive plate (2) from turning when removing the bolt (1).

Important: Measure and adjust the air conditioning compressor clutch drive plate. Refer to Air Conditioning Clutch Drive Plate Adjustment.

- 5. Remove the retaining ring (4).
- 6. Remove the air conditioning compressor pulley (5).
- 7. Remove the retaining ring (6).
- 8. Disconnect the connector and remove the air conditioning compressor coil (7).

Parts Information

Part Number	Description
92279285	CLUTCH KIT, A/C - V6 Engines
92279286	CLUTCH KIT, A/C - V8 Engines

Warranty Information

For vehicles repaired under the Bumper-to-Bumper coverage (Canada Base Warranty coverage), use the following labor operation. Reference the Applicable Warranties section of Investigate Vehicle History (IVH) for coverage information.

Labor Operation	Description	Labor Time
4480198*	Air Conditioning Clutch Replacement (On Vehicle)	1.1 hrs
*This is a unique Labor Operation for Bulletin use only. It will not be published in the Labor Time Guide.		