

REFERENCE:	Nova Bus Manuals
SECTION:	14: Heating and ventilation
RS N°:	MQR 7621-681
EFFECTIVE IN PROD.:	–

APPLICATION DEADLINE: 2015JL15
CLAIM REFERENCE NUMBER: WB-3165

SUBJECT:	A/C compressor belt
JUSTIFICATION:	A/C compressor belts are splitting down the center.

LEVEL	DESCRIPTION	DIRECT CHARGES		TIME
		LABOUR	MATERIAL	
1	Inspect for correct compressor plate hardware and change the compressor rubber mounts and belt.	Nova Bus	Nova Bus	60 min
2	Change the compressor plate hardware.	Nova Bus	Client*	10 min

* The cost of the material will be reimbursed when claiming for this service document.

MATERIAL

QTY	PART N°	REV.	DESCRIPTION	REPLACES PART N°
LEVEL 1				
1	N78165	–	Compressor Belt 79"	N68866
1	N70081	–	Compressor mount 40-45SH	–
3	N74196	–	Anti-vibration mount 70SH	N36493
LEVEL 2 (only if required*)				
8	N32932	–	Nordlock washer M12	–
4	N69378	–	Nut FL M12 Dacromet Class 10.9	–
3	N69539	–	Screw M12x50 Hex Dacromet Class 10.9	–
1	N69540	–	Screw M12x70 Hex Dacromet Class 10.9	–

Materials will be available within 42 days. To order, please contact Prevost Parts by phone at 1-800-771-6682, by fax at 1-888-668-2555 or by email at prevostparts.commandes@volvo.com. Specify document number, quantity of parts required and shipping address.

* The material identified in Level 2 is to be ordered only for vehicles that meet the criteria defined in Level 1.

DISPOSAL OF PARTS

REMOVED PARTS ARE:	DISCARDED *	RETAINED	* Dispose of the unused parts and the defective parts in accordance with local environmental standards in effect.
	Yes	–	

REVISION HISTORY

REV.	DATE	CHANGE DESCRIPTION	WRITTEN BY
NR	2014MA27	Initial release	Bertrand Plouffe
R1	2014SE17	Change in level 2 part list & torque change	Bertrand Plouffe

CLIENT	ORDER	ROAD NUMBER		VIN (2NVY/4RKY...)		QTY
		FROM	TO	FROM	TO	
New York City Transit - New York	L643	5895	5895	S92U1B4000143	S92U1B4000143	1
New York City Transit - New York	L681	5896	5263	S92U2C4500023	S92U3C4500175	102
New York City Transit - New York	L692	5298	5298	S92U5C4500209	S92U5C4500209	1
New York City Transit - New York	L692	5303	5303	S92U0C4500215	S92U0C4500215	1
New York City Transit - New York	L692	5306	5363	S92U4C4500217	S92U3D4500274	58

**WARNING**

Follow your internal safety procedures.

PROCEDURE

LEVEL 1: PROCEDURE

- 1.1. Open the rear engine access door.
- 1.2. Locate the A/C compressor. See Figure 1.

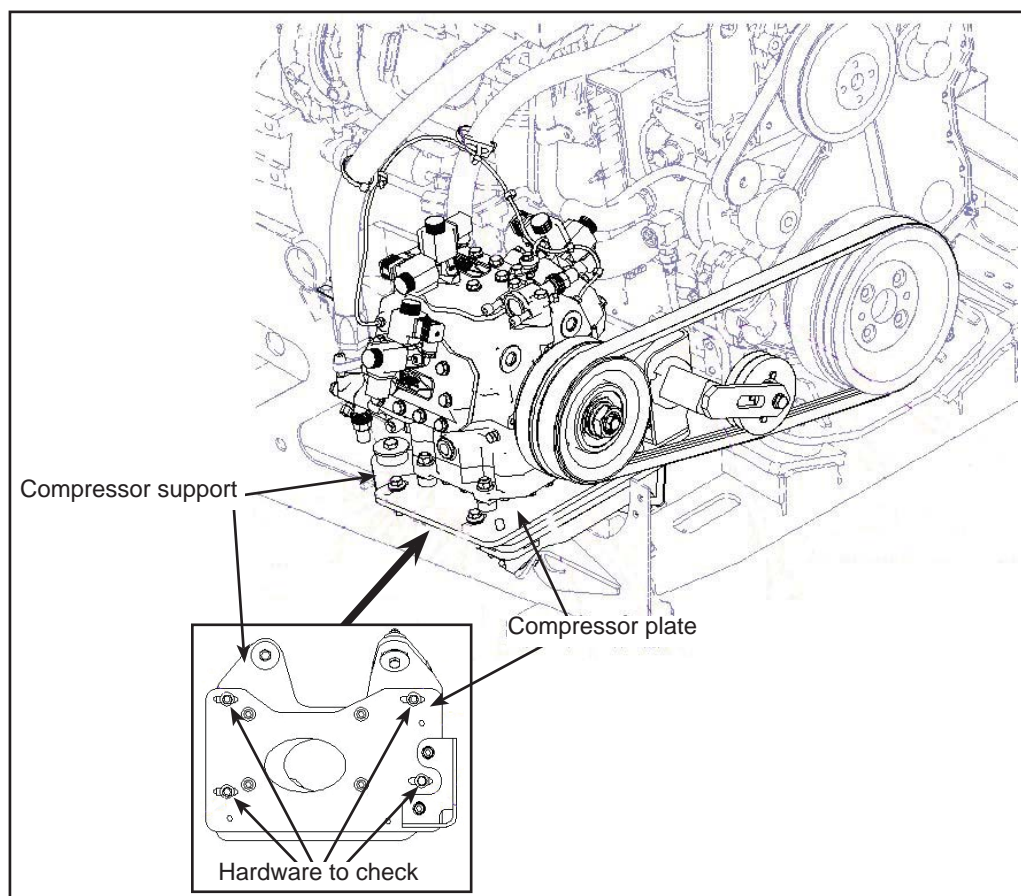

Figure 1 - A/C Compressor Location

- 1.3. Remove the A/C compressor belt in accordance with section 14: **HEATING AND VENTILATION** in the Nova Bus maintenance manual. Discard the belt.
- 1.4. Check if M12 Nordlock washers (8x), M12 class 10.9 bolts (4x) and M12 class 10.9 nuts (4x) which maintain the compressor plate on the A/C compressor support, are already installed. See Figure 1. If not in place, go to Level 2.

- 1.5. Remove the four rubber mounts on the A/C compressor support. See Figure 2.

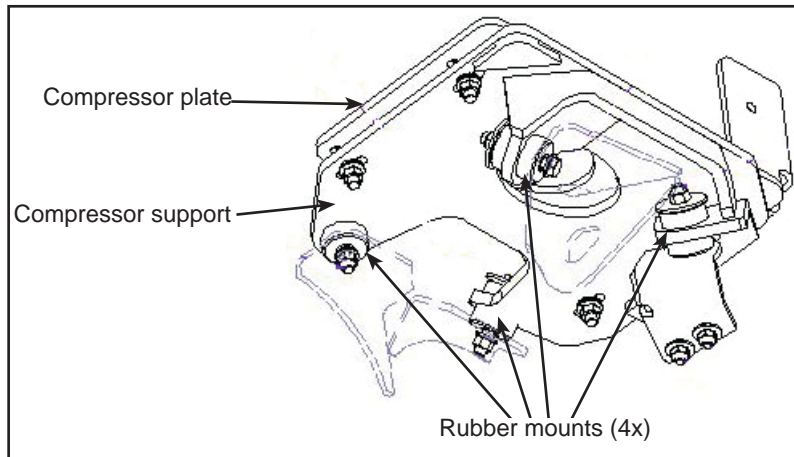

Figure 2 - A/C Compressor Support Rubber Mounts

- 1.6. Install the new N74196 (3x) and N70081(1x) rubber mounts on the A/C compressor support. See Figure 3.

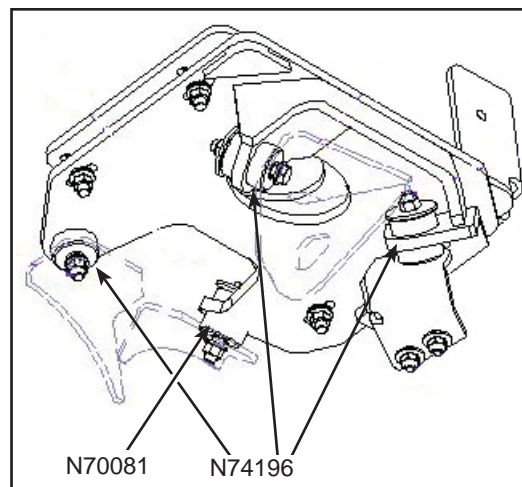

Figure 3 - Location of New A/C Compressor Rubber Mounts

- 1.7. Apply specified torque and torque sequence. See Figure 4.

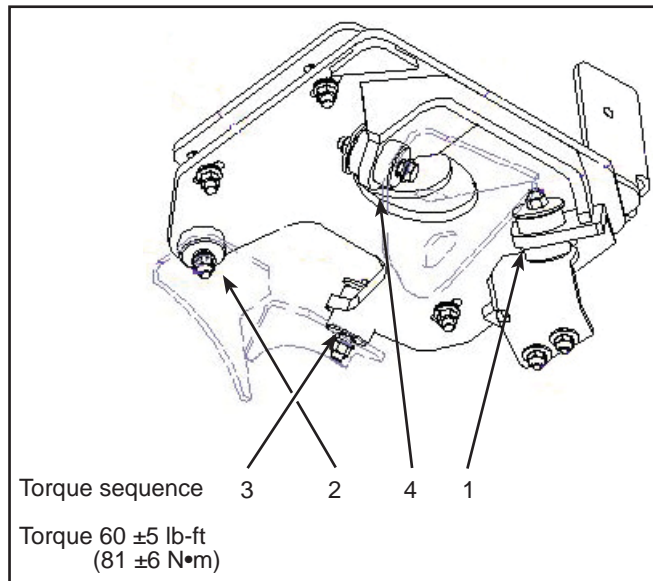

Figure 4 - Rubber Mounts Torque Sequence

- 1.8. Install the new N78165 compressor belt in accordance with section 14: **HEATING AND VENTILATION** in the Nova Bus maintenance manual.
- 1.9. Align the compressor belt in accordance with section 14: **HEATING AND VENTILATION** in the Nova Bus maintenance manual.
- 1.10. Tension the compressor belt in accordance with section 14: **HEATING AND VENTILATION** in the Nova Bus maintenance manual.



NOTE

Disregard the belt tension value in the maintenance manual. Apply a tension value of 220 ±5 lb (980 ±22 newtons) to the compressor belt. Disregard the torque value of the compressor plate screws in the maintenance manual. Apply torque of 89 ±4 lb-ft (120 ±5 N•m) to the four screws.

- 1.11. Close the rear engine access door.
- 1.12. Start the engine and let it run for 30 minutes.
- 1.13. Open the rear engine access door.
- 1.14. Re-tension the compressor belt in accordance with section 14: **HEATING AND VENTILATION** in the Nova Bus maintenance manual.



NOTE

Disregard the belt tension value in the maintenance manual. Apply a re-tension value of 200 lb (890 newtons) to the compressor belt. Disregard the torque value of the compressor plate screws in the maintenance manual. Apply torque of 89 ±4 lb-ft (120 ±5 N•m) to the four screws.

- 1.15. Close the rear engine access door.
- 1.16. The vehicle may be returned to service.

**NOTE**

At the next scheduled service at 3,000 or 6,000 miles (5,000 or 10,000 km), re-tension the belt to 190 lb (845 newtons). Apply torque of 89 ± 4 lb-ft (120 ± 5 N•m) to the four compressor plate screws.

LEVEL 2: INSTALL NEW HARDWARE AS NEEDED FROM STEP 1.4

- 2.1. Remove the compressor plate M12 bolts (4x), nuts (4x) and washers. See Figure 5. Discard the hardware.

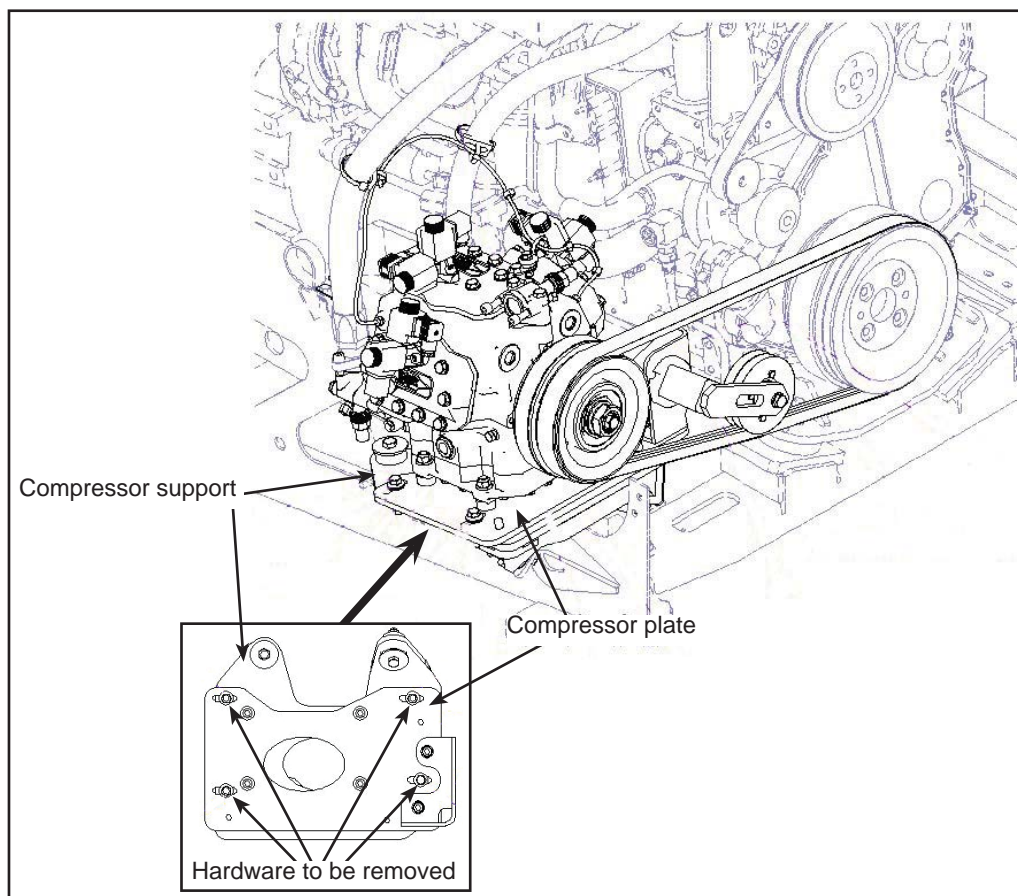

Figure 5 - Hardware to be Removed

- 2.2. Install new hardware N69539 M12x50 class 10.9 screws (3x), N69540 M12x60 class 10.9 screws (1x), N69378 M12 class 10.9 nuts (4x) and N32932 M12 Nordlock washers (8x). See Figure 6. Hand tighten the hardware.

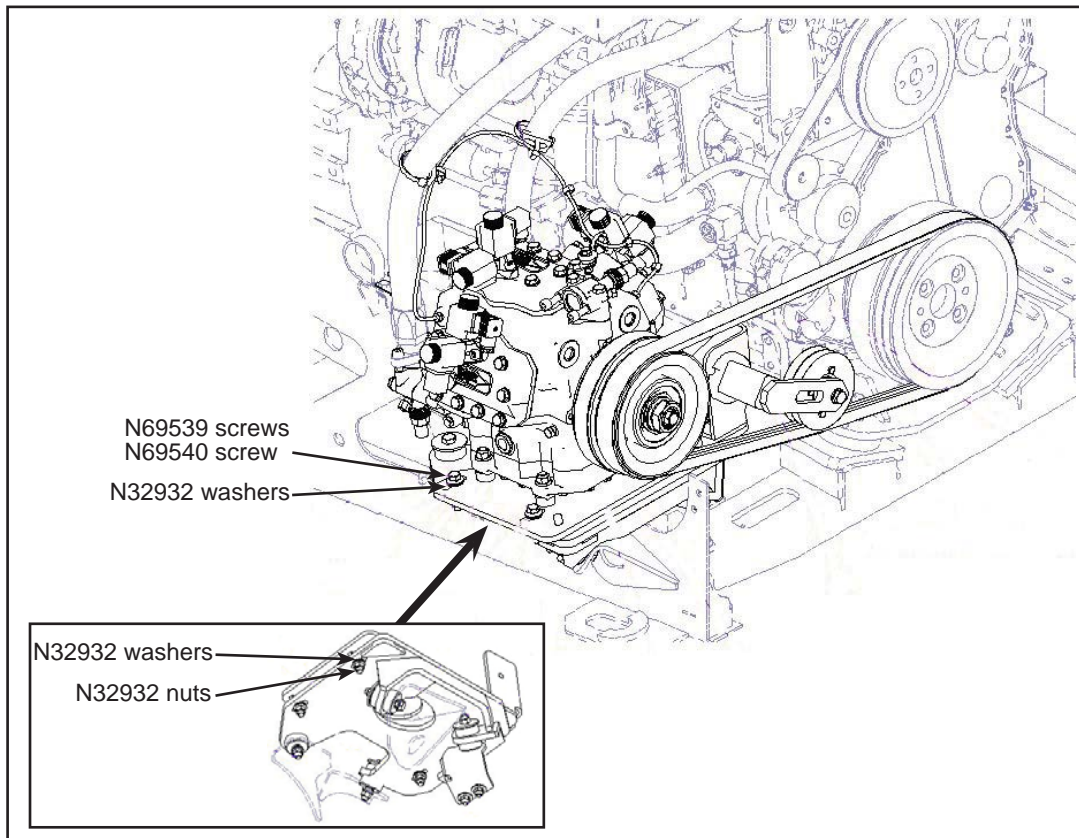

Figure 6 - New Hardware Installation

- 2.3. Go to step 1.5. ❖