

Special Bulletin

SP14-305A

Date	Expiration	Release	Page
04.2014	04.2014	3	1(4)

Revision A: This document supersedes previous revisions.
Updated as per DA comments.

BI-FOLD DOOR - HINGE ARM ROD ENDS REPLACEMENT Prevost vehicles

DESCRIPTION

On the vehicles affected by this bulletin, replace the bi-fold door hinge arm rod ends as described in the following procedure

MODEL YEAR(S) AND VEHICLES INVOLVED

NOTICE TO SERVICE CENTERS <i>Verify vehicle eligibility by checking warranty bulletin status with SAP or via ONLINE WARRANTY SYSTEM available on Service / Warranty tab of Prevost website.</i>	
Model	VIN
X3-45 Commuter Model Year : 2012	From 2PCG33495CC73 <u>5053</u> up to 2PCG33495CC73 <u>5232</u> incl.
This bulletin does not necessarily apply to all the above-mentioned vehicles, some vehicles may have been modified before delivery. The owners of the vehicles affected by this bulletin will be advised by a letter indicating the Vehicle Identification Number (VIN) of each vehicle concerned.	

MATERIAL NEEDED

Order the following parts to complete one (1) vehicle:

Part No.	Description	Qty
500747	WASHER, LOCK SPLIT N500 12.2x21.1x2.5	4
500958	WASHER, FLAT SS .531x1.062x.095	4
502261	ROD END, F ZP 1/2-20 WITH GREASE FITTING	4
502875	SCREW, CAP HEX N500 M12-1.75x40 G8.8	4
G5010160	SCREW #10-32X3/8 SS	4

NOTE
<i>Material can be obtained through regular channels.</i>

REQUIRED TOOLS

SAE OPEN END WRENCH SET 	TORQUE WRENCH AND METRIC SOCKET SET 
METRIC HEXAGONAL KEY SET 	

PROCEDURE



DANGER

Park vehicle safely, apply parking brake, stop engine. In the battery box, set the battery cut-off switch to the OFF position prior to working on the vehicle.

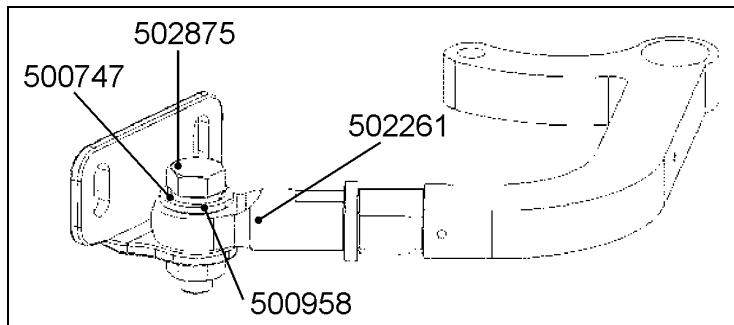

FIGURE 1



FIGURE 2

- 1) Prior to perform the following procedure, release the air pressure from the bi-fold door air cylinders and latch cylinders. To do so, turn the emergency release valve clockwise. This valve is located on the lower R.H. side of the dashboard (figure 2). Releasing the air pressure will unlatch the door and allow opening and closing of the door manually.



WARNING

Once a hinge arm rod end is disconnected from the door panel, a co-worker is needed to hold the door panel in place as it may fall.

NOTE

It is recommended to proceed with one rod end at a time. Remove a rod end and reinstall a new one with the new hardware as per the following procedure and then proceed to the next rod end.

Date	Expiration	Release	Page
04.2014	04.2014	3	3(4)



FIGURE 3

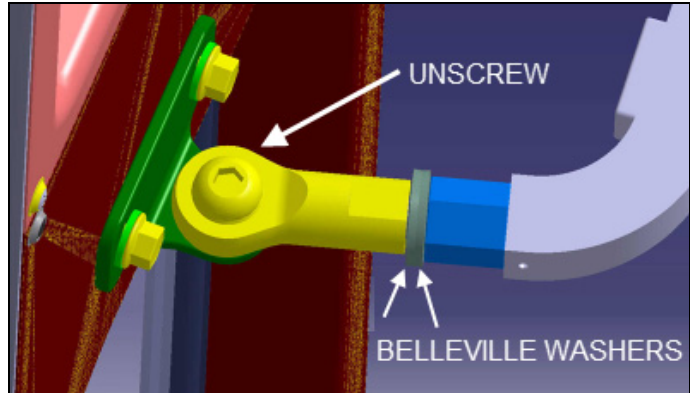

FIGURE 4

- 2) Remove the four hinge arm covers (2 screws per cover, figure 3).
- 3) While proceeding with one rod end at a time, unscrew and discard the bolt securing the rod end to the door panel attachment bracket (figure 4).
- 4) Keep the bi-fold door closed. Unscrew the existing rod end. **VERY IMPORTANT**, take note of the Belleville washers' position. All of the Belleville washers will have to be reinstalled with the concave sides against the other like this ().
- 5) Use Loctite 243 on hexagonal stud treads. Install a new rod end and tighten to a torque of 60 lbf-ft then loosen slightly until flat side is horizontal to allow fastening to the door attachment bracket.

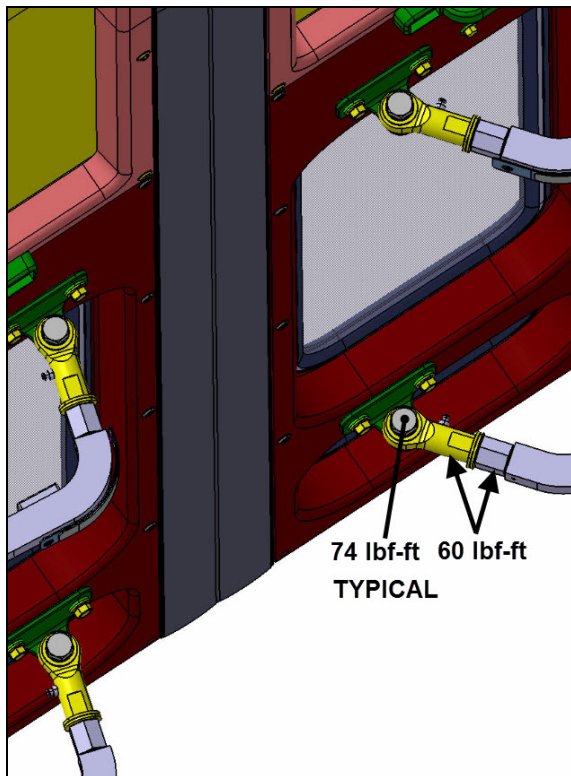

FIGURE 5



FIGURE 6: FILL ROD END WITH FRESH GREASE THEN REPLACE GREASE FITTING WITH SCREW G5010160

Date	Expiration	Release	Page
04.2014	04.2014	3	4(4)

- 6) Fasten the rod end to the door attachment bracket using new bolt 502875, new split lock washer 500747 (against bolt head) and new flat washer 500958. Tighten to 74 lbf-ft, use Loctite 243 on threads.
- 7) Proceed similarly with the second rod end on the door panel and then to the second door panel.
- 8) Fill the rod ends with fresh grease and clean grease in excess. Remove the four grease fittings and replace with screws G5010160 (figure 6).
- 9) Reinstall the four hinge arm covers.
- 10) Turn the emergency release valve counterclockwise to normal position.
- 11) Operate the door several times to confirm proper operation.

PARTS / WASTE DISPOSAL

Discard waste according to applicable environmental regulations (Municipal/State[Prov.]/ Federal)

ESTIMATED TIME

The time required to perform this special bulletin is approximately 1 hour.

OTHER

VBC Bulletin	na
Fail Code	18.01
Defect Code	09
System Condition	B
Causal Part	502196

Prevost engages in a continuous program of testing and evaluating to provide the best possible product. Prevost, however, is not committed to, or liable for updating existing products.