



Countries: CANADA, UNITED STATES, MEXICO, PUERTO RICO **Document ID:** IK1200469
Availability: ISIS, Bus ISIS, FleetSIS **Revision:** 3
Major System: ENGINES **Created:** 3/1/2010
Current Language: English **Last Modified:** 2/11/2014
Other Languages: [Français](#), [Español](#), **Author:** Jay Weston
Viewed: 4405

[Less Info](#)

Hide Details

Coding Information

Copy Link 	Copy Relative Link 	Bookmark View My Bookmarks	Add to Favorites 	Print 	Provide Feedback 	Helpful 499	Not Helpful 717
----------------------	-------------------------------	--	-----------------------------	------------------	-----------------------------	---------------------------	-------------------------------

Title: MaxxForce® 11 and 13 Oil leaking out of road draft tube

Applies To: 2008- 2009 MaxxForce® 11 and 13

DESCRIPTION

MaxxForce® 11 and 13 oil leaking out of road draft tube

SYMPTOMS

- Excessive oil leaking out of the road draft tube.

TROUBLESHOOTING



WARNING:

To prevent unexpected movement of the vehicle and possible serious personal injury or death, park the vehicle on a flat, level surface, set the parking brake, turn the engine off and chock the wheels to prevent vehicle from moving in both directions.

- Check the engine oil to see if it is at the correct level on the dipstick.
- If the engine is over full, drain oil to the correct level.
- Check the crankcase pressure per Engine Diagnostic Manual [EGES 420-2 - High Crankcase Pressure Test](#)
- If the the crankcase pressure test is greater than 14" H2O , remove the road draft tube and retest. If less than 14" H2O - Check road draft tube for blockage
- If the pressure is within specification, remove the crankcase breather filter and inspect the filter [See Breather Filter Servicing Instructions below](#).
- The filter should have a light oil film , the filter should not be saturated with oil. If filter is saturated with oil it must be replaced.
- Note recommended service interval for this filter below. It is the customers responsibility for all service items and service intervals.
- Remove the three drain tubes from the breather filter assembly Figure 1
- Using clean engine oil , slowly pour oil down each tube to check for obstructions.
- The oil should drain down into the oil pan, if it does not, check the lines for blockage.
- If blockage is found, inspect the upper and lower one way Check Valves in each line and check that they are installed correctly. Figure 2, 3 and 4
- Check Valves have a gray band that must be installed with the gray band up.

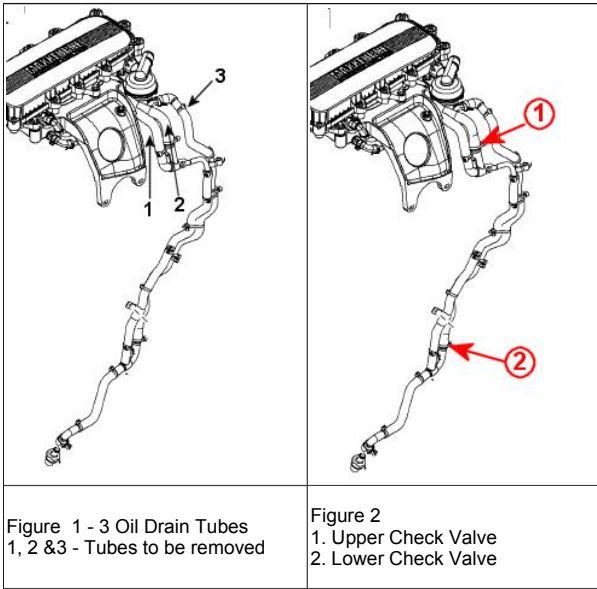

Figure 3 - Upper Check Valve
1. Check Valve - Gray Band Up

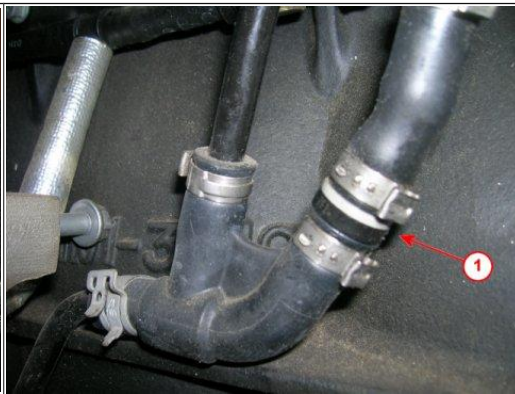
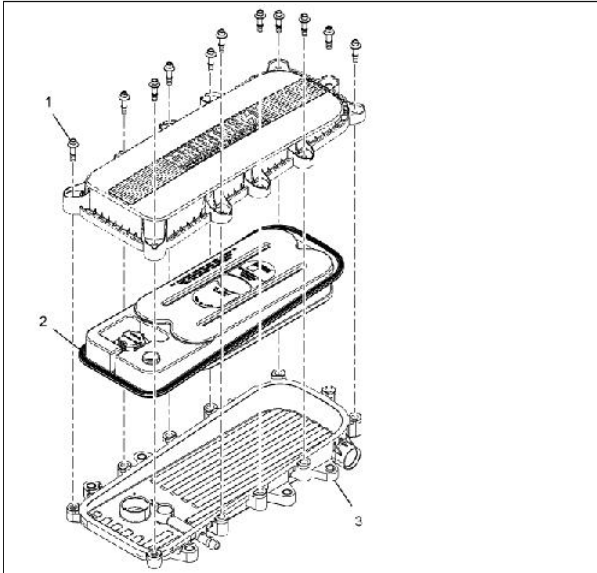

Figure 4 - Lower Check Valve
1. Check Valve - Gray Band Up

Breather Filter Servicing Instructions**NOTE:****Breather Service Interval: 161,000 km (100,000 miles)**

1. Remove breather insulator from service breather.
2. Remove five M8 x 35 hex bolts securing service breather cover. Figure 1 Item1
3. Remove service breather cover and discard service breather filter
4. Dispose of filter according to local regulations.
5. Install new service breather element. Figure 5 Item 2
6. Place service breather cover over service breather element.
7. Secure service breather cover with five M8 x 35 hex bolts. Tighten hex bolts to 31 N·m (23 lbf·ft).
8. Install breather insulator onto service breather.

**Figure 5 - Crankcase Breather Filter Assembly**

1. (5) M8 x 35 hex bolts
2. Breather Filter Element

[Hide Details](#)**Feedback Information**

Viewed: 4404

Helpful: 499

Not Helpful: 717

No Feedback Found