

Applies To: **2013 RDX AWD – ALL**
2014 RDX AWD – From VIN 5J8TB4...EL000001 thru 5J8TB4...EL019936

February 18, 2014

Vibration at Highway Speeds During VCM Operation

(Supersedes 14-001, dated January 15, 2014, to revise the information marked by the black bars)

REVISION SUMMARY

Under Applies To, a VIN range has been added to the 2014 model.

SYMPTOM

In cold ambient conditions (below-freezing temps) a vibration is felt in the front seats and floor at highway speeds during light throttle operation.

POSSIBLE CAUSE

The rubber in the companion flanges absorbs vibration poorly in cold temperatures.

CORRECTIVE ACTION

Replace the propeller shaft.

PARTS INFORMATION

Propeller Shaft Assembly:
P/N 40100-TX4-A02

Bolt (12 point, 8 mm x 21 mm) (eight required):
P/N 90113-S10-000

Flange Bolt (10x29) (two required):
P/N 90382-SH9-003

WARRANTY CLAIM INFORMATION

The normal warranty applies.

Operation Number: 2191W4

Flat Rate Time: 1.0 hour

Failed Part: P/N 40100-TX4-A01

Defect Code: 01601

Symptom Code: 04501

Skill Level: Repair Technician

Template ID: 14-001N

DIAGNOSIS

NOTE: Make sure the vehicle is cold soaked (let it sit overnight) before doing this test drive.

1. Test-drive the vehicle, paying close attention to the speed ranges when the vibration occurs and where it occurs.

NOTE: Make notes of where the vibrations are felt, (floor, seat, pedal, steering wheel, etc.) and the timing of when the vibration occurs relative to road/vehicle conditions (uphill, downhill, flat, VCM mode, etc.)

2. Pull over safely to the side of the road, and disconnect the rear rocker arm oil pressure switch connector, disabling the VCM operation.



REAR ROCKER ARM OIL PRESSURE SWITCH CONNECTOR

3. Drive the vehicle under the same conditions that caused vibration to occur.
 - If the vibration still occurs, this bulletin does not apply. Continue with normal troubleshooting.
 - If the vibration is gone, go to REPAIR PROCEDURE.

REPAIR PROCEDURE

1. Remove the No. 1 propeller shaft protector.

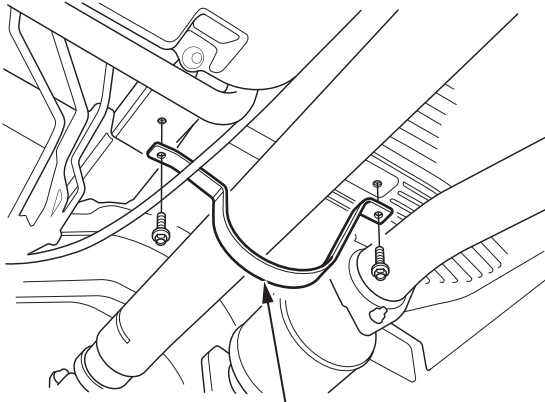

**No. 1 PROPELLER
SHAFT PROTECTOR**

2. Remove the No. 2 propeller shaft protector.

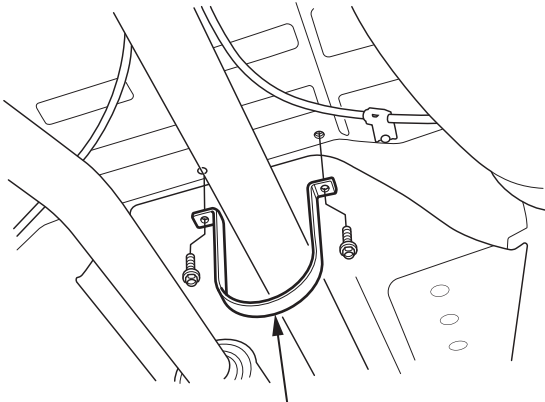

**No. 2 PROPELLER
SHAFT PROTECTOR**

3. Remove the No. 1 propeller shaft flange bolts.

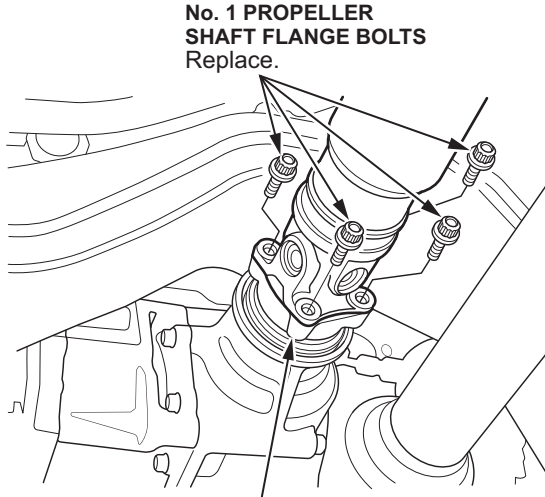

**No. 1 PROPELLER
SHAFT FLANGE BOLTS**
Replace.

TRANSFER COMPANION FLANGE

4. Remove the center support bearing mounting bolts.

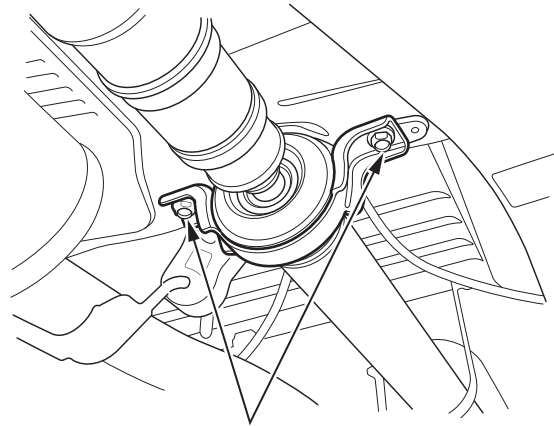

**CENTER SUPPORT BEARING
MOUNTING BOLTS**
Replace.

5. Remove the No. 2 propeller shaft flange bolts.

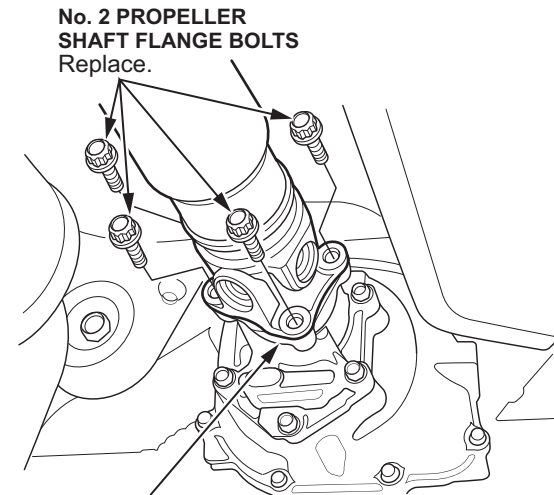

**No. 2 PROPELLER
SHAFT FLANGE BOLTS**
Replace.

**REAR DIFFERENTIAL
COMPANION FLANGE**

6. With the help of an assistant, install the new No. 1 propeller shaft to the transfer companion flange and loosely install the new flange bolts.

**NEW No. 1 PROPELLER
SHAFT FLANGE BOLTS**
32 N·m (24 lb-ft)

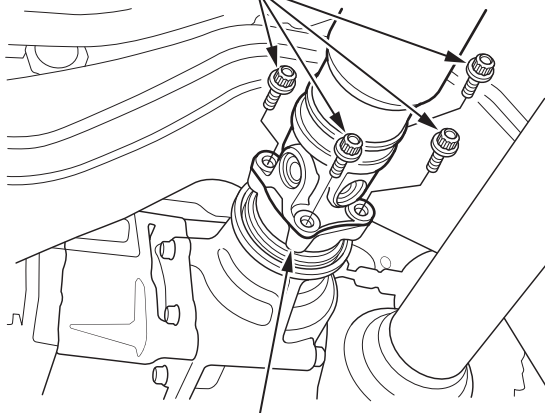

TRANSFER COMPANION FLANGE

7. With the continued help of an assistant, install the new No. 2 propeller shaft onto the rear differential companion flange and torque the No. 2 flange bolts to **32 N·m (24 lb-ft)**.

**NEW No. 2 PROPELLER
SHAFT FLANGE BOLTS**
32 N·m (24 lb-ft)

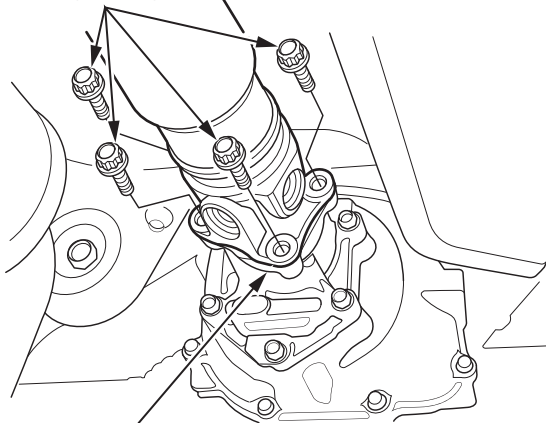

**REAR DIFFERENTIAL
COMPANION FLANGE**

8. Install the new center support bearing mounting bolts and torque them to **39 N·m (29 lb-ft)**. Then torque the No. 1 flange bolts to **32 N·m (24 lb-ft)**.

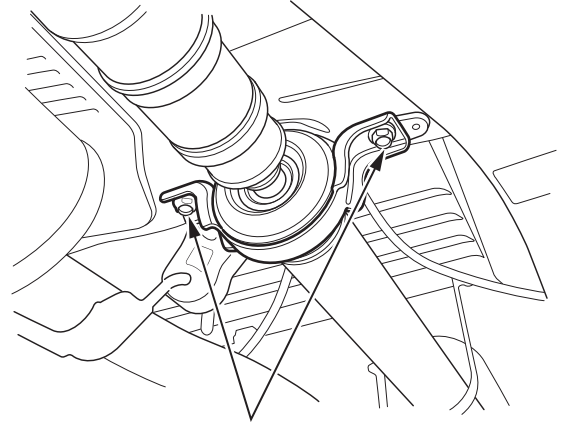

**NEW CENTER SUPPORT
BEARING MOUNTING BOLTS**
39 N·m (29 lb-ft)

9. Install the No. 1 and No. 2 propeller shaft protectors, then torque the bolts to **22 N·m (16 lb-ft)**.

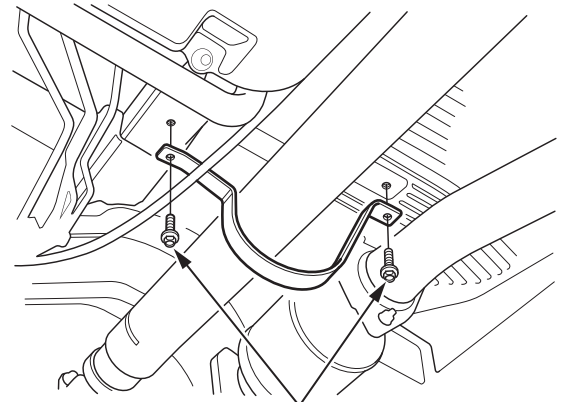

**No. 1 PROPELLER SHAFT
PROTECTOR BOLTS**
22 N·m (16 lb-ft)

10. Lower the vehicle to the ground.

11. Test drive the vehicle at 55 mph, and check for noise or vibration.

- If there is no vibration, go to step 12.
- If there is a vibration, make a reference mark across the No. 2 propeller shaft and the rear differential companion flange, then rotate the propeller shaft 180 degrees from that mark, and recheck.

NOTE: The rear rocker oil pressure switch coupler should still be disconnected during this test drive.

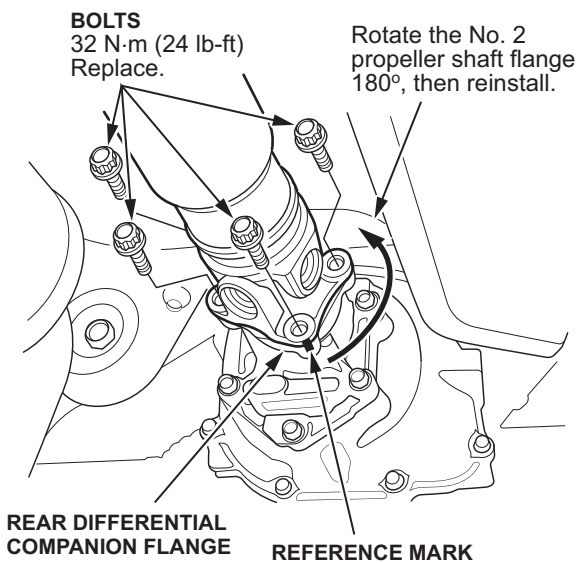

12. Reconnect the rear rocker oil pressure switch coupler.

13. Clear any DTCs with the HDS.