

FLA COE
FLB COE
FLD Conventional
Business Class
FLC 112 Conventional

> Century Class Conventional
Argosy COE
Cargo
Columbia

> 122SD and Coronado
> Business Class M2
> Cascadia
> 108SD/114SD

Freightliner
Service Bulletin

General Information

The fuses on horizontally-mounted powertrain power distribution modules (PDM) may crack due to vibration. Use the instructions in this bulletin to reduce the level of vibration on the PDM.

Instructions

1. Park the vehicle, shut down the engine, and apply the brakes. Chock the tires.
2. Open the hood.
3. Remove the split loom from the PDM harness and discard.
4. Wrap a 6-inch (15-cm) length of the harness with electrical tape, starting at the base. See [Fig. 1](#).

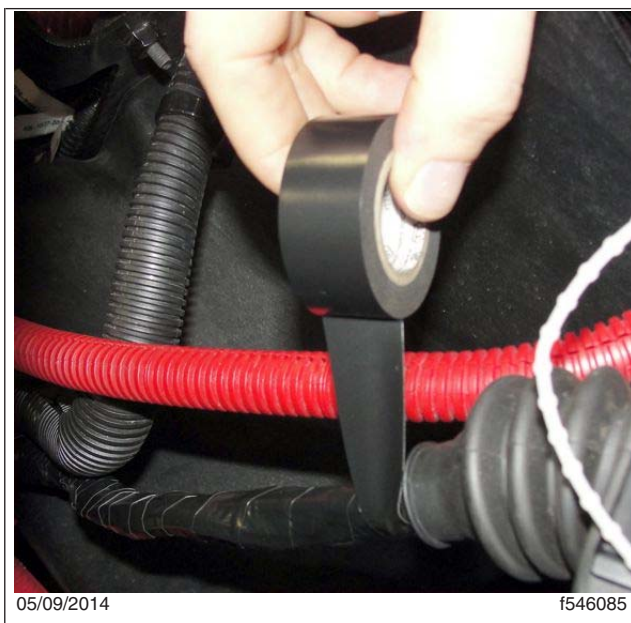

Fig. 1, Wrapping the PDM Harness with Electrical Tape

5. Secure the harness to the PDM using a cable tie.
 - 5.1 Feed the cable tie through the opening at the base of the PDM.
 - 5.2 Wrap the cable tie around the harness and attach the ends, but do not tighten.
 - 5.3 Form a drip loop with the harness so that the PDM boot is not bent or pulled by the harness.
 - 5.4 Tighten the cable tie and secure the harness tightly to the base of the PDM. See [Fig. 2](#).
6. Close the hood.

Warranty

This is an informational bulletin only. Warranty does not apply.

Freightliner Service Bulletin

FLA COE
FLB COE
FLD Conventional
Business Class
FLC 112 Conventional

> Century Class Conventional
Argosy COE
Cargo
Columbia

> 122SD and Coronado
> Business Class M2
> Cascadia
> 108SD/114SD

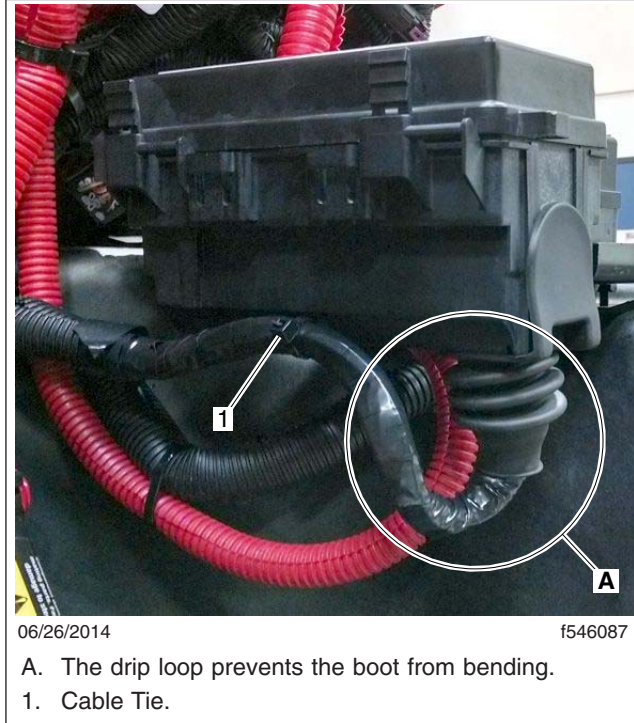

- A. The drip loop prevents the boot from bending.
- 1. Cable Tie.

Fig. 2, PDM Harness with a Drip Loop