

1 2 21-14



## Service Information Bulletin

SUBJECT	DATE
Description and Operation of the GHG14 Airless Dosing System Diesel Exhaust Fluid Pump	February 2014

### Additions, Revisions, or Updates

Publication Number / Title	Platform	Section Title	Change
DDC-SVC-MAN-0083	GHG14 DD Platform	Description and Operation of the GHG14 Airless Dosing System Diesel Exhaust Fluid Pump	The graphic was modified so the callouts in the text have been modified to match.



13400 Outer Drive, West, Detroit, Michigan 48239-4001  
 Telephone: 313-592-5000  
[www.demanddetroit.com](http://www.demanddetroit.com)

## 2 Description and Operation of the GHG14 Airless Dosing System Diesel Exhaust Fluid Pump

In most applications the Diesel Exhaust Fluid (DEF) pump module is mounted to a bracket located behind the DEF tank. The DEF pump module draws DEF from the tank, filters it and pumps it under 10 bar (145 psi) of pressure through a variable speed pump. The DEF pump pressure is controlled through the ACM via a pressure sensor located inside the DEF doser. The following items are serviceable for the DEF pump: DEF inlet fitting (1), DEF inlet filter screen (2), DEF outlet fitting (3), coolant inlet/outlet fitting (4), pressure relief valve (5), pressure relief valve plug screw (6), and DEF pump main filter (7).

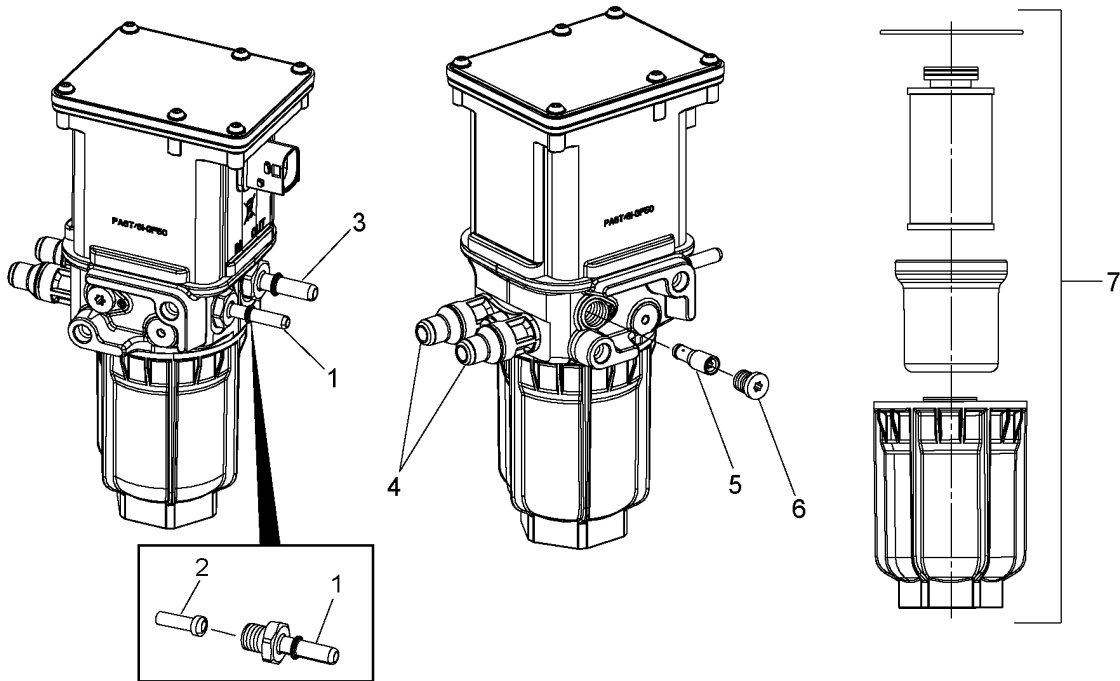

d140404a