

Technical Bulletin

Model(s)	Year	Eng. Code	Trans. Code	VIN Range From	VIN Range To
Jetta Wagon	2008-2009	All	All	All	All
Tiguan	2008-2014	All	All	All	All
Jetta SportWagen, Golf Wagon	2010-2014	All	All	All	All
Jetta	2011-2014	All	All	All	All
Touareg	2011-2014	All	All	All	All
Passat	2012-2014	All	All	All	All
Beetle	2012-2014	All	All	All	All

Condition

60 14 01 March 26, 2014 **2019568** Supersedes T.B. V601301 dated June 6, 2013 to include additional model year applicability.

Sunroof / Sunshade, Will Not Open

Note:

This bulletin is not applicable to Golf/GTI/Golf R, Eos or Routan.

DO NOT replace component(s) for this condition.

The panoramic sunroof, regular sunroof or sunshade cannot be opened. The following fault codes will set in fault memory of control module **4F Panorama roof (Except Touareg, Vehicle Electrical System 2)**.

Fault Code	Description
01512 005	No or incorrect basic setting / adaptation
02907 005	No or incorrect basic setting / adaptation

Technical Bulletin

Technical Background

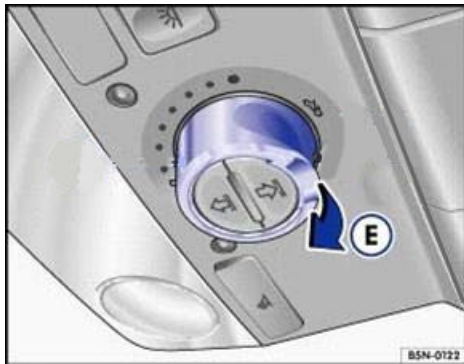

Figure 1



Figure 2

Jetta Sedan, Passat, Beetle

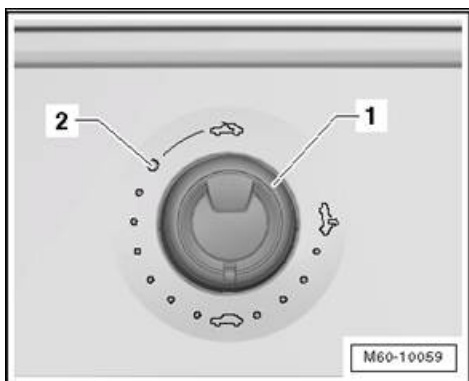

Figure 3

The sunroof only works when the ignition is switched ON.

The dial (Figure 3,-1-) opens the glass panel.

After the ignition is switched OFF, these functions are available until either the drivers or passenger door is opened.

Opening the glass sunroof in the “comfort” position (Figure 3, -2-) prevents most driving noise, which may occur when the glass is opened completely. The glass sunroof may be tilted and closed by pulling or pushing the rotary switch.

The sunroof is equipped with a closing force limiter in area of the window. When an obstruction is met during closing sequence, the roof opens again by itself.

There is also an emergency close function. If there are problems with closing the sunroof, it can be forced close by pulling on the back end of the dial. The rotary switch must be in the “sunroof close” roof position.

For the emergency close function the closing force limit is deactivated.

The motor for the sunroof has overheat protection, which activates under different conditions. After the sunroof motor has cooled down, it can be operated again.

If there is a malfunction in the sunroof electrical system, the sunroof can be moved manually by a hex wrench.

Technical Bulletin

Production Solution

Not applicable.

Service

Performing Basic Settings for Sun Roof

For vehicles that have not lost battery power, the customer can be instructed to perform "Basic Settings" manually:

1. Ignition ON.
2. The rotary switch must be placed in the sunroof closed position.
3. Pull the rotary switch down (Figure 1"E") and hold for approximately 20 seconds. Do not release the switch until the sunroof returns to closed position.



Tip:

During the adaptation process the glass sunroof will first close and then retract approximately 200mm. After the sunroof closes again, the adaptation process is complete.

Always open sunshade before opening sunroof.

How to open sunshade blind

- Press button 1 **briefly** (Figure 2) and the blind will open **automatically**. By pressing buttons 1 or 2 briefly again, the opening process can be stopped in any position.
- For manual opening, hold down button 1 until the desired position is reached, and release.

How to close sunshade blind

- Press button 2 briefly (see Figure 2), and the blind will close **automatically**. By pressing button 1 or 2 briefly again, the closing process can be stopped in any position.
- For **manual** closing, hold down button 2 until the desired position is reached, and release.



Technical Bulletin

Warranty

NON-Panoramic Sunroof

To determine if this procedure is covered under Warranty, always refer to the Warranty Policies and Procedures Manual ¹⁾					
Model(s)	Year(s)	Eng. Code(s)	Trans. Code(s)	VIN Range From	VIN Range To
Jetta	2011-2014	All	All	All	All
Passat	2012-2014	All	All	All	All
Beetle	2012-2014	All	All	All	All
SAGA Coding					
Claim Type:			Use applicable Claim Type ¹⁾		
Service Number:	Damage Code	HST	Damage Location (Depends on Service No.)		
6012	0040	--	Use applicable when indicated in ElsaWeb (L/R)		
	Jetta Sedan, Beetle		3ME ²⁾		
	Passat		TX6		
Labor Operation: Set Basic Settings			60122599 = 20 TU		
Causal Part: Select labor operation			60122599		
Diagnostic Time ⁴⁾					
GFF Time expenditure	01500000 = 00 TU		NO		
Road Test	01210002 = 00 TU 01210004 = 00 TU		NO		
Technical Diagnosis	01320000 = 20 TU		YES		



Technical Bulletin

Claim Comment: Input "As per Technical Bulletin 2019568" in comment section of Warranty Claim.

- ¹⁾ Vehicle may be outside any Warranty in which case this Technical Bulletin is informational only
- ²⁾ Code per warranty vendor code policy.
- ³⁾ Labor Time Units (TUs) are subject to change with ELSA updates.
- ⁴⁾ Documentation required per Warranty Policy Procedures Manual.

Panoramic Sunroof

To determine if this procedure is covered under Warranty, always refer to the Warranty Policies and Procedures Manual ¹⁾

Model(s)	Year(s)	Eng. Code(s)	Trans. Code(s)	VIN Range From	VIN Range To
Jetta Wagon	2008-2009	All	All	All	All
Tiguan	2008-2014	All	All	All	All
Jetta SportWagen, Golf Wagon	2010-2014	All	All	All	All
Touareg	2011-2014	All	All	All	All
SAGA Coding					
Claim Type:			Use applicable Claim Type ¹⁾		
Service Number:	Damage Code	HST	Damage Location (Depends on Service No.)		
6012	0040	--	Use applicable when indicated in ElsaWeb (L/R)		
Parts Manufacturer	Tiguan, Touareg		WWO ²⁾		
	Jetta Wagon , Jetta SportWagen, Golf Wagon		3ME ²⁾		
Labor Operation: Set Basic Settings			60122599 = 20 TU		
Causal Part: Select labor operation			60122599		



Technical Bulletin

Diagnostic Time ⁴⁾		
GFF Time expenditure	01500000 = 20 TU	YES
Road Test	01210002 = 00 TU 01210004 = 00 TU	NO
Technical Diagnosis	01320000 = 20 TU	YES
Claim Comment: Input "As per Technical Bulletin 2019568" in comment section of Warranty Claim.		
¹⁾ Vehicle may be outside any Warranty in which case this Technical Bulletin is informational only ²⁾ Code per warranty vendor code policy. ³⁾ Labor Time Units (TUs) are subject to change with ELSA updates. ⁴⁾ Documentation required per Warranty Policy Procedures Manual.		

Required Parts and Tools

No Special Parts required.

Tool Description	Tool No:
Midtronics Battery Tester/Charger	InCharge 940 (INC-940)
VAS Diagnostic Tool	VAS 5051B, VAS 5052A, VAS 6150/X & VAS 6160/X with: ODIS Service 2.0.0 or higher with current online updates

Additional Information

All part and service references provided in this Technical Bulletin are subject to change and/or removal. Always check with your Parts Dept. and Repair Manuals for the latest information.