



## Service Bulletin 509

Strictly Confidential

January 2014

---

**Affected Models** .....Tiger 800 and Tiger 800XC

**VIN Range** .....VIN 528044 to VIN 628403

**Markets** .....Brazil Only

**Subject** .....Clutch Cable Routing

### Background Information

We have identified a need to re-route the clutch cable as it has been incorrectly routed above the headlight/instrument mounting bracket in the headstock area.

### Customer Contact Instructions

Motorcycles in the affected VIN range must be modified prior to delivery to the customer, or at the next service/visit to the dealership.

### Identification of Affected Motorcycles

Tiger 800 and Tiger 800XC listed in the VIN range above.

### Warranty Claim Instructions

Fault code .....02045598

Repair code .....99509

Repair time allowance .....0.08 hrs

### Genuine Parts Information

**Genuine parts** .....Not required

**Genuine Parts Ordering Instructions** .....Not applicable

**Genuine Parts Return Instructions** .....Not applicable

### Other Instructions

Before returning the motorcycle to the customer, download the latest tune to the engine control module using the current version of the Triumph Diagnostic Software.

Once completed, please mark the Service Record Book that the requirements of this Bulletin have been complied with.

## Clutch Cable Routing

Re-route the clutch cable as described in the procedure detailed below.

### Warning

Throughout the following procedure, ensure that the motorcycle is stabilised and adequately supported to prevent the risk of injury from the motorcycle falling.

#### Note:

- Some affected motorcycles listed in the VIN range will have been modified and repaired by Triumph prior to their release from the factory.
  - The modified motorcycles can be identified by checking the 'VIN Enquiry' on [Triumphonline.net](http://Triumphonline.net).
1. Slacken the cable lock nut and release the adjuster at the clutch cover end to give maximum play in the cable.

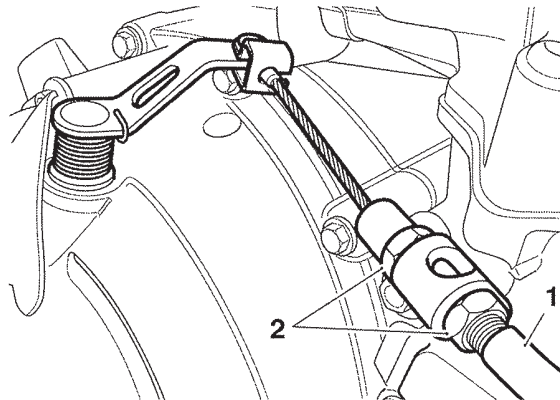

1. Clutch cable
2. Adjuster

2. Align the clutch cable adjuster and lever bracket slots.
3. Pull in the clutch lever and turn the inner cable anti-clockwise through the slots in the adjuster, until the cable can be detached from the lever by pushing downwards.

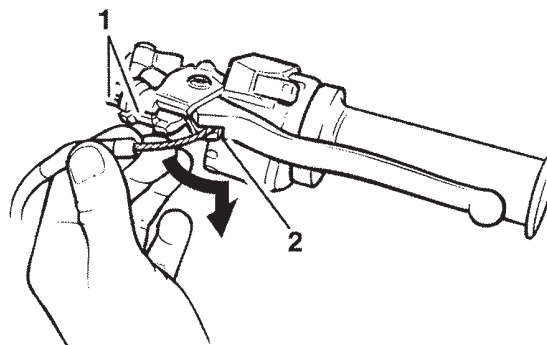

gaau\_1

1. Cable adjuster/lever bracket slots
2. Cable release point

# TRIUMPH

4. Re-route the cable such that it is between the two bars of the headlight/instrument bracket, as shown below.

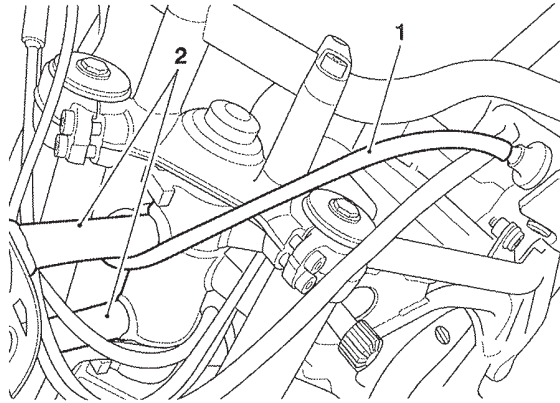

**1. Clutch cable**

**2. Headlight/instrument bracket**

5. Re-connect the clutch cable to the clutch lever and adjust the cable as described in the Service Manual.
6. Check the operation of the clutch cable.
7. With the clutch lever released, move the handlebars to full left and right hand locks and check that the cable does not move the clutch actuating arm.

## Circulation

(Initial and date when read and return to central file holder)

| Service Manager | Parts Manager | Sales Manager | Workshop Supervisor | Technician 1 | Technician 2 |
|-----------------|---------------|---------------|---------------------|--------------|--------------|
|                 |               |               |                     |              |              |