

REFERENCE:	Nova Bus Manuals
SECTION:	05: Rear suspension
RS N°:	—
EFFECTIVE IN PROD.:	—

APPLICATION DEADLINE:NA

SUBJECT:	Hub carrier
JUSTIFICATION:	Production of a modified hub carrier.

LEVEL	DESCRIPTION	DIRECT CHARGES		TIME
		LABOUR	MATERIAL	
1	New part number for the modified hub carrier.	Client	Client	—
2	—	—	—	—

**MATERIAL**

QTY	PART N°	REV.	DESCRIPTION	REPLACES PART N°
<b>LEVEL 1</b>				
—	N8898249	—	Hub carrier	N8893313
<b>LEVEL 2</b>				
—	—	—	—	—

**DISPOSAL OF PARTS**

REMOVED PARTS ARE:	DISCARDED	RETAINED	—
	—	—	

**REVISION HISTORY**

REV.	DATE	CHANGE DESCRIPTION	WRITTEN BY
NR	2014AL03	Initial release	Bertrand Plouffe

CLIENT	ORDER	ROAD NUMBER		VIN (2NVY/4RKY...)		QTY
		FROM	TO	FROM	TO	
CMBC (TransLink) - British Columbia	L412	9401	9401	L82X993000136	L82X993000136	1
Demo - Articulated Bus	L433	—	—	S92UX93000029	S92UX93000029	1
Demo - Articulated Bus APTA US	L359	—	—	S92U583000289	S92U583000289	1
Demo - Engineering Platform 2010 (Altoona)	L373	373-1	373-1	L82UX83000151	L82UX83000151	1
Demo - Nova PF2010 (TARC)	L356	356-2	356-2	L82U883000231	L82U883000231	1
Demo - Plateforme 2010 (ATQ)	L456	—	—	L82U893000019	L82U893000019	1
Demo - Proto Platform 2010	L271	—	—	L82U283000001	L82U283000002	2
Greater Toronto Airports Authority - GTAA - Ontario	L432	432-1	432-1	L82U793000061	L82U793000061	1
Moncton (Codiac) - New Brunswick	L358	358-1	358-1	L82U093000001	L82U093000001	1
Moncton (Codiac) - New Brunswick	L361	361-1	361-1	L82U293000002	L82U293000002	1
Regina - Saskatchewan	L356	356-1	356-1	L82U883000150	L82U883000150	1
Regina - Saskatchewan	L360	—	—	L82U283000290	L82U283000290	1
St. John - New Brunswick	L272	—	—	S92U483000011	S92U483000011	1
St. John - New Brunswick	L273	—	—	S92U383000050	S92U383000050	1
University of Colorado - Colorado	L427	—	—	S92U693000027	S92U693000027	1
University of Colorado - Colorado	L428	—	—	S92U893000028	S92U893000028	1



**WARNING**

Follow your internal safety procedures.



**NOTE**

You can still use stocked part # N8893313.

The new N8898249 hub carrier may be installed only one side at a time.

For disassembly and reassembly of the hub carrier, please refer to the ZF AV-132 rear axle repair manual.

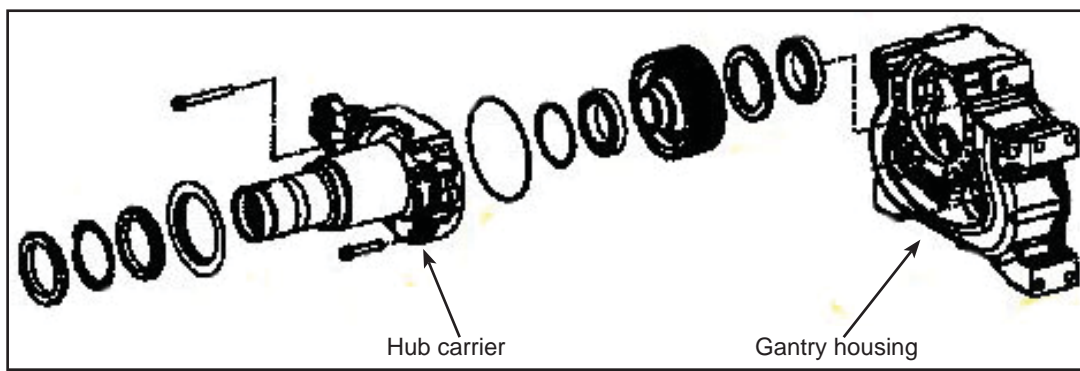

Figure 1 - Hub Carrier Typical Location

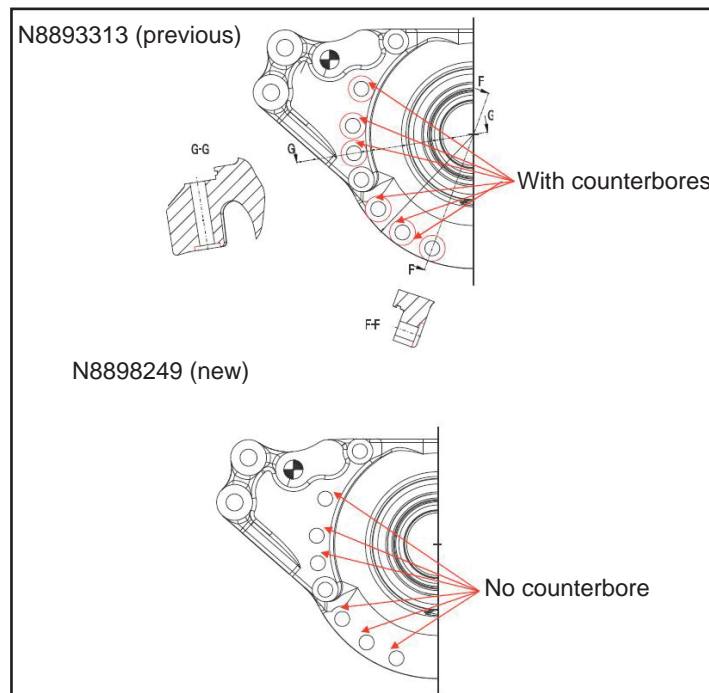

Figure 2 - Difference Between Previous and New Versions of Hub Carrier