



Service Bulletin

File in Section: -

Bulletin No.: P11328

Date: October, 2014

PRELIMINARY INFORMATION

Subject: Diagnostic Tip – Grind or Rattle Noise During a Left Turn or on a Bump

Models: 2013-2014 Cadillac CTS (VIN D), Escalade Models
2013 Chevrolet Avalanche
2013-2014 Chevrolet Camaro, Caprice, Corvette, Express, Silverado, Suburban, Tahoe
2013-2014 GMC Savana, Sierra, Yukon Models
Equipped with 6L80 Automatic Transmission (RPO MYC)

Condition/Concern

Some customers may comment that during left turns or on bumps there is a rattle or grind noise.

This noise may be due to a separated park pawl return spring, allowing the park pawl to pivot into the rotating park gear.

Recommendation/Instructions

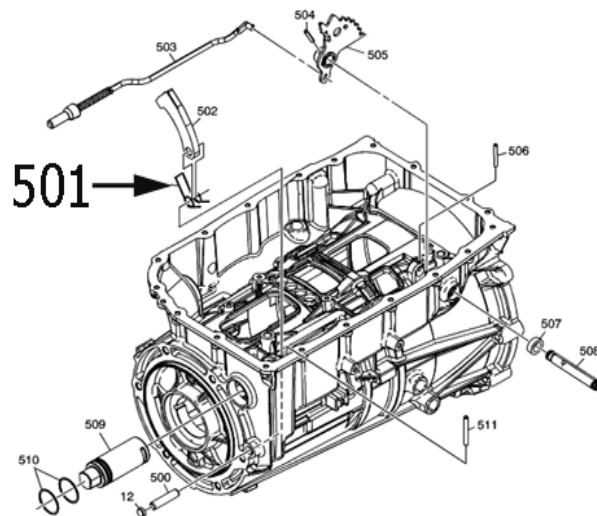

3982750

Remove the transmission fluid pan and inspect for a broken park pawl return spring (501).

A broken pawl return spring (501) will typically be loose on the park pawl shaft (500), while an unbroken spring will press tightly against the park pawl and the case.

Pieces of the spring may be found on the magnet or in the pan or filter.

If the park pawl return spring is broken, the **transmission case** must be replaced as the park pawl spring is not serviced separately.