	GROUP Body	MODEL 2011-12MY Sorento (XMa)
	NUMBER 090 (Rev 1, 09/11/2014)	DATE March 2012
TECHNICAL SERVICE BULLETIN		
SUBJECT: DRIVER'S SIDE POWER SEAT TRIM COVER REPLACEMENT AND WASHER RELOCATION		

*** NOTICE**

This bulletin has been revised to include additional information. New/revised sections of this bulletin are indicated by a black bar in the margin area.

This bulletin provides information about some 2011~12MY Sorento models produced before November 1, 2011 that may experience a loose or disengaged driver's side seat outer trim cover from the mounting bracket assembly. Follow the procedure outlined in this TSB to replace the Driver's Side Seat Trim Cover and relocate a front bracket shimming washer from the bottom hole to the top, to slightly angle the trim mounting bracket away from the seat cushion. After performing the TSB, if there are repeat repairs related to this trim cover replacement, please contact technical assistance.



Seat Side Trim Cover

***NOTICE**

Interior Trim can be easily damaged. Use a non-marring trim removal tool (Such as Snap-on® Part Number PBN5 or equivalent) to avoid breaking tabs and/or damaging trim pieces.

File Under: <Body>

-
- Circulate To: General Manager Service Manager Parts Manager
- Service Advisor(s) Technician(s) Body Shop Manager Fleet Repair

SUBJECT: DRIVER'S SIDE POWER SEAT TRIM COVER REPLACEMENT AND WASHER RELOCATION

1. Move the seat to the forward most position in preparation for removal of the side trim cover.



2. Remove both seat adjustment knobs by carefully prying them off from the top as indicated in the photo.

***NOTICE**

Use a non-marring trim removal tool (Such as Snap-on® Part Number PBN5 or equivalent) to avoid breaking tabs and/or damaging trim pieces.



3. Use your hand to disconnect the first tab only. Apply a light pulling force at the lower rear portion of the side trim cover; pulling trim piece towards you.



SUBJECT: DRIVER'S SIDE SEAT TRIM COVER WASHER RELOCATION/TRIM REPLACEMENT WITH POWER SEAT

4. Insert the trim removal tool into the gap and slide up to the next tab. Use the tool to maintain a separation between the two trim pieces. At the same time, use your hand to apply a light pulling force on the side trim cover.

***NOTICE**

Use a non-marring trim removal tool (Such as Snap-on® Part Number PBN5 or equivalent) to avoid breaking tabs and/or damaging trim pieces.

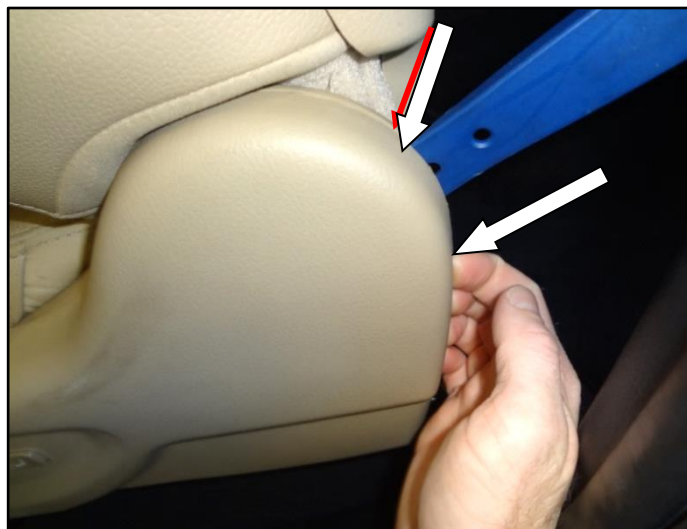

5. Repeat step 4 until all tabs are disconnected.



6. Slide the side trim cover forward to disengage the cover from the mounting bracket.



SUBJECT: DRIVER'S SIDE POWER SEAT TRIM COVER REPLACEMENT AND WASHER RELOCATION

7. Disconnect the two (2) seat adjustment wire harness connectors as indicated by the circles in the photo. Remove the seat control from the trim piece.



8. Locate the front side trim cover mounting bracket and then release the seat cover trim clips to access the bracket mounting screws.



***NOTICE**

Check for the presence of washer between bracket and frame, if it's located on lower screw continue to step 9. Otherwise, skip to step 13.

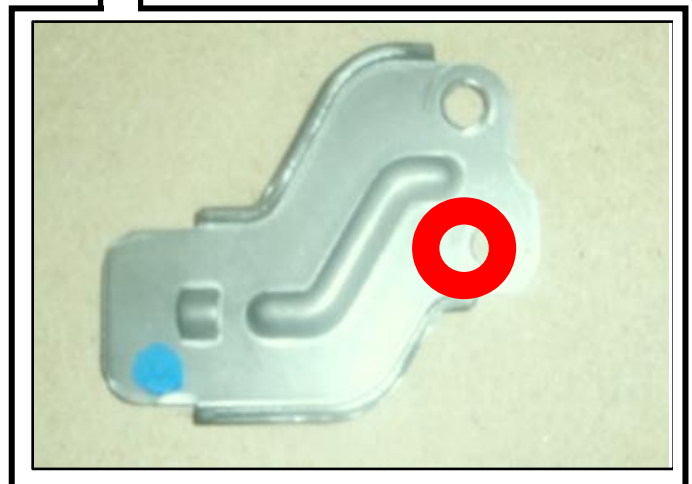

SUBJECT: DRIVER'S SIDE SEAT TRIM COVER WASHER RELOCATION/TRIM REPLACEMENT WITH POWER SEAT

9. Remove the front bracket using a Phillips screwdriver to remove the two (2) mounting screws as indicated in the photo.



10. Locate the washer on the back side of the bracket, around the lower mounting screw. Check position.

***NOTICE**

- Vehicles produced from January 1, 2011 to November 1, 2011 will have washer located on Lower screw.
- On vehicles produced before January 1, 2011 and after November 1, 2011 washer will already be in correct position no re-location is needed.

11. If washer is located on bottom remove the washer and install onto the top screw. If washer is already located on top no change needed.

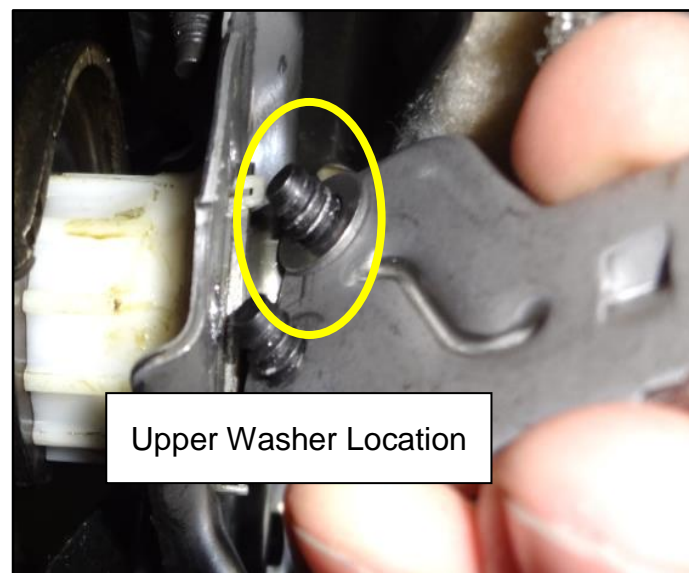

SUBJECT: DRIVER'S SIDE POWER SEAT TRIM COVER REPLACEMENT AND WASHER RELOCATION

- 12. With the washer installed on the top screw, reinstall the bracket onto the seat frame.



- 13. Install the seat controls into the new side trim cover by snapping them in place. Ensure tabs are engaged by push/pull check.



- 14. Re-secure the two (2) seat cover trim clips. Connect the two (2) seat adjustment wire harness connectors. Ensure harness is engaged by push/pull check. Cycle through all switch functions and seat positions to insure the wire harness is installed properly prior to installing side trim cover.

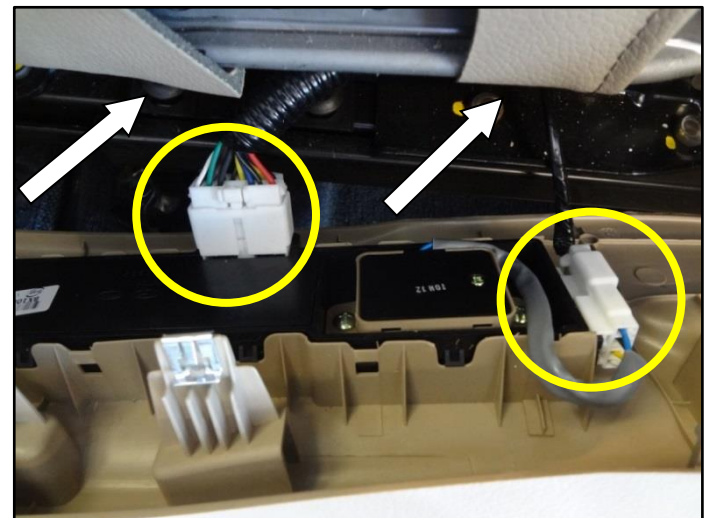

SUBJECT: DRIVER'S SIDE SEAT TRIM COVER WASHER RELOCATION/TRIM REPLACEMENT WITH POWER SEAT

15. Install the seat side trim cover over the front mounting bracket and slide back. Push the cover inward, ensuring that the clips are on the towers. Verify that all cover clips are fully engaged to the recliner cover.



***NOTICE**

Check to make sure bracket has improved rib design, verify presence of A-clip

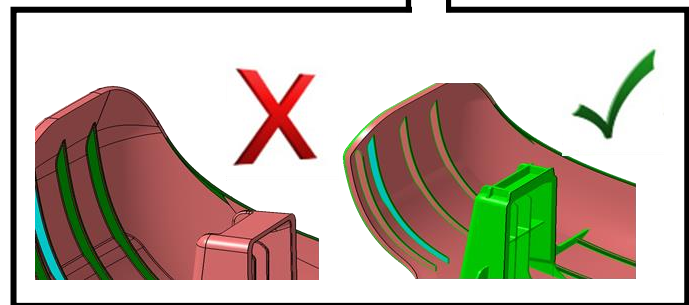

16. Snap the seat adjustment knobs back on the controller. Cycle the seat through all positions to ensure proper installation of Driver's Seat Trim Cover.



**SUBJECT: DRIVER'S SIDE POWER SEAT TRIM COVER REPLACEMENT
AND WASHER RELOCATION**

AFFECTED VEHICLE PRODUCTION RANGE:

Model	ProductionDateRange
Sorento (XMa)	Start of production to November 1, 2011

PART INFORMATION:

Part Name	Part Number	Color	Qty
Shield Cover-Seat Driver OTR	88160 1U020VA	Black	1
	88160 1U020H9	Gray	1
	88160 1U020J7	Beige	1

WARRANTY INFORMATION:

Claim Type	Causal P/N	Qty.	N Code	C Code	Repair Description	Labor Op Code	Op Time	Replacement P/N	Qty.
W	88160 1U020VA	0	N86	C06	Driver's Side Seat Trim Cover Replacement(BOD 090) (Relocate Shimming Washer)	88201R00	0.4 M/H	88160 1U020VA	1
	88160 1U020H9							1	
	88160 1U020J7							1	