

© 2013 Mazda Motor of America, Inc.

| | |
|--|--------------------------------|
| Subject: VARIOUS AUDIO SYSTEM CONCERNS WITH TUNER AND AMP UNIT (TAU) | Bulletin No: 09-038/13 |
| | Last Issued: 12/19/2013 |

APPLICABLE MODEL(S)/VINS

2014 Mazda3 vehicles (with MAZDA CONNECT) with VINs lower than JM1BM*****109600 (produced before September 1, 2013)

DESCRIPTION

Some vehicle may experience any one of the symptoms below that can be resolved with a modified TAU.

- AM/FM/XM cannot be selected as they are grayed out
- Radio station returns to 87.9MHz on its own
- Audio sound setting resets on its own
- TAU version is displayed as “not available”

Customers having any of these concerns should have their vehicle repaired using the following repair procedure.

REPAIR PROCEDURE

1. Verify customer concern.
2. On vehicle with a touchscreen (A), remove the TAU (B) and replace with a modified one. Refer to MS3 online instructions or Workshop manual (section 09-20 TUNER AND AMP UNIT (TAU) REMOVAL/INSTALLATION).

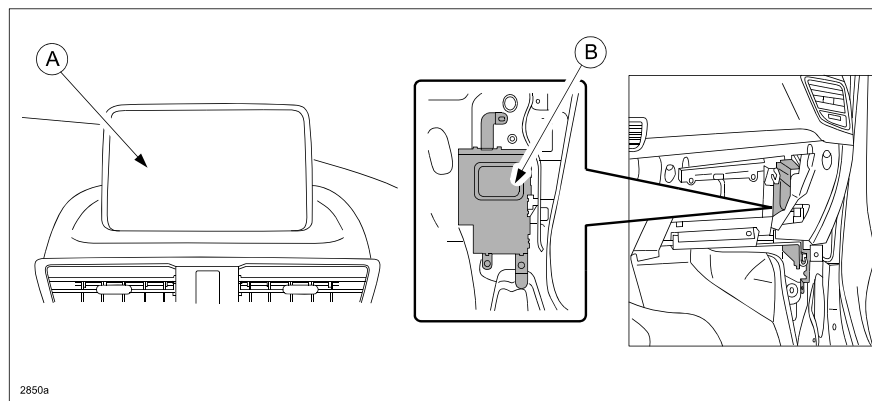

NOTE: When replacing the tuner and amp unit (TAU) with a new one for any reason, refer to TSB 09-030/13 SIRIUSXM REGISTRATION AFTER TUNER AND AMP UNIT (TAU) REPLACEMENT.

3. Verify repair.

PART(S) INFORMATION

Use exchange unit only. DO NOT automatically order a new part for warranty replacement.

| Part Number | Description | Qty. | Notes |
|--------------|-------------------|------|---|
| BHP1-66-DRX* | TAU | 1 | Confirm the part number in the EPC for the subject VIN. |
| BHP5-66-DRX* | TAU | 1 | |
| BJD5-66-DRX* | TAU (w/ XM Radio) | 1 | |
| BJD6-66-DRX* | TAU (w/ XM Radio) | 1 | |

* Any suffix

WARRANTY INFORMATION

NOTE:

- This warranty information applies only to verified customer complaints on vehicles eligible for warranty repair.
- This repair will be covered under Mazda's New Vehicle Limited Warranty term.
- Additional diagnostic time cannot be claimed for this repair.

| | |
|---------------------------------|----------------------|
| Warranty Type | A |
| Symptom Code | 61 |
| Damage Code | 9H |
| Part Number Main Cause | ****-66-DRX |
| Quantity | 0 |
| Operation Number / Labor Hours: | XXK2C2XRX / 0.3 Hrs. |