

Subject: CLACKING NOISE WHEN STARTING TO MOVE VEHICLE WHILE STEERING WHEEL IS TURNED TO FULL LEFT POSITION	Bulletin No: 06-002/13
	Last Issued: 10/09/2013

APPLICABLE MODEL(S)/VINS

2013-2014 CX-5 vehicles with VINs lower than JM3KE*****369145 (produced July 3, 2013)

DESCRIPTION

Some vehicles may exhibit a clacking noise from under the front of the vehicle. This noise only occurs when starting to move the vehicle while the steering wheel is turned to the full left position.

NOTE: The noise will not occur if the steering wheel is in the center or full right position.

The noise is caused when the edge of the left side inner ball joint (A) gets stuck with the steering gear housing. The shape of the inner ball joint edge has been changed to eliminate this noise.

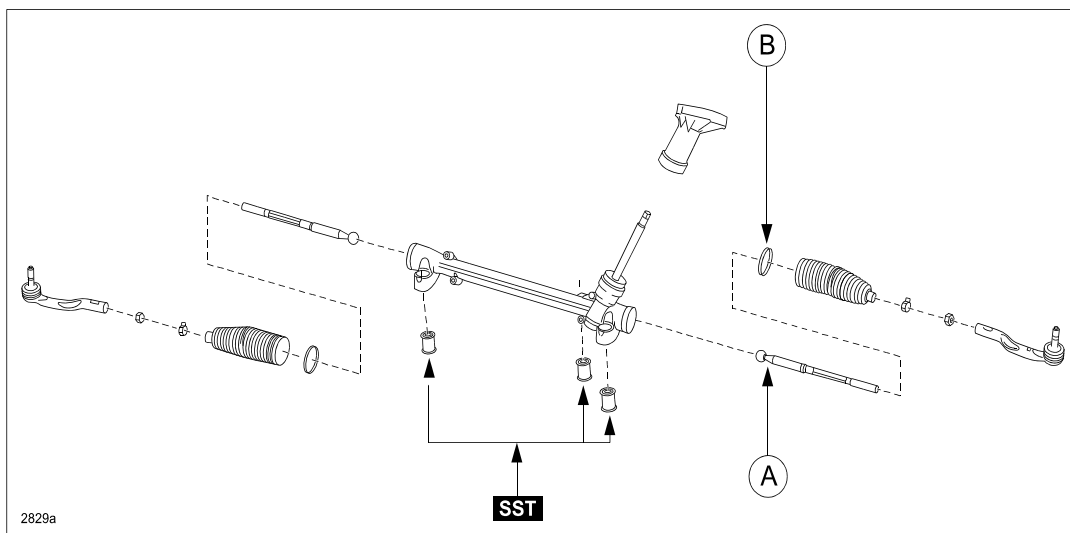

Customers having this concern should have their vehicle repaired using the following repair procedure.

REPAIR PROCEDURE

1. Verify the customer concern by turning the steering wheel full left, then start moving the vehicle.
2. Remove the steering gear and linkage according to the on-line instructions on MS3 or the Workshop Manual (section 06-13 STEERING GEAR AND LINKAGE REMOVAL) and replace the left inner ball joint (section 06-13 STEERING GEAR AND LINKAGE DISASSEMBLY).

NOTE: Be sure to replace wire clamp (B), the joint bolt and both snap pins.

3. Reinstall the steering gear and linkage in the reverse order of removal.
4. Verify the repair.

PART(S) INFORMATION

Part Number	Description	Qty.	Notes
KD31-32-240A	Inner Ball Joint	1	(A) (See illustration)
BBM4-32-127	Wire Clamp	1	(B) (See illustration)
B455-32-099B	Joint Bolt	1	Replace joint bolt located between intermediate shaft and steering gear / linkage assembly.
T060-26-169A	Snap Pin	2	Replace snap pins for outer ball joint (tie rod end) on both sides.

WARRANTY INFORMATION

NOTE:

- This warranty information applies only to verified customer complaints on vehicles eligible for warranty repair.
- This repair will be covered under the New Vehicle Limited Warranty term.
- Additional diagnostic time cannot be claimed for this repair.

Warranty Type	A
Symptom Code	82
Damage Code	9M
Part Number Main Cause	KD31-32-240A
Quantity	1
Operation Number / Labor Hours	XXJASRX / 2.8 Hrs. (Inner ball joint, R&R (left side)) Includes: Front wheel alignment check and adjust