

© 2013 Mazda Motor of America, Inc.

Subject: DOOR MIRROR BASE COVER DISCOLORATION	Bulletin No: 09-009/13
	Last Issued: 04/04/2013

APPLICABLE MODEL(S)/VINS

2013 CX-5 vehicles with VINs lower than JM3KE*****138997 (produced July 24, 2012)

DESCRIPTION

Some vehicles may experience a discoloration (from black to white) of the outer door mirror base cover. The material used for the mirror base cover has been changed to eliminate this concern.

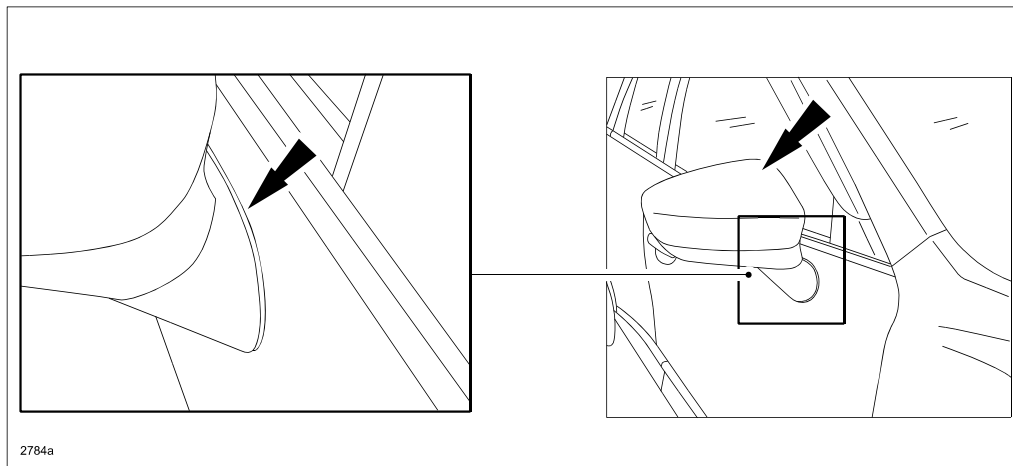

Customers having this concern should have their vehicle repaired using the following repair procedure.

REPAIR PROCEDURE

1. Verify the customer concern.

NOTE:

- If this concern has occurred on one side, it is recommended that both sides be repaired, unless for some reason the outer mirror has already been replaced with a modified part.
- Refer to the EPC for the modified door mirror part numbers.

2. Ensure the outer door mirrors are in the normal use (unfolded) position.
3. Remove the affected outer door mirror according to the instructions on MS3 online or the Workshop Manual (section 09-12 POWER OUTER MIRROR REMOVAL/INSTALLATION).
4. Remove the sealing rubber from the outer mirror base.

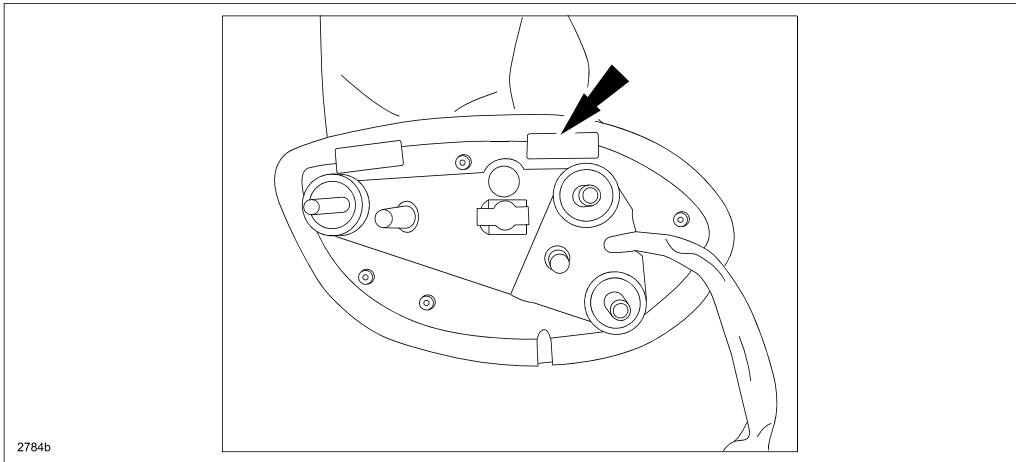

5. Using pliers, snap off the boss where the push nut (A) is installed, then remove it (B).

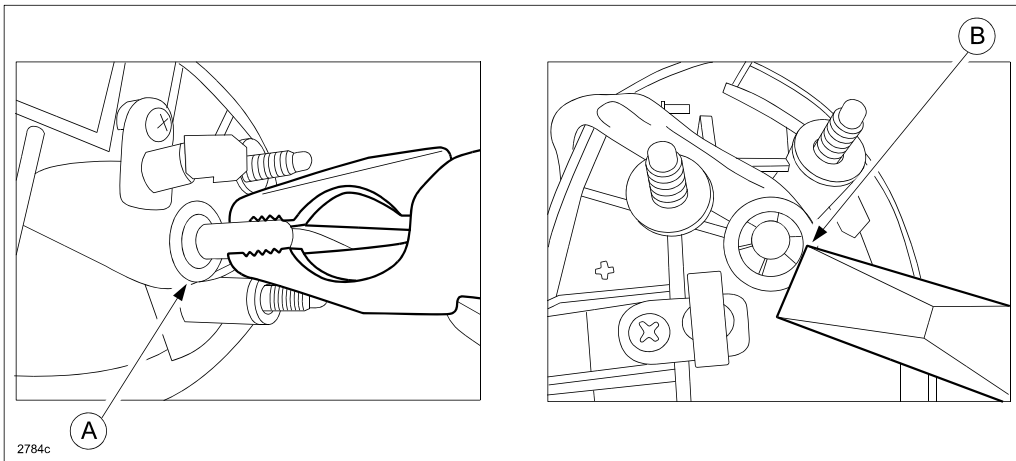

6. Disconnect the four (4) connections shown below using a flathead screw driver.

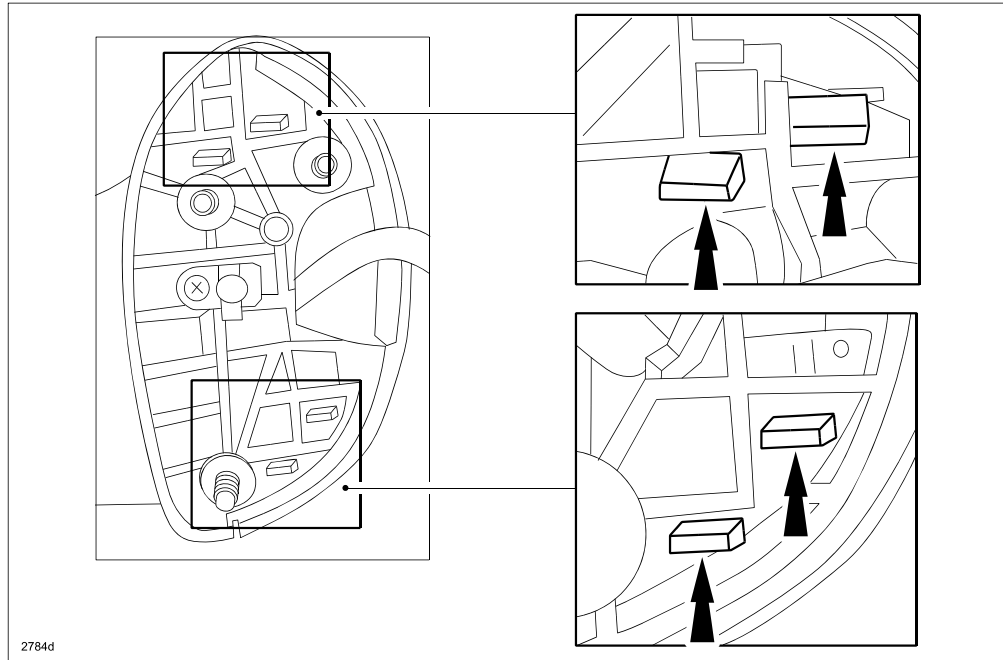

7. If the connection is disconnected, remove the cover by pulling it in the direction of the arrow shown below.

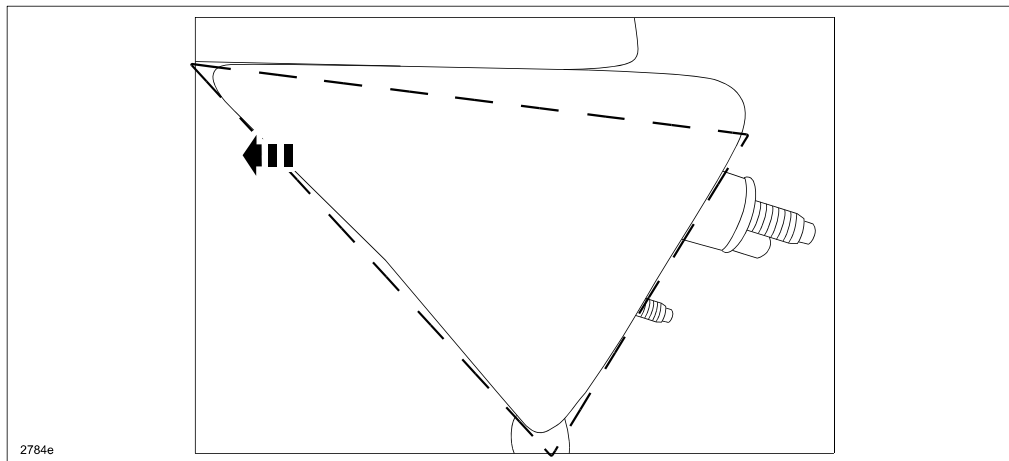

8. Replace the base cover with a new one.

9. Remove the three (3) screws, then the upper base cover and inner base together. Remove the inner base passing the harness out of location (A).

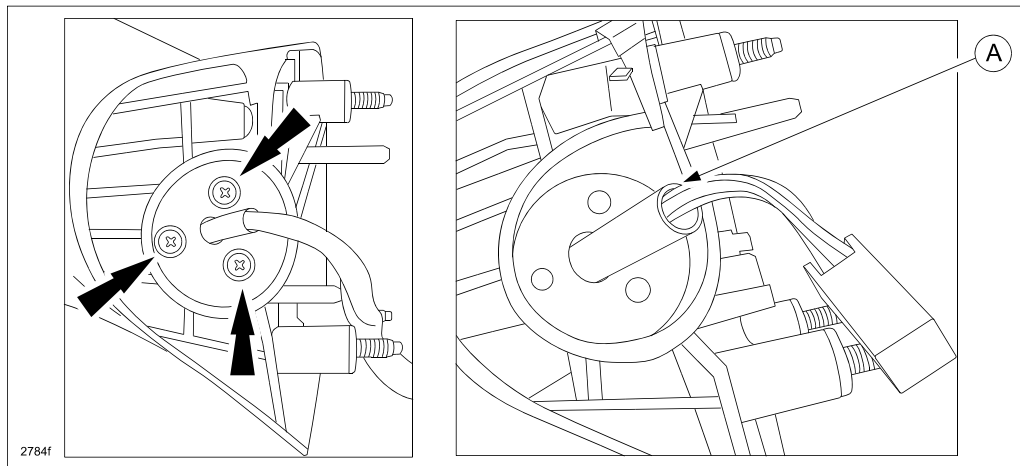

- (A) - Inner Base (including Upper Base Cover)
- (B) - Outer Mirror
- (C) - Sealing Rubber
- (D) - Lower Base Cover

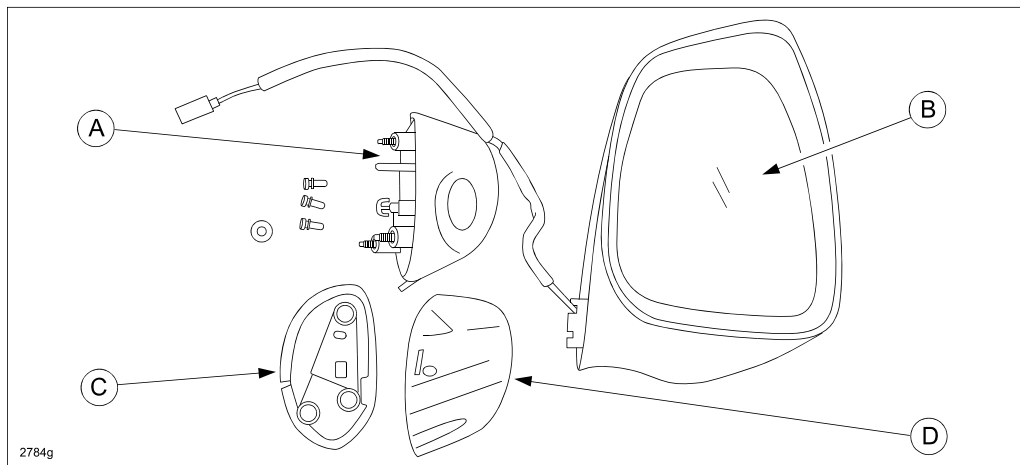

10. Pass the harness through the new inner base.

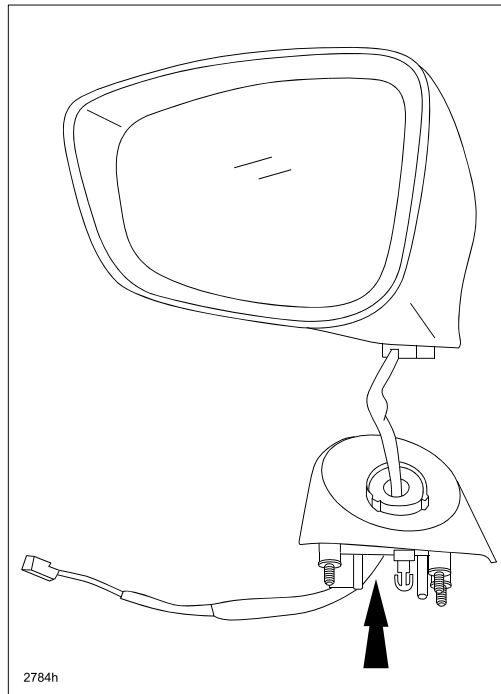

11. Install the inner base to the outer mirror matching up the positioning points.

NOTE: Be careful not to pinch the harness.

(A) - Outer Mirror side

(B) - Inner Base side (including Upper Base Cover)

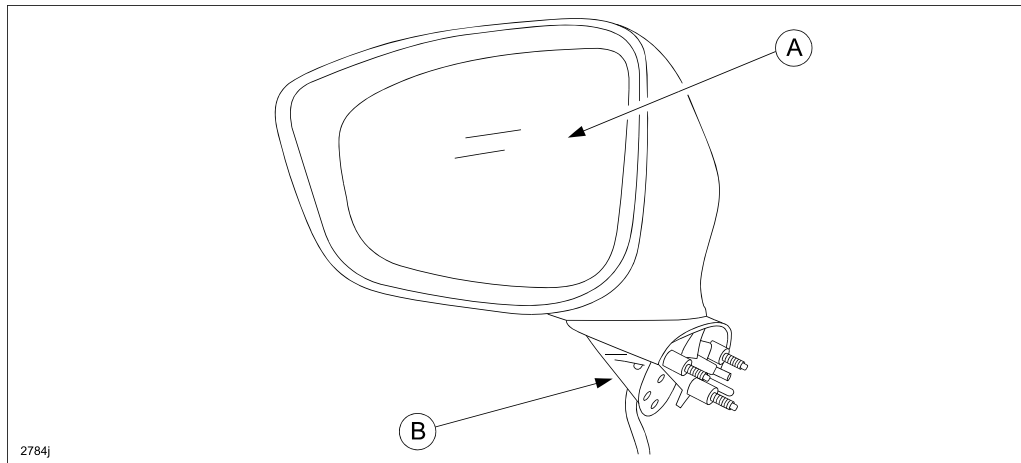
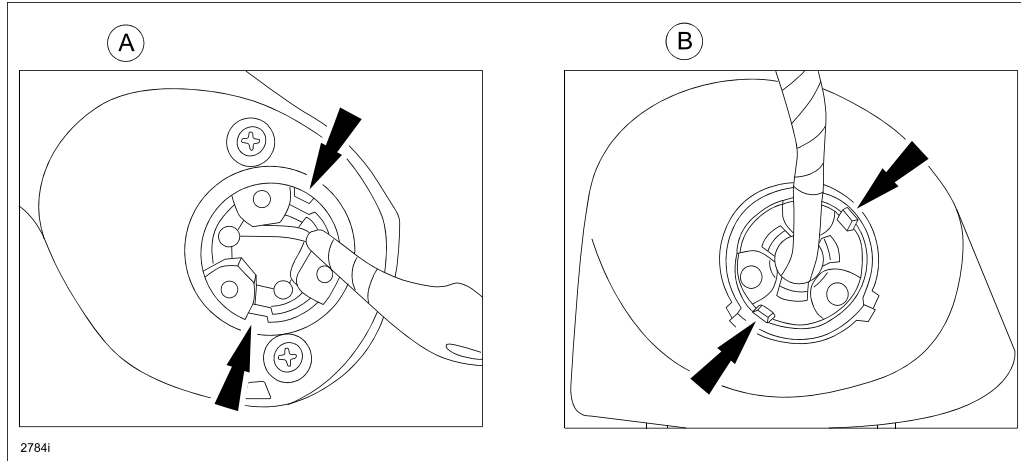

12. Install the inner base to the outer mirror using new screws (included in base cover set) using TORX screw (T25).

Tightening Torque: 47 +/- 4 in•lbf {5.3 +/- 0.5 N•m, 54 +/- 5 kgf•cm}

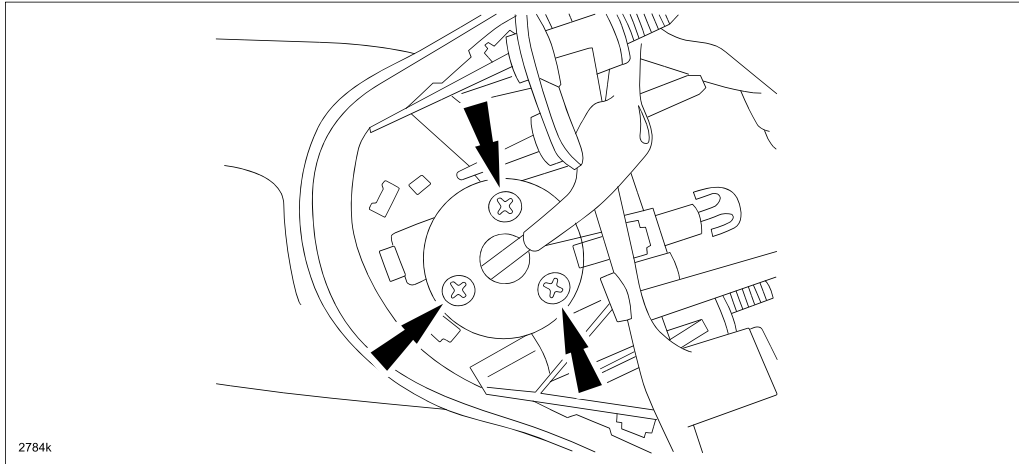

13. Push through the wire harness and install the new push nut (A) (included in base cover set) as shown below.

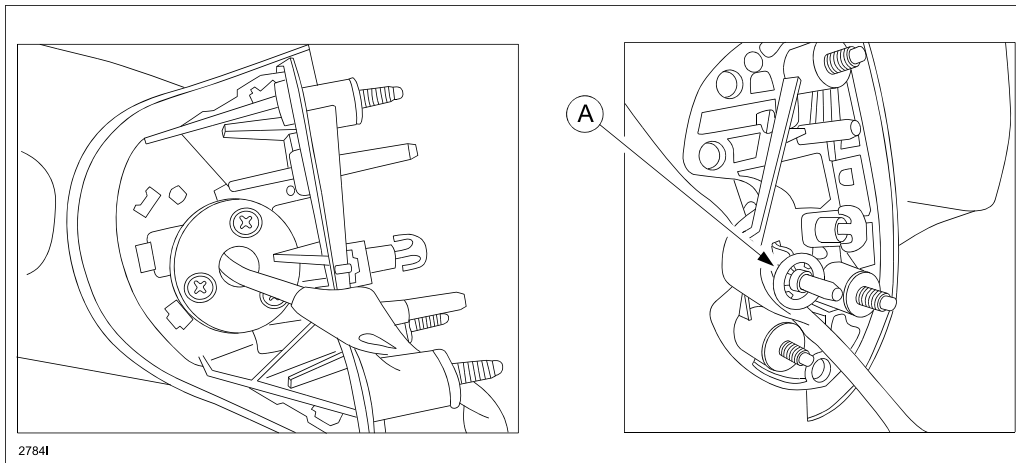

14. Align both locators (A) and install the base cover to the inner base as shown below.

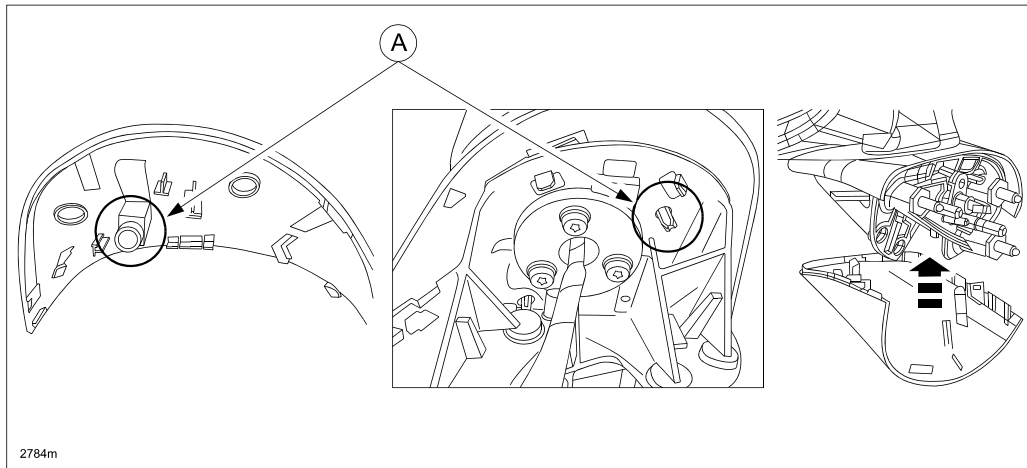

15. Confirm the harness length from the mirror base to the end of the connector is 340mm +/- 10mm (A).

NOTE: If the harness is a two (2) connector type (with Rear View Monitor) (B), the position is 340mm from the shorter of the two (2) connectors.

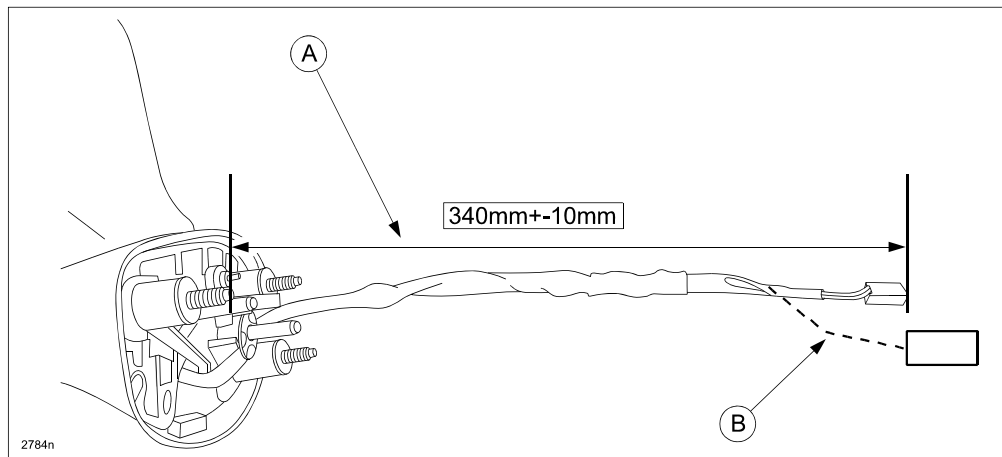

16. Install the new sealing rubber (included in the base cover set) to the mirror base.

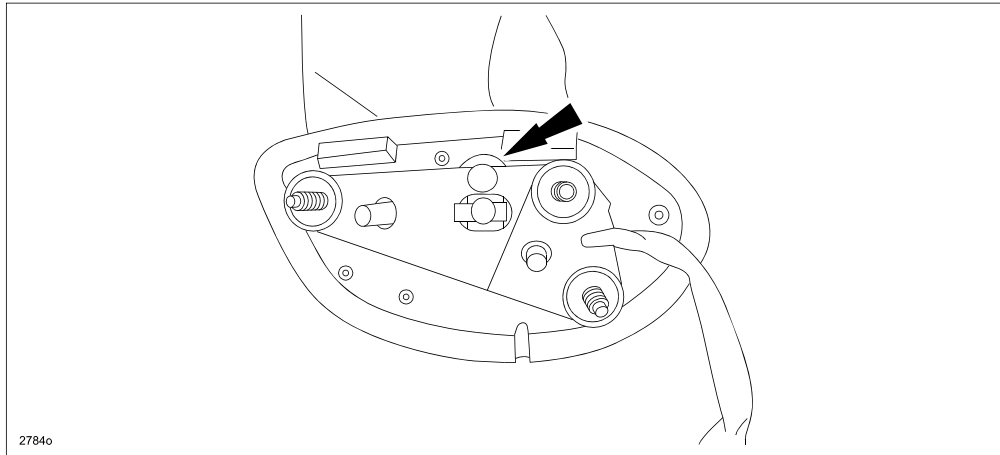

17. Remove the old EPT sealer from the harness and wrap a new one (included in the base cover set) in the same position (A), 140mm from the end of the connector.

NOTE: If the harness is a two (2) connector type (with Rear View Monitor) (B), the position is 140mm from the shorter of the two (2) connectors.

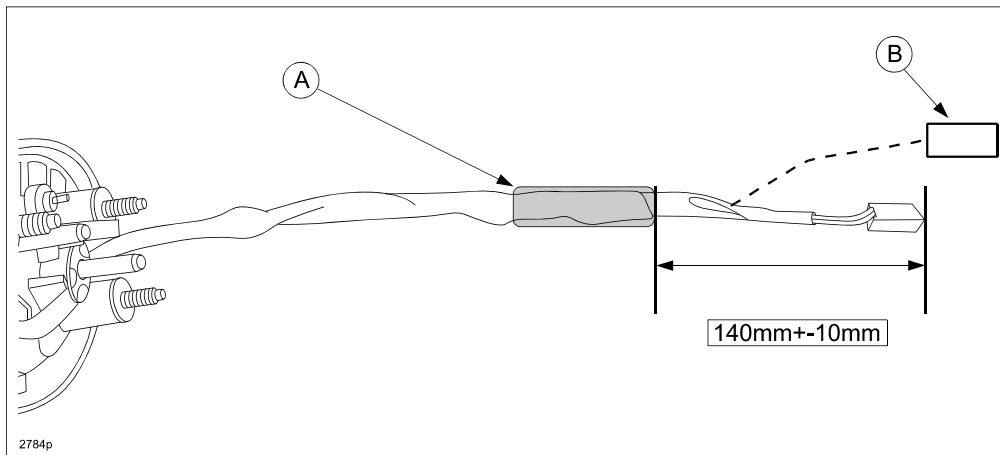

18. Install the outer door mirror according to the instructions on MS3 online or the Workshop Manual (section 09-12 POWER OUTER MIRROR REMOVAL/INSTALLATION).

NOTE: Replacement of mirror base and cover is identical on the opposite side outer door mirror.

19. Verify repair.

PART(S) INFORMATION

Part Number	Description	Qty.	Notes
KDY0-69-1A2	Base cover set (R)	1	---
KDY0-69-1A8	Base cover set (L)	1	---

WARRANTY INFORMATION

NOTE:

- This warranty information applies only to verified customer complaints on vehicles eligible for warranty repair.
- This repair will be covered under Mazda's New Vehicle Limited Warranty term.
- Additional diagnostic time cannot be claimed for this repair.

Warranty Type	A
Symptom Code	49
Damage Code	9X
Part Number Main Cause	KDY0-69-1A2 or KDY0-69-1A8
Quantity	1
Operation Number / Labor Hours	XXJ4CXRX / 0.5 Hrs. (one side) XXJ3ZXRX / 0.8 Hrs. (both sides)