



# Service Bulletin

File in Section: -

Bulletin No.: PI0922

Date: March, 2013

## PRELIMINARY INFORMATION

**Subject:** Malfunction Indicator Lamp (MIL) On, DTCs P059F and P069E Set

**Models:** 2013 Chevrolet Malibu  
Equipped with Front Lower Grille Shutters (RPO VRI)  
and Built Prior to the VIN Breakpoints in the Table Below

Plant Location	Date
Fairfax (VIN Code F)	June 25, 2012
Detroit Hamtramck (VIN Code U)	July 20, 2012

### Condition/Concern

Some customers may comment that the malfunction indicator lamp (MIL) is on.

When checking the vehicle for DTCs, P059F and P069E may be set. If both DTCs are NOT set, this PI does not apply.

The MIL may illuminate if shutter movement is obstructed or if the drive louver (louver connected to actuator) has over-rotated past its stop.

### Recommendation/Instructions

Perform the following steps to verify proper shutter operation.

1. Inspect for debris blocking the movement of the shutter louvers.
2. Inspect for any signs of impact.
3. Remove the front bumper fascia. Refer to the Front Bumper Fascia Replacement procedure in SI.

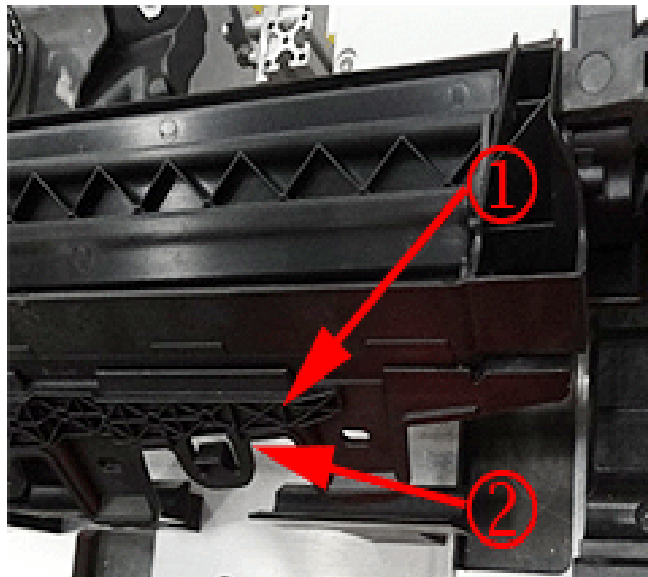

2906217

4. Inspect for proper installation of the shutter assembly. Make sure the clips (1) are fully engaged and aligned between the bracket (2) and the shutter assembly.

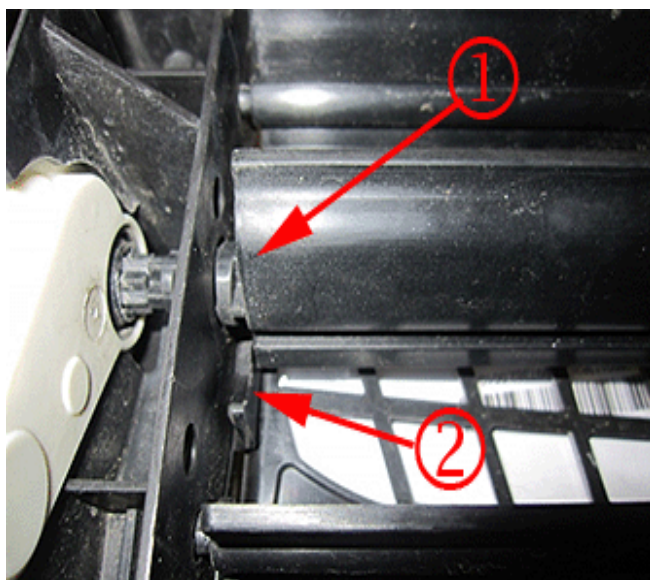

2906215

5. Inspect the drive louver (louver connected to actuator) (1) to determine if it has rotated past its stop (2). If the louver is shoved all the way to the passenger side of the shutter frame, the louver may bypass the stop. This will cause the drive louver to over-rotate and set the DTC. If the drive louver has over-rotated past its stop, install a washer (obtained from WPC) between the drive louver and the shutter frame using the steps below.

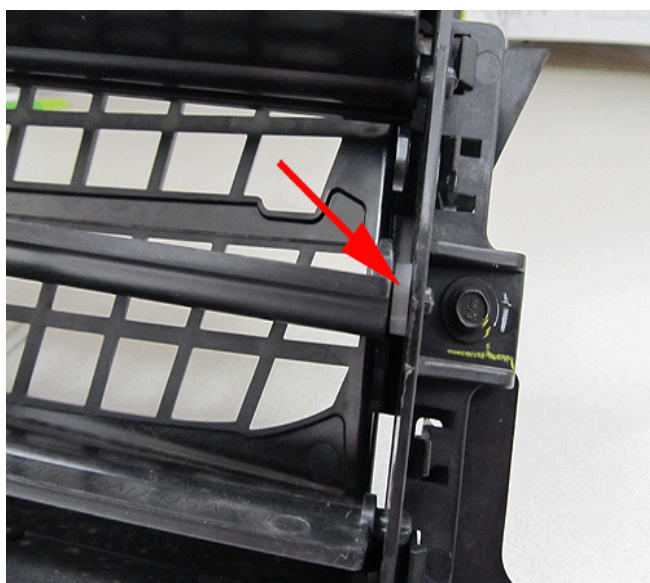

2906401

- 5.1. Remove the drive louver from the pivot hole on the shutter frame. Gently grasp or pry to release.  
 5.2. Install the washer on the louver pivot pin.  
 5.3. Reinstall the drive louver into the pivot hole on the shutter frame.  
 6. Install the front bumper fascia. Refer to the Front Bumper Fascia Replacement procedure in SI.

## Parts Information

To obtain the washer, fax the form included in this bulletin to the GM Warranty Parts Center (WPC). Request WPC #642.

## Warranty Information

For vehicles repaired under warranty, use:

Labor Operation	Description	Labor Time
B6829*	Verify Proper Shutter Operation – Inspect for Any Obstructions	0.3 hr
Add	To Inspect Shutter Installation and/or Install Washer (Includes Front Bumper Fascia Removal/Installation)	1.1 hrs

Labor Operation	Description	Labor Time
*This is a unique labor operation for bulletin use only. It will not be published in the Labor Time Guide.		

**IMPORTANT NOTE WHEN PRINTING THIS FORM:** If the form prints out on two pages, make certain you fax BOTH pages so that the WPC receives all the needed information. Missing information will delay or prevent the part from being shipped.

Parts Request Form – Warranty Parts Center
<p><b>Use this form ONLY for U.S., Canadian and Mexico Dealers. Export markets located outside of North America must contact their regional Technical Assistance Center for assistance.</b></p>
<p>To: Warranty Parts Center</p>
<p>e-mail: <a href="mailto:warrantypartscenterUSA@gm.com">warrantypartscenterUSA@gm.com</a></p>
<p>or WPC Fax: 248-371-0192</p>
<p>Attn: Jeanette Dunn</p>
<p>Part Being Requested: WPC #642 Washer</p>
<p>Dealer BAC (U.S.) /Dealer Code (Canada)/Dealer Number (Mexico):</p>
<p>Dealer Name:</p>
<p>Dealer Address:</p>
<p>Dealer Contact Person:</p>
<p>Dealer Phone Number:</p>
<p>Repair Order Number:</p>
<p>Vehicle VIN:</p>
<p><b>Important:</b> If you do not receive the part within 2 business days after e-mailing or faxing your part request to the Warranty Parts Center, please call Customer Assistance at 248-371-9901/9902.</p>
<p><b>IMPORTANT NOTE WHEN PRINTING THIS FORM:</b> If the form prints out on two pages, make certain you fax BOTH pages so that the WPC receives all the needed information. Missing information will delay or prevent the part from being shipped.</p>